

PREPARED FOR:



10 East 53rd Street, 17th Floor  
New York, NY 10022

REVISIONS:

#	DATE	COMMENT
A	12/11/2020	DRAFT - Site Plan
B	01/29/2021	Preliminary Site Plan
C	03/19/2021	Preliminary Site Plan

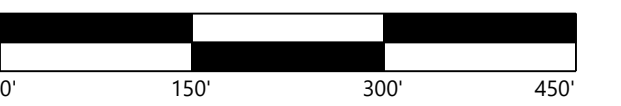

# Hayward Solar Project

Freeborn County, Minnesota

Site Plan

**PRELIMINARY  
NOT FOR CONSTRUCTION**

DATE: 03/19/2021

SHEET: **C.307**

SEE SHEET C.304

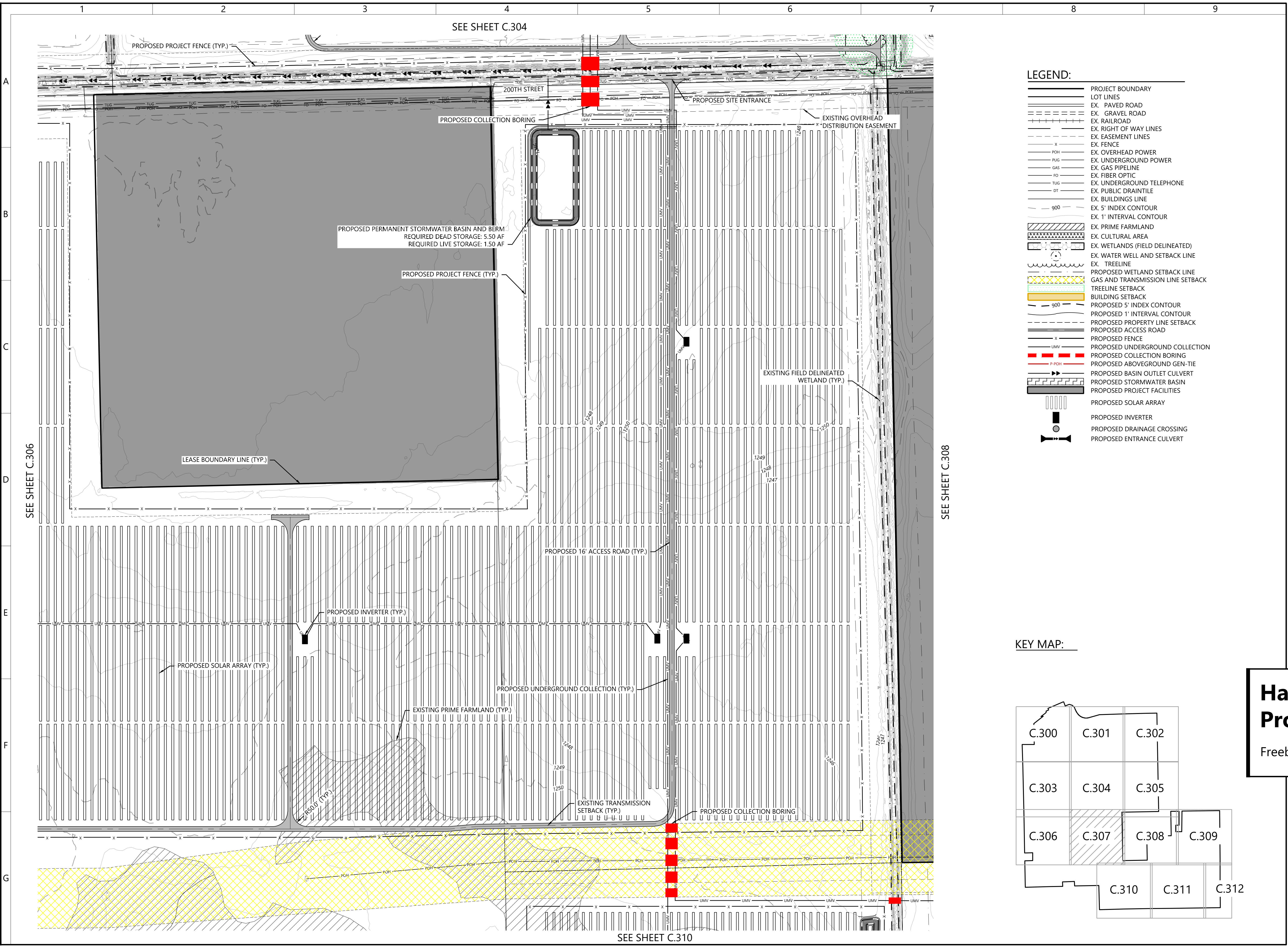

**LEGEND:**

- PROJECT BOUNDARY
- LOT LINES
- EX. PAVED ROAD
- EX. GRAVEL ROAD
- EX. RAILROAD
- EX. RIGHT OF WAY LINES
- EX. EASEMENT LINES
- EX. FENCE
- EX. OVERHEAD POWER
- EX. UNDERGROUND POWER
- EX. GAS PIPELINE
- EX. FIBER OPTIC
- EX. UNDERGROUND TELEPHONE
- EX. PUBLIC DRAIN TILE
- EX. BUILDINGS LINE
- EX. 5' INDEX CONTOUR
- EX. 1' INTERVAL CONTOUR
- EX. PRIME FARMLAND
- EX. CULTURAL AREA
- EX. WETLANDS (FIELD DELINEATED)
- EX. WATER WELL AND SETBACK LINE
- EX. TREELINE
- PROPOSED WETLAND SETBACK LINE
- GAS AND TRANSMISSION LINE SETBACK
- TREELINE SETBACK
- BUILDING SETBACK
- PROPOSED 5' INDEX CONTOUR
- PROPOSED 1' INTERVAL CONTOUR
- PROPOSED PROPERTY LINE SETBACK
- PROPOSED ACCESS ROAD
- PROPOSED FENCE
- PROPOSED UNDERGROUND COLLECTION
- PROPOSED COLLECTION BORING
- PROPOSED ABOVEGROUND GEN-TIE
- PROPOSED BASIN OUTLET CULVERT
- PROPOSED STORMWATER BASIN
- PROPOSED PROJECT FACILITIES
- PROPOSED SOLAR ARRAY
- PROPOSED INVERTER
- PROPOSED DRAINAGE CROSSING
- PROPOSED ENTRANCE CULVERT

**KEY MAP:**

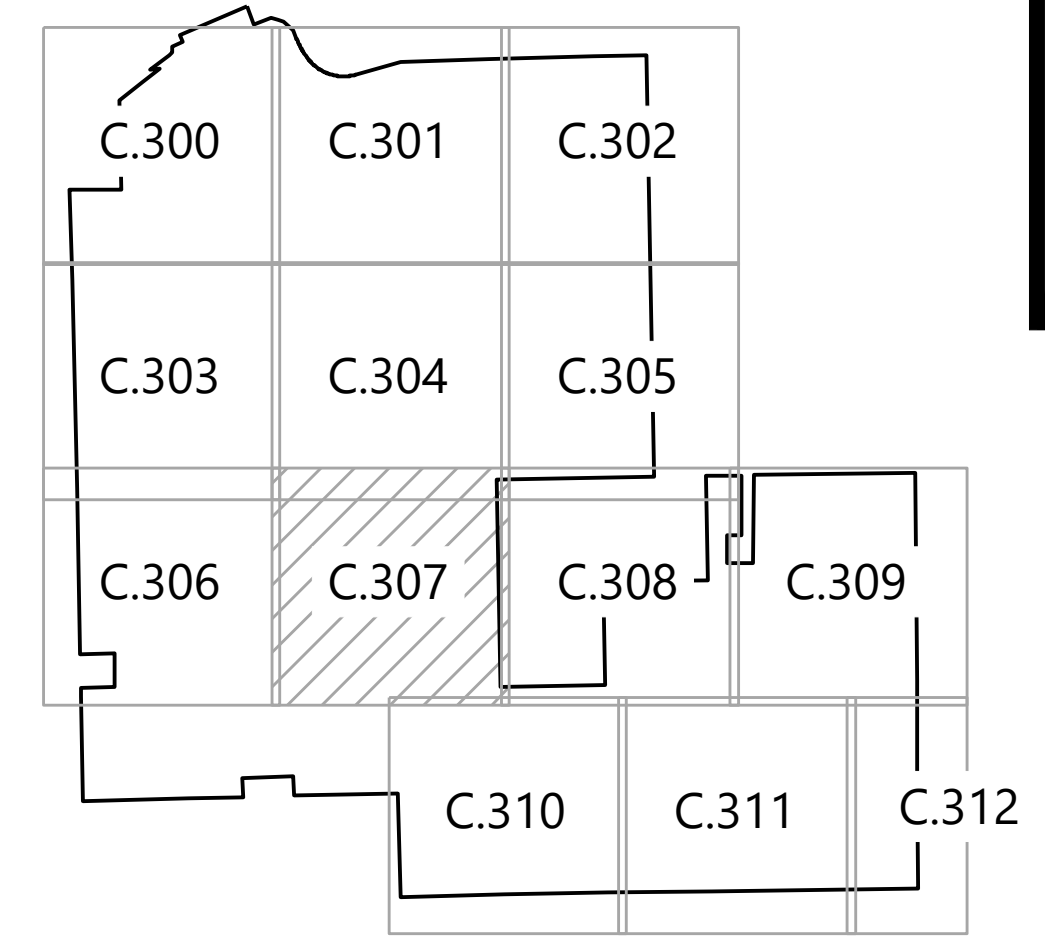

SEE SHEET C.310

03/19/2021 11:27 AM C:\Users\j... \Documents\HaywardSolar\SitePlan\031921\_SitePlan.dwg

PREPARED FOR:



10 East 53rd Street, 17th Floor  
New York, NY 10022

REVISIONS:

#	DATE	COMMENT
A	12/11/2020	DRAFT - Site Plan
B	01/29/2021	Preliminary Site Plan
C	03/19/2021	Preliminary Site Plan

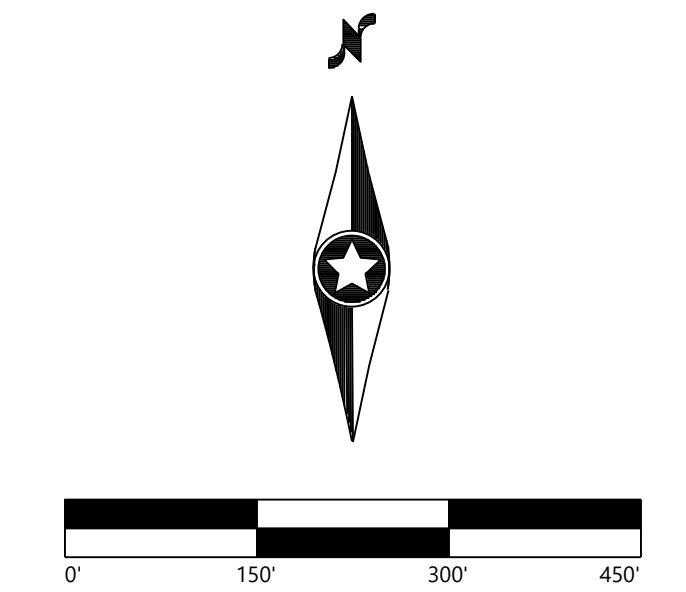

## Hayward Solar Project

Freeborn County, Minnesota

Site Plan

PRELIMINARY  
NOT FOR CONSTRUCTION

DATE: 03/19/2021

SHEET: C.308

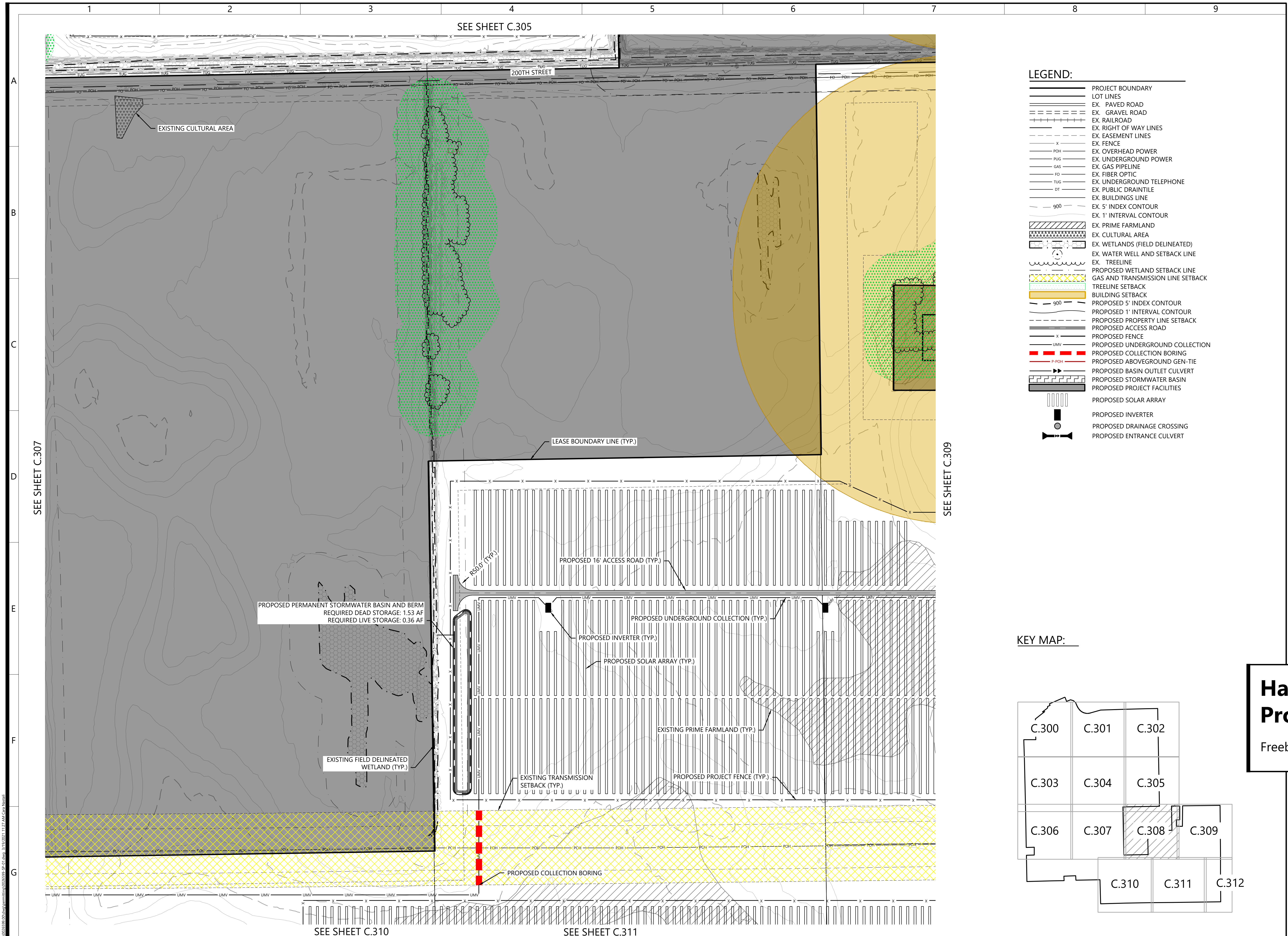

03/19/2021 11:27 AM C:\p\308.dwg

PREPARED FOR:



10 East 53rd Street, 17th Floor  
New York, NY 10022

REVISIONS:

#	DATE	COMMENT
A	12/11/2020	DRAFT - Site Plan
B	01/29/2021	Preliminary Site Plan
C	03/19/2021	Preliminary Site Plan

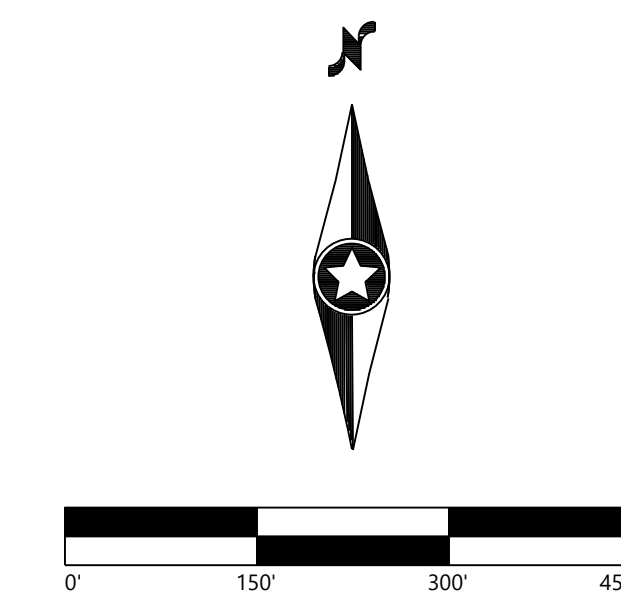

**LEGEND:**

- PROJECT BOUNDARY
- LOT LINES
- EX. PAVED ROAD
- EX. GRAVEL ROAD
- EX. RAILROAD
- EX. RIGHT OF WAY LINES
- EX. EASEMENT LINES
- EX. FENCE
- EX. OVERHEAD POWER
- EX. UNDERGROUND POWER
- EX. GAS PIPELINE
- EX. FIBER OPTIC
- EX. UNDERGROUND TELEPHONE
- EX. PUBLIC DRAINTILE
- EX. BUILDINGS LINE
- EX. 5' INDEX CONTOUR
- EX. 1' INTERVAL CONTOUR
- EX. PRIME FARMLAND
- EX. CULTURAL AREA
- EX. WETLANDS (FIELD DELINEATED)
- EX. WATER WELL AND SETBACK LINE
- EX. TREELINE
- PROPOSED WETLAND SETBACK LINE
- GAS AND TRANSMISSION LINE SETBACK
- TREELINE SETBACK
- BUILDING SETBACK
- PROPOSED 5' INDEX CONTOUR
- PROPOSED 1' INTERVAL CONTOUR
- PROPOSED PROPERTY LINE SETBACK
- PROPOSED ACCESS ROAD
- PROPOSED FENCE
- PROPOSED UNDERGROUND COLLECTION
- PROPOSED COLLECTION BORING
- PROPOSED ABOVEGROUND GEN-TIE
- PROPOSED BASIN OUTLET CULVERT
- PROPOSED STORMWATER BASIN
- PROPOSED PROJECT FACILITIES
- PROPOSED SOLAR ARRAY
- PROPOSED INVERTER
- PROPOSED DRAINAGE CROSSING
- PROPOSED ENTRANCE CULVERT

**KEY MAP:**

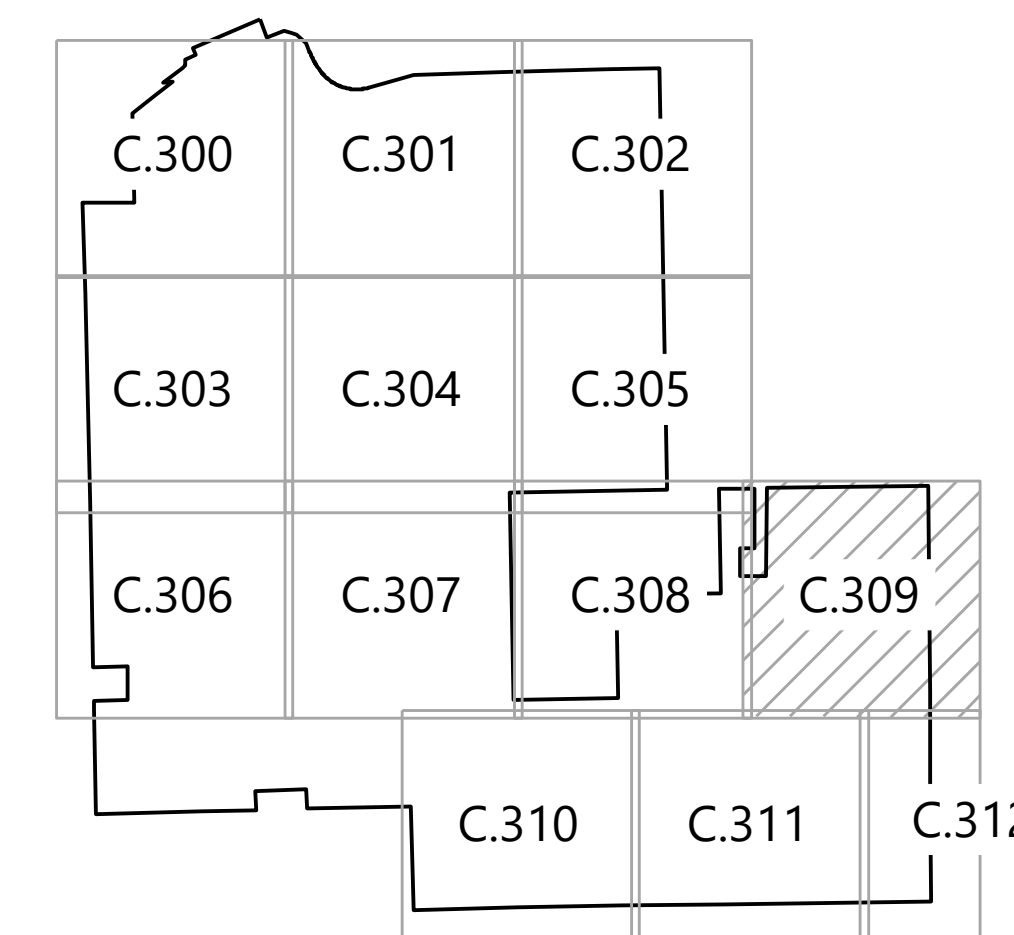

**Hayward Solar Project**

Freeborn County, Minnesota

Site Plan

**PRELIMINARY  
NOT FOR CONSTRUCTION**

DATE: 03/19/2021

SHEET: C.309

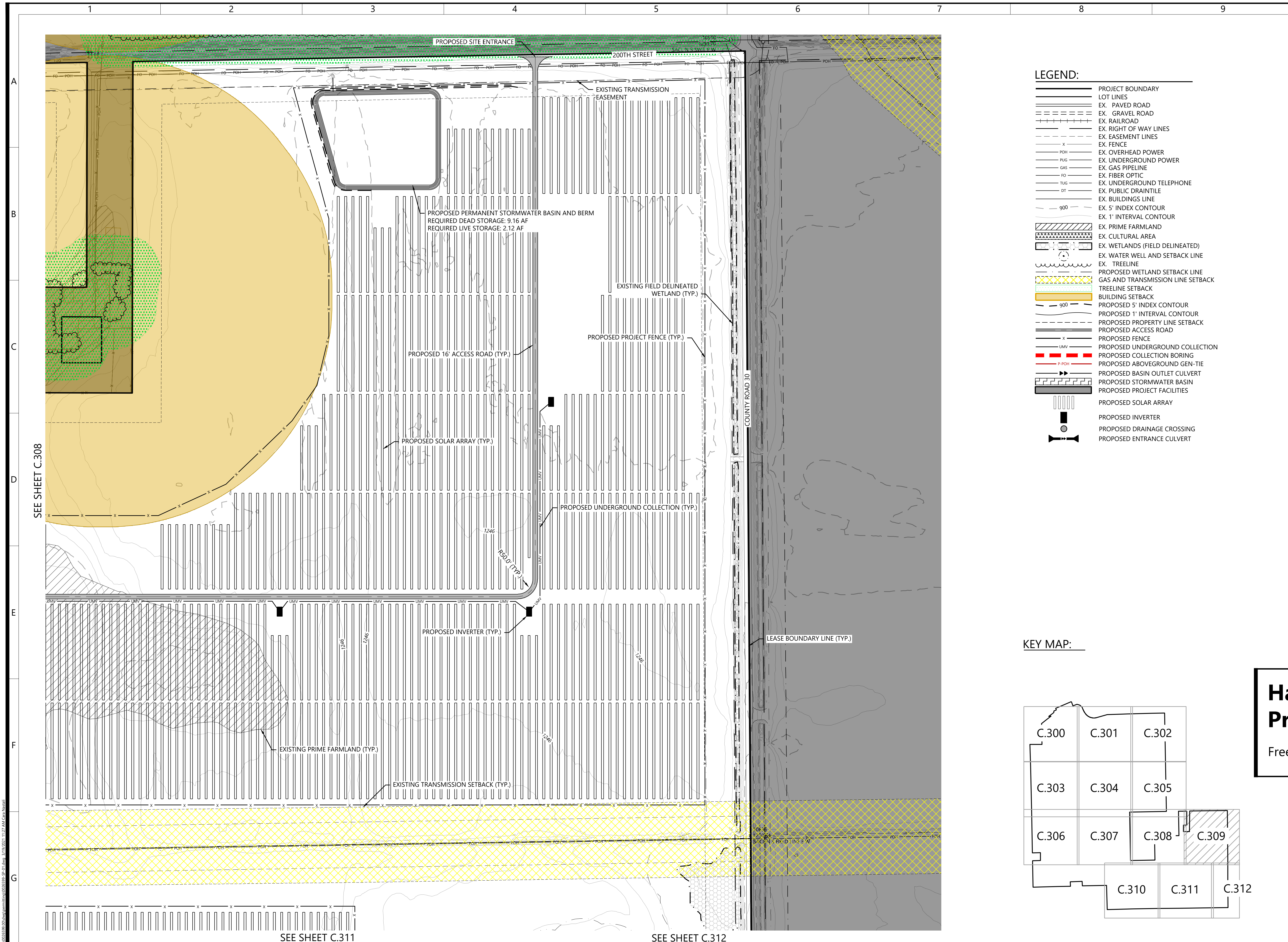

03/19/2021 11:27 AM C:\p\...

SEE SHEET C.311

SEE SHEET C.312

PREPARED FOR:



10 East 53rd Street, 17th Floor  
New York, NY 10022

REVISIONS:

#	DATE	COMMENT
A	12/11/2020	DRAFT - Site Plan
B	01/29/2021	Preliminary Site Plan
C	03/19/2021	Preliminary Site Plan

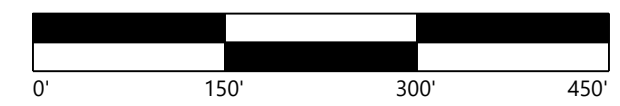

# Hayward Solar Project

Freeborn County, Minnesota

Site Plan

PRELIMINARY  
NOT FOR CONSTRUCTION

DATE: 03/19/2021

SHEET: C.310

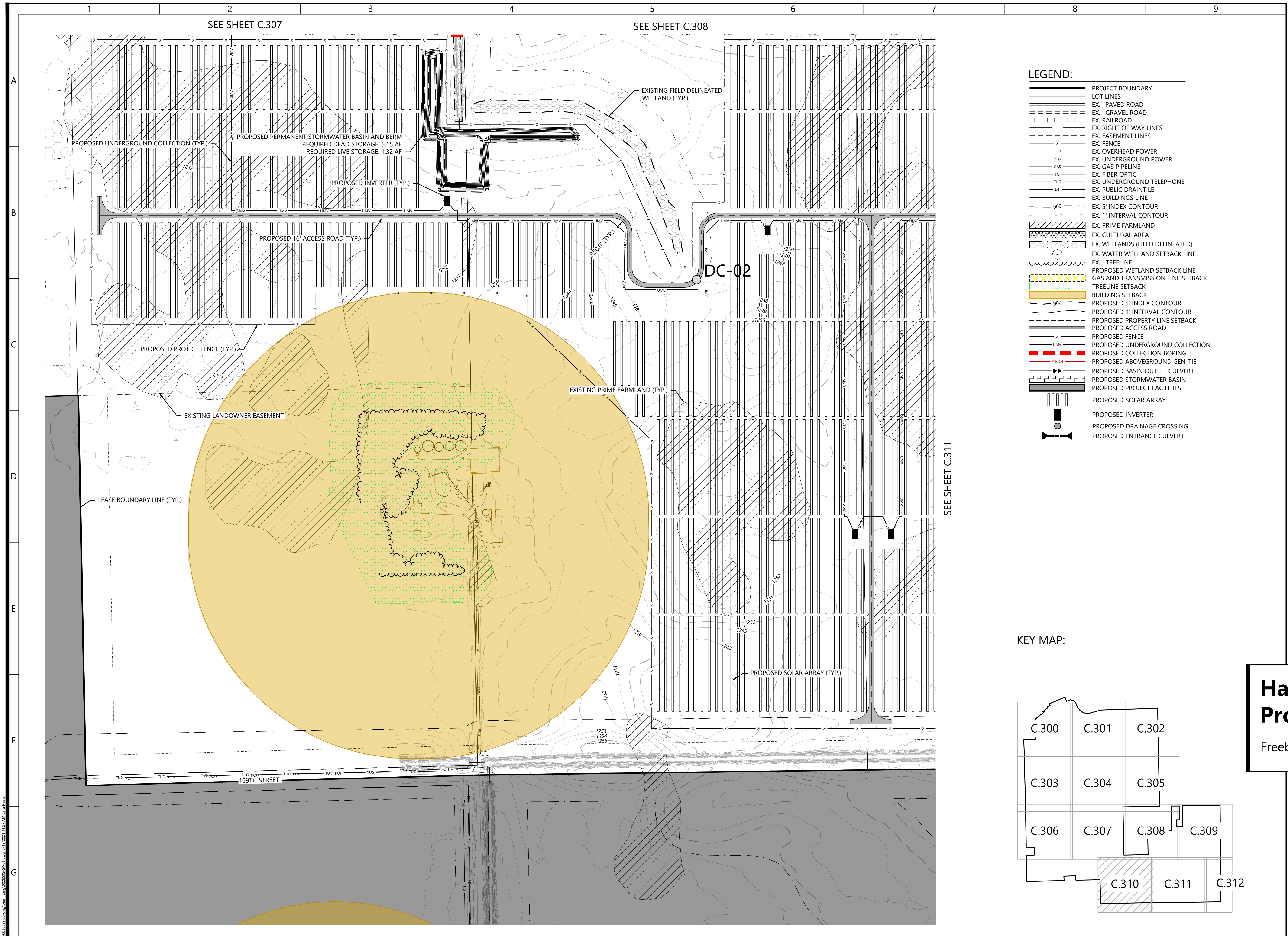

**LEGEND:**

- PROJECT BOUNDARY
- LOT LINES
- EX. PAVED ROAD
- EX. GRAVEL ROAD
- EX. RAILROAD
- EX. RIGHT OF WAY LINES
- EX. EASEMENT LINES
- EX. FENCE
- EX. OVERHEAD POWER
- EX. UNDERGROUND POWER
- EX. GAS PIPELINE
- EX. FIBER OPTIC
- EX. UNDERGROUND TELEPHONE
- EX. PUBLIC DRAIN TILE
- EX. BUILDINGS LINE
- EX. 5' INDEX CONTOUR
- EX. 1' INTERVAL CONTOUR
- EX. PRIME FARMLAND
- EX. CULTURAL AREA
- EX. WETLANDS (FIELD DELINEATED)
- EX. WATER WELL AND SETBACK LINE
- EX. TREELINE
- PROPOSED WETLAND SETBACK LINE
- GAS AND TRANSMISSION LINE SETBACK
- TREELINE SETBACK
- BUILDING SETBACK
- PROPOSED 5' INDEX CONTOUR
- PROPOSED 1' INTERVAL CONTOUR
- PROPOSED PROPERTY LINE SETBACK
- PROPOSED ACCESS ROAD
- PROPOSED FENCE
- PROPOSED UNDERGROUND COLLECTION
- PROPOSED COLLECTION BORING
- PROPOSED ABOVEGROUND GEN-TIE
- PROPOSED BASIN OUTLET CULVERT
- PROPOSED STORMWATER BASIN
- PROPOSED PROJECT FACILITIES
- PROPOSED SOLAR ARRAY
- PROPOSED INVERTER
- PROPOSED DRAINAGE CROSSING
- PROPOSED ENTRANCE CULVERT

**KEY MAP:**

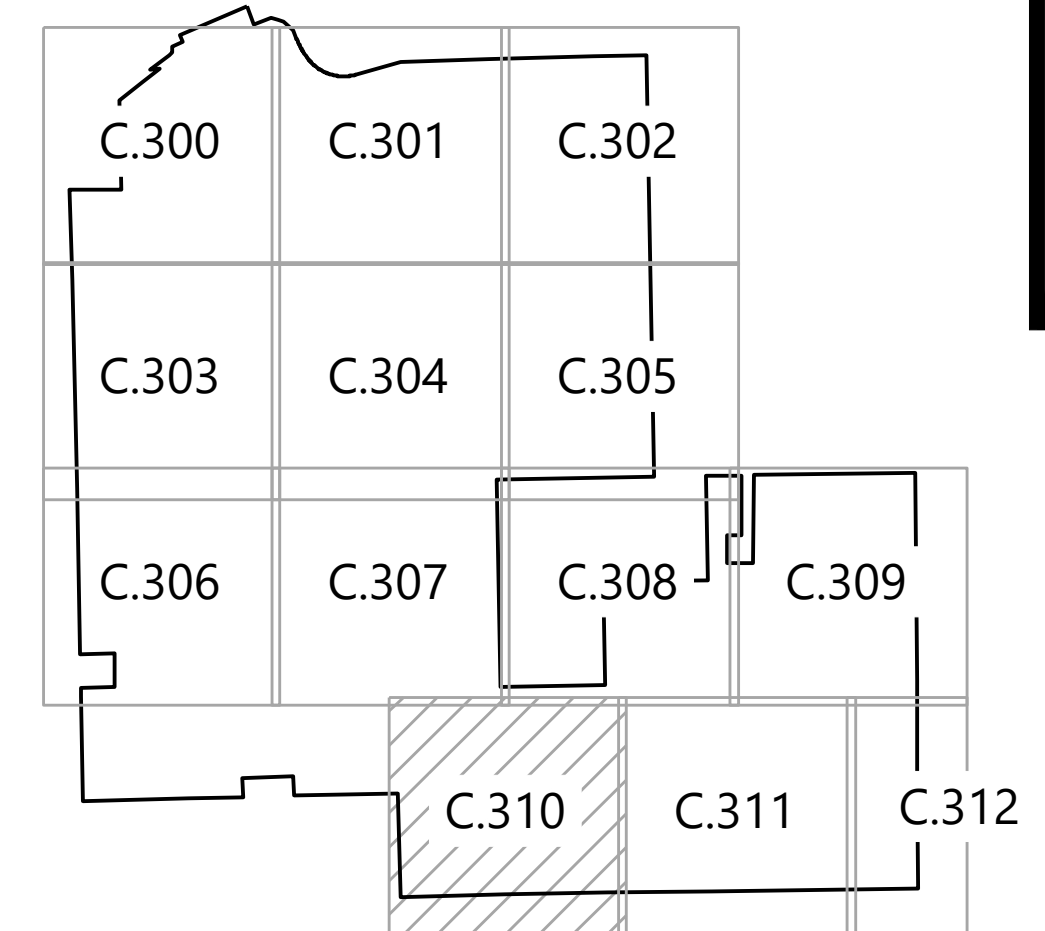

03/25/2021 11:27 AM C:\Users\j... \Documents\030309.sp-01.dwg

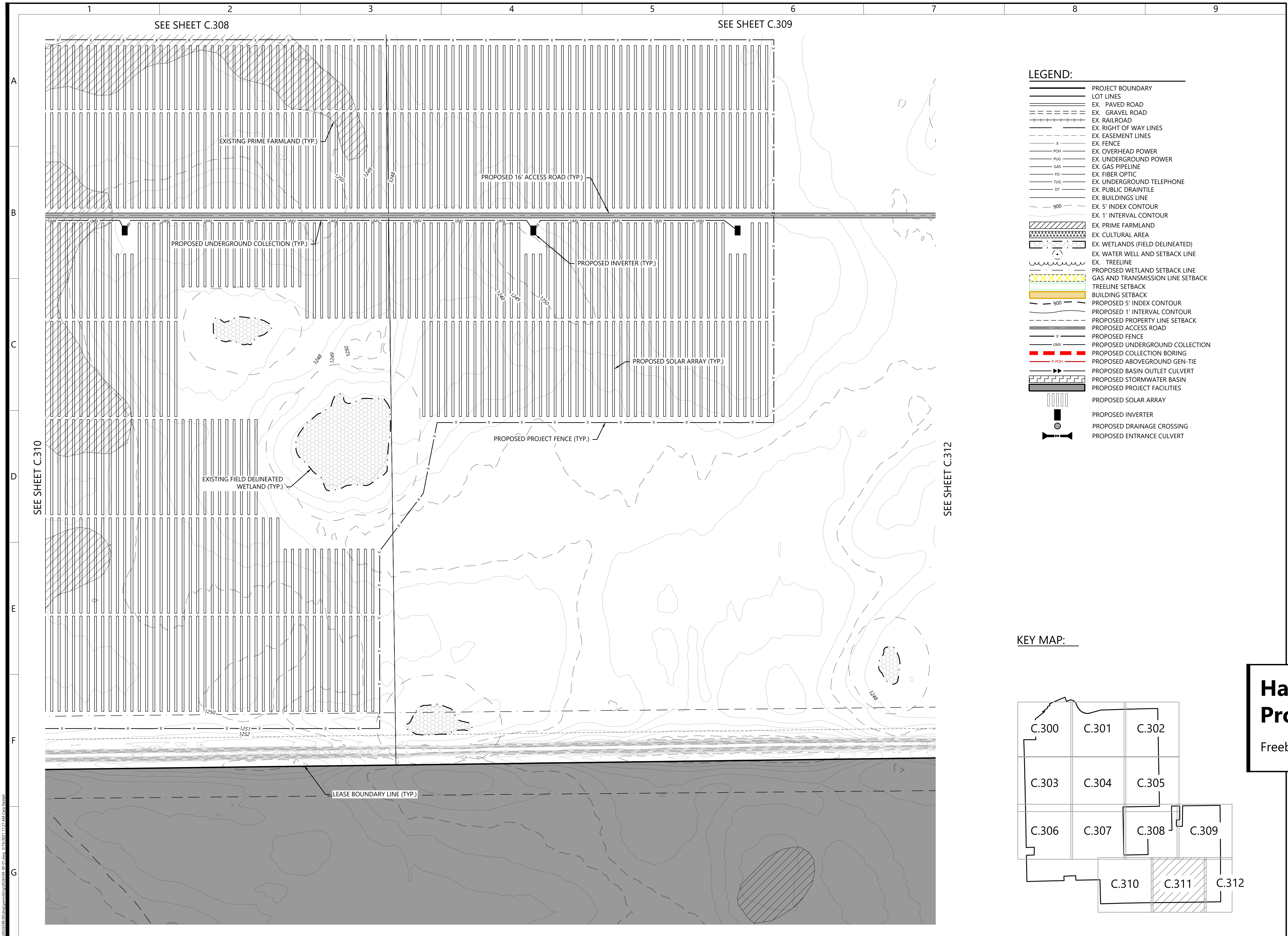

PREPARED FOR:



10 East 53rd Street, 17th Floor  
New York, NY 10022

REVISIONS:

#	DATE	COMMENT
A	12/11/2020	DRAFT - Site Plan
B	01/29/2021	Preliminary Site Plan
C	03/19/2021	Preliminary Site Plan

- LEGEND:**
- PROJECT BOUNDARY
  - LOT LINES
  - EX. PAVED ROAD
  - EX. GRAVEL ROAD
  - EX. RAILROAD
  - EX. RIGHT OF WAY LINES
  - EX. EASEMENT LINES
  - EX. FENCE
  - EX. OVERHEAD POWER
  - EX. UNDERGROUND POWER
  - EX. GAS PIPELINE
  - EX. FIBER OPTIC
  - EX. UNDERGROUND TELEPHONE
  - EX. PUBLIC DRAIN TILE
  - EX. BUILDINGS LINE
  - EX. 5' INDEX CONTOUR
  - EX. 1' INTERVAL CONTOUR
  - EX. PRIME FARMLAND
  - EX. CULTURAL AREA
  - EX. WETLANDS (FIELD DELINEATED)
  - EX. WATER WELL AND SETBACK LINE
  - EX. TREELINE
  - PROPOSED WETLAND SETBACK LINE
  - GAS AND TRANSMISSION LINE SETBACK
  - TREELINE SETBACK
  - BUILDING SETBACK
  - PROPOSED 5' INDEX CONTOUR
  - PROPOSED 1' INTERVAL CONTOUR
  - PROPOSED PROPERTY LINE SETBACK
  - PROPOSED ACCESS ROAD
  - PROPOSED FENCE
  - PROPOSED UNDERGROUND COLLECTION
  - PROPOSED COLLECTION BORING
  - PROPOSED ABOVEGROUND GEN-TIE
  - PROPOSED BASIN OUTLET CULVERT
  - PROPOSED STORMWATER BASIN
  - PROPOSED PROJECT FACILITIES
  - PROPOSED SOLAR ARRAY
  - PROPOSED INVERTER
  - PROPOSED DRAINAGE CROSSING
  - PROPOSED ENTRANCE CULVERT

KEY MAP:

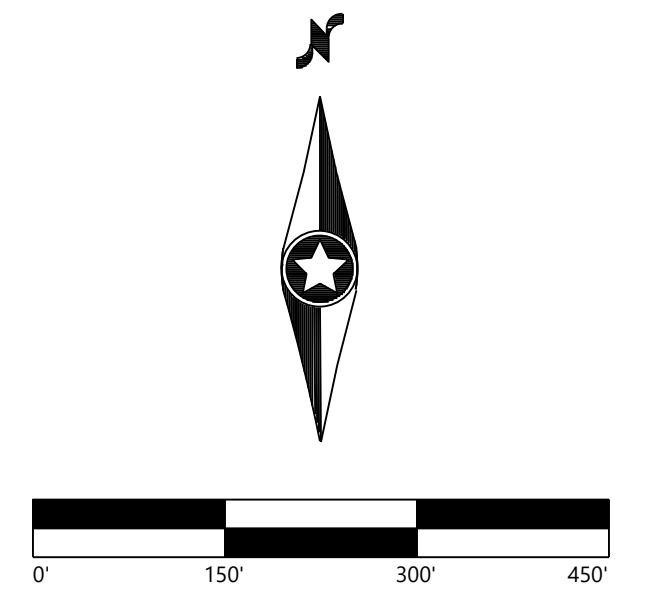
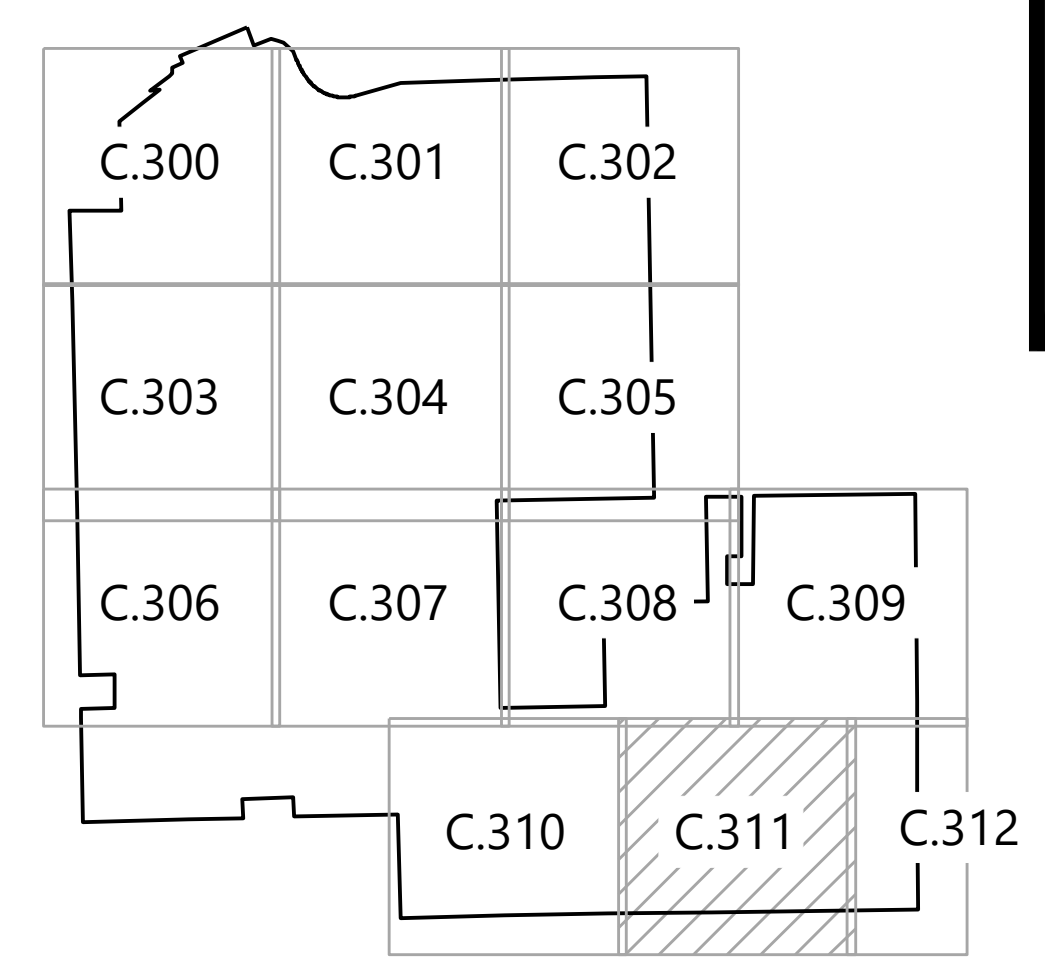

# Hayward Solar Project

Freeborn County, Minnesota

Site Plan

**PRELIMINARY  
NOT FOR CONSTRUCTION**

DATE: 03/19/2021

SHEET: **C.311**

03/19/2021 11:27 AM C:\a\311.dwg

SEE SHEET C.309

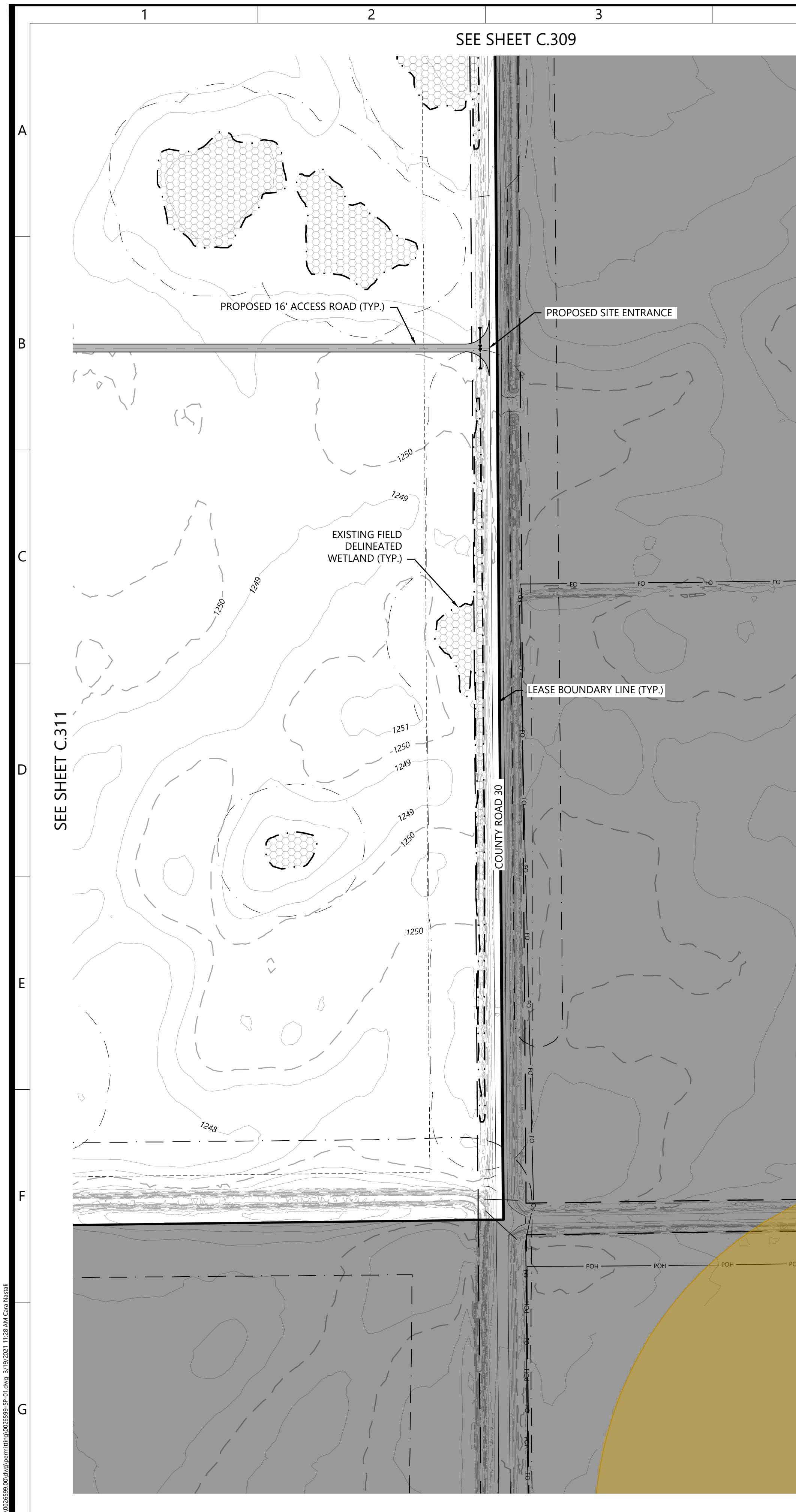

**LEGEND:**

- PROJECT BOUNDARY
- LOT LINES
- EX. PAVED ROAD
- EX. GRAVEL ROAD
- EX. RAILROAD
- EX. RIGHT OF WAY LINES
- EX. EASEMENT LINES
- EX. FENCE
- EX. OVERHEAD POWER
- EX. UNDERGROUND POWER
- EX. GAS PIPELINE
- EX. FIBER OPTIC
- EX. UNDERGROUND TELEPHONE
- EX. PUBLIC DRAIN TILE
- EX. BUILDINGS LINE
- EX. 5' INDEX CONTOUR
- EX. 1' INTERVAL CONTOUR
- EX. PRIME FARMLAND
- EX. CULTURAL AREA
- EX. WETLANDS (FIELD DELINEATED)
- EX. WATER WELL AND SETBACK LINE
- EX. TREELINE
- PROPOSED WETLAND SETBACK LINE
- GAS AND TRANSMISSION LINE SETBACK
- TREELINE SETBACK
- BUILDING SETBACK
- PROPOSED 5' INDEX CONTOUR
- PROPOSED 1' INTERVAL CONTOUR
- PROPOSED PROPERTY LINE SETBACK
- PROPOSED ACCESS ROAD
- PROPOSED FENCE
- PROPOSED UNDERGROUND COLLECTION
- PROPOSED COLLECTION BORING
- PROPOSED ABOVEGROUND GEN-TIE
- PROPOSED BASIN OUTLET CULVERT
- PROPOSED STORMWATER BASIN
- PROPOSED PROJECT FACILITIES
- PROPOSED SOLAR ARRAY
- PROPOSED INVERTER
- PROPOSED DRAINAGE CROSSING
- PROPOSED ENTRANCE CULVERT

**KEY MAP:**

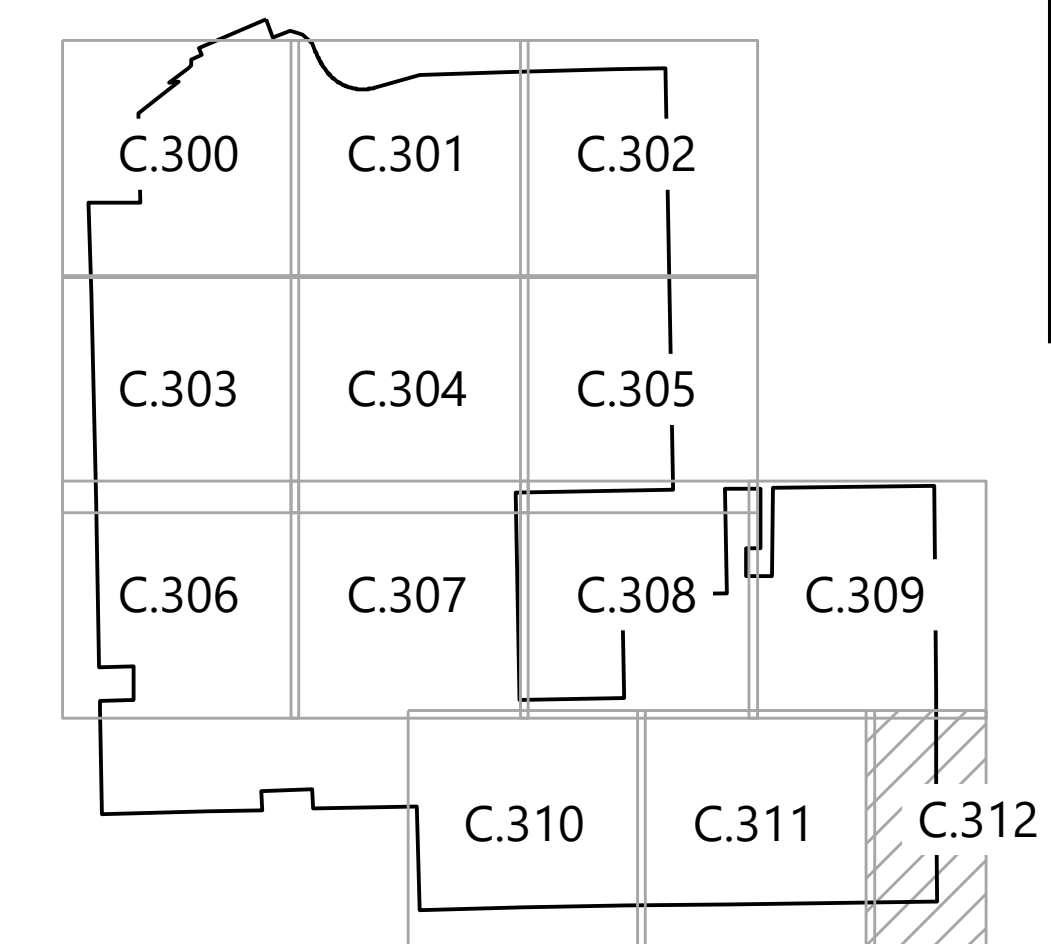

**Westwood**

Phone (608) 821-6600 8401 Greenway Blvd., Suite 400  
Middleton, WI 53562  
westwoodps.com

Westwood Professional Services, Inc.

PREPARED FOR:

**CapitalDynamics**  
TRULY INVESTED.

10 East 53rd Street, 17th Floor  
New York, NY 10022

REVISIONS:

#	DATE	COMMENT
A	12/11/2020	DRAFT - Site Plan
B	01/29/2021	Preliminary Site Plan
C	03/19/2021	Preliminary Site Plan

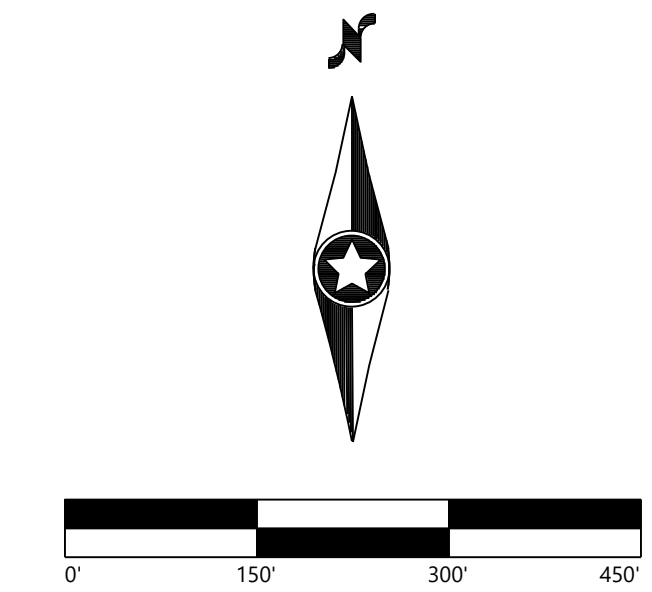

**Hayward Solar Project**

Freeborn County, Minnesota

Site Plan

**PRELIMINARY  
NOT FOR CONSTRUCTION**

DATE: 03/19/2021

SHEET: C.312

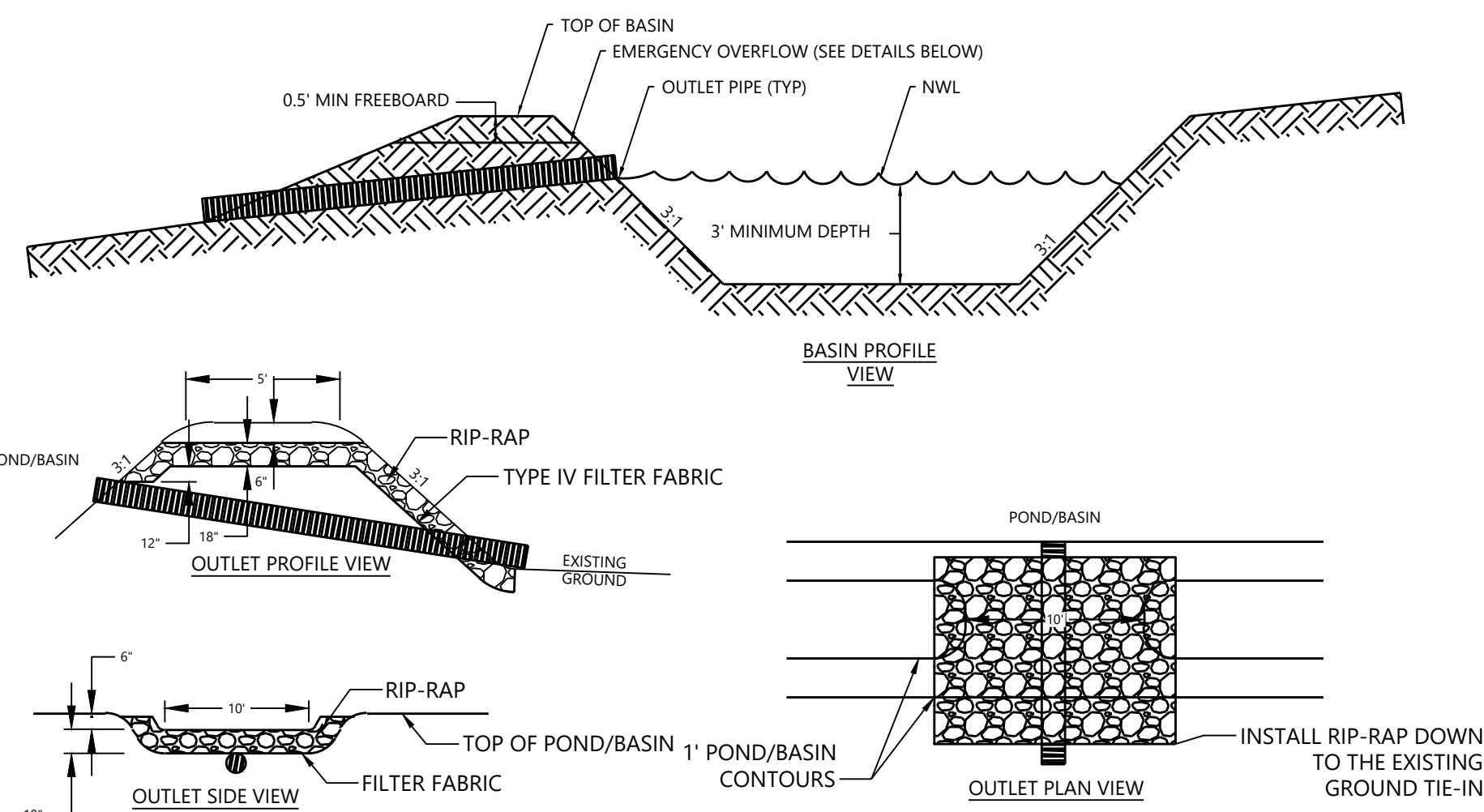

- NOTES:
1. OUTLET PIPE SHALL BE CORRUGATED PE SMOOTH INTERIOR PIPE MITERED TO CONFORM TO FILL REQUIREMENT
  2. SEE PLAN SHEET FOR OUTLET ELEVATION AND STORAGE REQUIREMENT

Westwood WET SEDIMENTATION BASIN & LIVE STORAGE BERM (NOT TO SCALE) GD06

- NOTES:
1. FIBER ROLLS SHALL BE INSTALLED PRIOR TO UPSLOPE DISTURBANCE ACTIVITIES COMMENCE.
  2. FIBER ROLLS SHALL BE PREFABRICATED AND MADE FROM WEED FREE RICE STRAW, FLAX, OR A SIMILAR AGRICULTURAL MATERIAL BOUND INTO A TIGHT TUBULAR ROLL BY NETTING. USE A 6" OR 12" DIA. ROLL.
  3. TRENCHES SHALL BE CREATED ALONG THE SLOPE OF THE PERIMETER. THE TRENCH DEPTH SHOULD BE 1/4 TO 1/3 OF THE THICKNESS OF THE ROLL, AND THE WIDTH SHOULD EQUAL THE ROLL DIAMETER, IN ORDER TO PROVIDE AREA TO BACKFILL THE TRENCH.
  4. STAKE FIBER ROLLS INTO THE TRENCH. DRIVE STAKES AT THE END OF EACH FIBER ROLL AND SPACED 4 FEET MAXIMUM ON CENTER. USE WOOD STAKES WITH NOMINAL CLASSIFICATION OF 0.75 IN BY 0.75 IN. AND A MINIMUM LENGTH OF 24 IN.
  5. ROLLS SHALL BE INSTALLED PERPENDICULAR TO WATER MOVEMENT, AND PARALLEL TO THE SLOPE CONTOUR.
  6. TURN THE ENDS OF THE FIBER ROLLS UP SLOPE TO PREVENT RUNOFF FROM GOING AROUND THE ROLL. THE UPSLOPE POINT SHOULD BE A MINIMUM 6" HIGHER IN ELEVATION THAN THE LOW POINT.
  7. IF MORE THAN ONE FIBER ROLL IS PLACED IN A ROW, THE ROLLS SHOULD BE OVERLAPPED A MINIMUM OF 6 INCHES, NOT ABUTTED.
  8. FIBER ROLLS ENCASED WITH PLASTIC NETTING ARE USED FOR A TEMPORARY APPLICATION ONLY AND SHOULD BE REMOVED FOLLOWING STABILIZATION. FIBER ROLLS USED IN A PERMANENT APPLICATION SHALL BE ENCASED WITH A BIODEGRADABLE MATERIAL AND MAY BE LEFT IN.
  9. TEMPORARY INSTALLATIONS SHOULD ONLY BE REMOVED WHEN UP GRADIENT AREAS ARE STABILIZED PER GENERAL PERMIT REQUIREMENTS, AND/OR POLLUTANT SOURCES NO LONGER PRESENT A HAZARD. BUT, THEY SHOULD ALSO BE REMOVED BEFORE VEGETATION BECOMES TOO MATURE SO THAT THE REMOVAL PROCESS DOES NOT DISTURB MORE SOIL AND VEGETATION THAN IS NECESSARY.
  10. FIBER ROLLS MUST BE INSPECTED IN ACCORDANCE WITH GENERAL PERMIT REQUIREMENTS FOR THE ASSOCIATED PROJECT TYPE AND RISK LEVEL. IT IS RECOMMENDED THAT AT A MINIMUM, THE BMPs BE INSPECTED WEEKLY, PRIOR TO FORECASTED RAIN EVENTS, DAILY DURING EXTENDED RAIN EVENTS, AND AFTER THE CONCLUSION OF RAIN EVENTS.
  11. REPAIR OR REPLACE SPLIT, TORN, UNRAVELING, OR SLUMPING FIBER ROLLS.
  12. SEDIMENT THAT ACCUMULATES UPSLOPE OF THE BMP SHOULD BE PERIODICALLY REMOVED IN ORDER TO MAINTAIN BMP EFFECTIVENESS. SEDIMENT SHOULD BE REMOVED WHEN SEDIMENT ACCUMULATION REACHES ONE-THIRD THE DESIGNATED SEDIMENT STORAGE DEPTH.
  14. RILLS OR GULLIES MAY BEGIN TO FORM FOLLOWING MAJOR STORM EVENTS WHERE RUNOFF HAS OVERTOPPED THE FIBER ROLLS. THESE RILLS OR GULLIES SHOULD BE PROMPTLY REPAIRED.

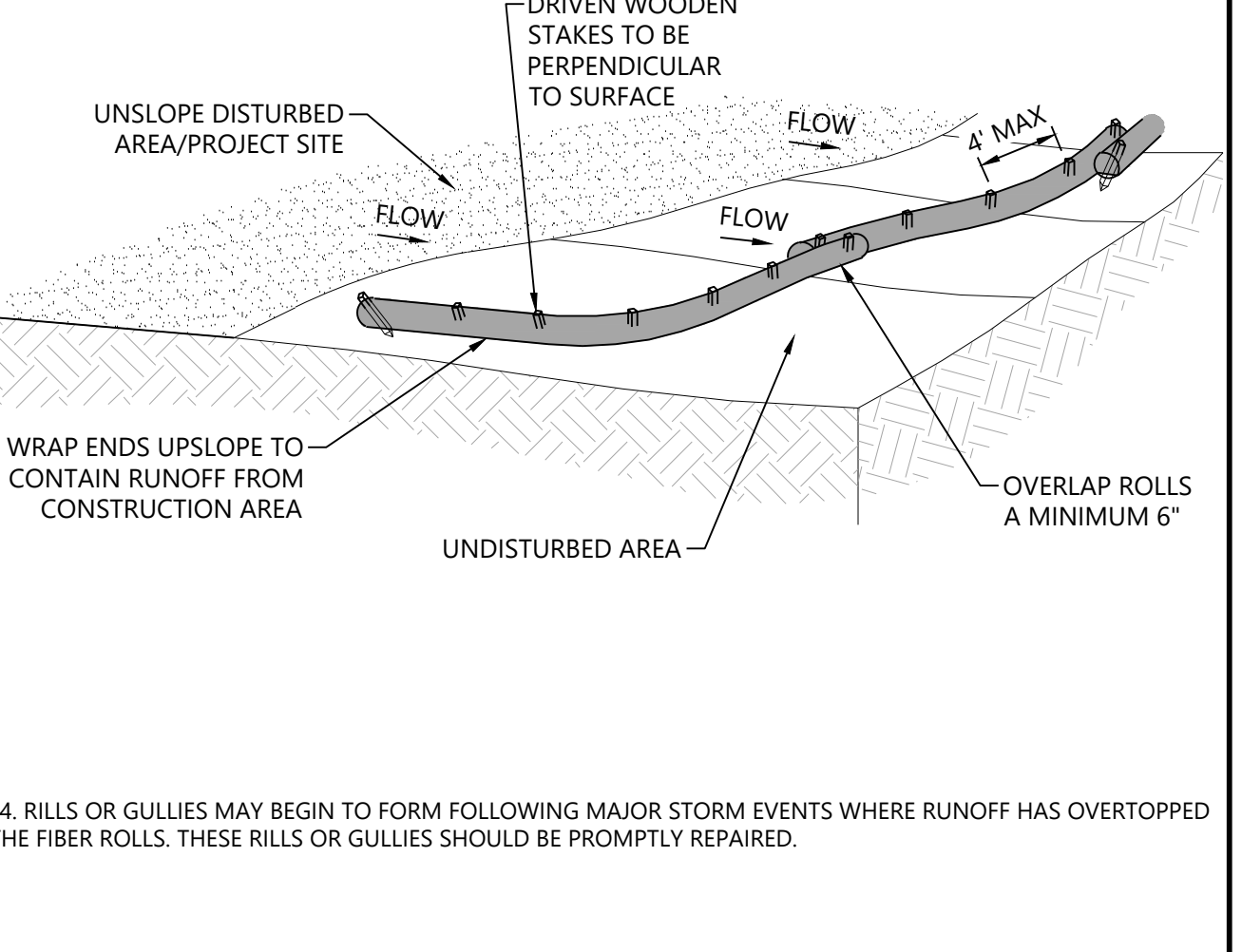

Westwood TYPICAL FIBER ROLLS FOR PERIMETER CONTROL OF CONSTRUCTION AREA LIMIT (NOT TO SCALE) GD42

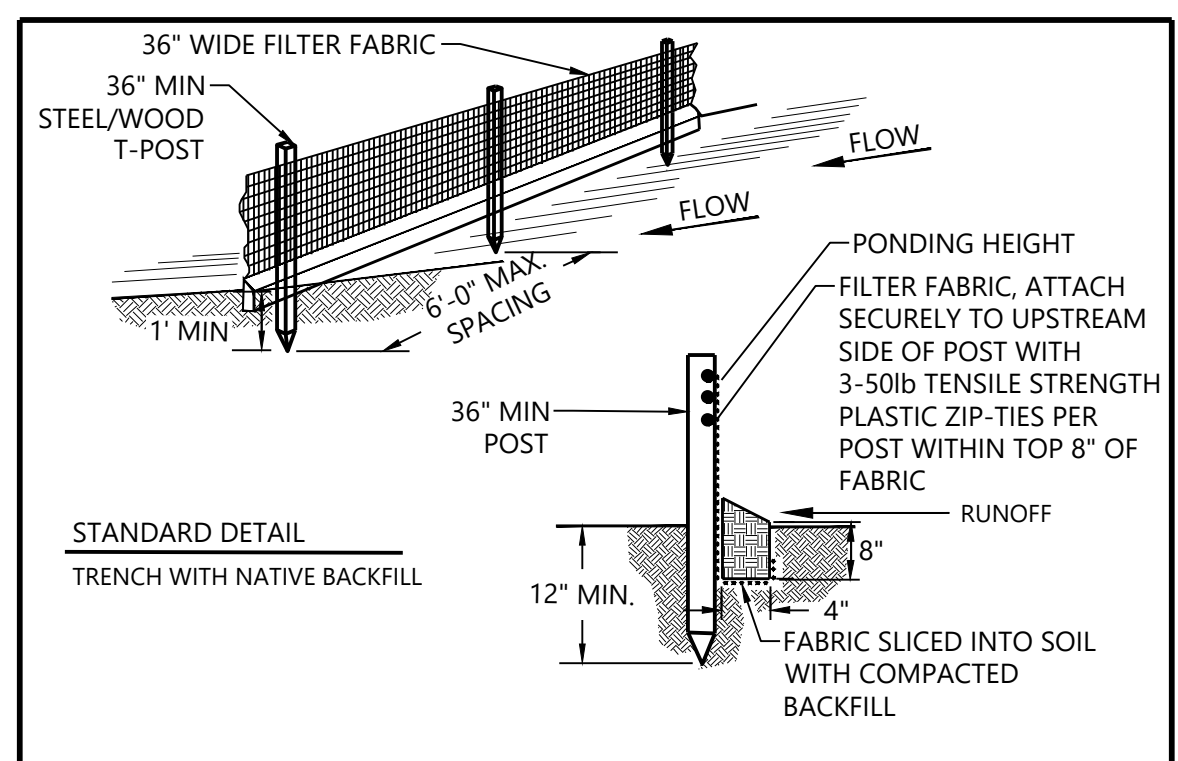

- NOTES:
1. INSPECT AND REPAIR FENCE AFTER EACH STORM EVENT AND REMOVE SEDIMENT WHEN ACCUMULATED TO 1/3 THE HEIGHT OF THE FABRIC OR MORE.
  2. REMOVED SEDIMENT SHALL BE DEPOSITED TO AN AREA THAT WILL NOT CONTRIBUTE SEDIMENT OFF-SITE AND CAN BE PERMANENTLY STABILIZED.
  3. SILT FENCE SHALL BE PLACED ON SLOPE CONTOURS TO MAXIMIZE PONDING EFFICIENCY.
  4. ALL ENDS OF THE SILT FENCE SHALL BE WRAPPED UPSLOPE SO THE ELEVATION OF THE BOTTOM OF FABRIC IS HIGHER THAN "PONDING HEIGHT".

Westwood SILT FENCE (NOT TO SCALE) GD50

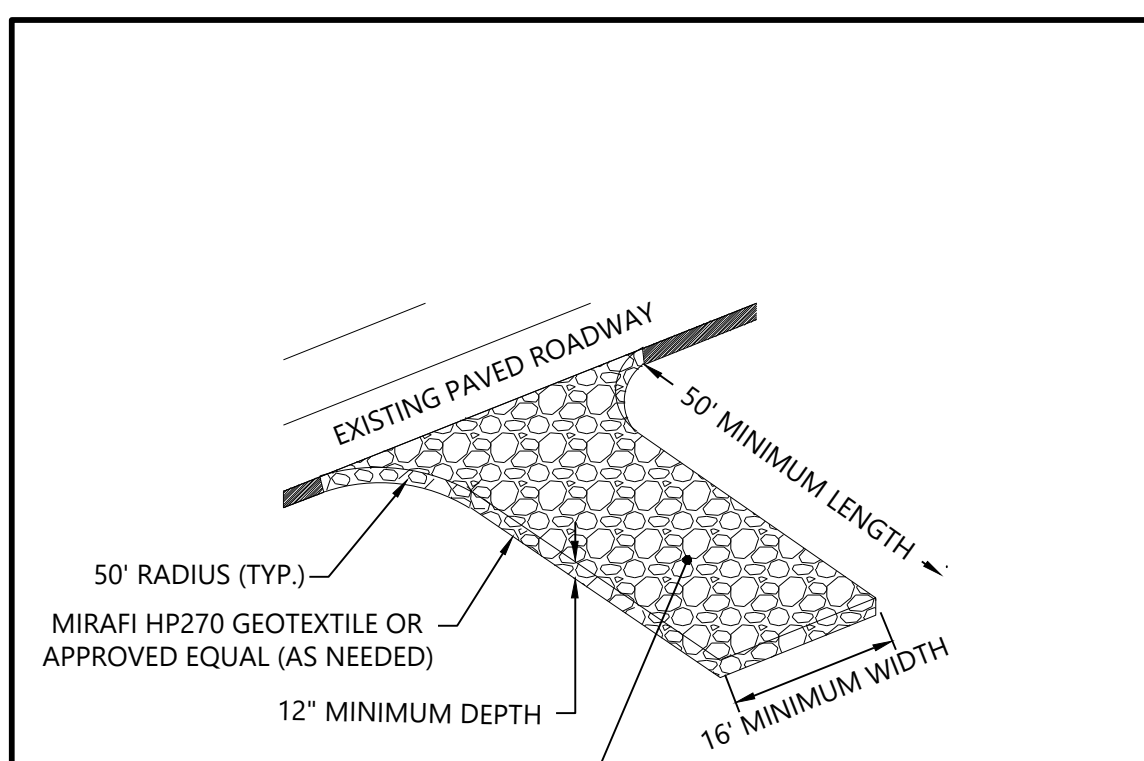

- NOTES:
1. ROCK CONSTRUCTION ENTRANCE SHOULD CONTAIN MAXIMUM SIDE SLOPES OF 4:1.
  2. ROCK ENTRANCE SHOULD BE INSPECTED AND MAINTAINED REGULARLY. ROCK ENTRANCE LENGTH MAY NEED TO BE EXTENDED IN CLAY SOILS.

Westwood ROCK CONSTRUCTION ENTRANCE (NOT TO SCALE) GD05

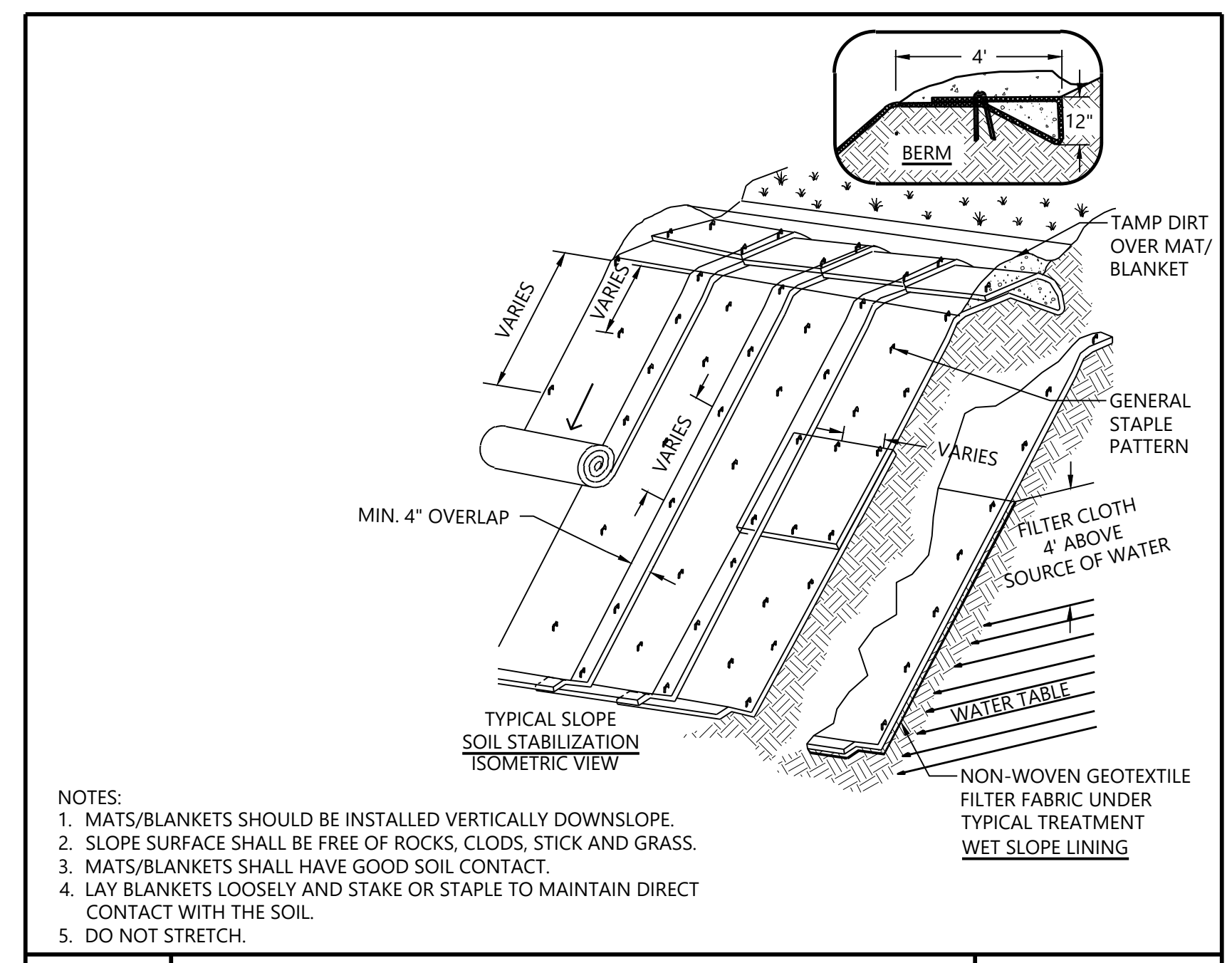

- NOTES:
1. MATS/BLANKETS SHOULD BE INSTALLED VERTICALLY DOWNSLOPE.
  2. SLOPE SURFACE SHALL BE FREE OF ROCKS, CLODS, STICK AND GRASS.
  3. MATS/BLANKETS SHALL HAVE GOOD SOIL CONTACT.
  4. LAY BLANKETS LOOSELY AND STAKE OR STAPLE TO MAINTAIN DIRECT CONTACT WITH THE SOIL.
  5. DO NOT STRETCH.

Westwood TEMPORARY EROSION BLANKETS TURF REINFORCEMENT MATS FOR SLOPE (NOT TO SCALE) GD22

PREPARED FOR:



10 East 53rd Street, 17th Floor  
New York, NY 10022

REVISIONS:

#	DATE	COMMENT
A	12/11/2020	DRAFT - Site Plan
B	01/29/2021	Preliminary Site Plan
C	03/19/2021	Preliminary Site Plan

# Hayward Solar Project

Freeborn County, Minnesota

## Construction Details

PRELIMINARY  
NOT FOR CONSTRUCTION

DATE: 03/19/2021

SHEET: C.400

02025598.DWG/02025598.dwg 3/19/2021 11:28 AM C:\Users\...

PREPARED FOR:



10 East 53rd Street, 17th Floor  
New York, NY 10022

REVISIONS:

#	DATE	COMMENT
A	12/11/2020	DRAFT - Site Plan
B	01/29/2021	Preliminary Site Plan
C	03/19/2021	Preliminary Site Plan

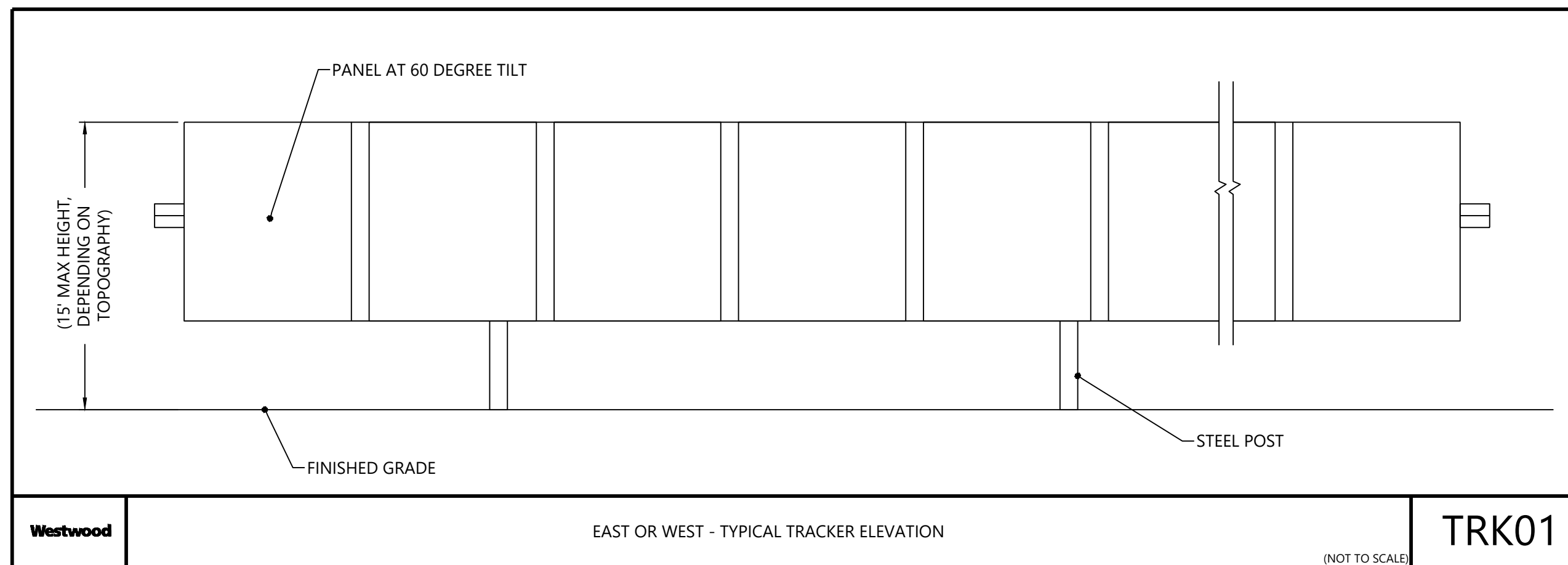

Westwood EAST OR WEST - TYPICAL TRACKER ELEVATION (NOT TO SCALE) **TRK01**

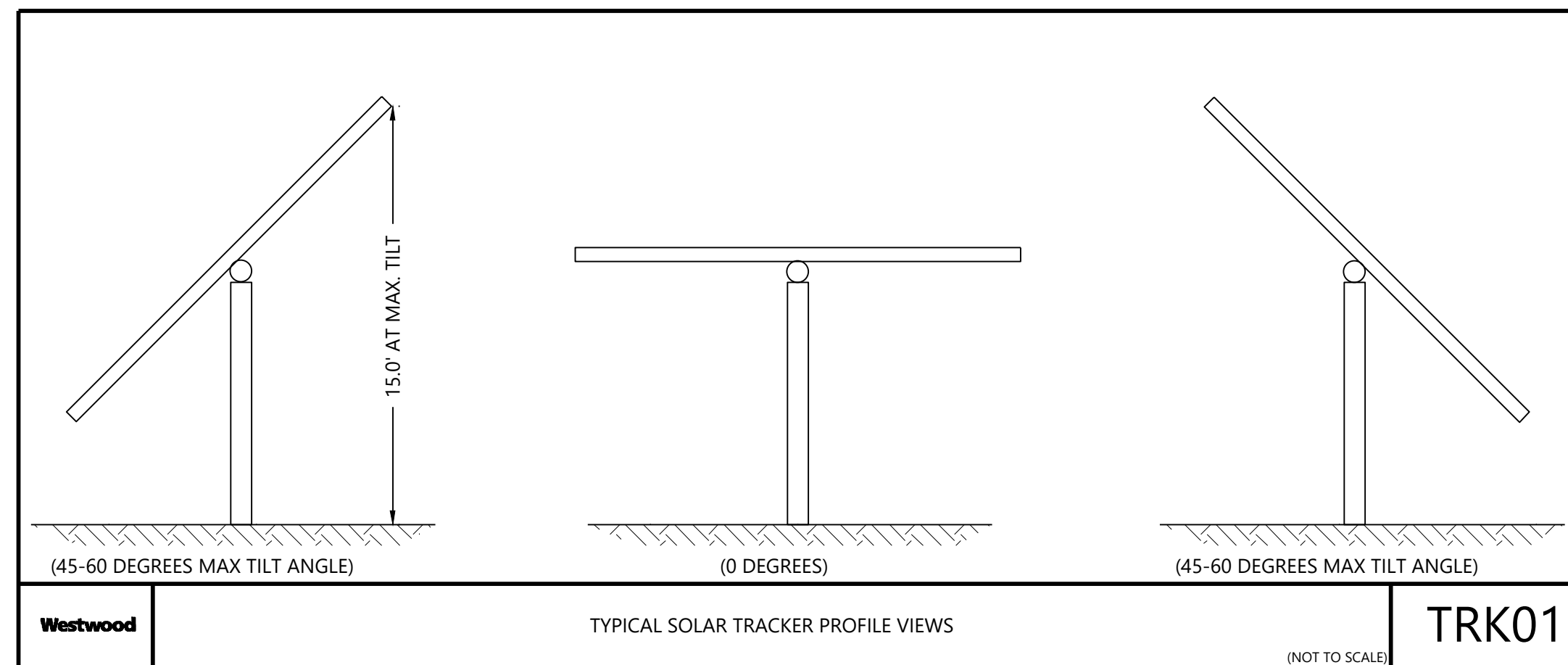

Westwood TYPICAL SOLAR TRACKER PROFILE VIEWS (NOT TO SCALE) **TRK01**

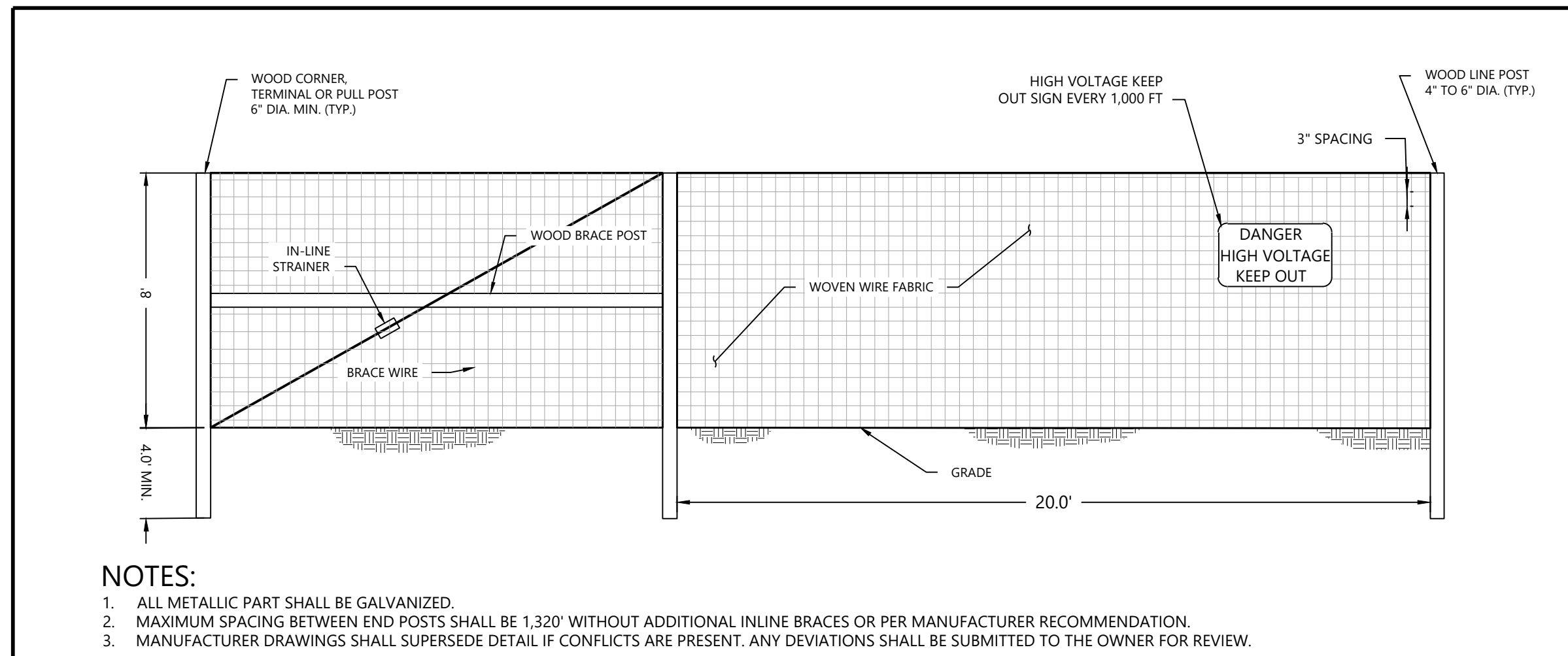

- NOTES:
1. ALL METALLIC PART SHALL BE GALVANIZED.
  2. MAXIMUM SPACING BETWEEN END POSTS SHALL BE 1,320' WITHOUT ADDITIONAL INLINE BRACES OR PER MANUFACTURER RECOMMENDATION.
  3. MANUFACTURER DRAWINGS SHALL SUPERSEDE DETAIL IF CONFLICTS ARE PRESENT. ANY DEVIATIONS SHALL BE SUBMITTED TO THE OWNER FOR REVIEW.

Westwood TYPICAL AGRICULTURAL FENCE DETAIL (NOT TO SCALE) **FN01**

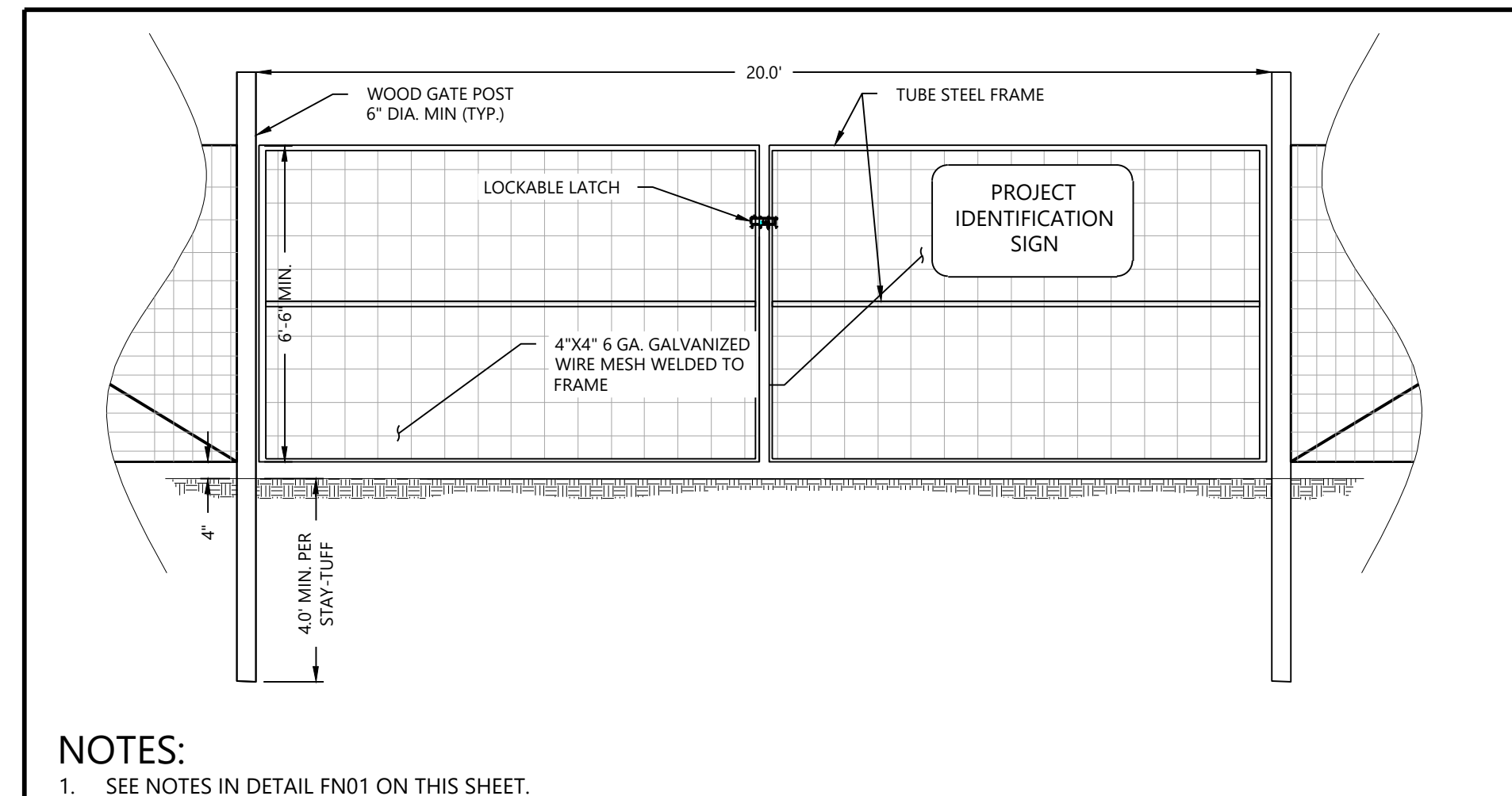

- NOTES:
1. SEE NOTES IN DETAIL FN01 ON THIS SHEET.

Westwood TYPICAL AGRICULTURE SWING GATE (NOT TO SCALE) **FN02**

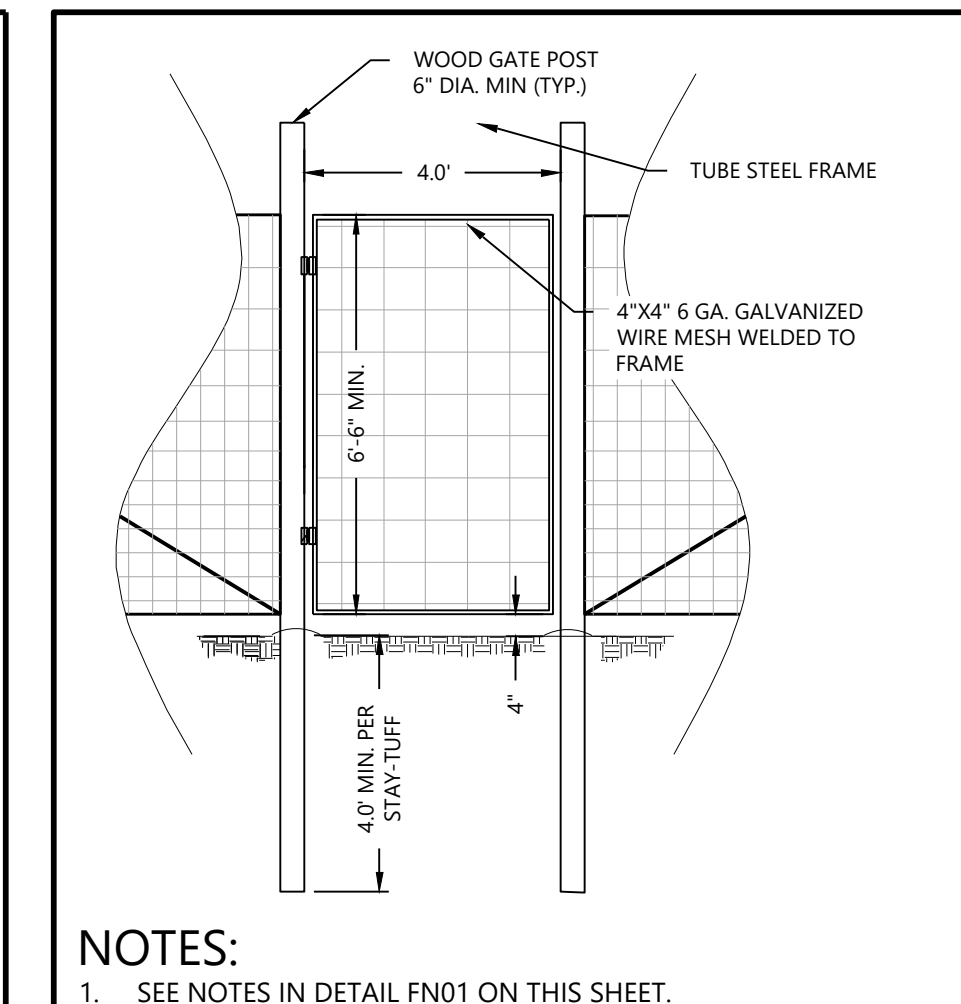

- NOTES:
1. SEE NOTES IN DETAIL FN01 ON THIS SHEET.

Westwood TYPICAL AGRICULTURE PERSONNEL GATE (NOT TO SCALE) **FN03**

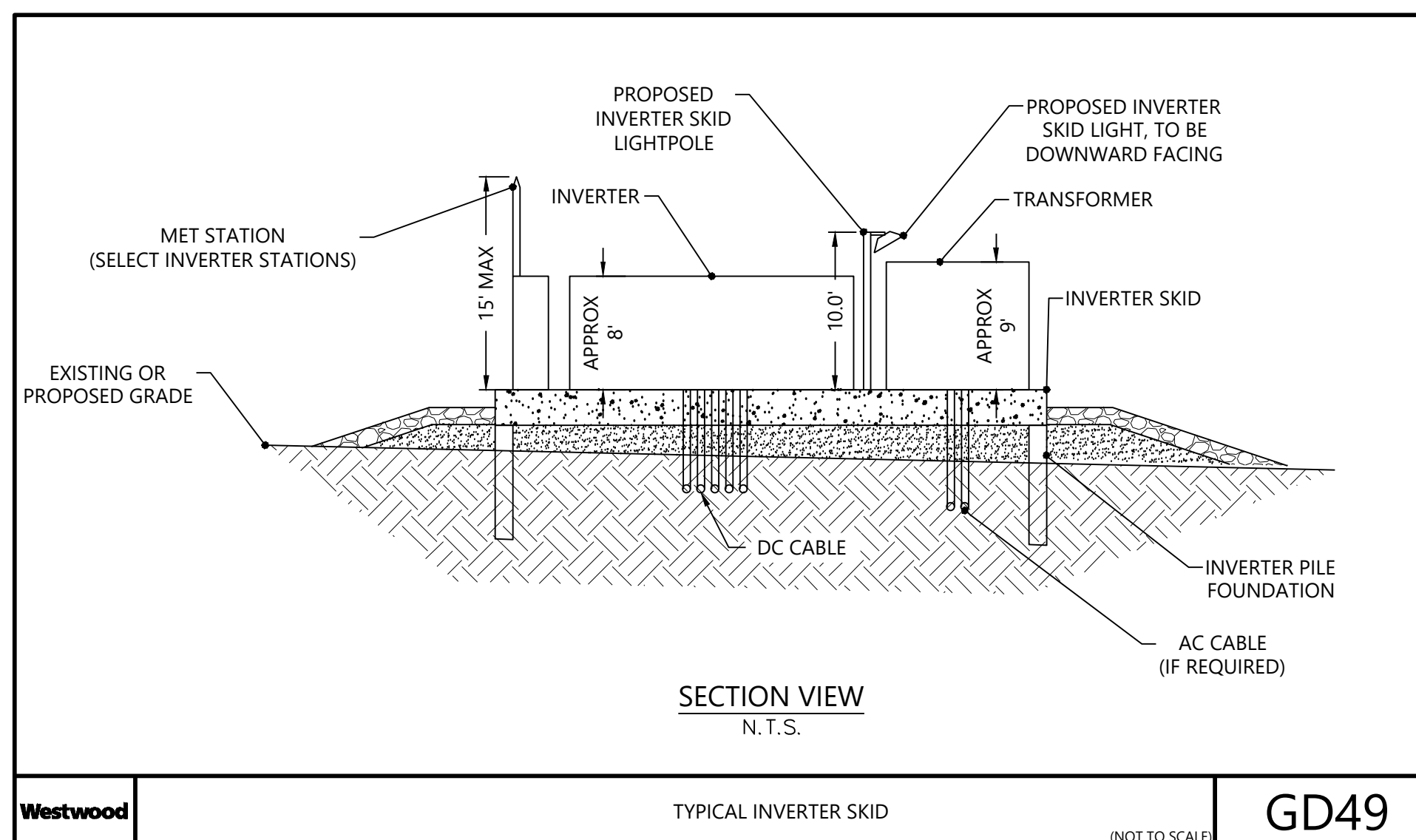

Westwood TYPICAL INVERTER SKID (NOT TO SCALE) **GD49**

## Hayward Solar Project

Freeborn County, Minnesota

Construction Details

PRELIMINARY  
NOT FOR CONSTRUCTION

DATE: 03/19/2021

SHEET: C.401



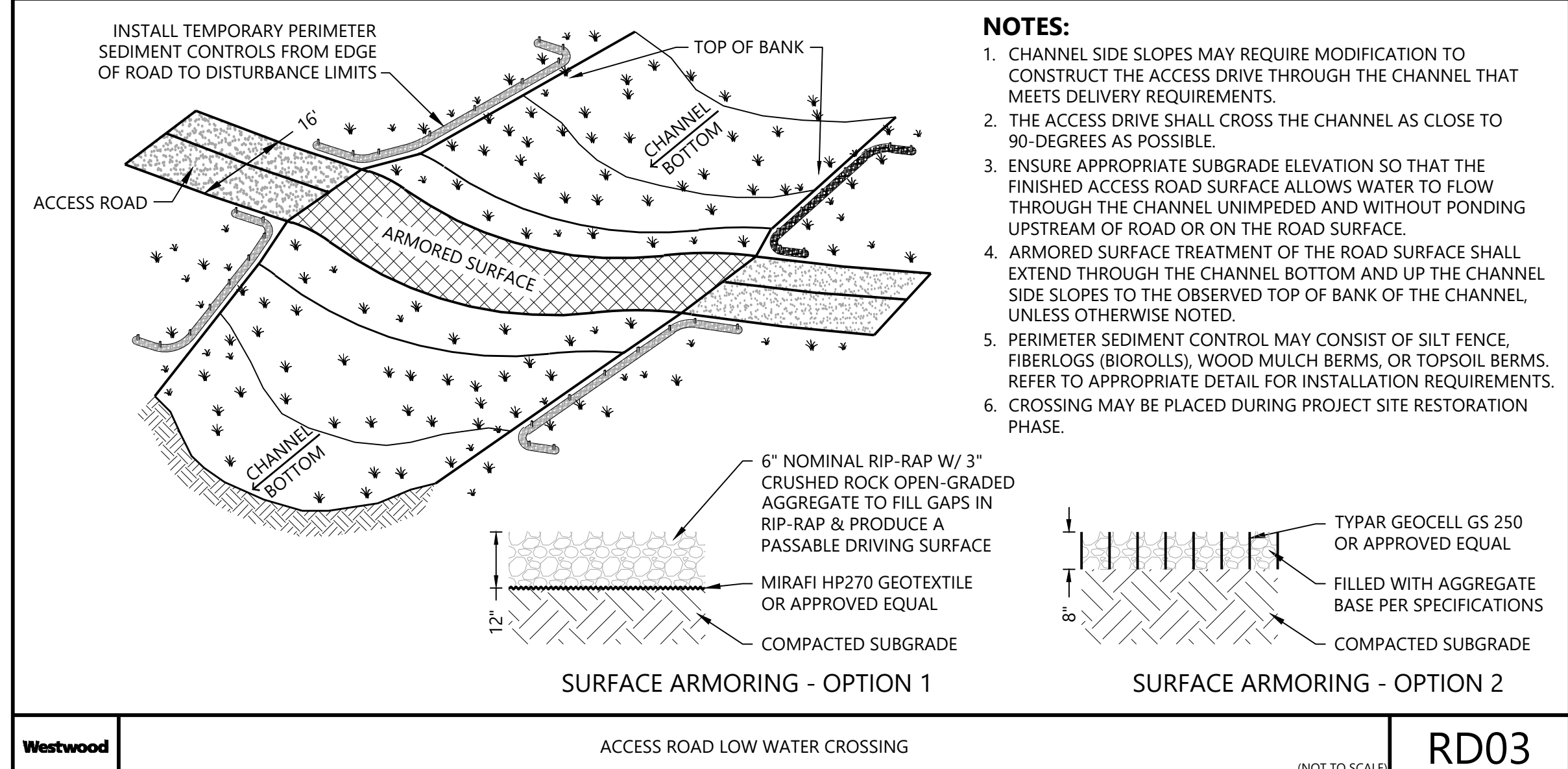

Westwood ACCESS ROAD LOW WATER CROSSING (NOT TO SCALE) RD03

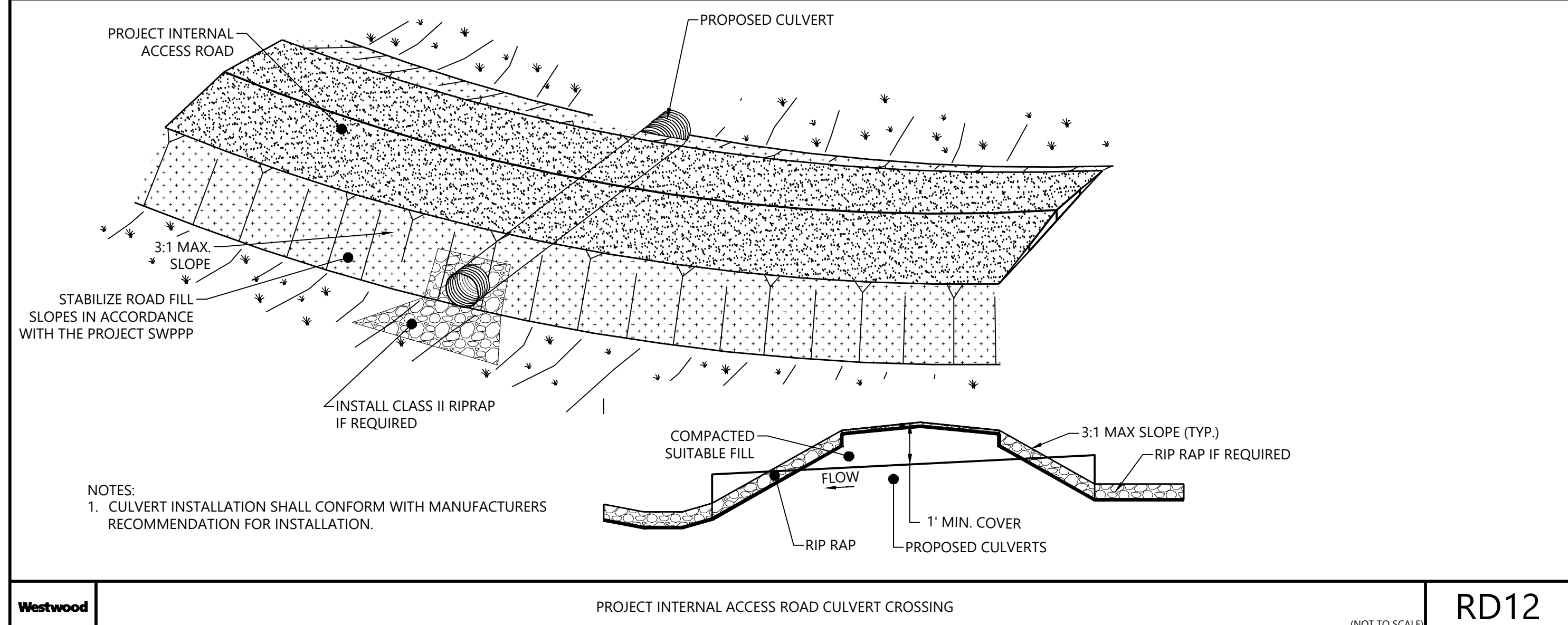

Westwood PROJECT INTERNAL ACCESS ROAD CULVERT CROSSING (NOT TO SCALE) RD12

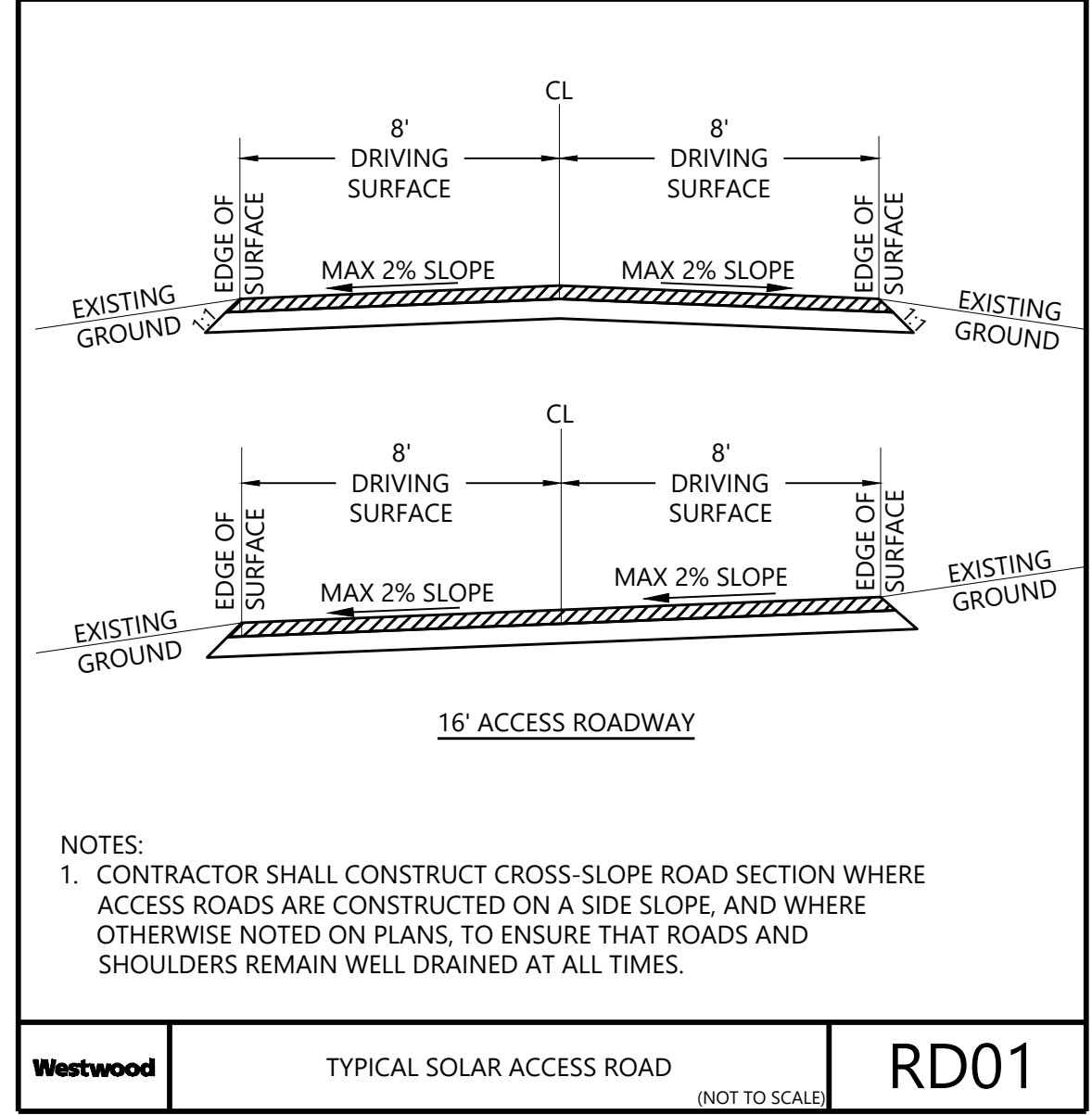

Westwood TYPICAL SOLAR ACCESS ROAD (NOT TO SCALE) RD01

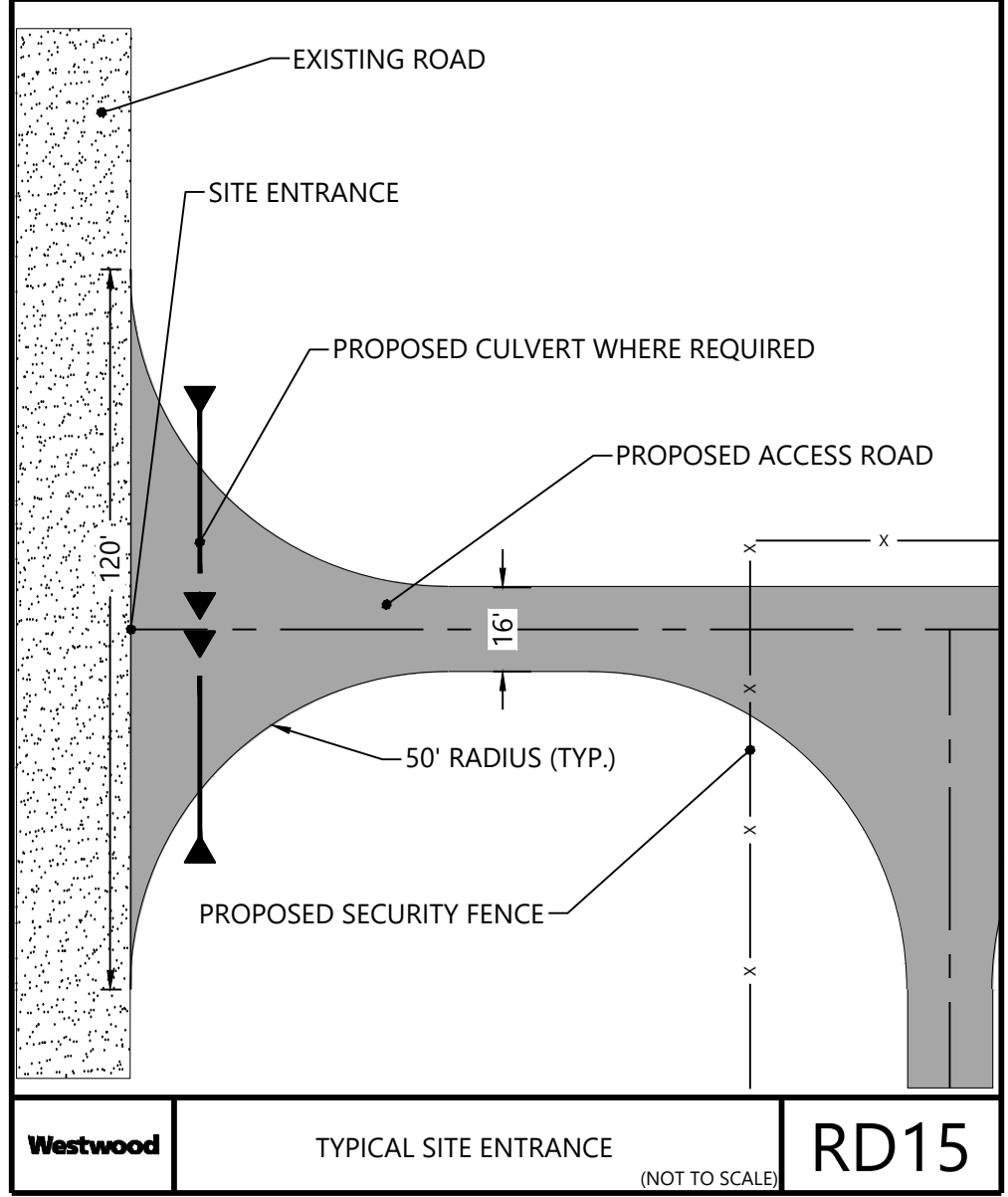

Westwood TYPICAL SITE ENTRANCE (NOT TO SCALE) RD15

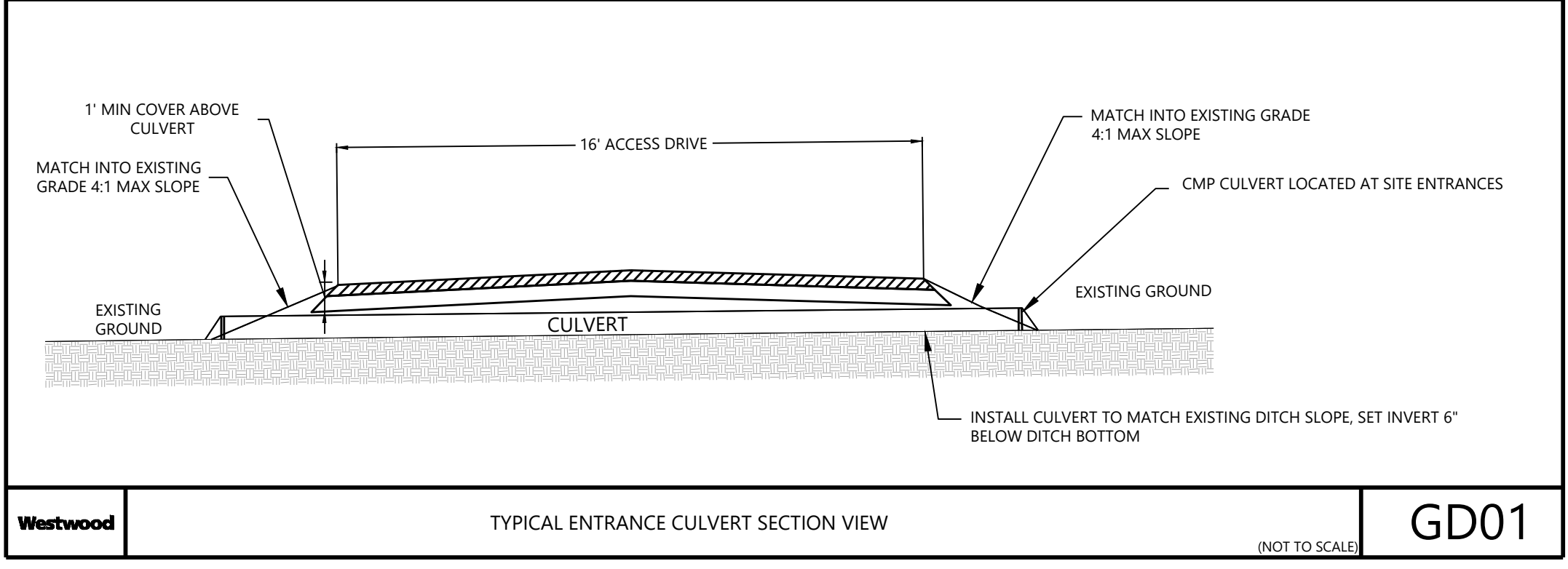

Westwood TYPICAL ENTRANCE CULVERT SECTION VIEW (NOT TO SCALE) GD01

**Hayward Solar Project**  
 Freeborn County, Minnesota

Construction Details

PRELIMINARY  
 NOT FOR CONSTRUCTION

DATE: 03/19/2021  
 SHEET: C.402

03/19/2021 11:28 AM C:\Users\j... \Documents\0303599.DWG

PREPARED FOR:

**CapitalDynamics**   
TRULY INVESTED.

10 East 53rd Street, 17th Floor  
New York, NY 10022

REVISIONS:

#	DATE	COMMENT
A	12/11/2020	DRAFT - Site Plan
B	01/29/2021	Preliminary Site Plan
C	03/19/2021	Preliminary Site Plan

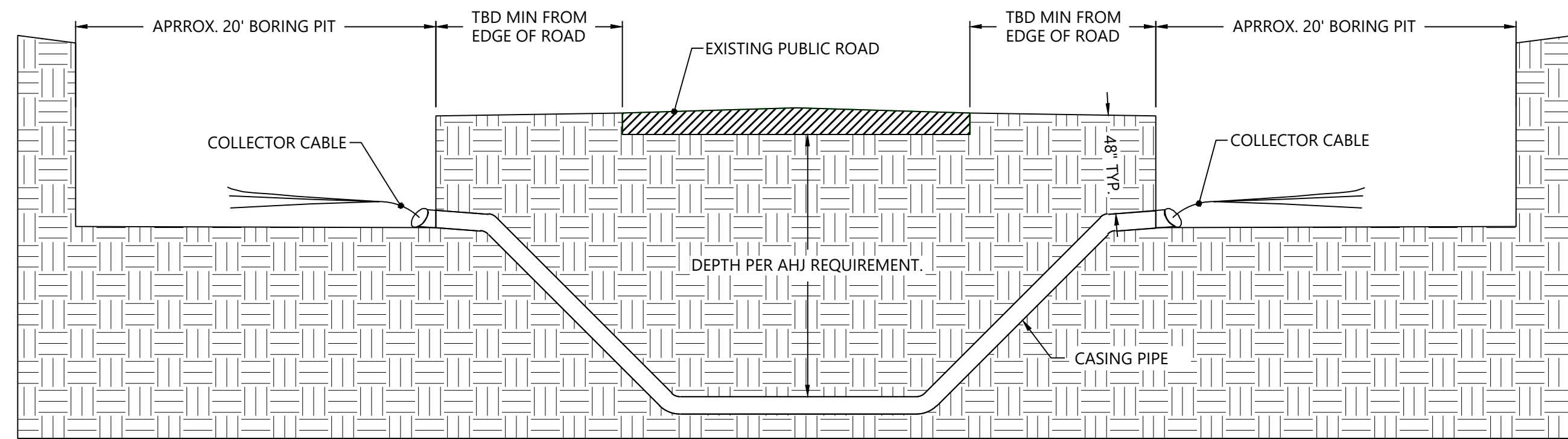

Westwood TYPICAL ROAD UNDERGROUND COLLECTOR BORING - PUBLIC ROAD (NOT TO SCALE) DR01

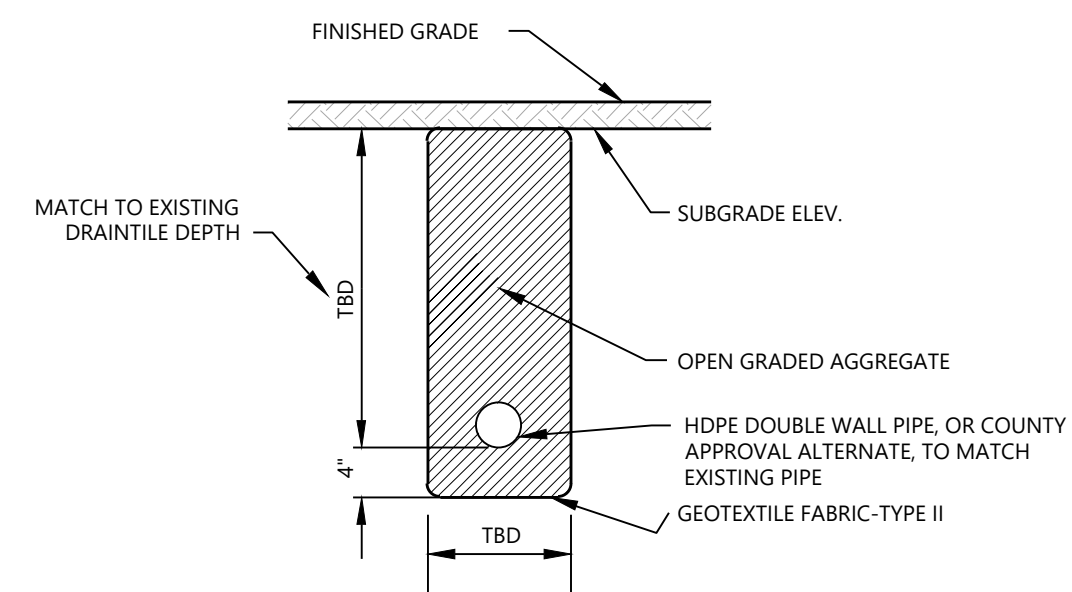

Westwood TYPICAL PERFORATED DRAIN TILE (NOT TO SCALE) ST15

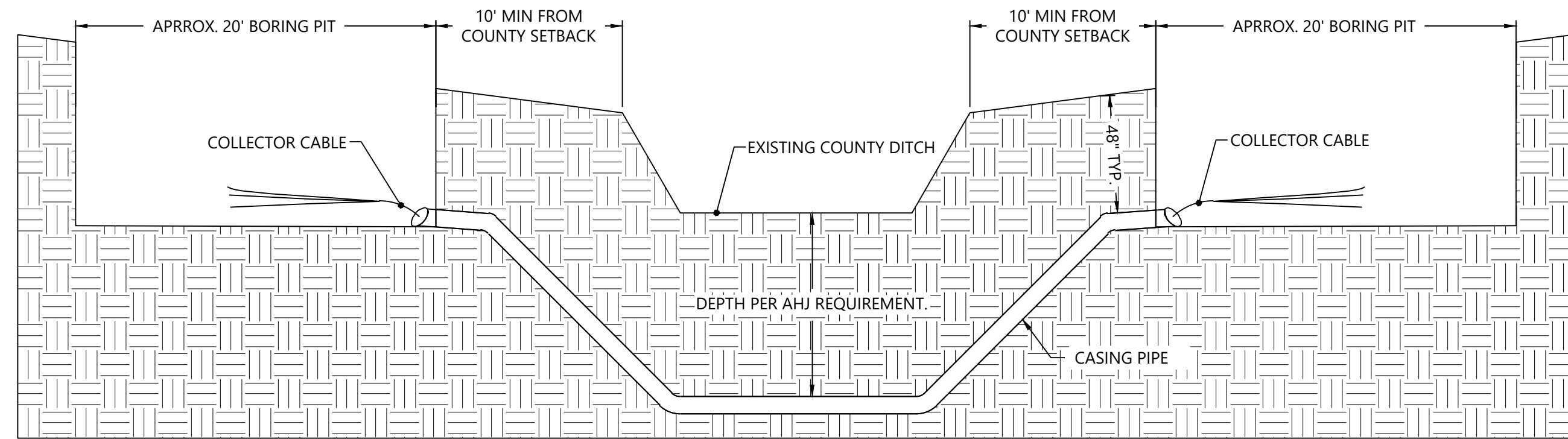

Westwood TYPICAL UNDERGROUND COLLECTOR BORING - DITCH (NOT TO SCALE) DR02

NOTES:

1. FERNCO CAPPED MONITORING PORT TO BE INSTALLED ~10' DOWNSTREAM OF BORING FOR CAMERA ACCESS

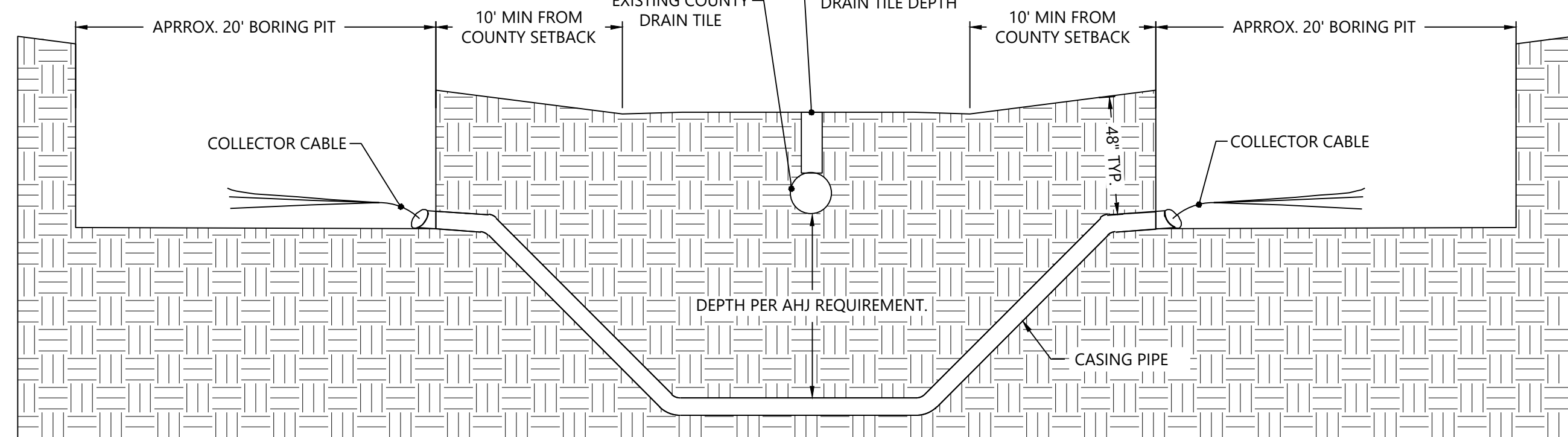

Westwood TYPICAL UNDERGROUND COLLECTOR BORING - COUNTY OPEN DRAIN TILE (NOT TO SCALE) DR03

NOTES:

1. FERNCO CAPPED MONITORING PORT TO BE INSTALLED ~10' DOWNSTREAM OF BORING FOR CAMERA ACCESS
2. THE DRAIN TILE SHALL BE REPLACED A MINIMUM OF 5' ON EACH SIDE OF THE PROPOSED ACCESS ROAD EDGE OF GRAVEL

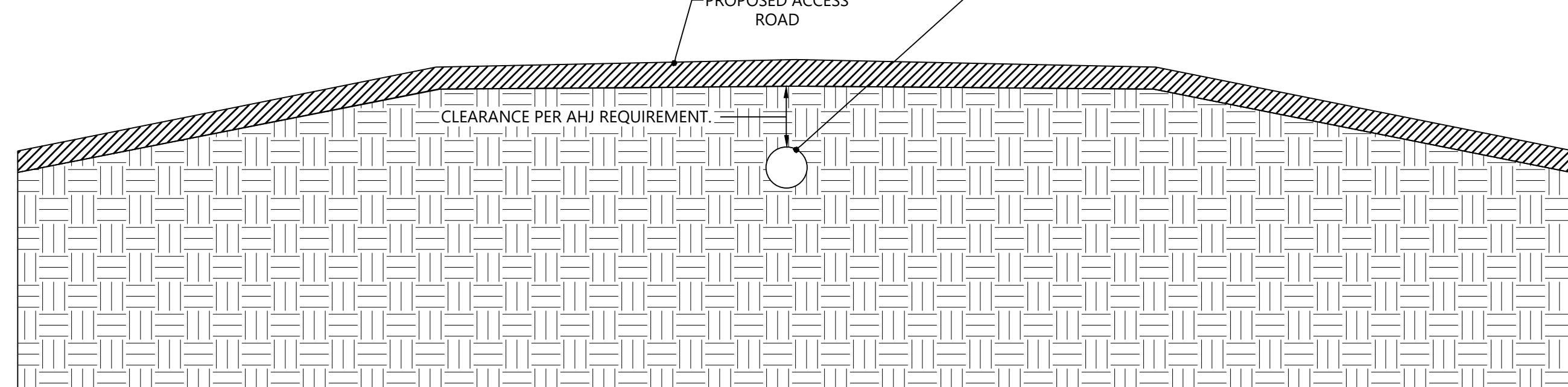

Westwood TYPICAL COUNTY DRAIN TILE ACCESS ROAD CROSSING (NOT TO SCALE) DR04

## Hayward Solar Project

Freeborn County, Minnesota

Construction Details

PRELIMINARY  
NOT FOR CONSTRUCTION

DATE: 03/19/2021

SHEET: C.403