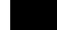











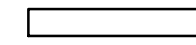


## FIGURE 1.1 Proposed Route Overview

### LEGEND

-  Odell Wind Farm Substation
-  Woad Hill Substation
-  Proposed Route
-  Private Airstrips
-  Existing HVTL
-  Pipeline - Field Verified
-  US Highway
-  State Highway
-  County Highway
-  County Road
-  Other Roads
-  County Boundary

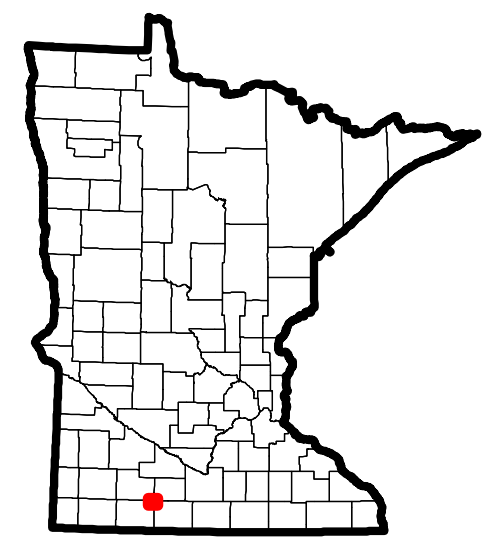
0.5



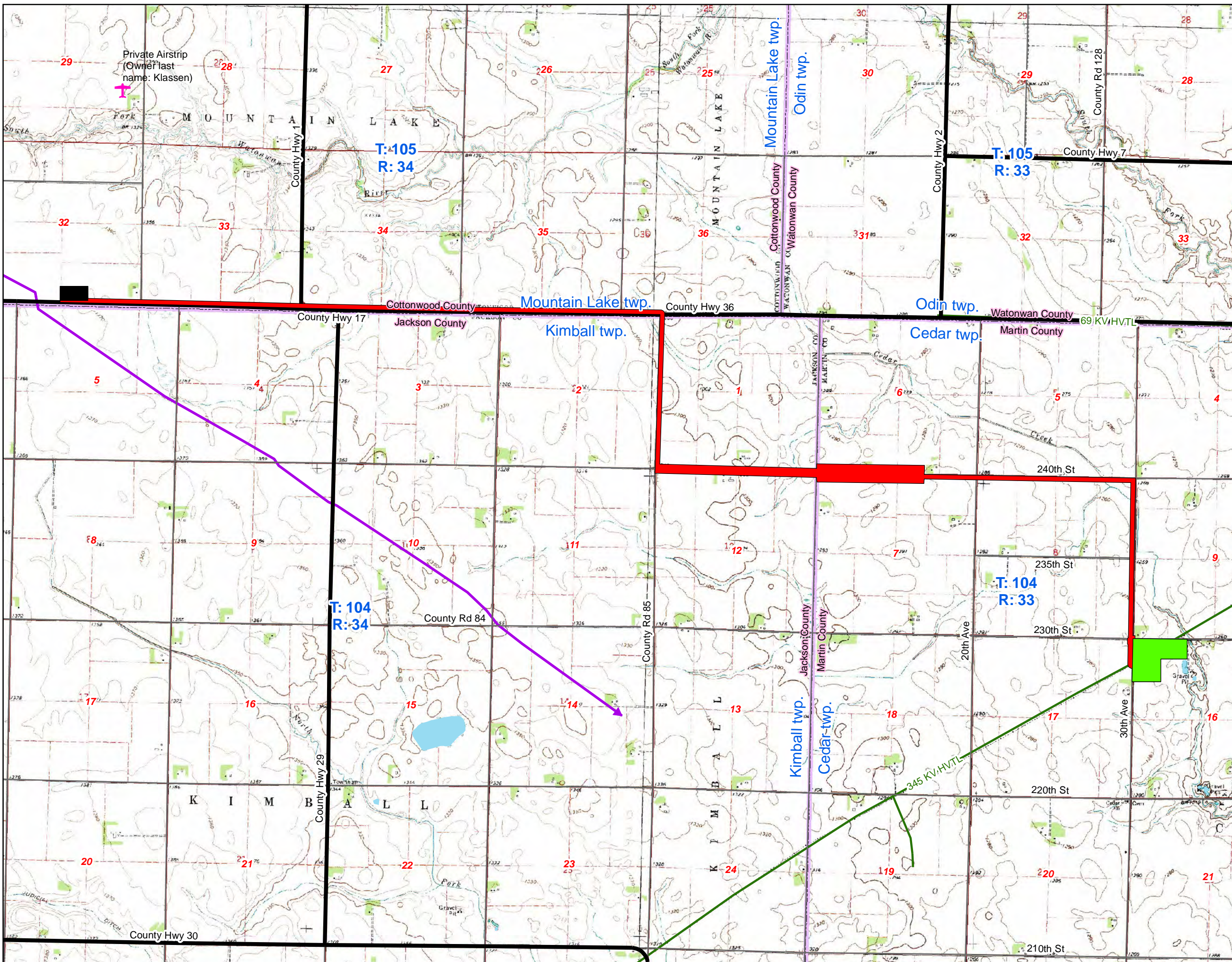
Miles



NAD 1983 UTM Zone 15N



SOURCES:  
Geronimo Energy,  
Ventyx, USGS,  
MNDNR



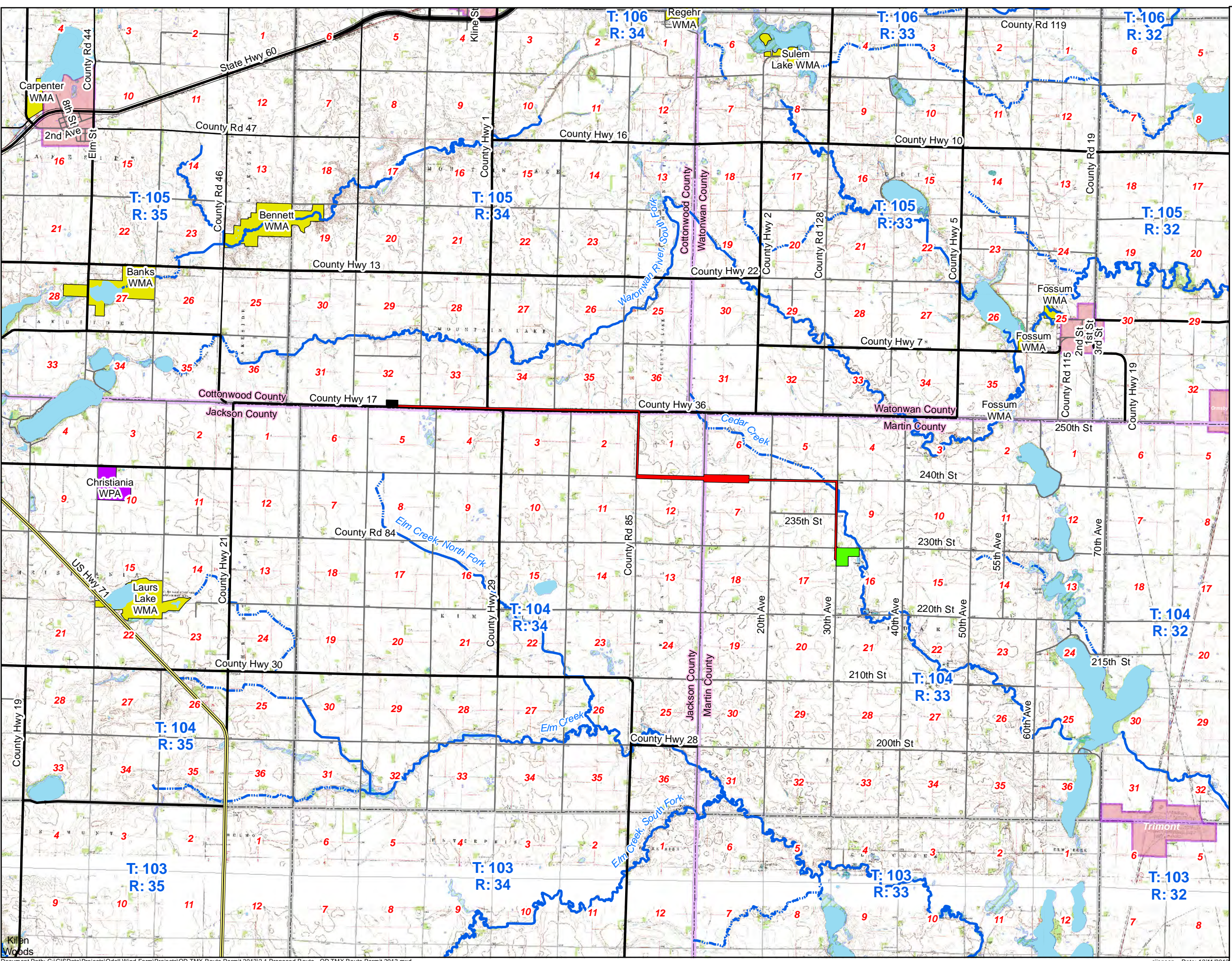
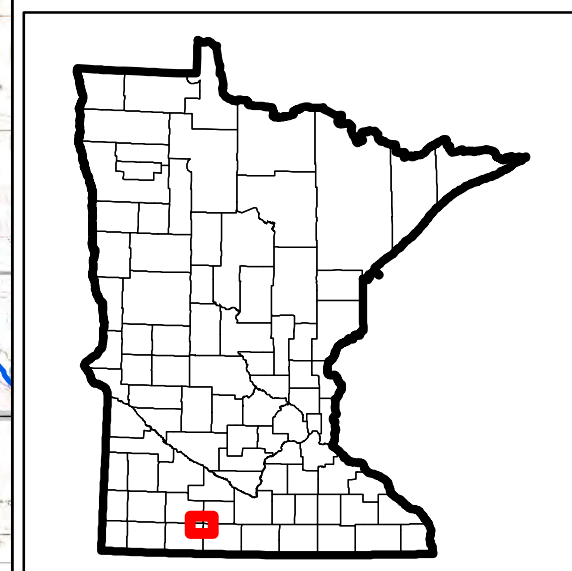
## FIGURE 2.1 Proposed Route

**LEGEND**

- Odell Wind Farm Substation
- Woad Hill Substation
- Proposed Route
- Public Waters Inventory (PWI)**
- River
- Perennial Stream
- Intermittent Stream
- Minnesota County Biological Survey
- Scientific and Natural Areas
- Wildlife Management Areas
- State Park
- Waterfowl Production Areas
- National Wetland Inventory (NWI)**
- Freshwater Emergent Wetland
- Freshwater Forested/Shrub Wetland
- Lake/Pond
- Riverine
- City/Town Boundary
- County Boundary
- Township Boundary

1  
Miles

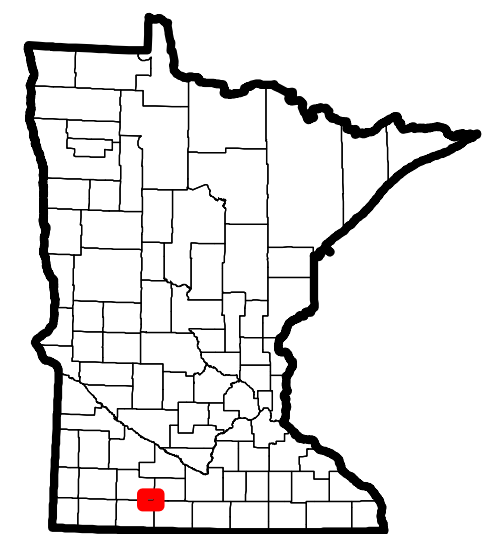
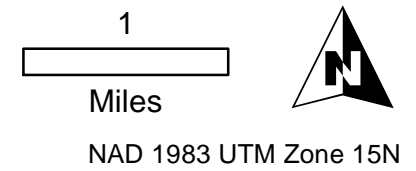
NAD 1983 UTM Zone 15N



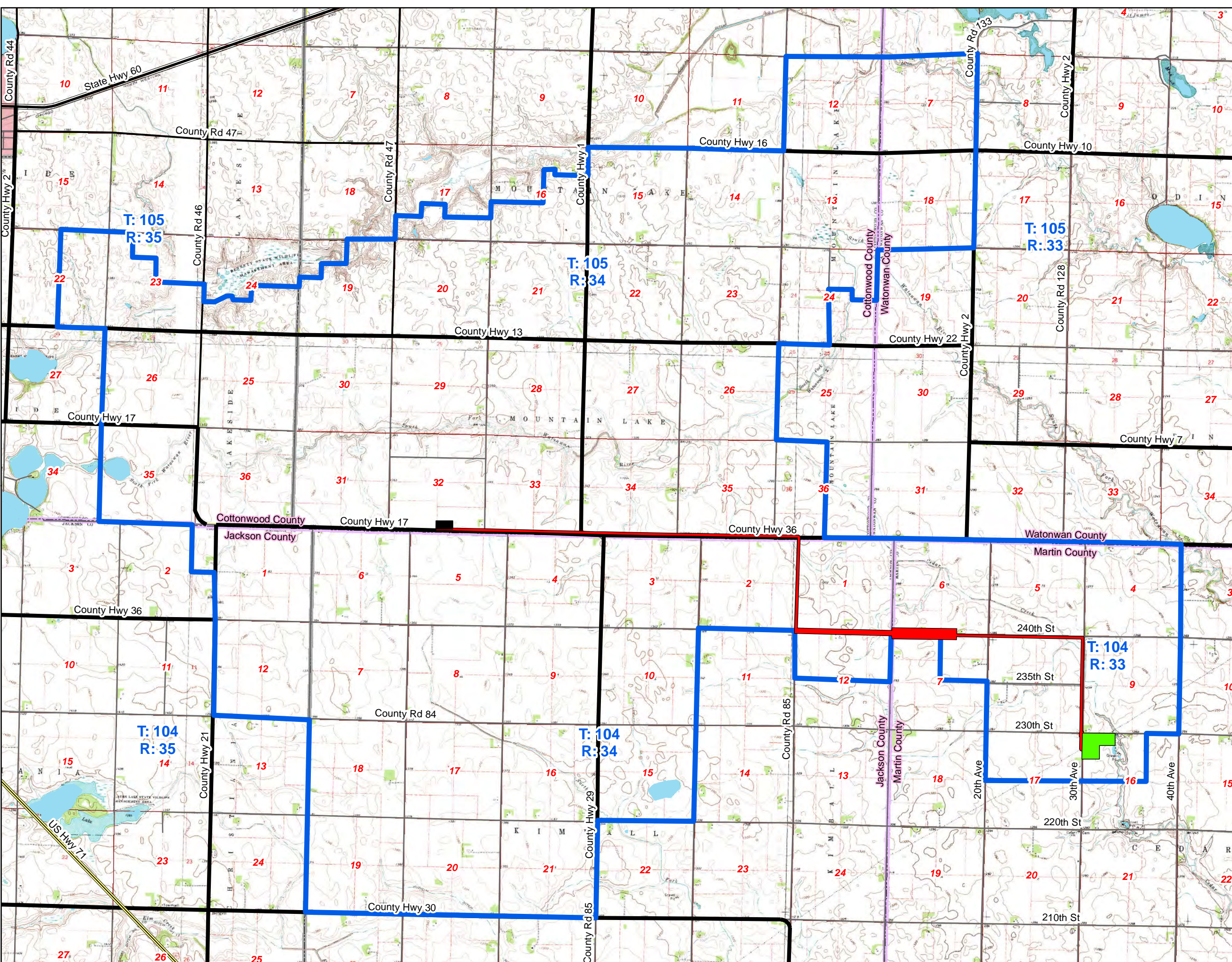
**FIGURE 3.1**  
**Proposed Odell Wind Farm**  
**Boundary and Transmission**  
**Line Route**

**LEGEND**

- Odell Wind Farm Substation
- Woad Hill Substation
- Proposed Route
- Odell Wind Farm Boundary
- US Highway
- State Highway
- County Highway
- County Road
- Other Roads
- County Boundary



SOURCES:  
 Geronimo Energy,  
 Ventyx, USGS



**Figure 4.1(a)**  
**Picture and Schematic**  
**of Proposed Structures**  
**(Delta Configuration)**

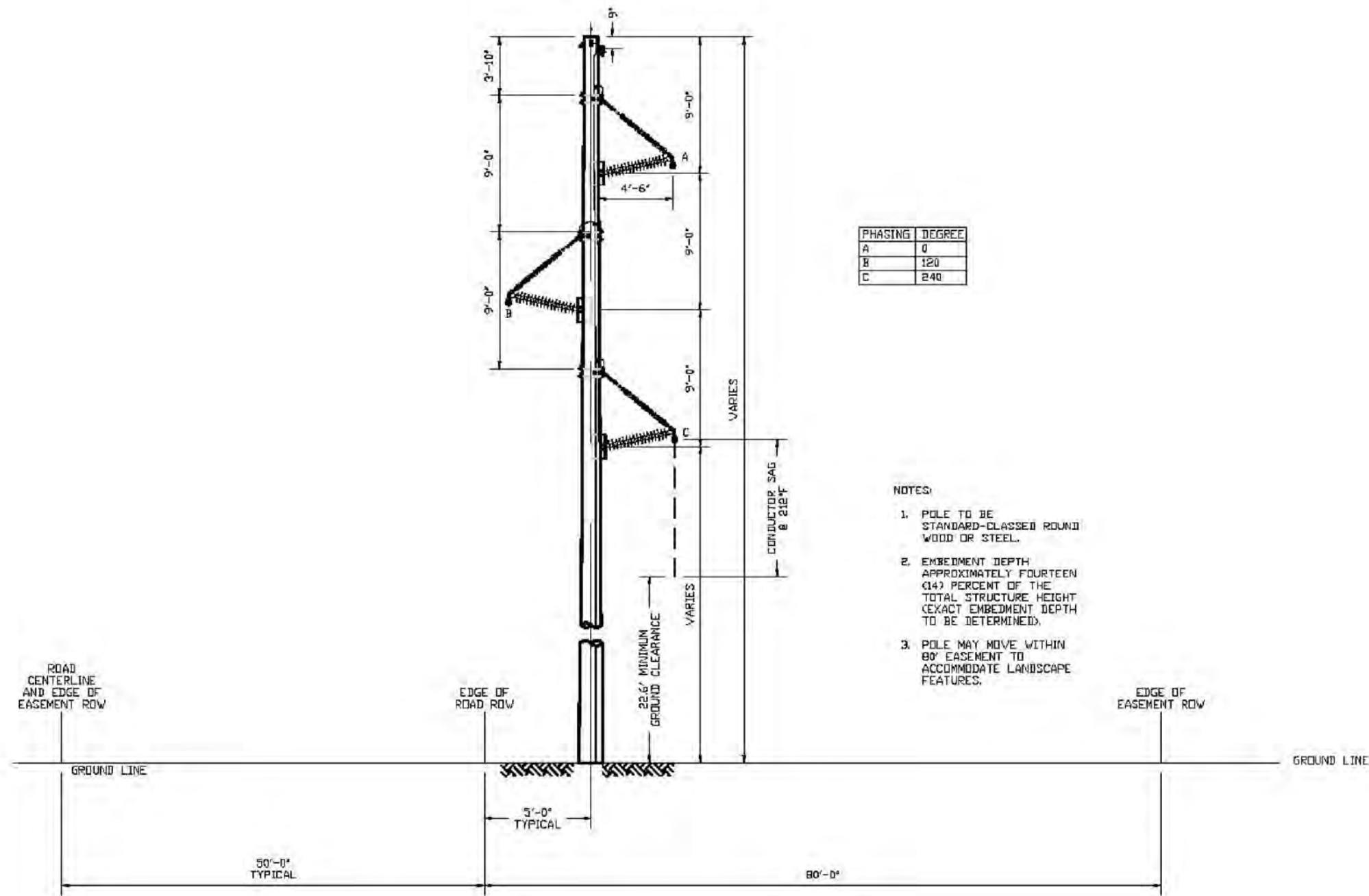
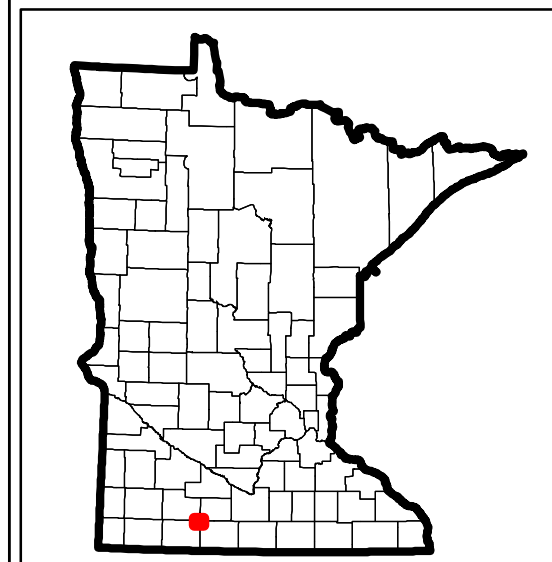
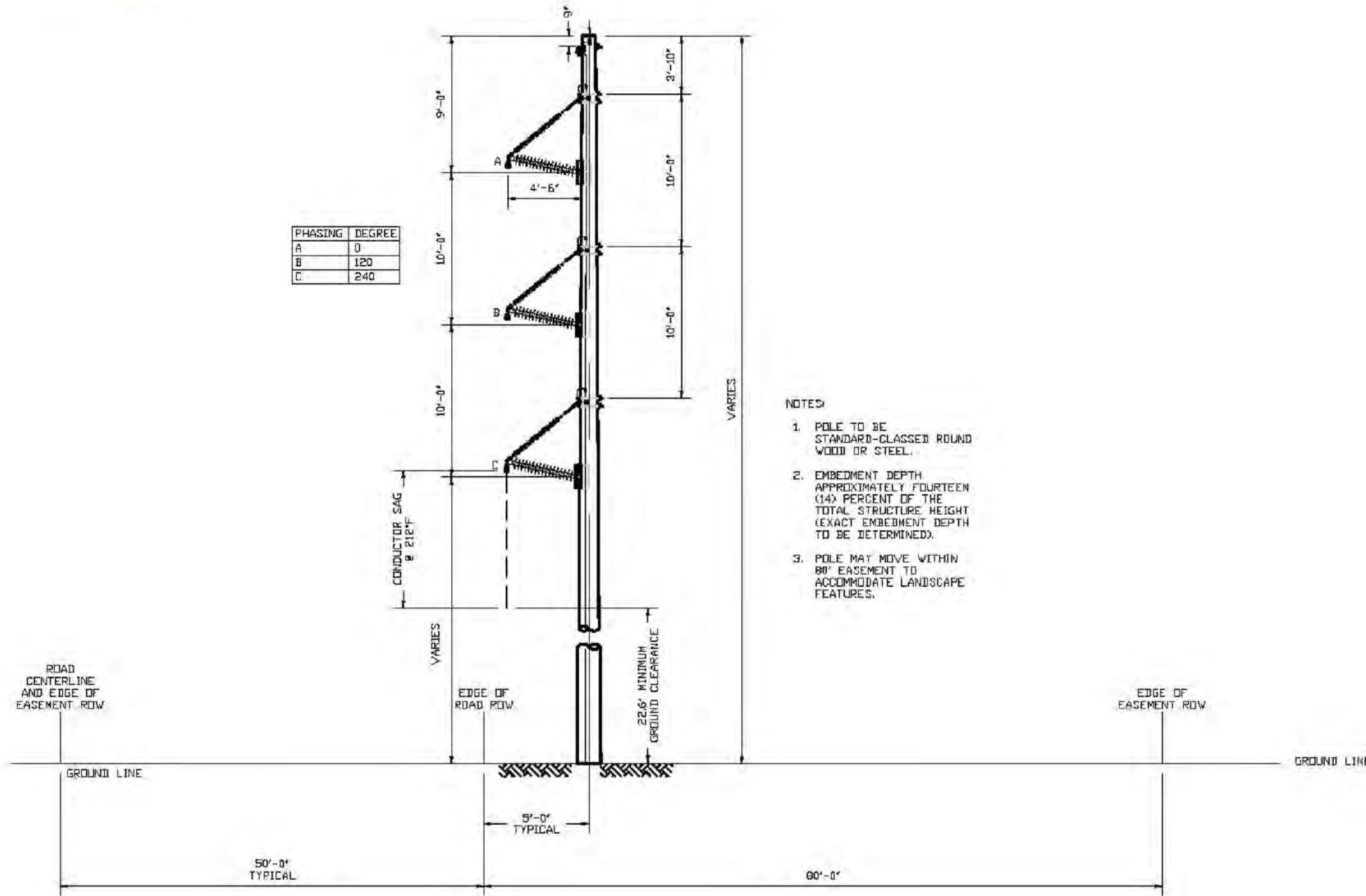


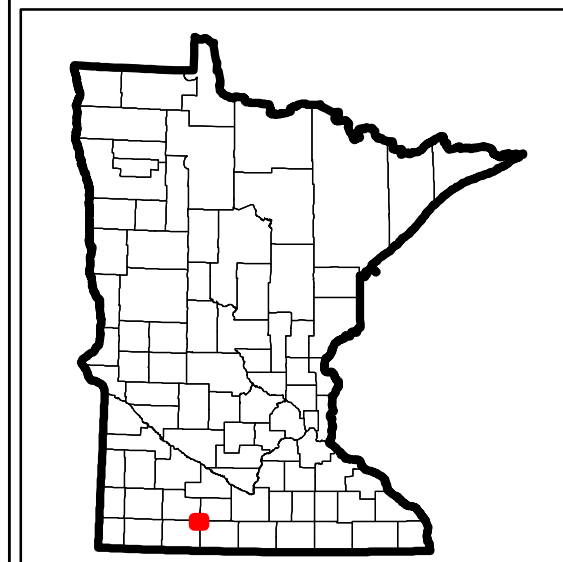
FIGURE 1 - PROPOSED DELTA CONFIGURATION STRUCTURE AND EASEMENT RIGHT-OF-WAY CORRIDOR



**Figure 4.1(b)  
Picture and Schematic  
of Proposed Structures  
(Vertical Configuration)**











**FIGURE 2 - PROPOSED VERTICAL CONFIGURATION STRUCTURE AND EASEMENT RIGHT-OF-WAY CORRIDOR**




**FIGURE 5.1**  
**Topographic Map**

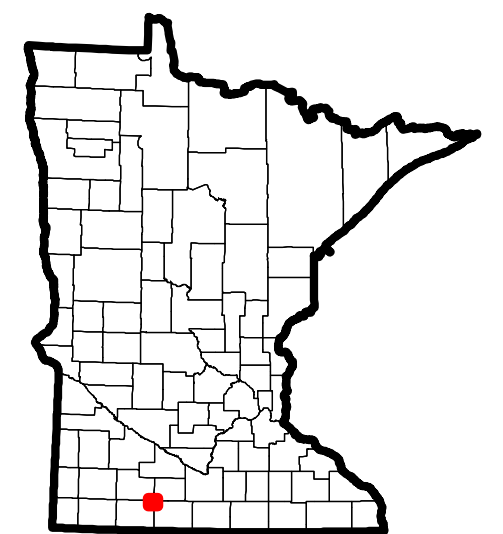
**LEGEND**

-  Woad Hill Substation
-  Proposed Route
-  Odell Wind Farm Substation
-  US Highway
-  State Highway
-  County Highway
-  County Road
-  Other Roads

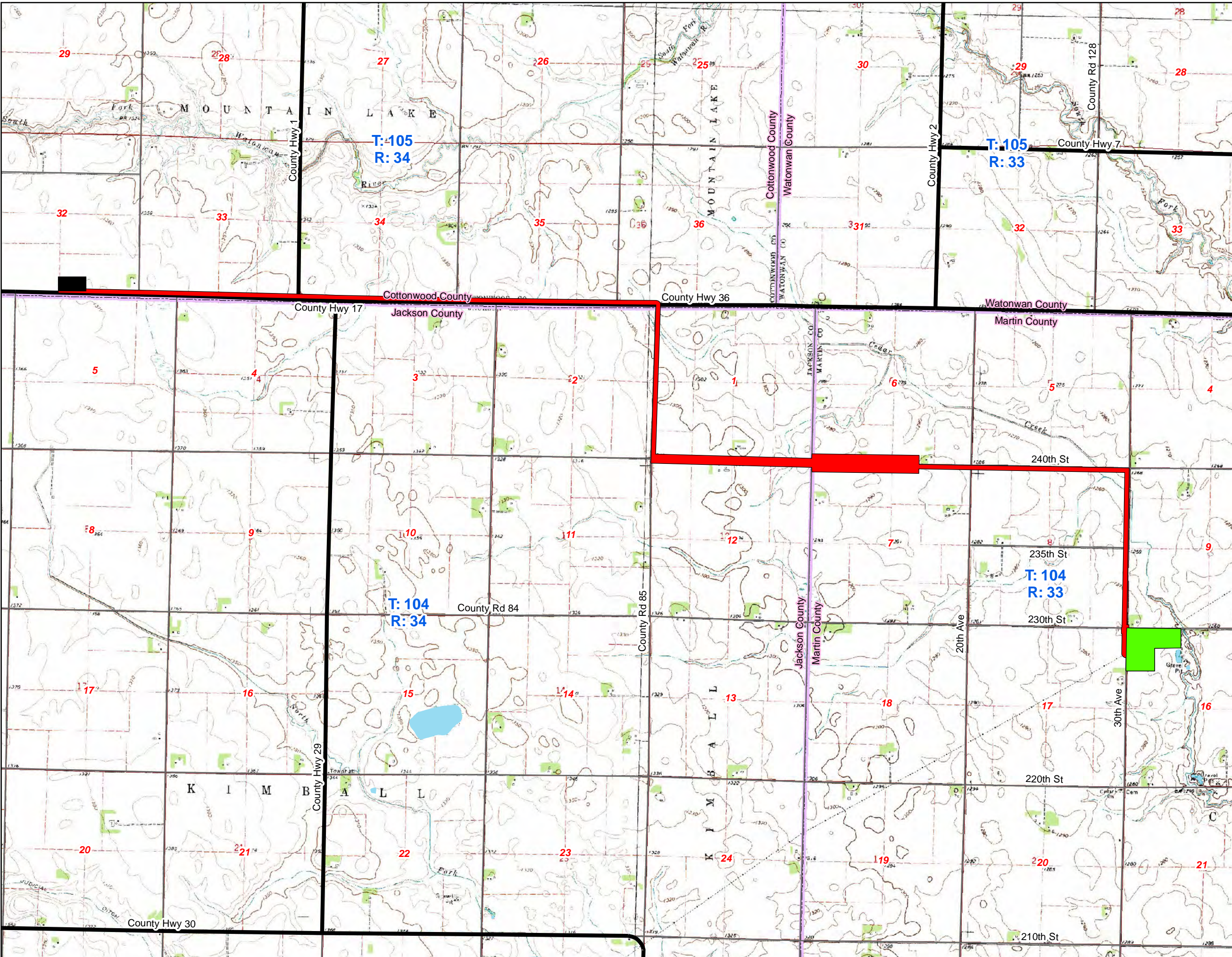
0.5  
Miles



NAD 1983 UTM Zone 15N



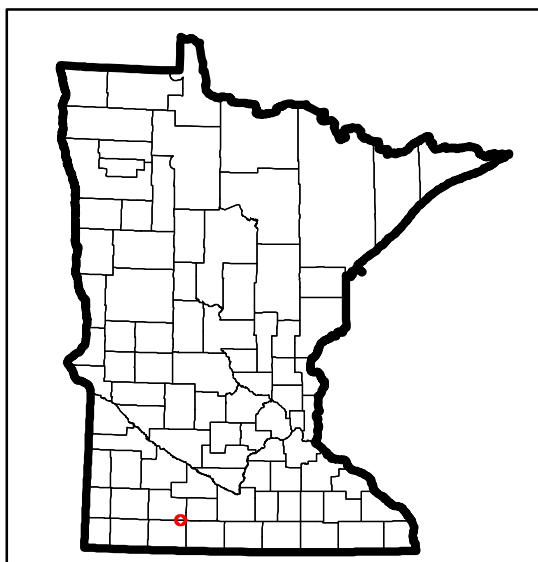
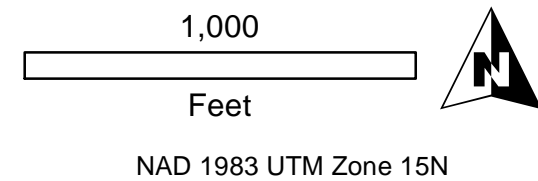
SOURCES:  
Geronimo Energy,  
Ventyx, USGS



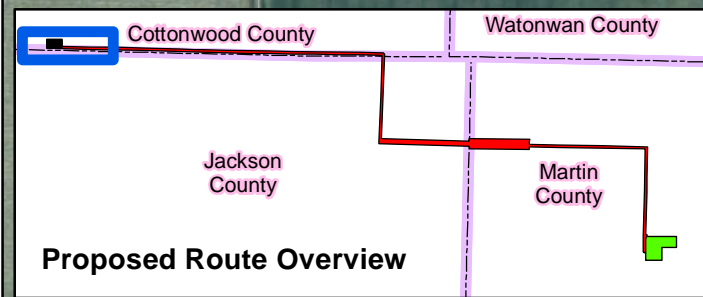
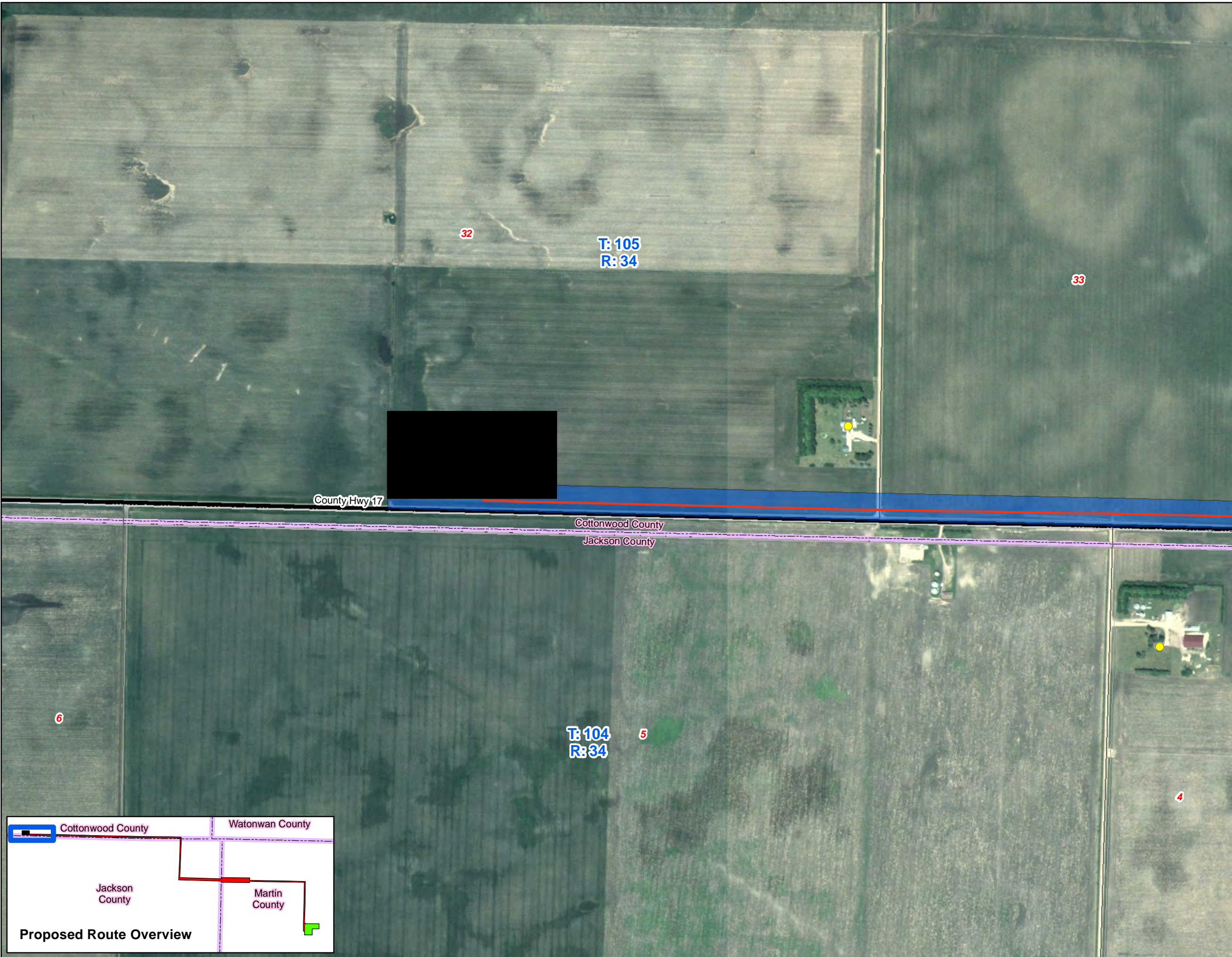
**FIGURE 5.2 (a)**  
**Locations of**  
**Residences or**  
**Farmsteads**

**LEGEND**

- Residence/Farmstead
- Anticipated Alignment
- Woad Hill Substation
- Proposed Route
- Odell Wind Farm Substation








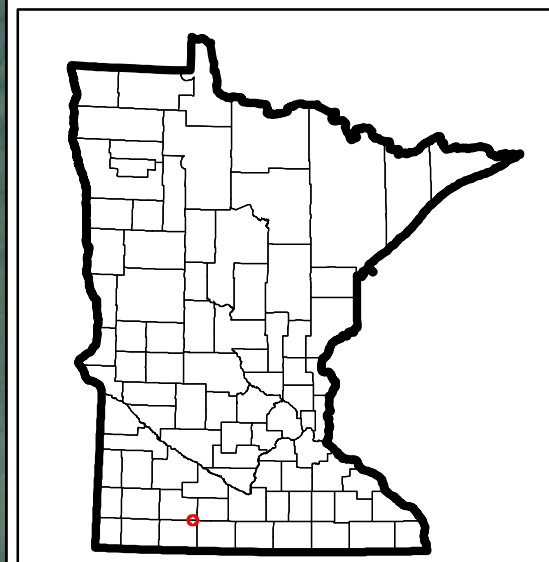
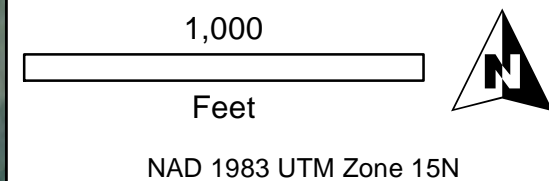
SOURCES:  
Geronimo Energy,  
Ventyx, NAIP,  
WSB, PWI



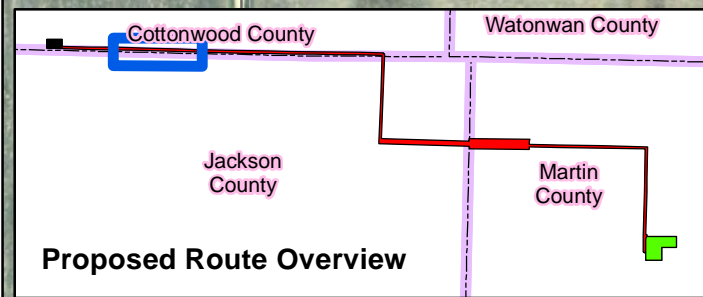
**FIGURE 5.2 (b)**  
**Locations of**  
**Residences or**  
**Farmsteads**

**LEGEND**

-  Residence/Farmstead
-  Anticipated Alignment
-  Woad Hill Substation
-  Proposed Route
-  Odell Wind Farm Substation







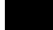
SOURCES:  
Geronimo Energy,  
Ventyx, NAIP,  
WSB, PWI

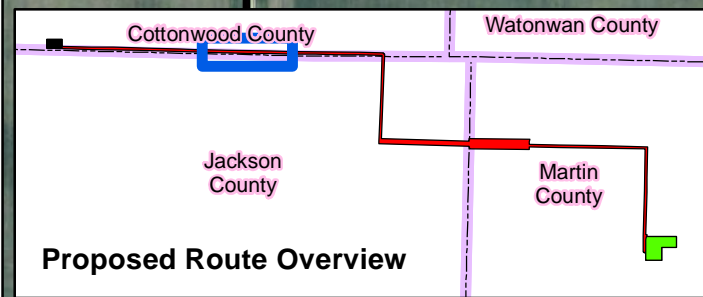
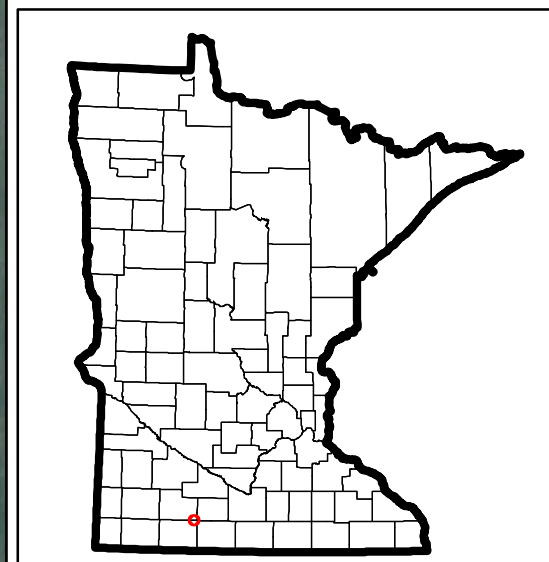
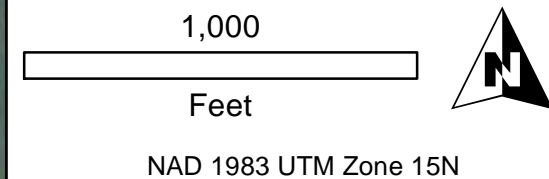




**FIGURE 5.2 (c)**  
**Locations of**  
**Residences or**  
**Farmsteads**






**LEGEND**

-  Residence/Farmstead
-  Anticipated Alignment
-  Woad Hill Substation
-  Proposed Route
-  Odell Wind Farm Substation

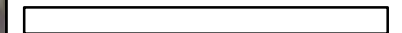


**FIGURE 5.2 (d)**  
**Locations of**  
**Residences or**  
**Farmsteads**

**LEGEND**

-  Residence/Farmstead
-  Anticipated Alignment
-  Woad Hill Substation
-  Proposed Route
-  Odell Wind Farm Substation

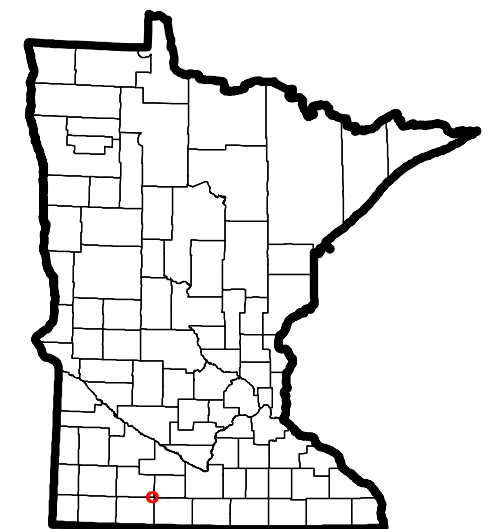
1,000



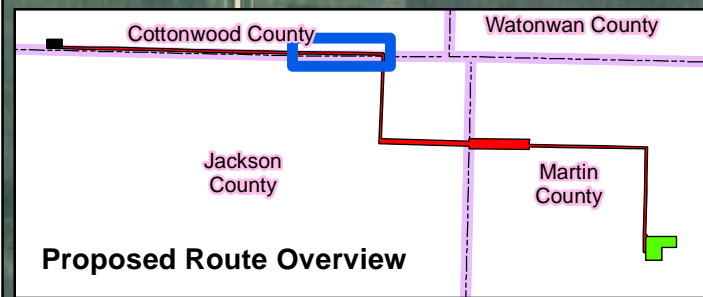
Feet



NAD 1983 UTM Zone 15N



SOURCES:  
Geronimo Energy,  
Ventyx, NAIP,  
WSB, PWI

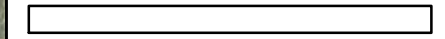


**FIGURE 5.2 (e)**  
**Locations of**  
**Residences or**  
**Farmsteads**

**LEGEND**

- Residence/Farmstead
- Anticipated Alignment
- Woad Hill Substation
- Proposed Route
- Odell Wind Farm Substation

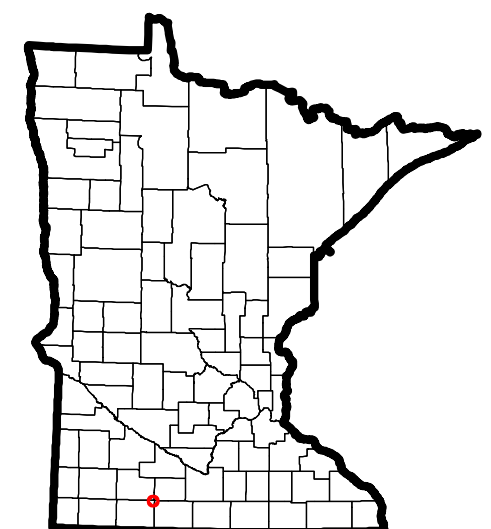
1,250



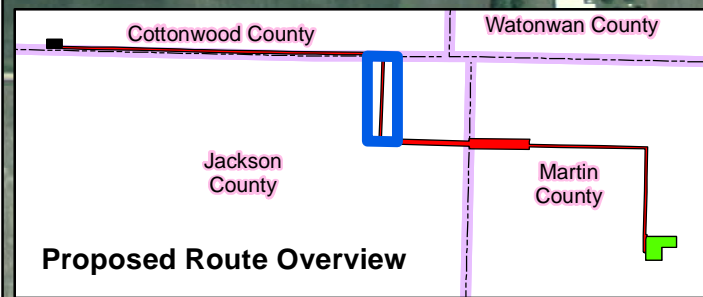
Feet



NAD 1983 UTM Zone 15N





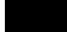


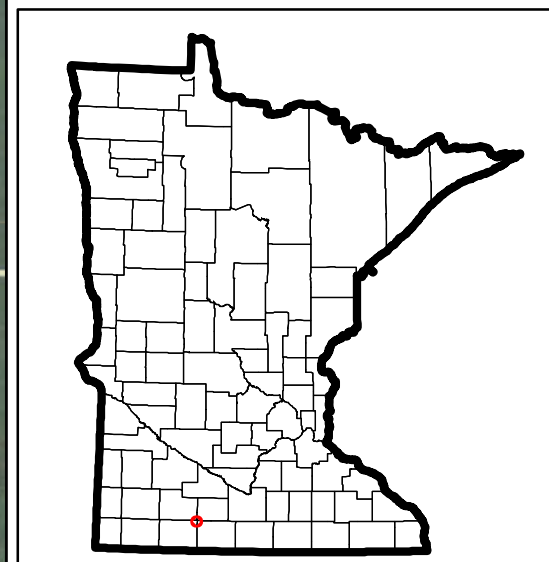
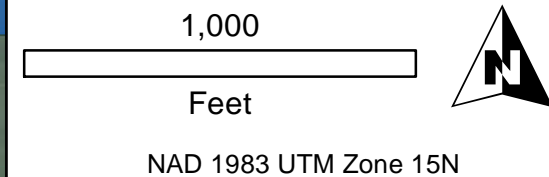
SOURCES:  
Geronimo Energy,  
Ventyx, NAIP,  
WSB, PWI



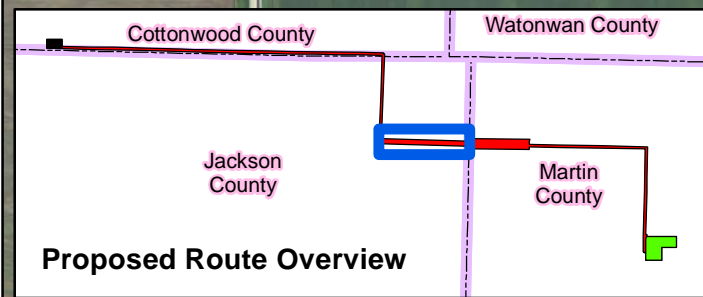
**FIGURE 5.2 (f)**  
**Locations of**  
**Residences or**  
**Farmsteads**

**LEGEND**

-  Residence/Farmstead
-  Anticipated Alignment
-  Woad Hill Substation
-  Proposed Route
-  Odell Wind Farm Substation



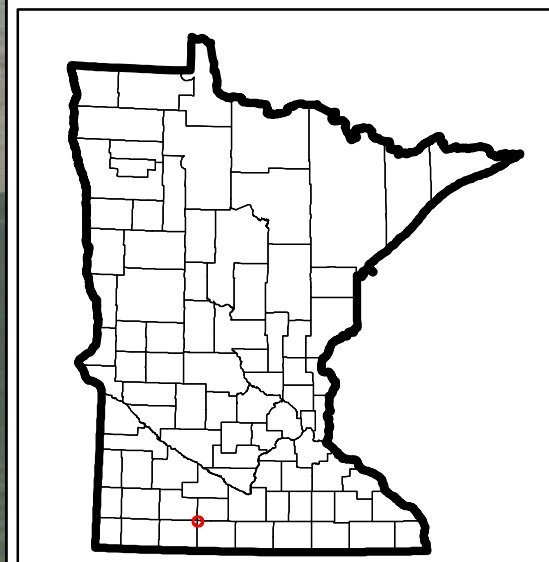
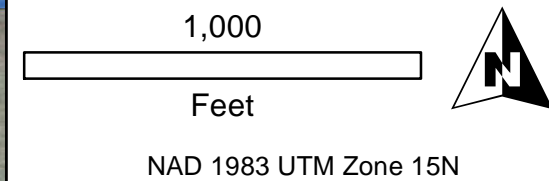
SOURCES:  
Geronimo Energy,  
Ventyx, NAIP,  
WSB, PWI



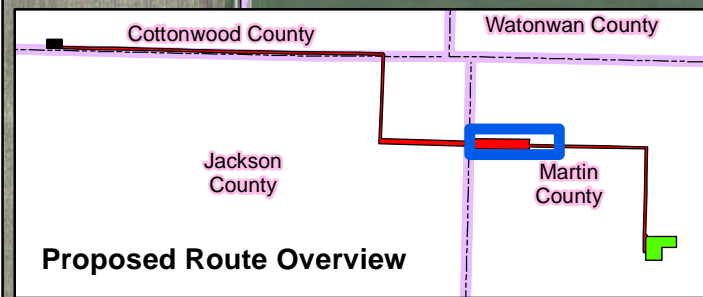
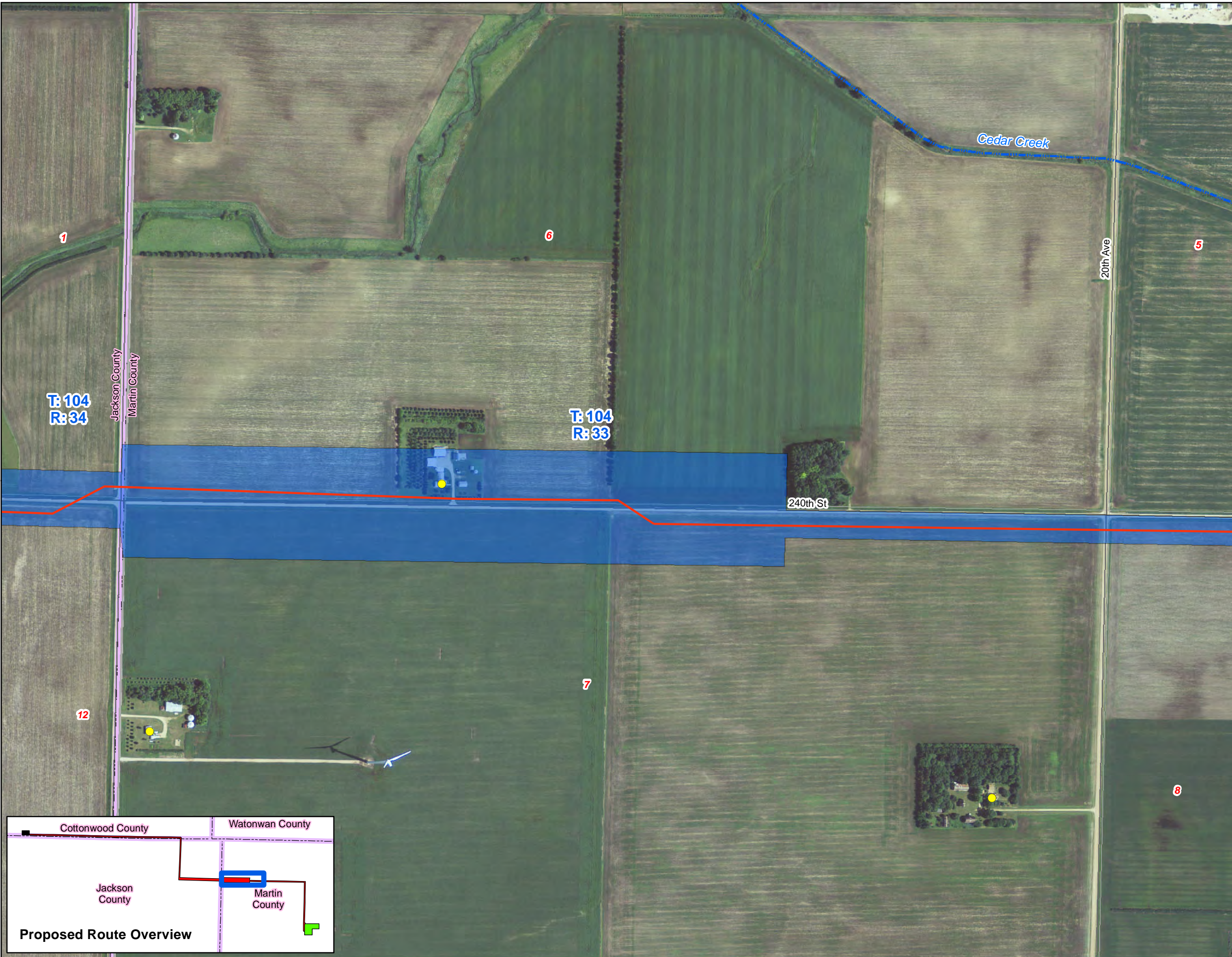
**FIGURE 5.2 (g)**  
**Locations of**  
**Residences or**  
**Farmsteads**

**LEGEND**

- Residence/Farmstead
- Anticipated Alignment
- Woad Hill Substation
- Proposed Route
- Odell Wind Farm Substation





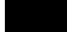


SOURCES:  
Geronimo Energy,  
Ventyx, NAIP,  
WSB, PWI



**FIGURE 5.2 (h)**  
**Locations of**  
**Residences or**  
**Farmsteads**

**LEGEND**

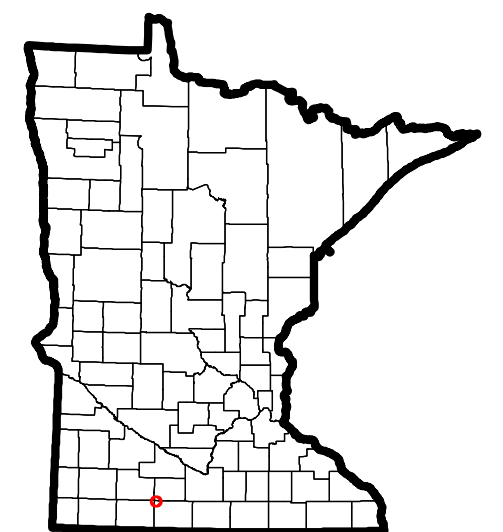
-  Residence/Farmstead
-  Anticipated Alignment
-  Woad Hill Substation
-  Proposed Route
-  Odell Wind Farm Substation

1,000

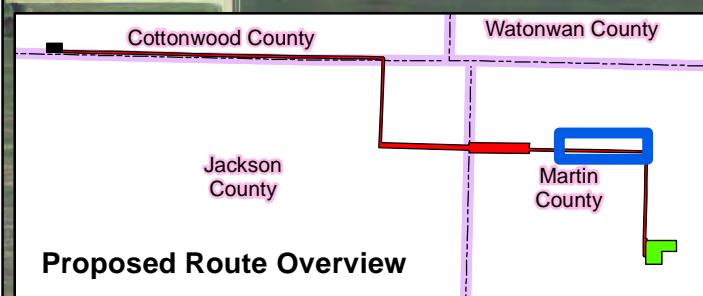
Feet



NAD 1983 UTM Zone 15N





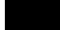


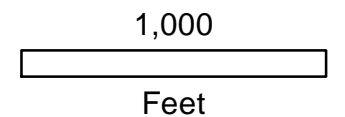
SOURCES:  
Geronimo Energy,  
Ventyx, NAIP,  
WSB, PWI



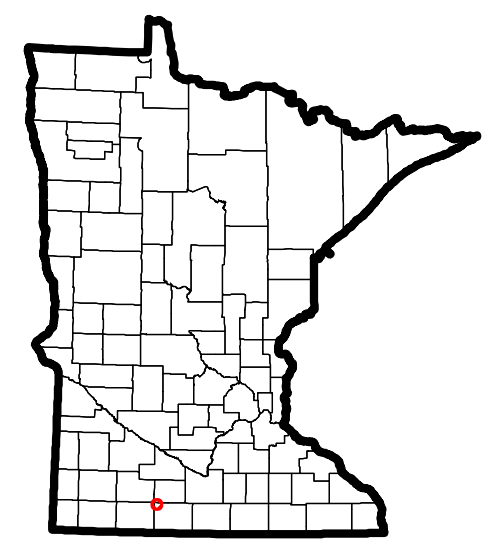
**FIGURE 5.2 (i)**  
**Locations of**  
**Residences or**  
**Farmsteads**

**LEGEND**

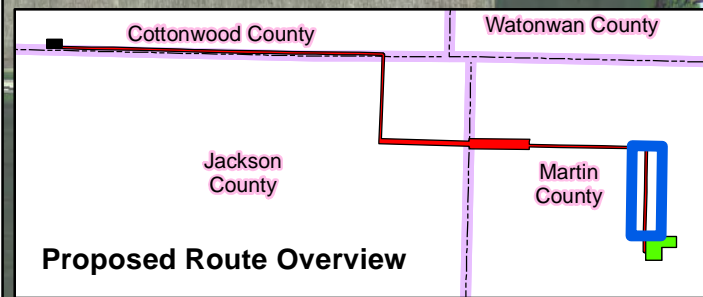
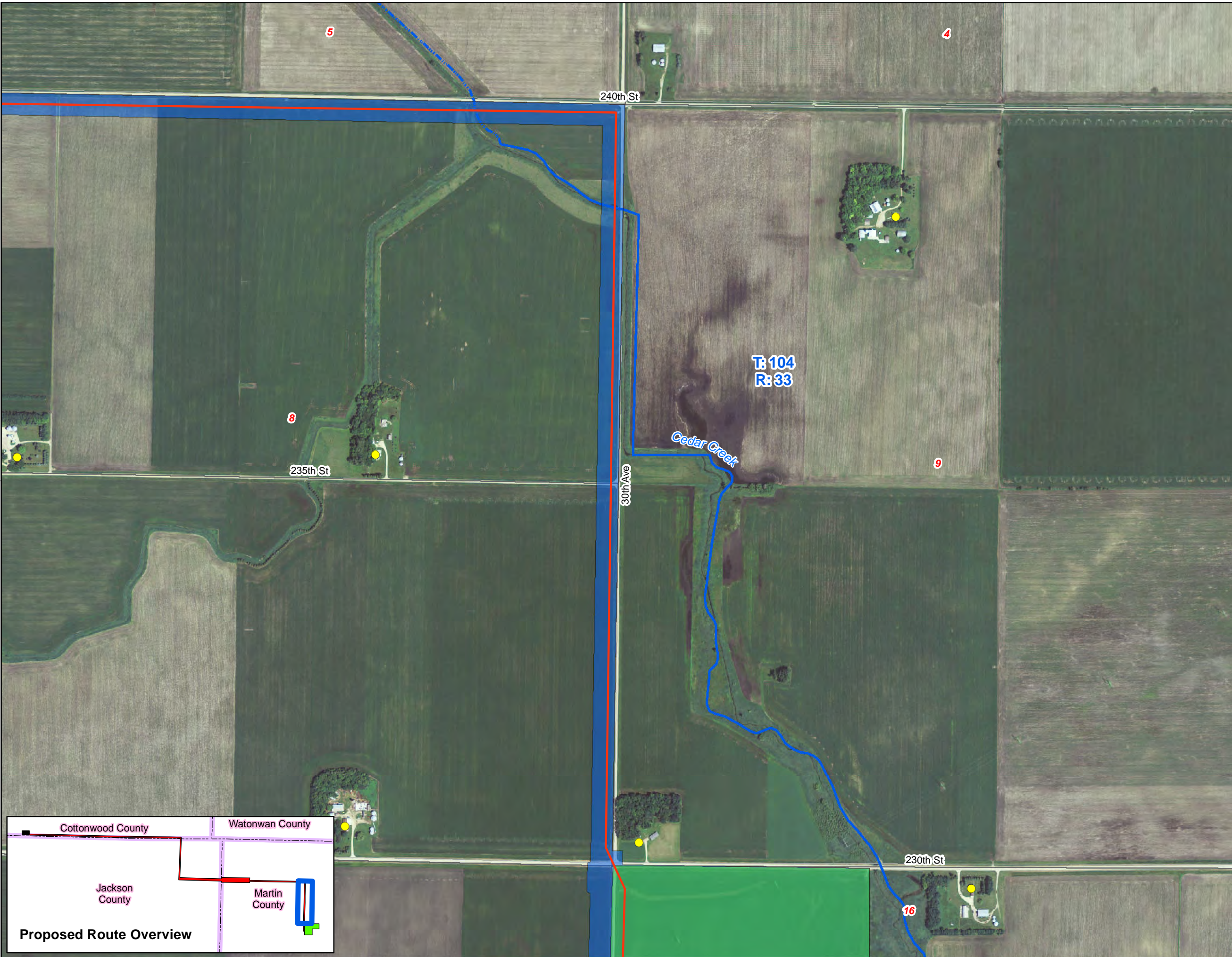
-  Residence/Farmstead
-  Anticipated Alignment
-  Woad Hill Substation
-  Proposed Route
-  Odell Wind Farm Substation



NAD 1983 UTM Zone 15N





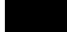


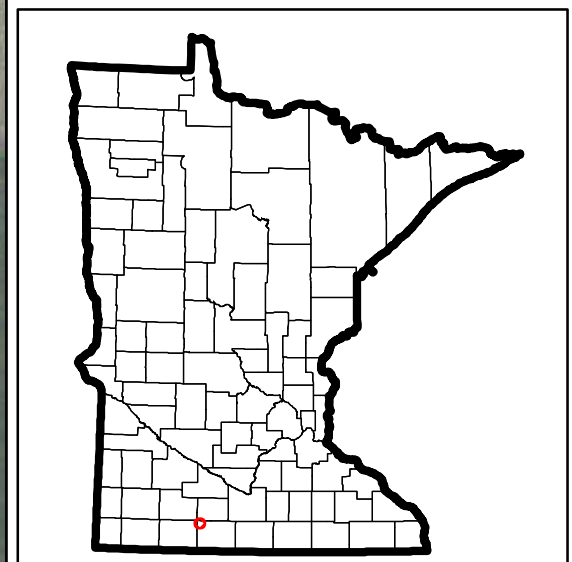
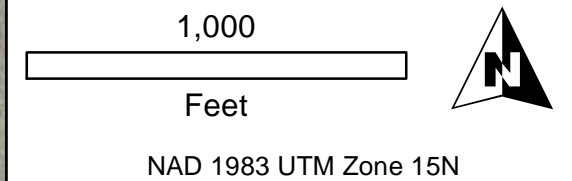
SOURCES:  
Geronimo Energy,  
Ventyx, NAIP,  
WSB, PWI



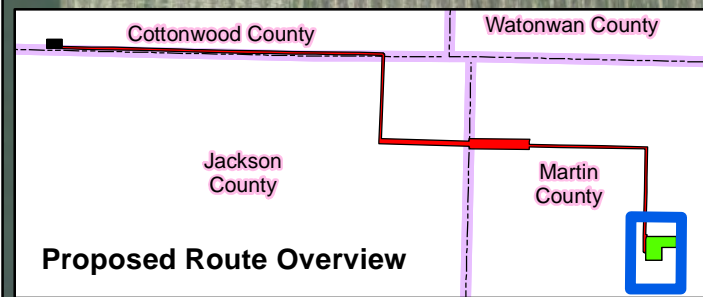
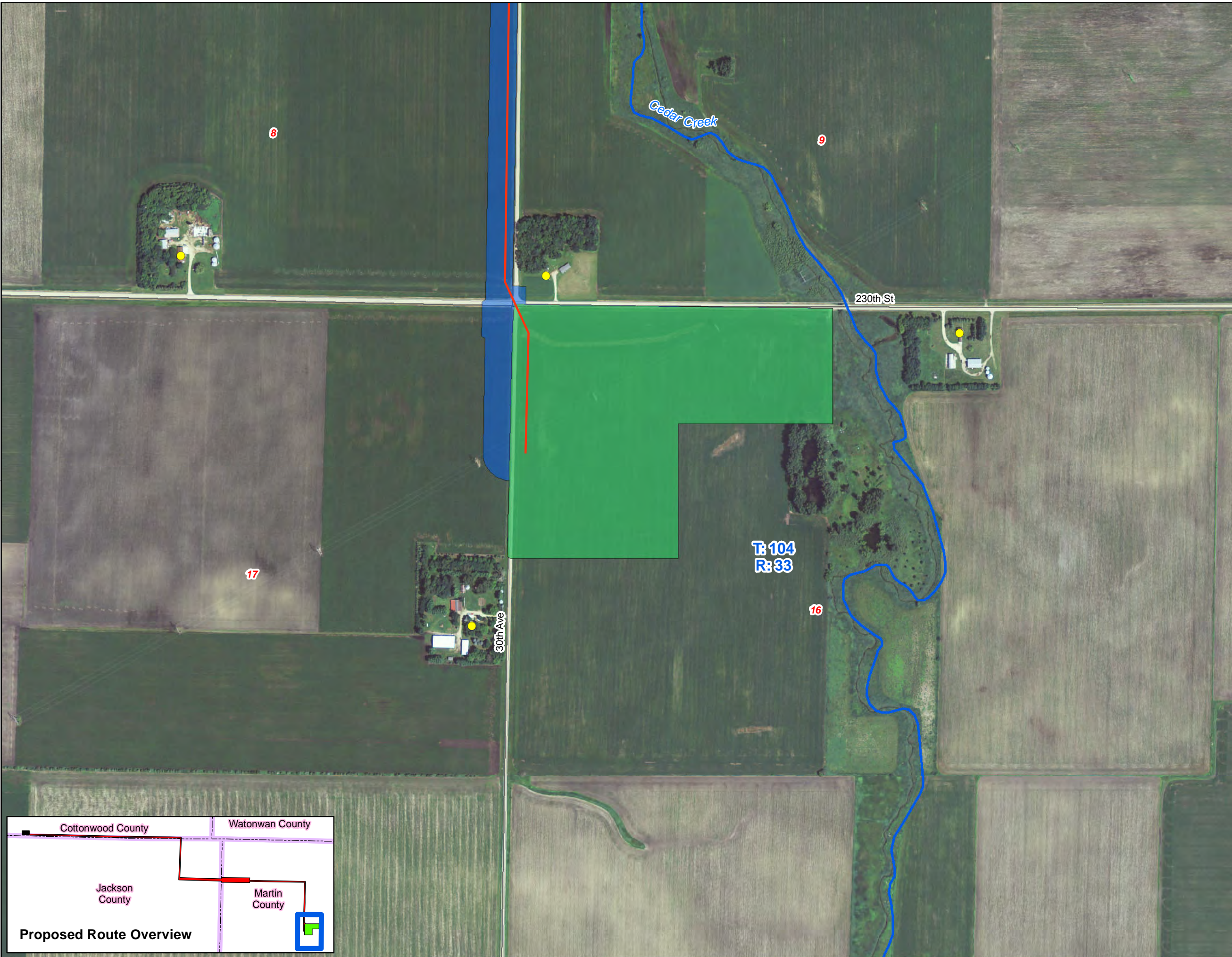
**FIGURE 5.2 (j)**  
**Locations of**  
**Residences or**  
**Farmsteads**

**LEGEND**

-  Residence/Farmstead
-  Anticipated Alignment
-  Woad Hill Substation
-  Proposed Route
-  Odell Wind Farm Substation





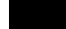
SOURCES:  
Geronimo Energy,  
Ventyx, NAIP,  
WSB, PWI









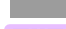



**FIGURE 5.3**  
**AES Vegetation**  
**Cover Type**


**LEGEND**

-  Wood Hill Substation
-  Proposed Route
-  Odell Wind Farm Substation

**AES Land Cover**

-  Cropland
-  Grassland
-  Emergent Wetland
-  Upland Forest
-  Open Water
-  Developed
-  Barren Land
-  County Boundary

0.5  
Miles



NAD 1983 UTM Zone 15N

