

SEE SHEET C.101

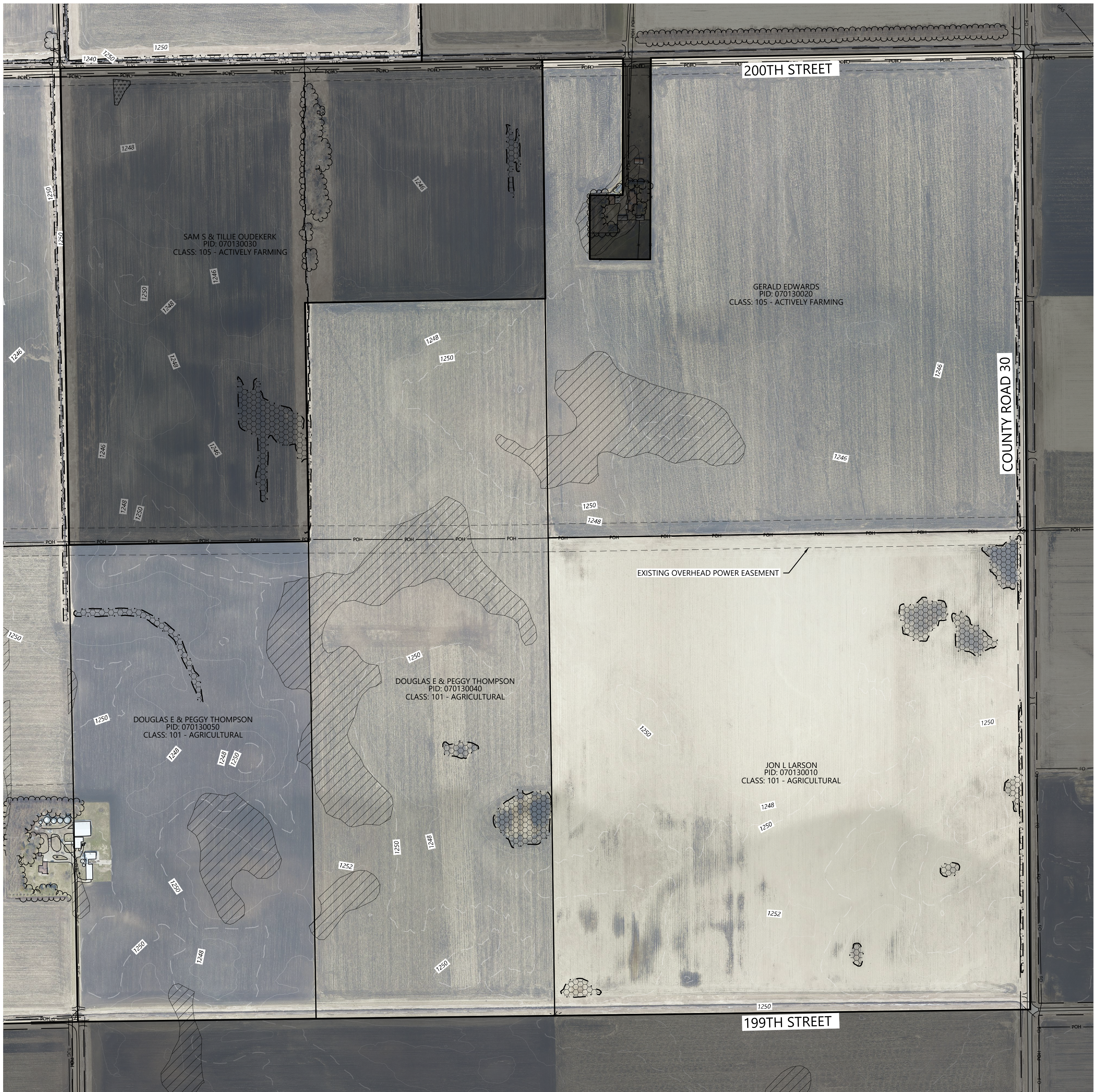

LEGEND:

- PROJECT BOUNDARY
- LOT LINES
- EX. PAVED ROAD
- EX. GRAVEL ROAD
- EX. RIGHT OF WAY LINES
- EX. EASEMENT LINES
- EX. FENCE
- EX. OVERHEAD POWER
- EX. UNDERGROUND POWER
- EX. GAS PIPELINE
- EX. FIBER OPTIC
- EX. UNDERGROUND TELEPHONE
- EX. PUBLIC OPEN DRAIN
- EX. PUBLIC DRAIN TILE
- EX. BUILDINGS LINE
- EX. 10' INTERVAL CONTOUR
- EX. 2' INTERVAL CONTOUR
- EX. PRIME FARMLAND
- EX. WETLANDS (FIELD DELINEATED)
- EX. TREELINE

KEY MAP:

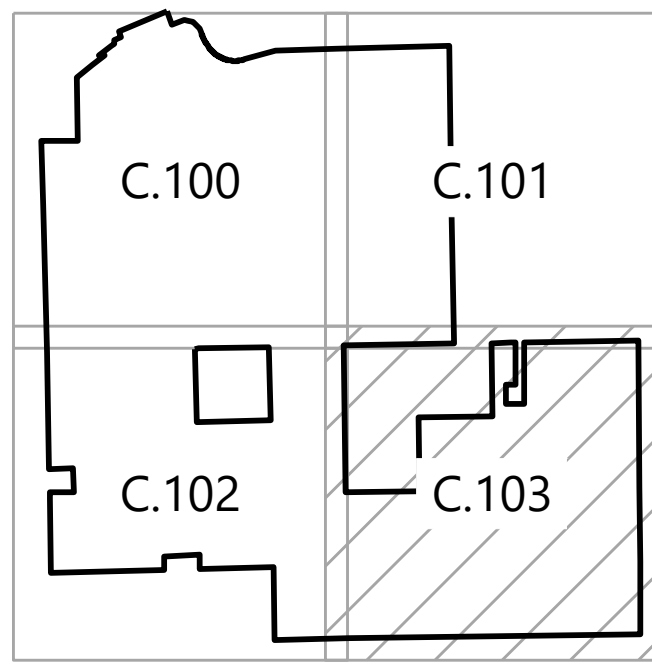

Westwood

Phone (608) 821-6600 8401 Greenway Blvd., Suite 400
Middleton, WI 53562
westwoodps.com

Westwood Professional Services, Inc.

PREPARED FOR:



10 East 53rd Street, 17th Floor
New York, NY 10022

REVISIONS:

#	DATE	COMMENT
A	12/11/2020	DRAFT - Site Plan
B	01/29/2021	Preliminary Site Plan
C	03/19/2021	Preliminary Site Plan



Hayward Solar Project

Freeborn County, Minnesota

Existing Conditions

PRELIMINARY
NOT FOR CONSTRUCTION

DATE: 03/19/2021

SHEET: C.103

03/19/2021 11:25 AM C:\Users\j... \Documents\HaywardSolar\031921\C.103.dwg

PREPARED FOR:



10 East 53rd Street, 17th Floor
New York, NY 10022

REVISIONS:

#	DATE	COMMENT
A	12/11/2020	DRAFT - Site Plan
B	01/29/2021	Preliminary Site Plan
C	03/19/2021	Preliminary Site Plan

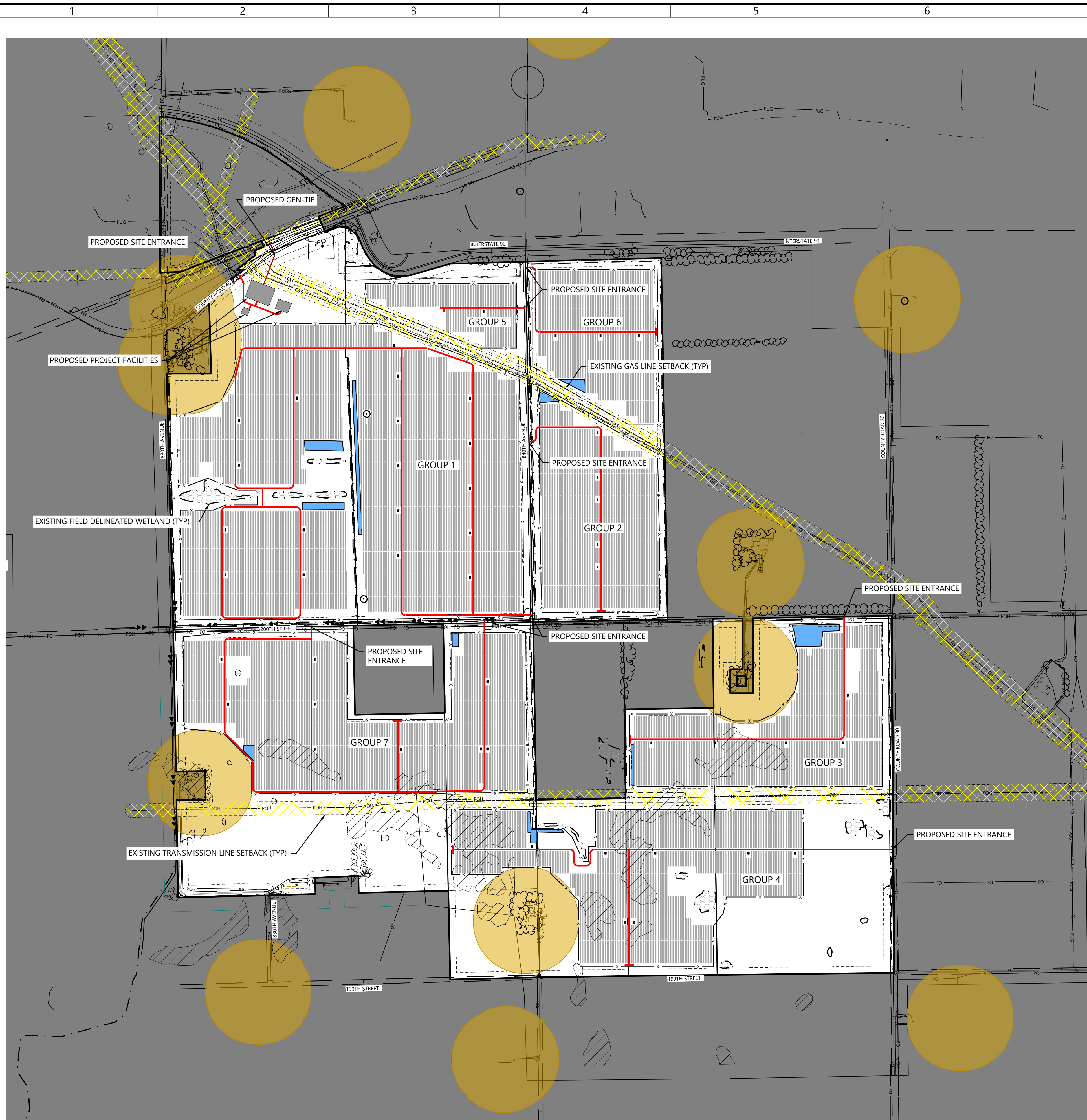

LEGEND:

- PROJECT BOUNDARY
- LOT LINES
- EX. PAVED ROAD
- EX. GRAVEL ROAD
- EX. RAILROAD
- EX. RIGHT OF WAY LINES
- EX. EASEMENT LINES
- EX. FENCE
- EX. OVERHEAD POWER
- PUG — EX. UNDERGROUND POWER
- GAS — EX. GAS PIPELINE
- FO — EX. FIBER OPTIC
- TLUG — EX. UNDERGROUND TELEPHONE
- DT — EX. DRAINTILE
- — EX. PUBLIC OPEN DRAIN
- — EX. BUILDINGS LINE
- 900 — EX. 10' INDEX CONTOUR
- — EX. 2' INTERVAL CONTOUR
- — EX. PRIME FARMLAND
- — EX. WETLANDS (FIELD DELINEATED)
- — EX. TREELINE
- — GAS AND TRANSMISSION LINE SETBACK
- — BUILDING SETBACK HATCH
- — PROPOSED PROPERTY LINE SETBACK
- — PROPOSED ACCESS ROAD
- — PROPOSED FENCE
- — UMV — PROPOSED UNDERGROUND COLLECTION
- — POH — PROPOSED ABOVEGROUND GEN-TIE
- — PROPOSED BASIN
- — PROPOSED PROJECT FACILITIES
- — PROPOSED SOLAR ARRAY
- — PROPOSED INVERTER

LAND USE	
LEASED LAND	TBD AC
FENCED AREA	1196 AC
PRIME FARMLAND IMPACTED	TBD AC

JURISDICTIONAL SETBACKS	
PROPERTY LINES	100'
ROAD RIGHT OF WAY	100'
OTHER RIGHT OF WAY'S	50'
PRIMARY STRUCTURES ON ADJACENT PROPERTY - AGRICULTURAL ZONE	500'
PRIMARY STRUCTURES ON ADJACENT PROPERTY - PD, I, B-1 AND B-2 ZONES	750'
WETLANDS	100'
PUBLIC DRAINTILE	30'
PUBLIC DRAINAGE DITCH	50'
TRANSMISSION LINES	50' FROM RIGHT OF WAY
PIPELINES	50' FROM RIGHT OF WAY
WATER WELLS	50'

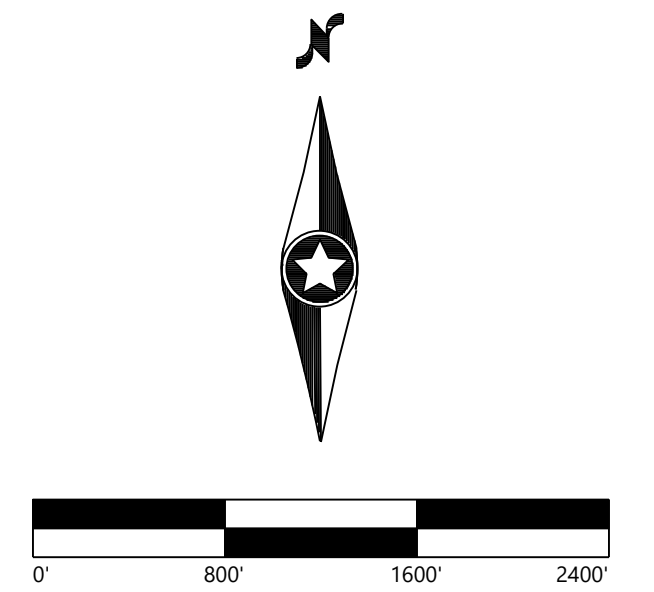

Hayward Solar Project

Freeborn County, Minnesota

Overall Site Plan

PRELIMINARY
NOT FOR CONSTRUCTION

DATE: 03/19/2021

SHEET: C.200

PREPARED FOR:



10 East 53rd Street, 17th Floor
New York, NY 10022

REVISIONS:

#	DATE	COMMENT
A	12/11/2020	DRAFT - Site Plan
B	01/29/2021	Preliminary Site Plan
C	03/19/2021	Preliminary Site Plan

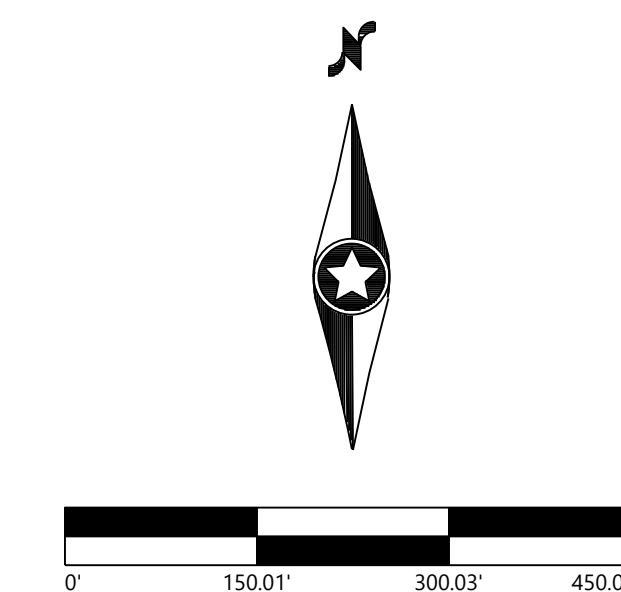

LEGEND:

- PROJECT BOUNDARY
- LOT LINES
- EX. PAVED ROAD
- EX. GRAVEL ROAD
- EX. RAILROAD
- EX. RIGHT OF WAY LINES
- EX. EASEMENT LINES
- EX. FENCE
- EX. OVERHEAD POWER
- EX. UNDERGROUND POWER
- EX. GAS PIPELINE
- EX. FIBER OPTIC
- EX. UNDERGROUND TELEPHONE
- EX. PUBLIC DRAIN TILE
- EX. BUILDINGS LINE
- EX. 5' INDEX CONTOUR
- EX. 1' INTERVAL CONTOUR
- EX. PRIME FARMLAND
- EX. CULTURAL AREA
- EX. WETLANDS (FIELD DELINEATED)
- EX. WATER WELL AND SETBACK LINE
- EX. TREELINE
- PROPOSED WETLAND SETBACK LINE
- GAS AND TRANSMISSION LINE SETBACK
- TREELINE SETBACK
- BUILDING SETBACK
- PROPOSED 5' INDEX CONTOUR
- PROPOSED 1' INTERVAL CONTOUR
- PROPOSED PROPERTY LINE SETBACK
- PROPOSED ACCESS ROAD
- PROPOSED FENCE
- PROPOSED UNDERGROUND COLLECTION
- PROPOSED COLLECTION BORING
- PROPOSED ABOVEGROUND GEN-TIE
- PROPOSED BASIN OUTLET CULVERT
- PROPOSED STORMWATER BASIN
- PROPOSED PROJECT FACILITIES
- PROPOSED SOLAR ARRAY
- PROPOSED INVERTER
- PROPOSED DRAINAGE CROSSING
- PROPOSED ENTRANCE CULVERT

KEY MAP:

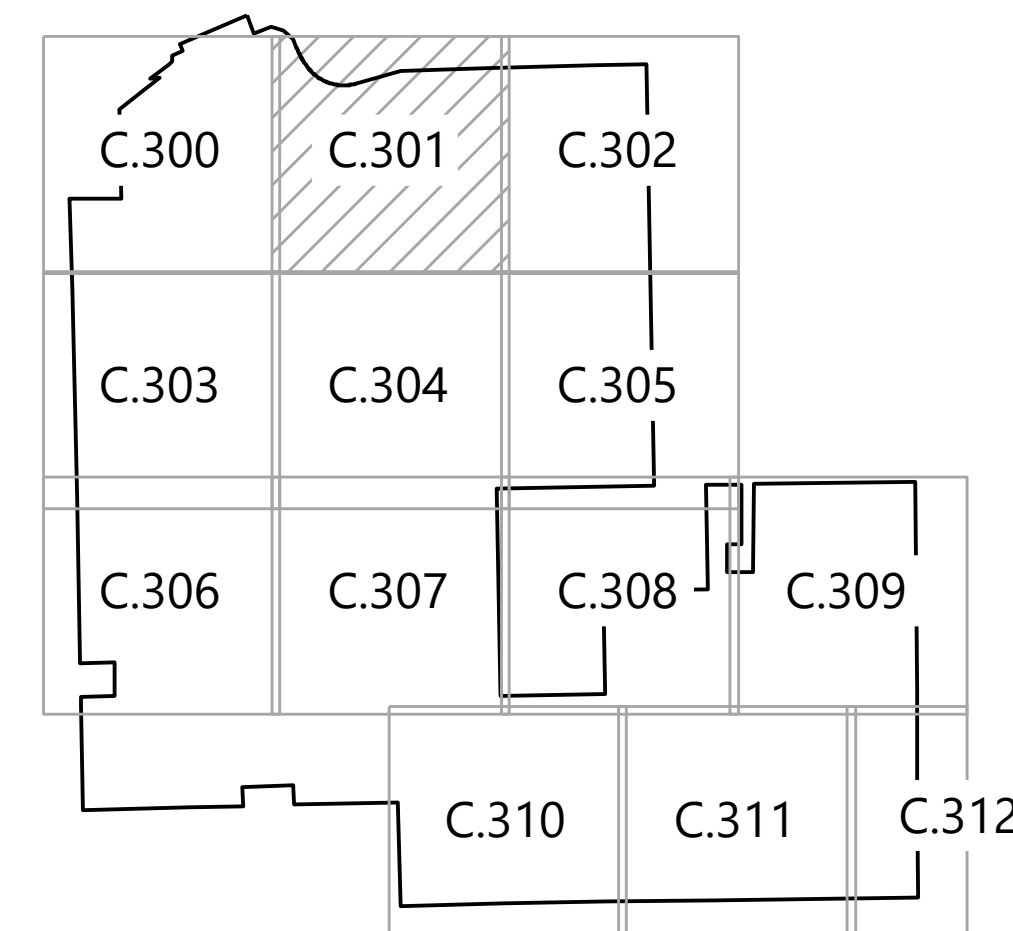

Hayward Solar Project

Freeborn County, Minnesota

Site Plan

PRELIMINARY
NOT FOR CONSTRUCTION

DATE: 03/19/2021

SHEET: C.301

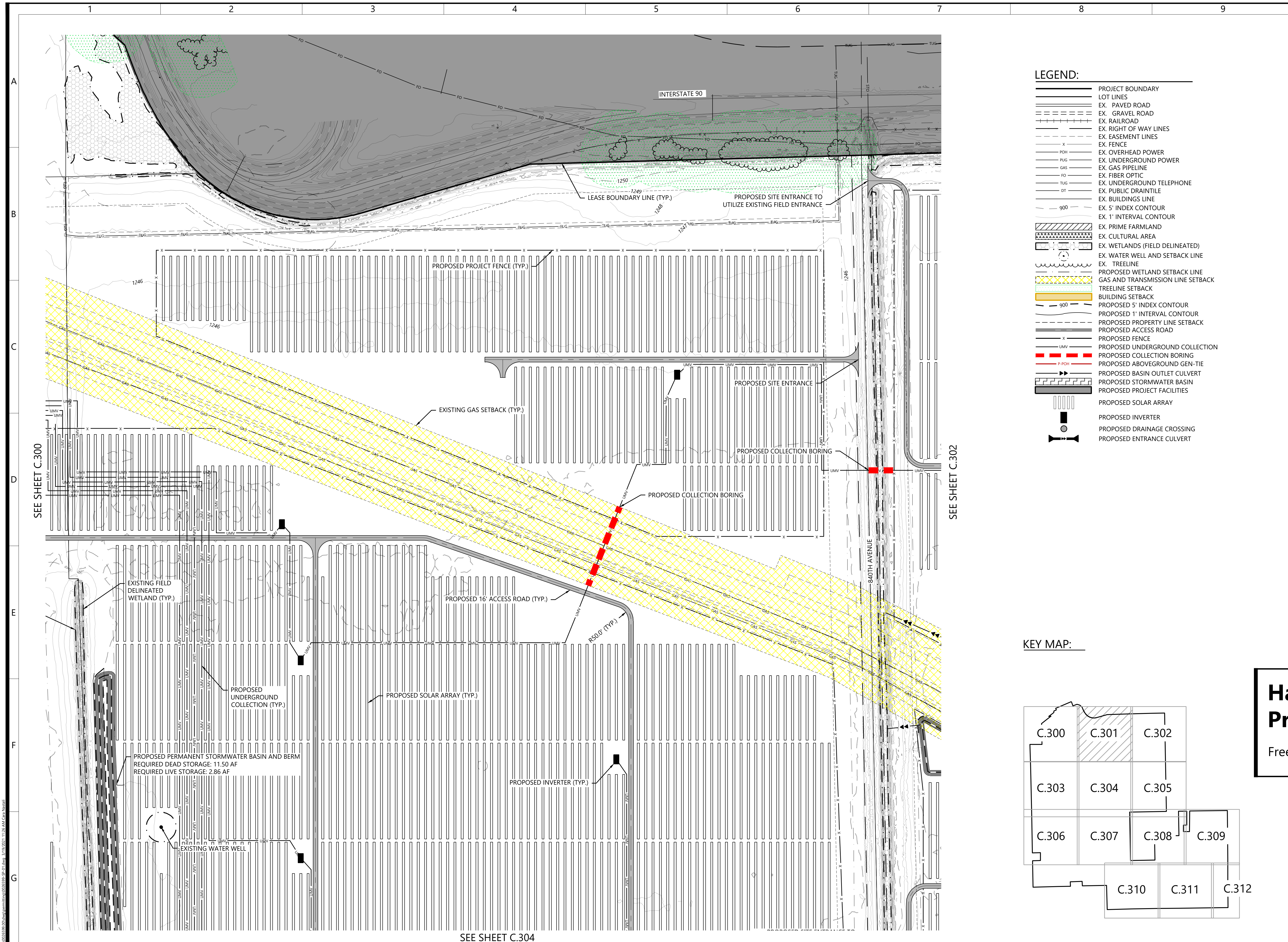

03/19/2021 11:25 AM C:\Users\j... \Documents\HaywardSolar\SitePlan\031921_SitePlan_C301.dwg

PREPARED FOR:



10 East 53rd Street, 17th Floor
New York, NY 10022

REVISIONS:

#	DATE	COMMENT
A	12/11/2020	DRAFT - Site Plan
B	01/29/2021	Preliminary Site Plan
C	03/19/2021	Preliminary Site Plan

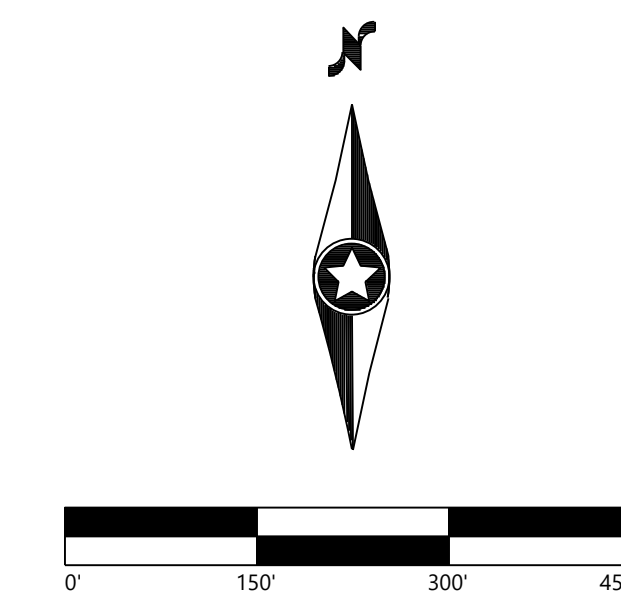

LEGEND:

- PROJECT BOUNDARY
- LOT LINES
- EX. PAVED ROAD
- EX. GRAVEL ROAD
- EX. RAILROAD
- EX. RIGHT OF WAY LINES
- EX. EASEMENT LINES
- EX. FENCE
- EX. OVERHEAD POWER
- EX. UNDERGROUND POWER
- EX. GAS PIPELINE
- EX. FIBER OPTIC
- EX. UNDERGROUND TELEPHONE
- EX. PUBLIC DRAIN TILE
- EX. BUILDINGS LINE
- EX. 5' INDEX CONTOUR
- EX. 1' INTERVAL CONTOUR
- EX. PRIME FARMLAND
- EX. CULTURAL AREA
- EX. WETLANDS (FIELD DELINEATED)
- EX. WATER WELL AND SETBACK LINE
- EX. TREELINE
- PROPOSED WETLAND SETBACK LINE
- GAS AND TRANSMISSION LINE SETBACK
- TREELINE SETBACK
- BUILDING SETBACK
- PROPOSED 5' INDEX CONTOUR
- PROPOSED 1' INTERVAL CONTOUR
- PROPOSED PROPERTY LINE SETBACK
- PROPOSED ACCESS ROAD
- PROPOSED FENCE
- PROPOSED UNDERGROUND COLLECTION
- PROPOSED COLLECTION BORING
- PROPOSED ABOVEGROUND GEN-TIE
- PROPOSED BASIN OUTLET CULVERT
- PROPOSED STORMWATER BASIN
- PROPOSED PROJECT FACILITIES
- PROPOSED SOLAR ARRAY
- PROPOSED INVERTER
- PROPOSED DRAINAGE CROSSING
- PROPOSED ENTRANCE CULVERT

KEY MAP:

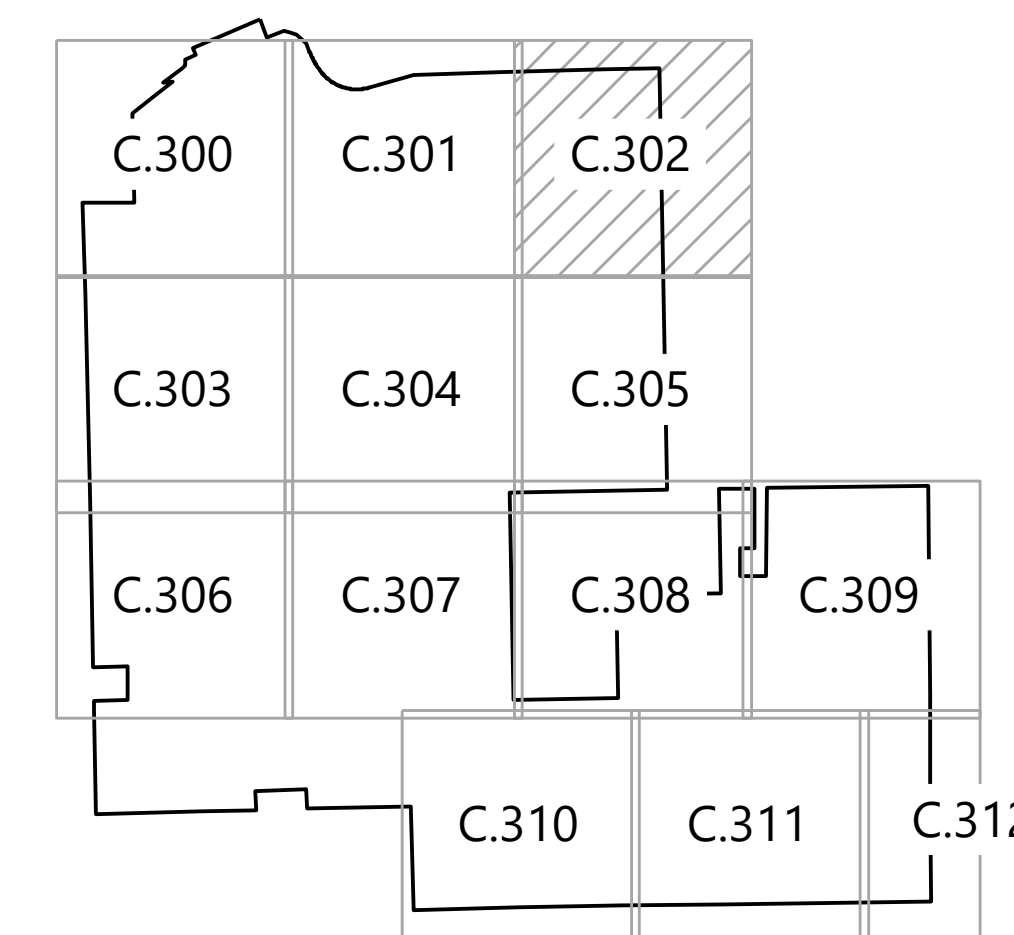

Hayward Solar Project

Freeborn County, Minnesota

Site Plan

PRELIMINARY
NOT FOR CONSTRUCTION

DATE: 03/19/2021

SHEET: C.302

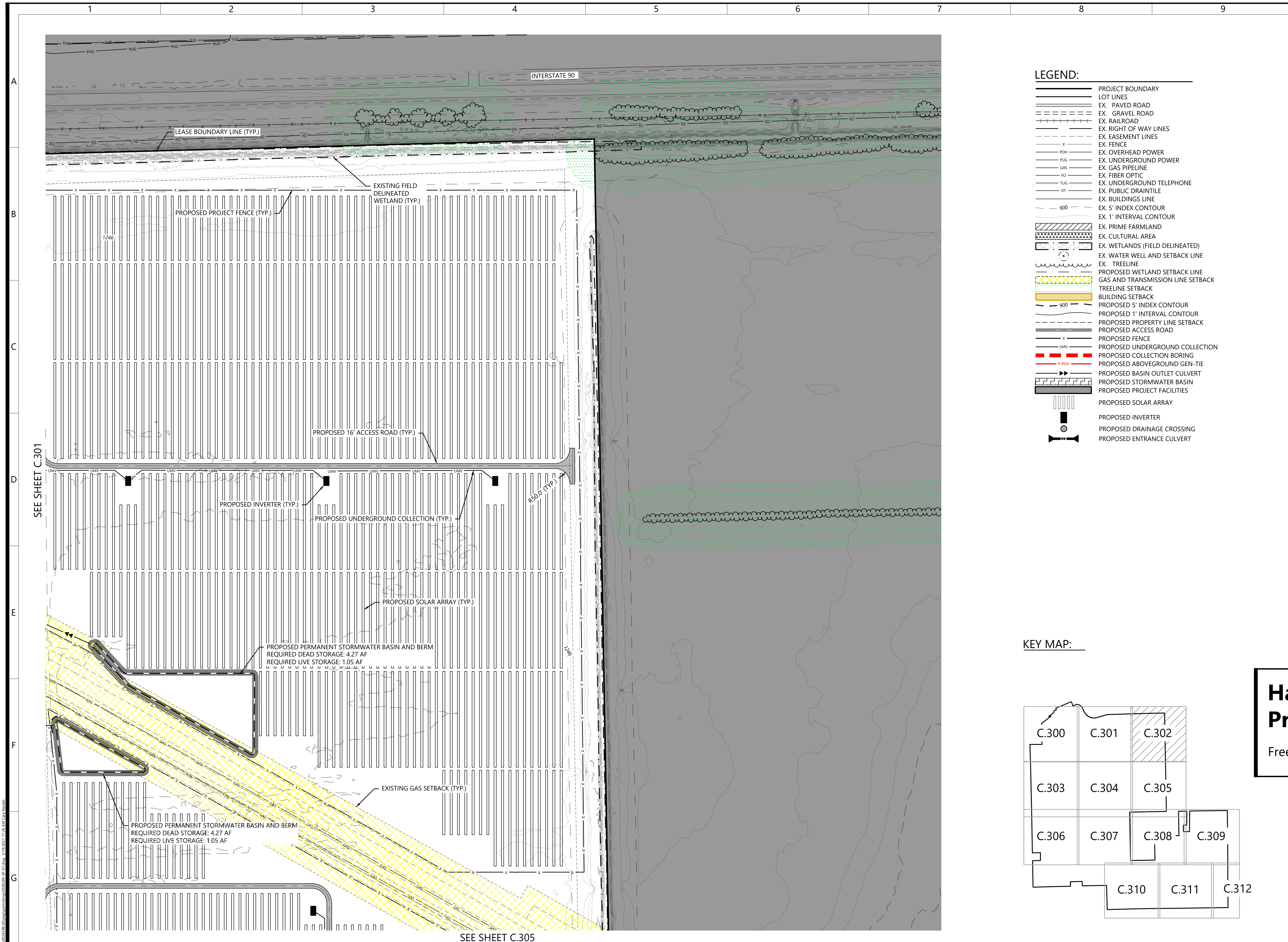

02025598.DWG (03/19/2021 11:25 AM) C:\Users\j... \Public\02025598.dwg

SEE SHEET C.305

SEE SHEET C.301

PREPARED FOR:



10 East 53rd Street, 17th Floor
New York, NY 10022

REVISIONS:

#	DATE	COMMENT
A	12/11/2020	DRAFT - Site Plan
B	01/29/2021	Preliminary Site Plan
C	03/19/2021	Preliminary Site Plan

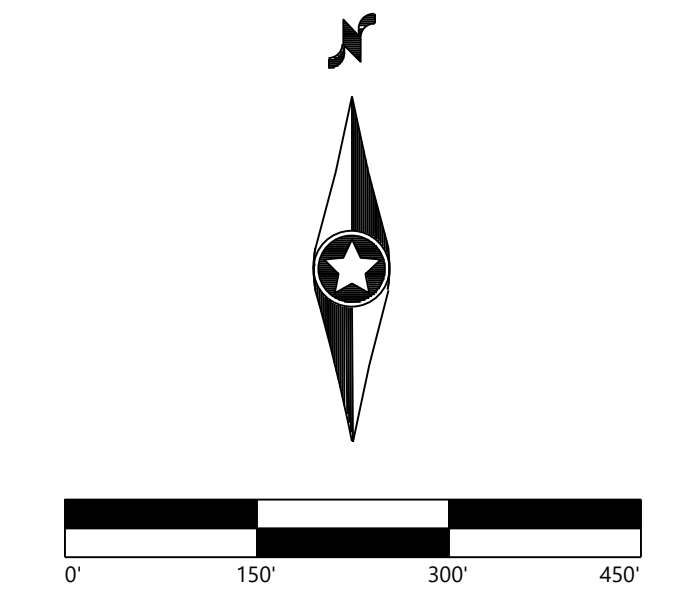

Hayward Solar Project

Freeborn County, Minnesota

Site Plan

**PRELIMINARY
NOT FOR CONSTRUCTION**

DATE: 03/19/2021

SHEET: C.303

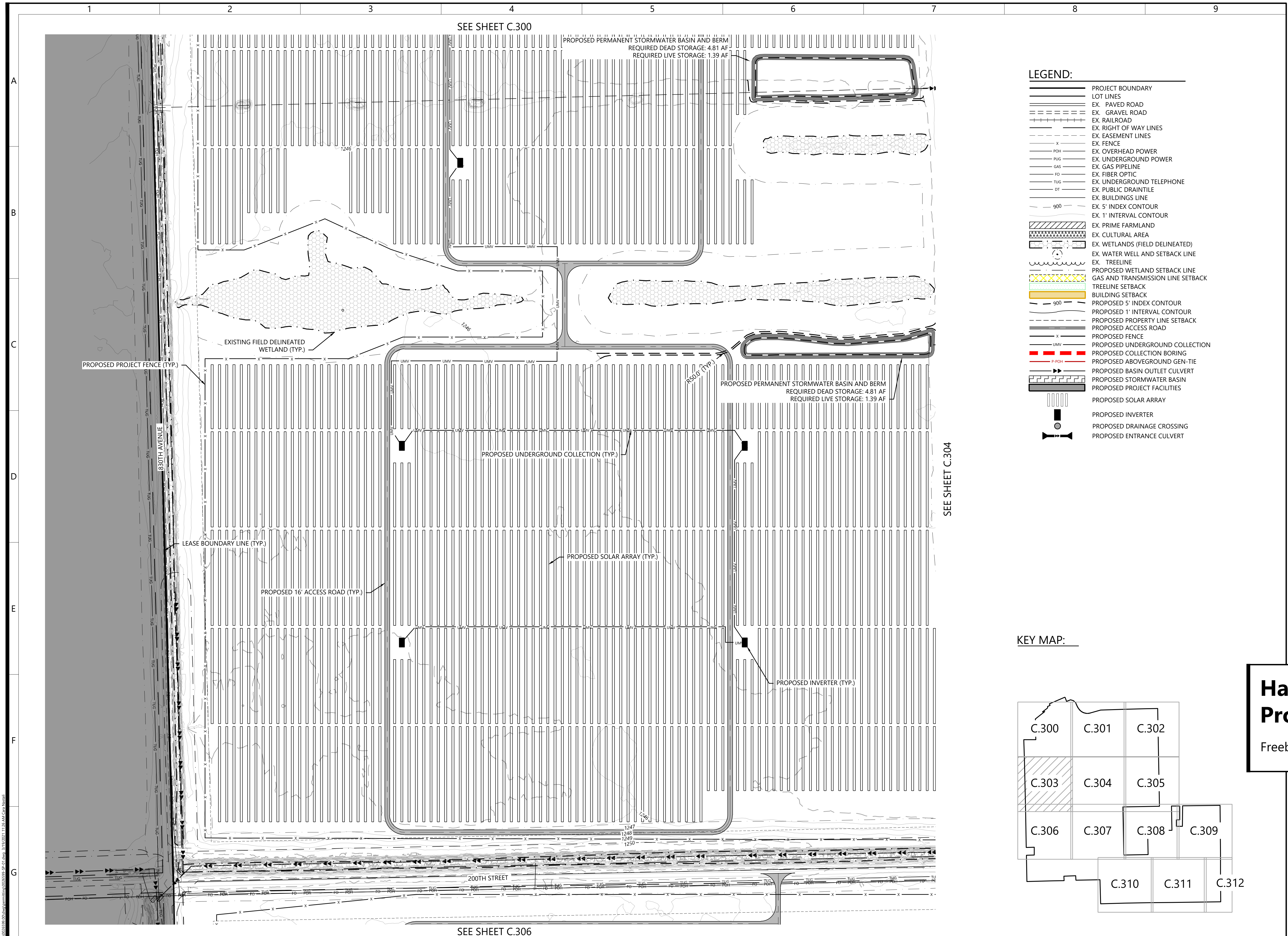

LEGEND:

- PROJECT BOUNDARY
- LOT LINES
- EX. PAVED ROAD
- EX. GRAVEL ROAD
- EX. RAILROAD
- EX. RIGHT OF WAY LINES
- EX. EASEMENT LINES
- EX. FENCE
- EX. OVERHEAD POWER
- EX. UNDERGROUND POWER
- EX. GAS PIPELINE
- EX. FIBER OPTIC
- EX. UNDERGROUND TELEPHONE
- EX. PUBLIC DRAIN TILE
- EX. BUILDINGS LINE
- EX. 5' INDEX CONTOUR
- EX. 1' INTERVAL CONTOUR
- EX. PRIME FARMLAND
- EX. CULTURAL AREA
- EX. WETLANDS (FIELD DELINEATED)
- EX. WATER WELL AND SETBACK LINE
- EX. TREELINE
- PROPOSED WETLAND SETBACK LINE
- GAS AND TRANSMISSION LINE SETBACK
- TREELINE SETBACK
- BUILDING SETBACK
- PROPOSED 5' INDEX CONTOUR
- PROPOSED 1' INTERVAL CONTOUR
- PROPOSED PROPERTY LINE SETBACK
- PROPOSED ACCESS ROAD
- PROPOSED FENCE
- PROPOSED UNDERGROUND COLLECTION
- PROPOSED COLLECTION BORING
- PROPOSED ABOVEGROUND GEN-TIE
- PROPOSED BASIN OUTLET CULVERT
- PROPOSED STORMWATER BASIN
- PROPOSED PROJECT FACILITIES
- PROPOSED SOLAR ARRAY
- PROPOSED INVERTER
- PROPOSED DRAINAGE CROSSING
- PROPOSED ENTRANCE CULVERT

KEY MAP:

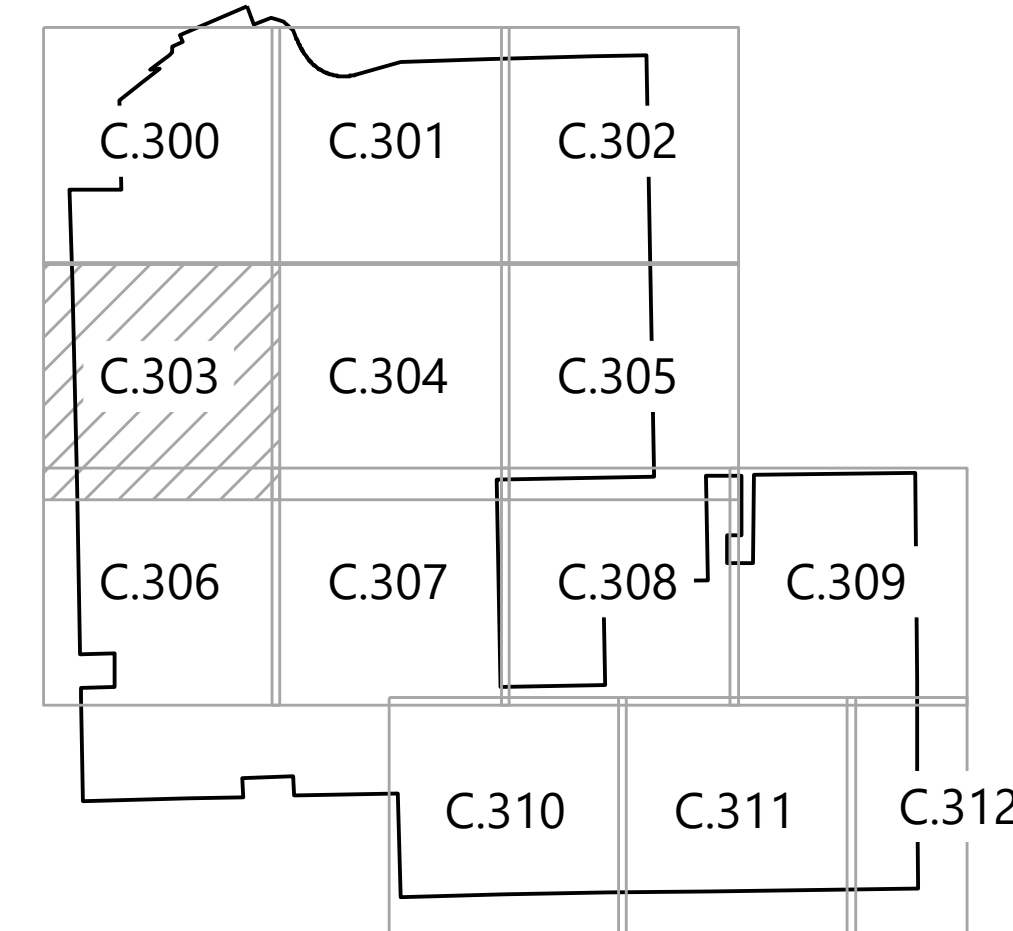

03/19/2021 11:25 AM C:\Users\j... \Documents\HaywardSolar\031921_SitePlan.dwg

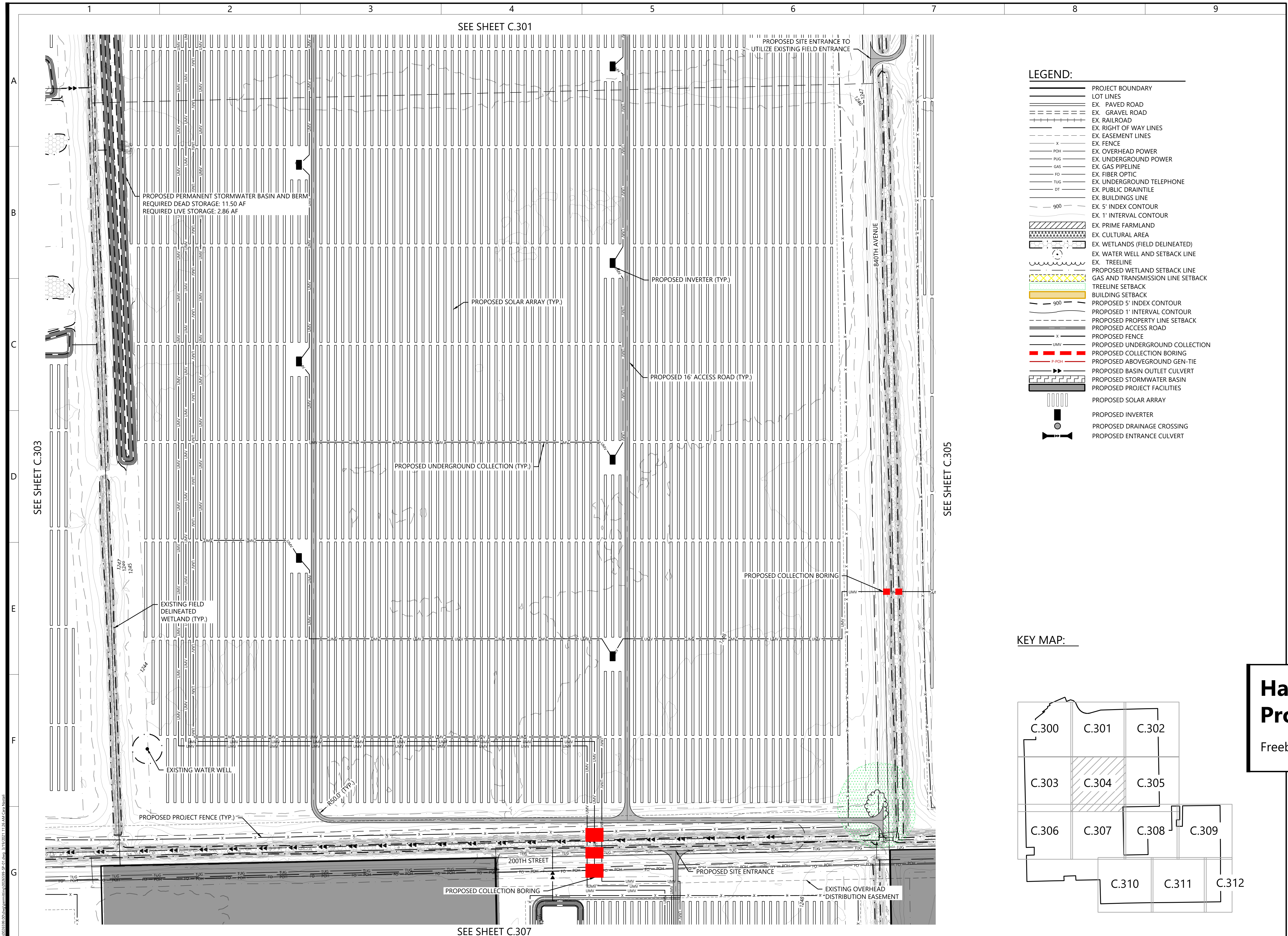

SEE SHEET C.301

SEE SHEET C.307

SEE SHEET C.303

SEE SHEET C.305

- LEGEND:**
- PROJECT BOUNDARY
 - LOT LINES
 - EX. PAVED ROAD
 - EX. GRAVEL ROAD
 - EX. RAILROAD
 - EX. RIGHT OF WAY LINES
 - EX. EASEMENT LINES
 - EX. FENCE
 - EX. OVERHEAD POWER
 - EX. UNDERGROUND POWER
 - EX. GAS PIPELINE
 - EX. FIBER OPTIC
 - EX. UNDERGROUND TELEPHONE
 - EX. PUBLIC DRAINILE
 - EX. BUILDINGS LINE
 - EX. 5' INDEX CONTOUR
 - EX. 1' INTERVAL CONTOUR
 - EX. PRIME FARMLAND
 - EX. CULTURAL AREA
 - EX. WETLANDS (FIELD DELINEATED)
 - EX. WATER WELL AND SETBACK LINE
 - EX. TREELINE
 - PROPOSED WETLAND SETBACK LINE
 - GAS AND TRANSMISSION LINE SETBACK
 - TREELINE SETBACK
 - BUILDING SETBACK
 - PROPOSED 5' INDEX CONTOUR
 - PROPOSED 1' INTERVAL CONTOUR
 - PROPOSED PROPERTY LINE SETBACK
 - PROPOSED ACCESS ROAD
 - PROPOSED FENCE
 - PROPOSED UNDERGROUND COLLECTION
 - PROPOSED COLLECTION BORING
 - PROPOSED ABOVEGROUND GEN-TIE
 - PROPOSED BASIN OUTLET CULVERT
 - PROPOSED STORMWATER BASIN
 - PROPOSED PROJECT FACILITIES
 - PROPOSED SOLAR ARRAY
 - PROPOSED INVERTER
 - PROPOSED DRAINAGE CROSSING
 - PROPOSED ENTRANCE CULVERT

KEY MAP:

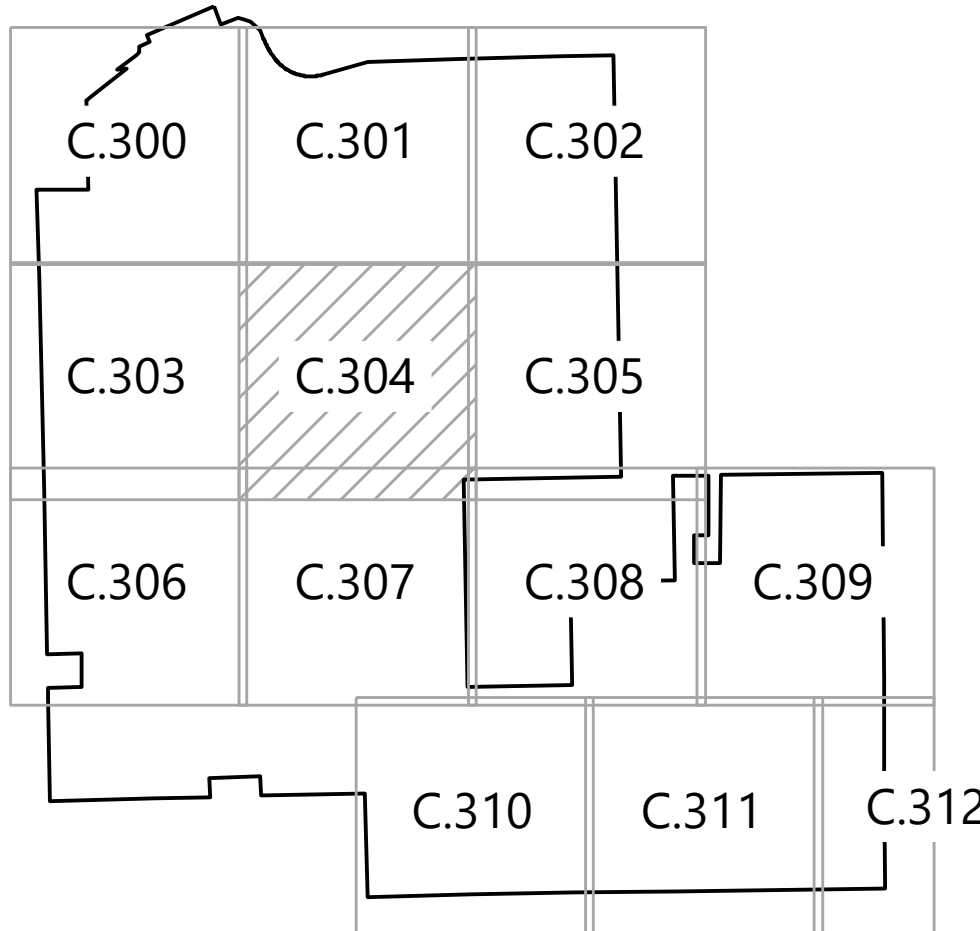

Westwood

Phone (608) 821-6600 8401 Greenway Blvd., Suite 400
Middleton, WI 53562
westwoodps.com

Westwood Professional Services, Inc.

PREPARED FOR:

CapitalDynamics
TRULY INVESTED.

10 East 53rd Street, 17th Floor
New York, NY 10022

REVISIONS:

#	DATE	COMMENT
A	12/11/2020	DRAFT - Site Plan
B	01/29/2021	Preliminary Site Plan
C	03/19/2021	Preliminary Site Plan

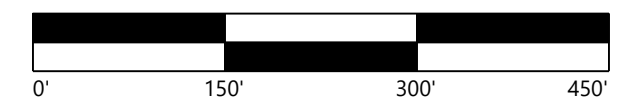

Hayward Solar Project

Freeborn County, Minnesota

Site Plan

**PRELIMINARY
NOT FOR CONSTRUCTION**

DATE: 03/19/2021

SHEET: C.304

03/19/2021 11:25 AM C:\Users\j... \Documents\HaywardSolar\031921\031921.dwg

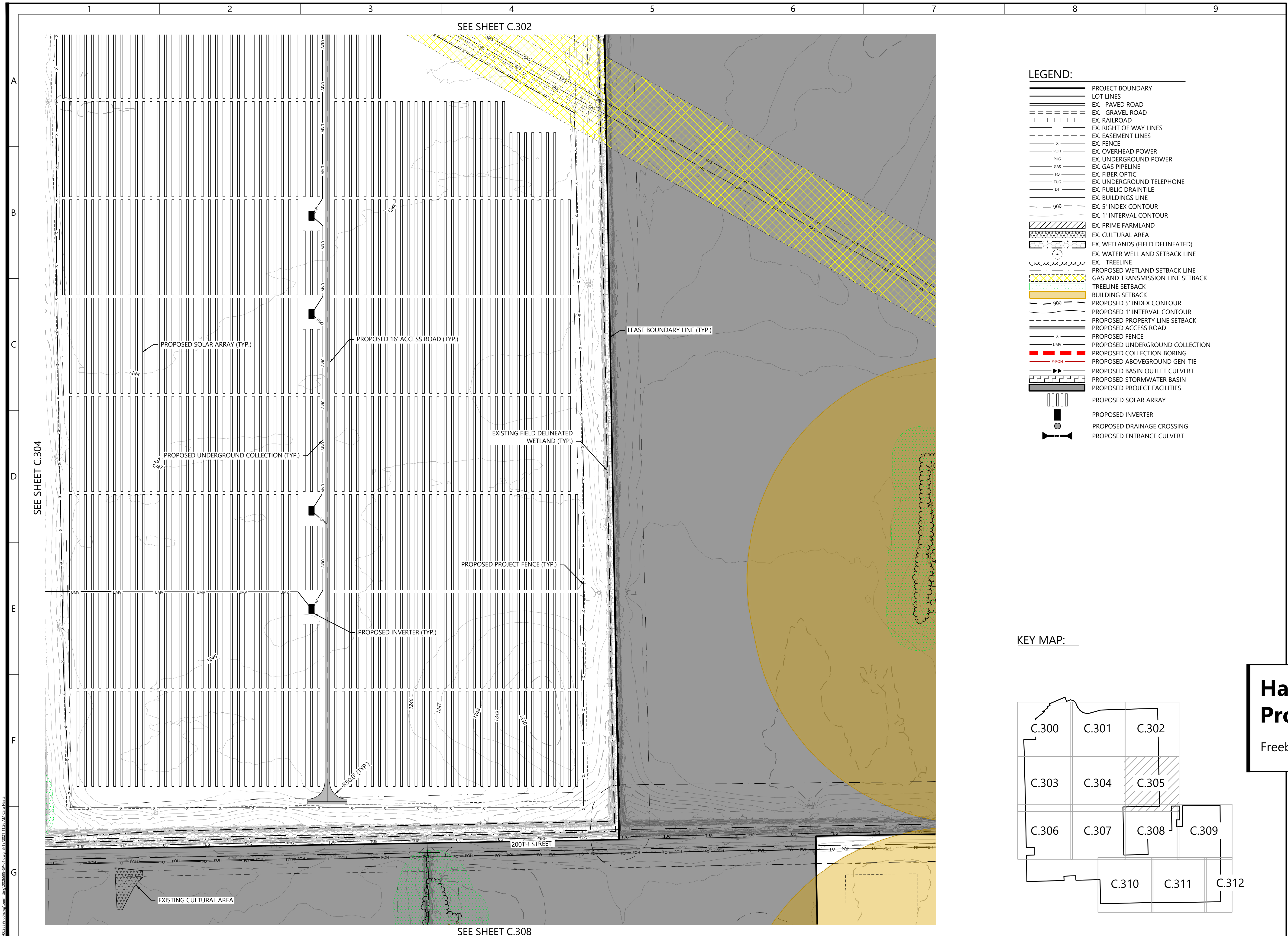

PREPARED FOR:



10 East 53rd Street, 17th Floor
New York, NY 10022

REVISIONS:

#	DATE	COMMENT
A	12/11/2020	DRAFT - Site Plan
B	01/29/2021	Preliminary Site Plan
C	03/19/2021	Preliminary Site Plan

- LEGEND:**
- PROJECT BOUNDARY
 - LOT LINES
 - EX. PAVED ROAD
 - EX. GRAVEL ROAD
 - EX. RAILROAD
 - EX. RIGHT OF WAY LINES
 - EX. EASEMENT LINES
 - EX. FENCE
 - EX. OVERHEAD POWER
 - EX. UNDERGROUND POWER
 - EX. GAS PIPELINE
 - EX. FIBER OPTIC
 - EX. UNDERGROUND TELEPHONE
 - EX. PUBLIC DRAIN TILE
 - EX. BUILDINGS LINE
 - EX. 5' INDEX CONTOUR
 - EX. 1' INTERVAL CONTOUR
 - EX. PRIME FARMLAND
 - EX. CULTURAL AREA
 - EX. WETLANDS (FIELD DELINEATED)
 - EX. WATER WELL AND SETBACK LINE
 - EX. TREELINE
 - PROPOSED WETLAND SETBACK LINE
 - GAS AND TRANSMISSION LINE SETBACK
 - TREELINE SETBACK
 - BUILDING SETBACK
 - PROPOSED 5' INDEX CONTOUR
 - PROPOSED 1' INTERVAL CONTOUR
 - PROPOSED PROPERTY LINE SETBACK
 - PROPOSED ACCESS ROAD
 - PROPOSED FENCE
 - PROPOSED UNDERGROUND COLLECTION
 - PROPOSED COLLECTION BORING
 - PROPOSED ABOVEGROUND GEN-TIE
 - PROPOSED BASIN OUTLET CULVERT
 - PROPOSED STORMWATER BASIN
 - PROPOSED PROJECT FACILITIES
 - PROPOSED SOLAR ARRAY
 - PROPOSED INVERTER
 - PROPOSED DRAINAGE CROSSING
 - PROPOSED ENTRANCE CULVERT

KEY MAP:

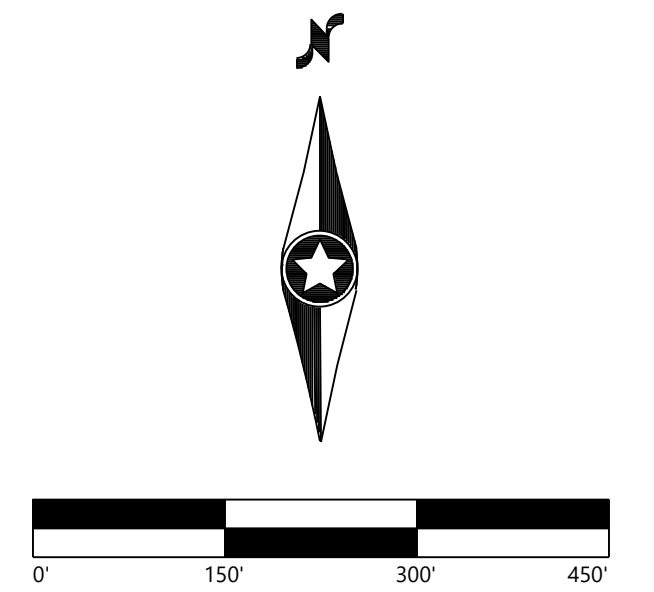
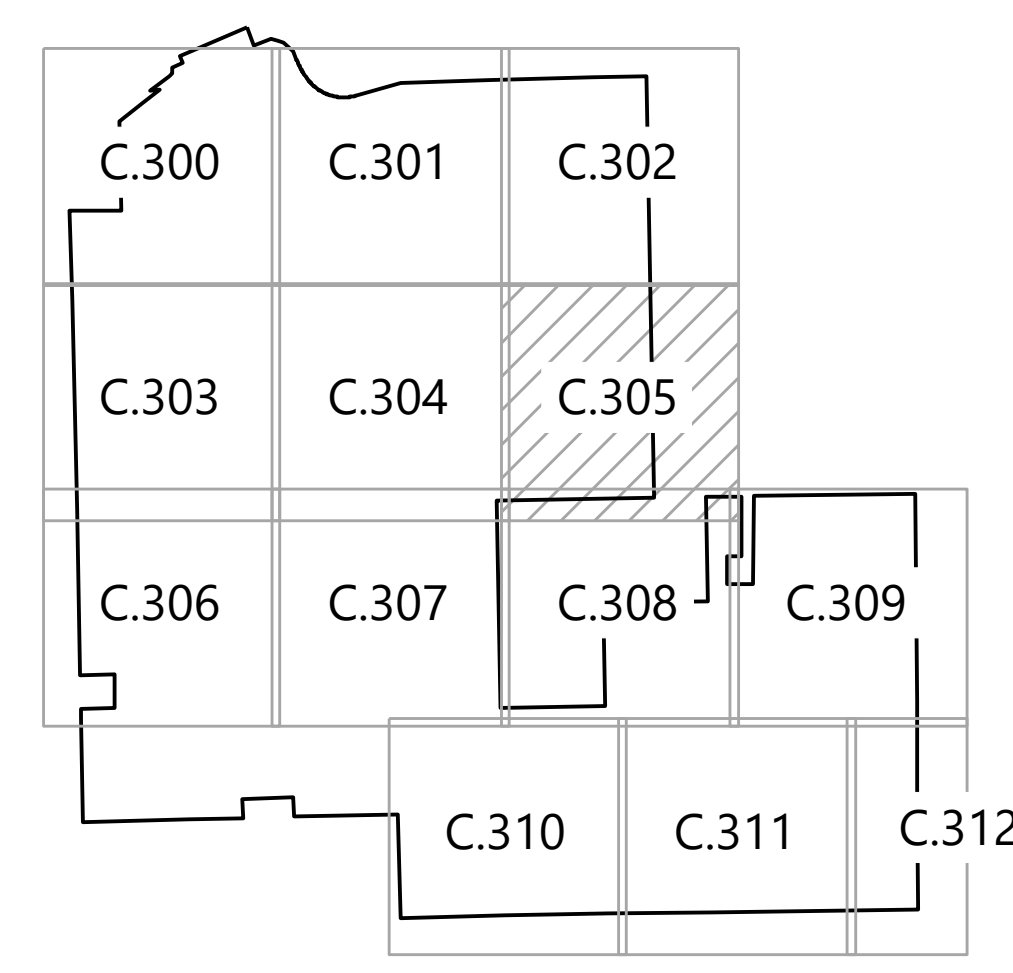

Hayward Solar Project

Freeborn County, Minnesota

Site Plan

PRELIMINARY
NOT FOR CONSTRUCTION

DATE: 03/19/2021

SHEET: C.305

03/19/2021 11:25:41 AM C:\305.dwg

PREPARED FOR:



10 East 53rd Street, 17th Floor
New York, NY 10022

REVISIONS:

#	DATE	COMMENT
A	12/11/2020	DRAFT - Site Plan
B	01/29/2021	Preliminary Site Plan
C	03/19/2021	Preliminary Site Plan

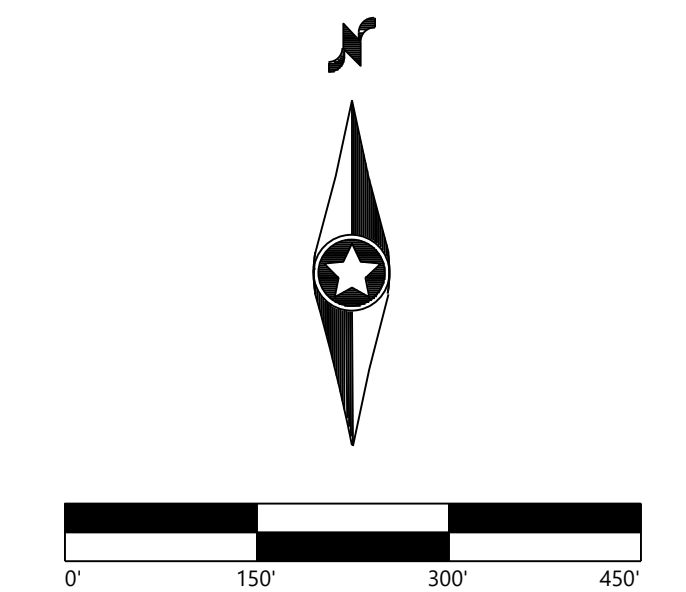

Hayward Solar Project

Freeborn County, Minnesota

Site Plan

**PRELIMINARY
NOT FOR CONSTRUCTION**

DATE: 03/19/2021

SHEET: C.306

SEE SHEET C.303

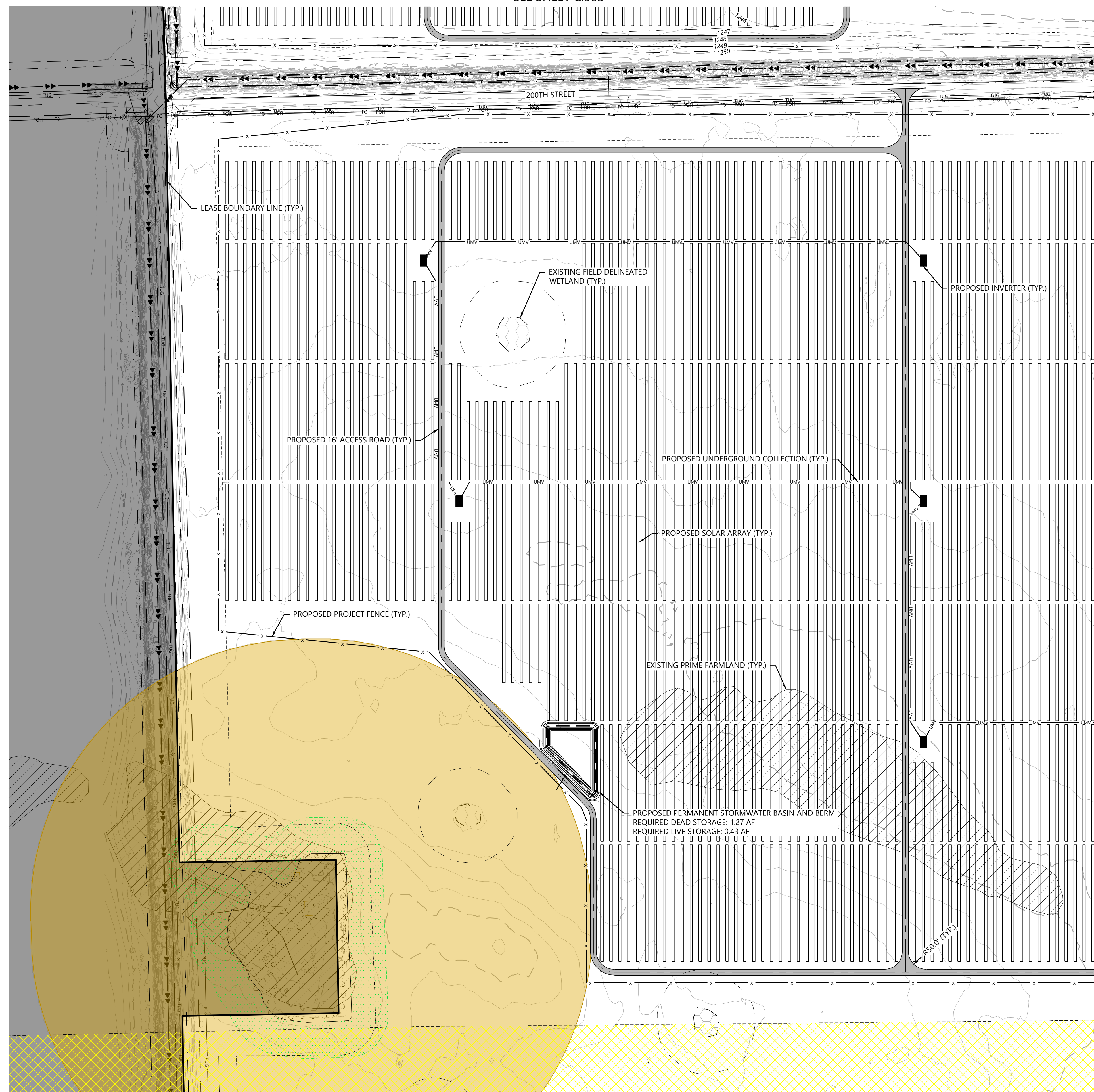

SEE SHEET C.307

LEGEND:

- PROJECT BOUNDARY
- LOT LINES
- EX. PAVED ROAD
- EX. GRAVEL ROAD
- EX. RAILROAD
- EX. RIGHT OF WAY LINES
- EX. EASEMENT LINES
- EX. FENCE
- EX. OVERHEAD POWER
- EX. UNDERGROUND POWER
- EX. GAS PIPELINE
- EX. FIBER OPTIC
- EX. UNDERGROUND TELEPHONE
- EX. PUBLIC DRAIN TILE
- EX. BUILDINGS LINE
- EX. 5' INDEX CONTOUR
- EX. 1' INTERVAL CONTOUR
- EX. PRIME FARMLAND
- EX. CULTURAL AREA
- EX. WETLANDS (FIELD DELINEATED)
- EX. WATER WELL AND SETBACK LINE
- EX. TREELINE
- PROPOSED WETLAND SETBACK LINE
- GAS AND TRANSMISSION LINE SETBACK
- TREELINE SETBACK
- BUILDING SETBACK
- PROPOSED 5' INDEX CONTOUR
- PROPOSED 1' INTERVAL CONTOUR
- PROPOSED PROPERTY LINE SETBACK
- PROPOSED ACCESS ROAD
- PROPOSED FENCE
- PROPOSED UNDERGROUND COLLECTION
- PROPOSED COLLECTION BORING
- PROPOSED ABOVEGROUND GEN-TIE
- PROPOSED BASIN OUTLET CULVERT
- PROPOSED STORMWATER BASIN
- PROPOSED PROJECT FACILITIES
- PROPOSED SOLAR ARRAY
- PROPOSED INVERTER
- PROPOSED DRAINAGE CROSSING
- PROPOSED ENTRANCE CULVERT

KEY MAP:

