

Appendix B

Site Plan

Elk Creek Solar

Rock County, MN

Permit Plans

PREPARED FOR:



8400 Normandale Lake Blvd, Suite 1200
 Bloomington, MN 55347

REVISIONS:

| # | DATE | COMMENT | BY | CHK | APR |
|---|------------|--------------|----|-----|-----|
| A | 05/01/2023 | Permit Plans | MB | BV | KA |

Sheet List Table

| Sheet Number | Sheet Title |
|--------------|---|
| C.100 | Cover Sheet |
| C.200 | Overall Site Plan |
| C.300 | Existing Conditions - 1 |
| C.301 | Existing Conditions - 2 |
| C.302 | Existing Conditions - 3 |
| C.303 | Existing Conditions - 4 |
| C.400 | Overall Parcel Map |
| C.401 | Site Plan - 1 |
| C.402 | Site Plan - 2 |
| C.403 | Site Plan - 3 |
| C.404 | Site Plan - 4 |
| C.405 | Site Plan - 5 |
| C.406 | Site Plan - 6 |
| C.407 | Site Plan - 7 |
| C.408 | Site Plan - 8 |
| C.409 | Site Plan - 9 |
| C.410 | Site Plan - 10 |
| C.411 | Site Plan - 11 |
| C.412 | Site Plan - 12 |
| C.413 | Site Plan - 13 |
| C.414 | Site Plan - 14 |
| C.415 | Site Plan - 15 |
| C.416 | Site Plan - 16 |
| C.417 | Site Plan - 17 |
| C.418 | Site Plan - 18 |
| C.419 | Site Plan - 19 |
| C.420 | Site Plan - 20 |
| C.421 | Site Plan - 21 |
| C.422 | Site Plan - 22 |
| C.423 | Site Plan - 23 |
| C.424 | Site Plan - 24 |
| C.425 | Site Plan - 25 |
| C.426 | Site Plan - 26 |
| C.500 | Grading and Drainage Plan - 1 |
| C.501 | Grading and Drainage Plan - 2 |
| C.502 | Grading and Drainage Plan - 3 |
| C.503 | Grading and Drainage Plan - 4 |
| C.504 | Grading and Drainage Plan - 5 |
| C.505 | Grading and Drainage Plan - 6 |
| C.506 | Grading and Drainage Plan - 7 |
| C.507 | Grading and Drainage Plan - 8 |
| C.508 | Grading and Drainage Plan - 9 |
| C.509 | Grading and Drainage Plan - 10 |
| C.510 | Grading and Drainage Plan - 11 |
| C.511 | Grading and Drainage Plan - 12 |
| C.512 | Grading and Drainage Plan - 13 |
| C.513 | Grading and Drainage Plan - 14 |
| C.514 | Grading and Drainage Plan - 15 |
| C.515 | Grading and Drainage Plan - 16 |
| C.516 | Grading and Drainage Plan - 17 |
| C.517 | Grading and Drainage Plan - 18 |
| C.518 | Grading and Drainage Plan - 19 |
| C.519 | Grading and Drainage Plan - 20 |
| C.520 | Grading and Drainage Plan - 21 |
| C.521 | Grading and Drainage Plan - 22 |
| C.522 | Grading and Drainage Plan - 23 |
| C.523 | Grading and Drainage Plan - 24 |
| C.524 | Grading and Drainage Plan - 25 |
| C.525 | Grading and Drainage Plan - 26 |
| C.600 | Road and Fence construction Details |
| C.601 | Grading and Drainage Construction Details |
| C.602 | Erosion & Sediment Control Details |

REGIONAL MAP



VICINITY MAP

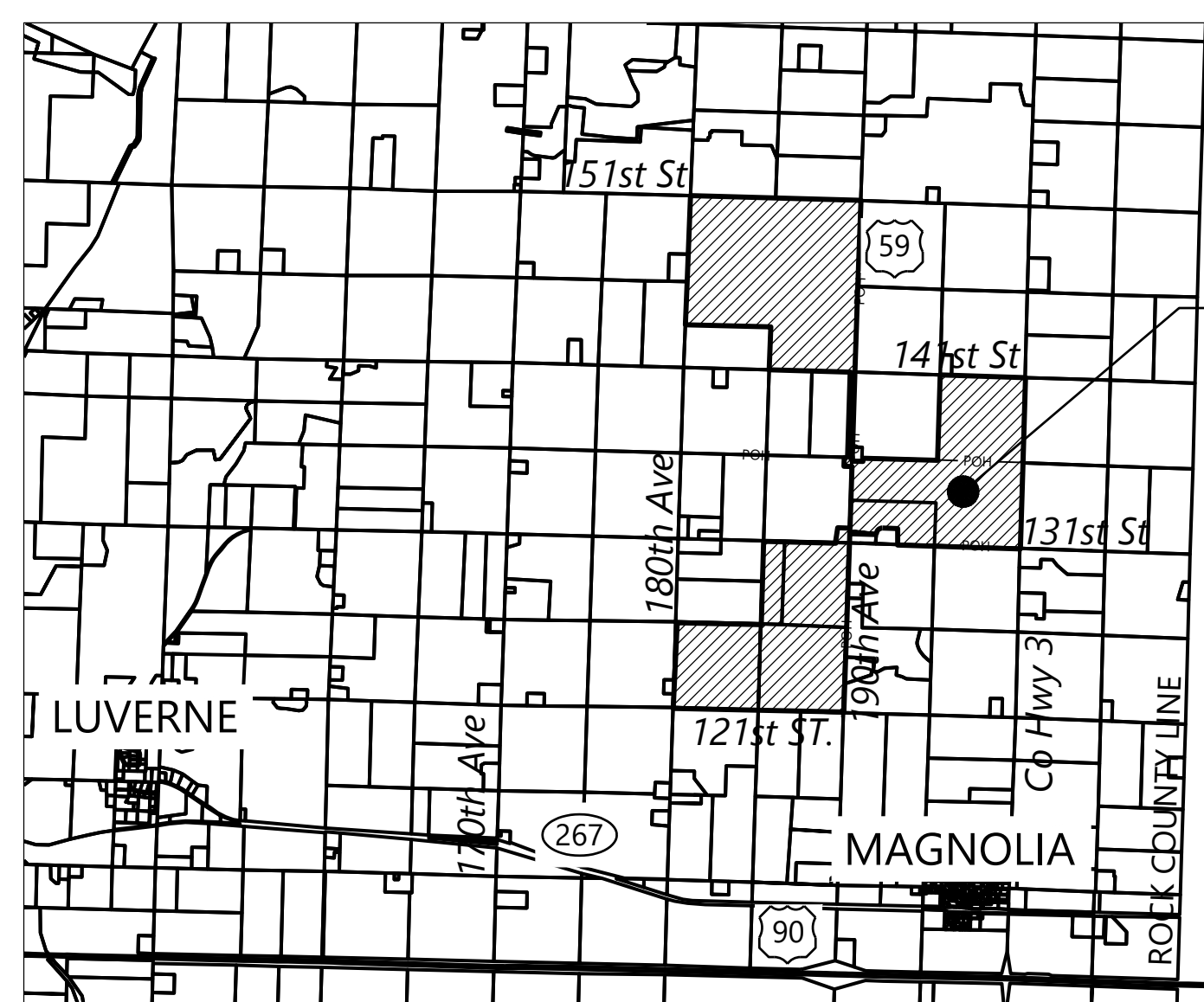

SITE

| DATA SET INFORMATION | | | |
|------------------------------|--|---------------|-----------|
| Coordinate System | NAD83 (2011) Minnesota State Plane Coordinate System, South Zone (US Feet) | | |
| BASE FILE | FILE NAME / NOTES | PROVIDER | DATE |
| AERIAL IMAGE | 0015992.00V-AERIAL | Westwood | 12/7/2020 |
| LAND CONTROL | 2023-04-04 Elk Creek - Layout.kmz | Westwood | 4/20/2023 |
| ALTA SURVEY - NORTH | 015992.00V-SURV.dwg | Westwood | 3/30/2021 |
| ALTA SURVEY - SOUTH | | Westwood | TBD |
| TOPOGRAPHY | 015992.00V-DTM.dwg | Westwood | 12/7/2020 |
| ARRAY LAYOUT | 015992.00E-EQUIP.dwg | Westwood | 4/20/2023 |
| ELECTRICAL COLLECTION DESIGN | 015992.00E-WIRE.dwg | Westwood | 4/20/2023 |
| GEN-TIE | * | * | * |
| FEMA INFO | * | * | * |
| STREAMS/WETLANDS - NORTH | Elk_Creek_Phase_1_Delineated_Wetlands_20190510.shp | National Grid | 5/10/2019 |
| STREAMS/WETLANDS - SOUTH | | | TBD |
| CULTURAL RESOURCES | * | * | * |
| BIOLOGICAL | * | * | * |
| HYDROLOGY REPORT | 2019-03-29 Elk Creek Preliminary Hydrology Study Report | Westwood | 3/29/2019 |
| GEOTECHNICAL REPORT | Elk Creek Solar-Terracon Project No. MP215082 (FINAL).pdf | Terracon | 8/25/2021 |

| CONTACT INFORMATION | | | |
|----------------------------|--------------------------|--------------------|----------------|
| TITLE | COMPANY | NAME | PHONE NUMBER |
| OWNER | NATIONAL GRID RENEWABLES | JOHN STROM | (952) 300-9483 |
| CIVIL ENGINEER | WESTWOOD | BRETT VANDERWIEL | (952) 906-7431 |
| CIVIL ENGINEERING MANAGER | WESTWOOD | AUGUST CHRISTENSEN | (952) 906-7430 |
| ELECTRICAL ENGINEER | WESTWOOD | DOUG MUTCHER | (952) 697-5709 |
| ELECTRICAL PROJECT MANAGER | WESTWOOD | BRIAN CARROLL | (952) 937-5150 |

Elk Creek Solar Project
 Rock County, MN

Cover Sheet











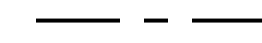
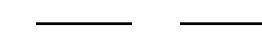
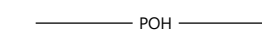

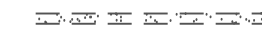

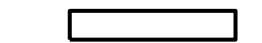
NOT FOR CONSTRUCTION

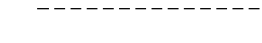
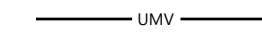
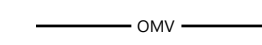
DATE: 05/01/2023 REV:
 SHEET: C.100 A

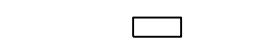
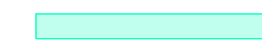
REVISIONS:

| # | DATE | COMMENT | BY | CHK | APR |
|---|------------|--------------|----|-----|-----|
| A | 05/01/2023 | Permit Plans | MB | BV | KA |

LEGEND:

-  PROJECT BOUNDARY
-  EX. PARCEL LINE
-  RIGHT-OF-WAY LINES
-  EX. OVERHEAD POWER
-  EX. PAVED ROAD
-  EX. GRAVEL ROAD
-  EX. STREAM CHANNEL
-  EX. WETLAND
-  EX. STRUCTURE
-  PROPOSED SOLAR ARRAY
-  PROPOSED MODULE SETBACK
-  PROPOSED UNDERGROUND COLLECTION
-  PROPOSED OVERHEAD COLLECTION
-  PROPOSED ACCESS ROAD
-  PROPOSED ELECTRICAL EQUIPMENT
-  PROPOSED PRELIM BASIN LOCATIONS
-  PROPOSED LAYDOWN YARD
-  PROPOSED SCREENING
-  PROPOSED O&M LOCATION
-  PROPOSED SUBSTATION LOCATION
-  PROPOSED EXISTING SUBSTATION EXPANSION LOCATION
-  PROPOSED SECURITY FENCE

NOTES:

- BASIN AREAS REPRESENT INTENDED PRELIMINARY LOCATIONS. SIZE IS NOT REPRESENTATIVE OF THE ACTUAL BASIN SIZE. ACTUAL SIZES TO BE DETERMINED WITH FURTHER ENGINEERING DESIGN.
- EXISTING PARCELS, EASEMENTS, RIGHT-OF-WAYS, ETC ARE BASED ON ALTA SURVEY (NORTH HALF) AS WELL AS GIS DATA (SOUTH HALF).

ESTIMATED HORIZONTAL SURFACE COVERAGE

| ITEM | COVERAGE (AC) |
|-------------------|---------------|
| FENCED ACREAGE | 1,157.55 |
| MODULE FOOTPRINT* | 292.34 |
| INVERTER SKIDS | 0.28 |
| SUBSTATION | 1.16 |

*DOES NOT INCLUDE SPACE BETWEEN MODULES OR ROWS

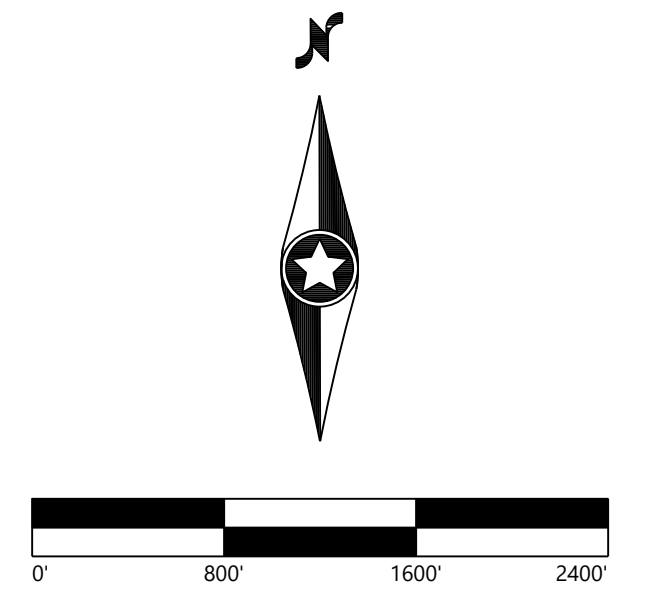

Elk Creek Solar Project
 Rock County, MN

Overall Site Plan

NOT FOR CONSTRUCTION

DATE: 05/01/2023 REV:
 SHEET: C.200 A

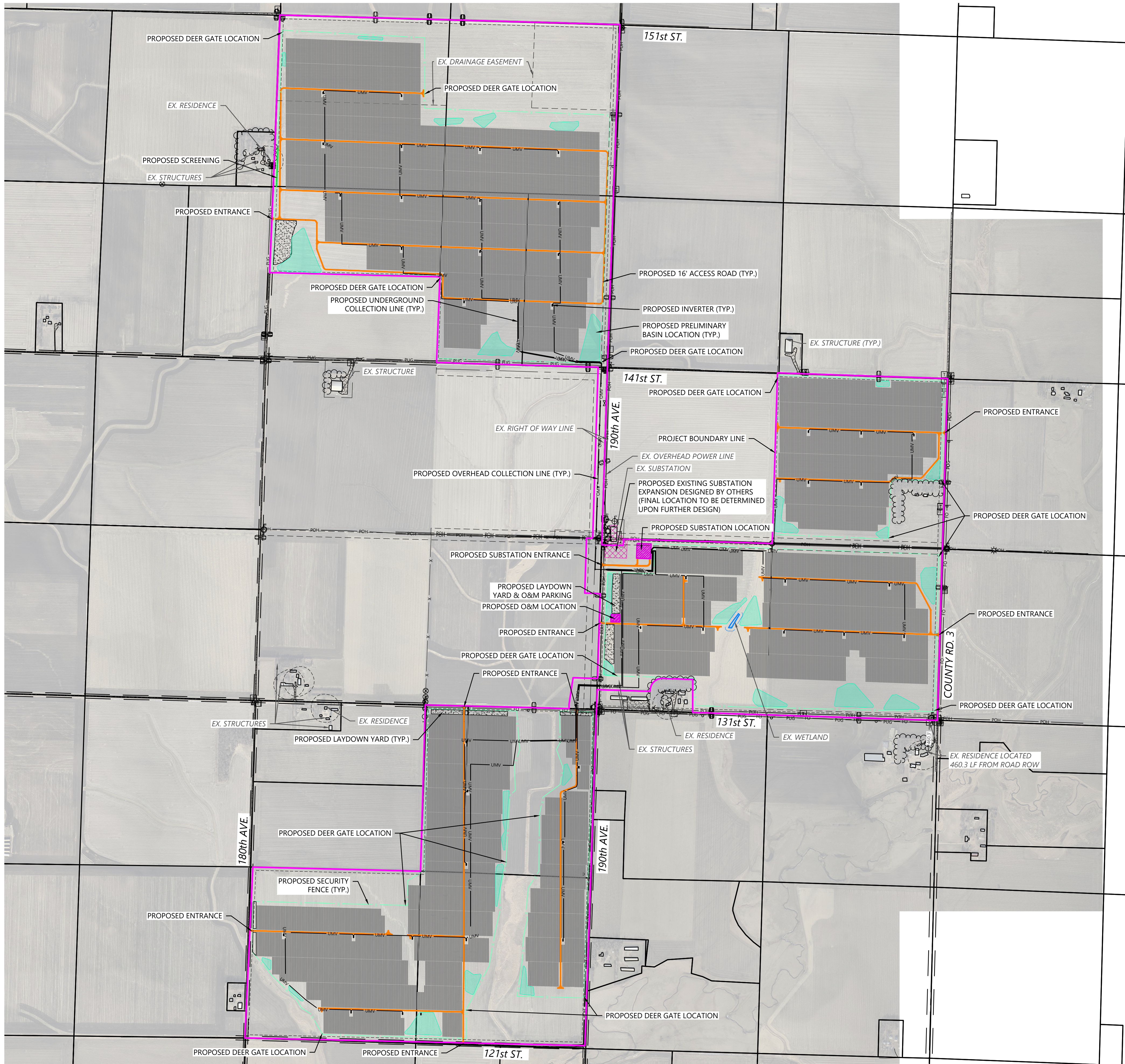

20230501 10:20:00 am C:\Users\jgibson\OneDrive\Documents\199156_C02.dwg 5/1/2023 1:57 PM Westwood



8400 Normandale Lake Blvd, Suite 1200
 Bloomington, MN 55347

REVISIONS:

| # | DATE | COMMENT | BY | CHK | APR |
|---|------------|--------------|----|-----|-----|
| A | 05/01/2023 | Permit Plans | MB | BV | KA |

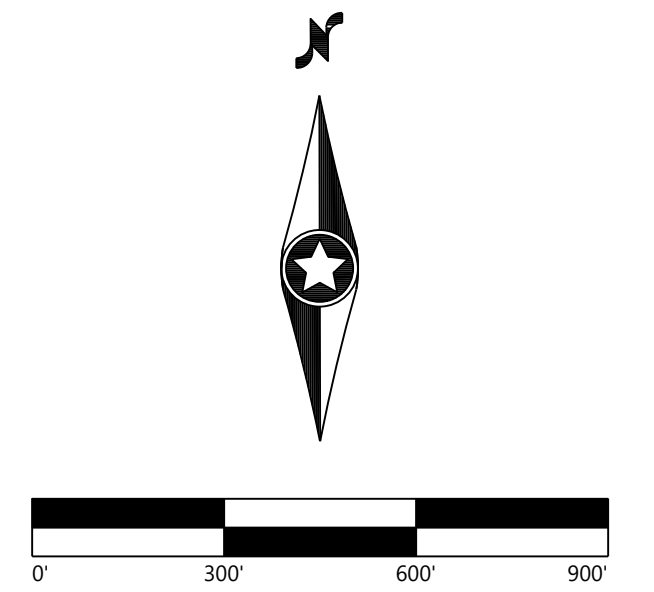

LEGEND:

- PROJECT BOUNDARY
- EX. EASEMENT LINE
- EX. SECTION LINE
- EX. PARCEL LINE
- RIGHT-OF-WAY LINES
- EX. OVERHEAD POWER
- EX. UNDERGROUND COLLECTION
- EX. FIBER OPTIC
- EX. TREE LINE
- EX. FENCE
- EX. 5' CONTOUR
- EX. 1' CONTOUR
- EX. PAVED ROAD
- EX. GRAVEL ROAD
- EX. STREAM CHANNEL
- EX. WETLAND
- EX. STRUCTURE
- EX. CULVERT
- EX. SIGN
- EX. TELEPHONE PEDESTAL

NOTES:

1. EXISTING WETLAND LOCATIONS ARE PRELIMINARY. FURTHER SURVEY IS NEEDED TO LOCATE ALL EXISTING WETLANDS.
2. EXISTING PARCELS, EASEMENTS, RIGHT-OF-WAYS, ETC ARE BASED ON ALTA SURVEY (NORTH HALF) AS WELL AS GIS DATA (SOUTH HALF).

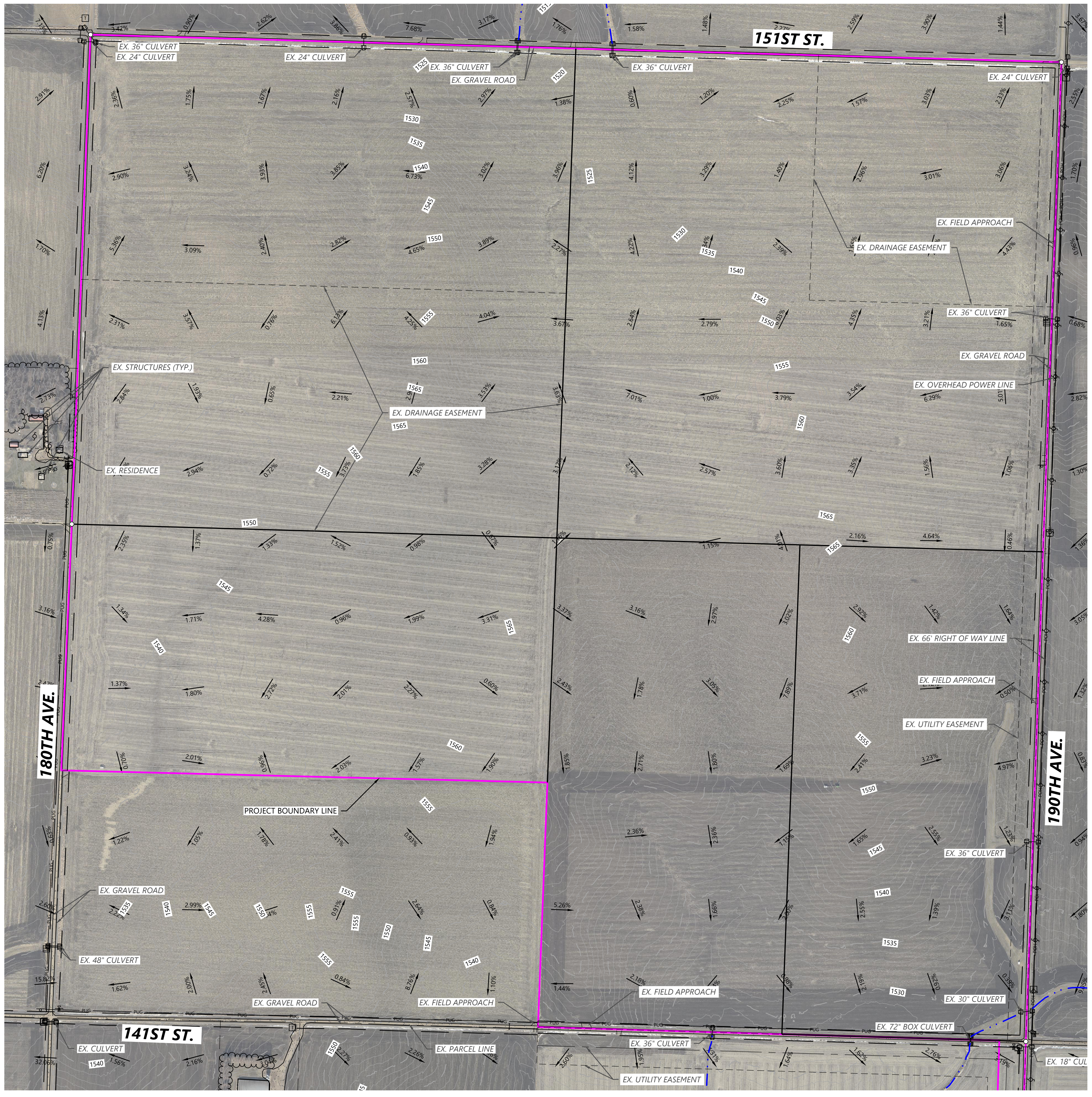

KEY MAP

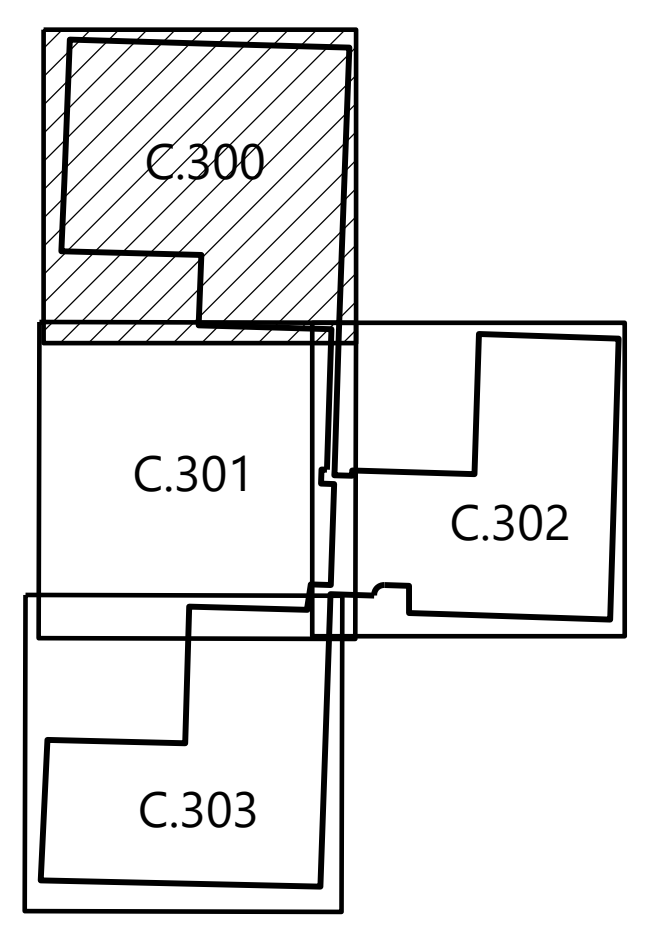

Elk Creek Solar Project
 Rock County, MN

Existing Conditions - 1

NOT FOR CONSTRUCTION

DATE: 05/01/2023 REV:
 SHEET: C.300 A

SEE SHEET C.301

SEE SHEET C.302

2023.05.01 10:20:00.dwg C:\Users\jgibson\OneDrive\Documents\199555\Elk Creek\199555_01\2023.05.01 10:20:00.dwg