

Data Source(s): Westwood (2021); US Census Bureau (2019); USGS NHD Dataset (2013); USFWS NWI (2017); FEMA (Various Dates); Dodge and Olmsted County DOQ Imagery (2019).



Westwood

Phone (952) 937-5150 12701 Whitewater Drive, Suite #300
 Fax (952) 937-5822 Minnetonka, MN 55343
 Toll Free (888) 937-5150 westwoodps.com

Westwood Professional Services, Inc.

- Project Area Boundary
- Existing Substation
- Project Substation
- Laydown Yard
- O&M Facility
- Solar Array
- Proposed Fence
- Proposed Access Road
- Stormwater Pond
- Delineated Wetlands
- NHD Waterbody
- NHD Flowline
- PWI Watercourse
- Drainage Ditch (Statewide)
- NWI Wetland
- FEMA Flood Zone
- Railroad
- County Boundary
- Municipal Boundary

Byron Solar Project

Dodge and Olmsted Counties, Minnesota

Water Resources

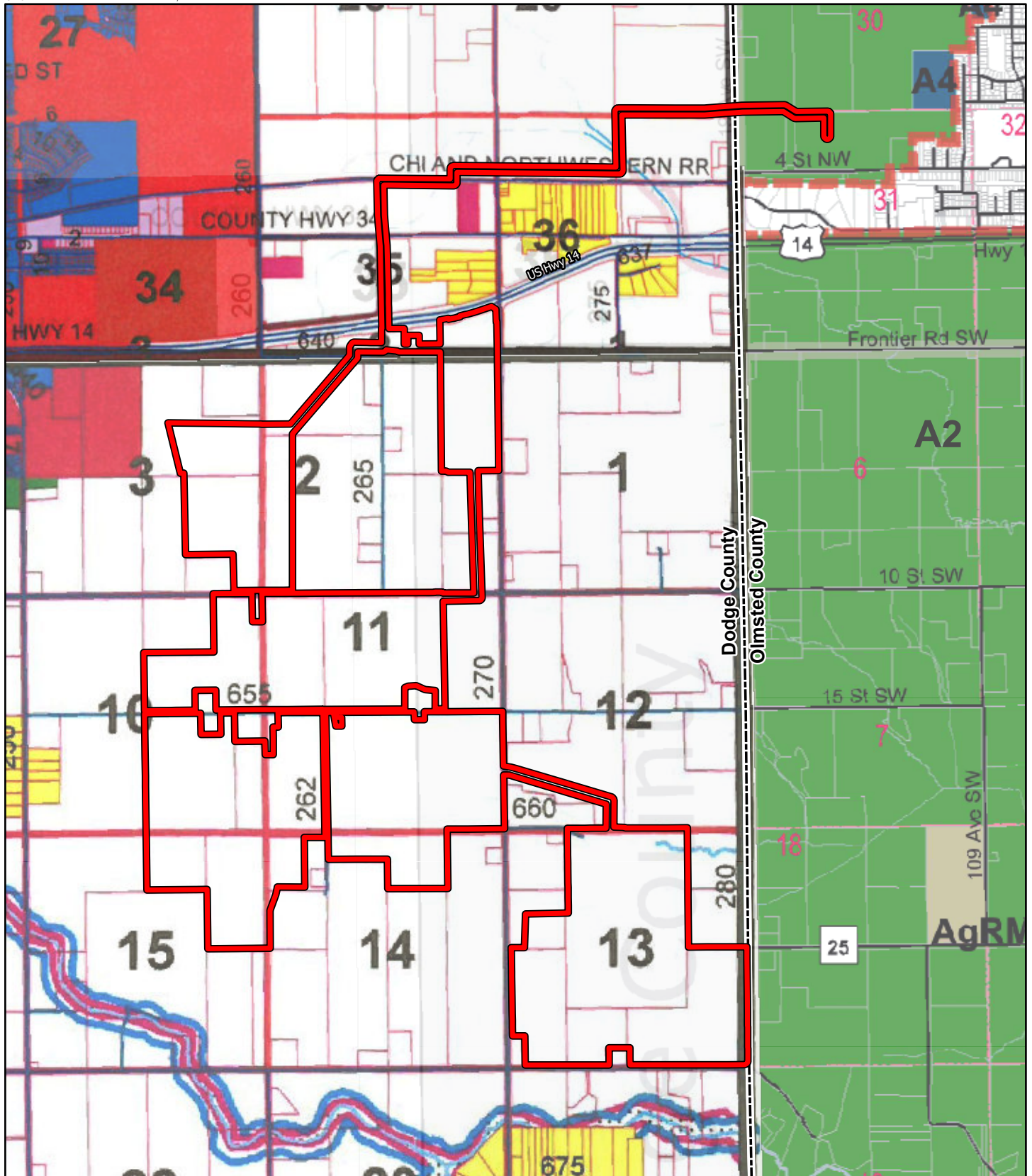

Data Source(s): Westwood (2021); US Census Bureau (2019); Dodge County (2014, 2018); Olmsted County (2020).



Westwood

Phone (952) 937-5150 12701 Whitewater Drive, Suite #300
 Fax (952) 937-5822 Minnetonka, MN 55343
 Toll Free (888) 937-5150 westwoodps.com

Westwood Professional Services, Inc.

Project Area Boundary

County Boundary

Dodge County Zones

Agricultural

City

Commercial

Rural Residential

Split

Urban Expansion

Urban Expansion Residential

Shoreland Buffer 300ft

FEMA Floodplain

PLSS Townships

Parcel Lines

Olmsted County Zones

A-2 Agricultural Protection

A-4 Agricultural-Urban Expansion

A.R.C. Agricultural Residential Cluster

City Limits

Byron Solar Project

Dodge and Olmsted Counties, Minnesota

Zoning

MAP 14

