

SEE SHEET C.301

SEE SHEET C.302

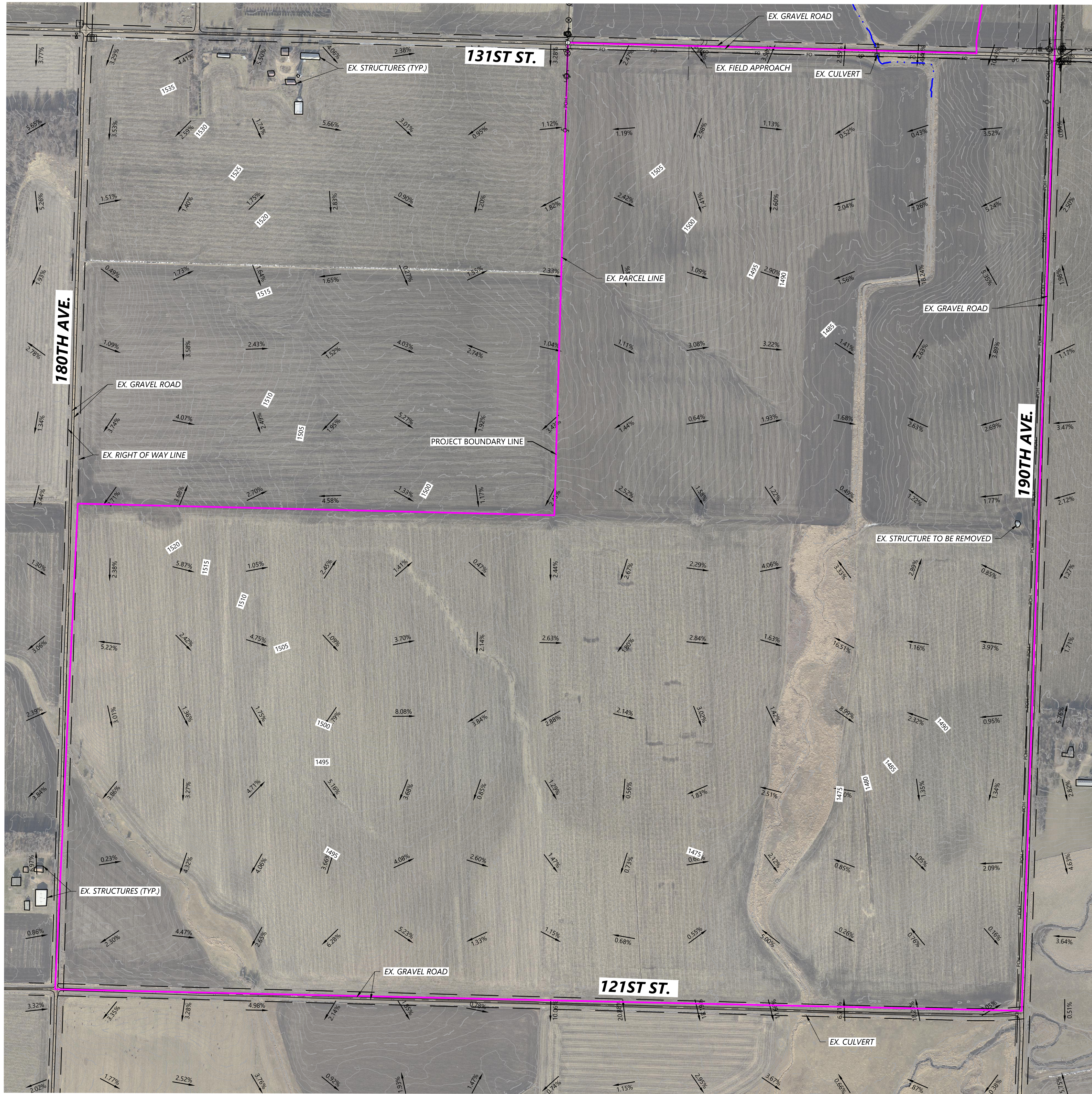

LEGEND:

- PROJECT BOUNDARY
- EX. EASEMENT LINE
- EX. SECTION LINE
- EX. PARCEL LINE
- RIGHT-OF-WAY LINES
- EX. OVERHEAD POWER
- EX. UNDERGROUND COLLECTION
- EX. FIBER OPTIC
- EX. TREE LINE
- EX. FENCE
- EX. 5' CONTOUR
- EX. 1' CONTOUR
- EX. PAVED ROAD
- EX. GRAVEL ROAD
- EX. STREAM CHANNEL
- EX. WETLAND
- EX. STRUCTURE
- EX. CULVERT
- EX. SIGN
- EX. TELEPHONE PEDESTAL

NOTES:

1. EXISTING WETLAND LOCATIONS ARE PRELIMINARY. FURTHER SURVEY IS NEEDED TO LOCATE ALL EXISTING WETLANDS.
2. EXISTING PARCELS, EASEMENTS, RIGHT-OF-WAYS, ETC ARE BASED ON ALTA SURVEY (NORTH HALF) AS WELL AS GIS DATA (SOUTH HALF).

**Westwood**

Phone (952) 937-5150 12701 Whitewater Drive, Suite #300  
 Fax (952) 937-5822 Minnetonka, MN 55343  
 TollFree (888) 937-5150 westwoodps.com  
 Westwood Professional Services, Inc.

PREPARED FOR:



8400 Normandale Lake Blvd, Suite 1200  
 Bloomington, MN 55347

REVISIONS:

#	DATE	COMMENT	BY	CHK	APR
A	05/01/2023	Permit Plans	MB	BV	KA

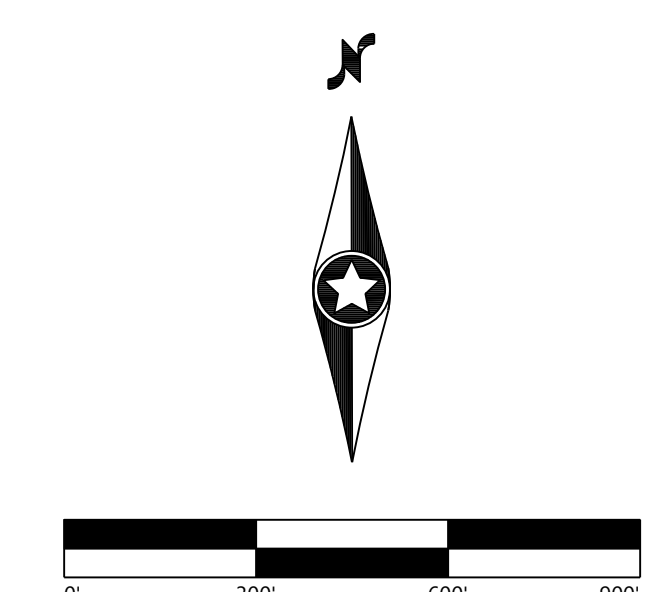
KEY MAP

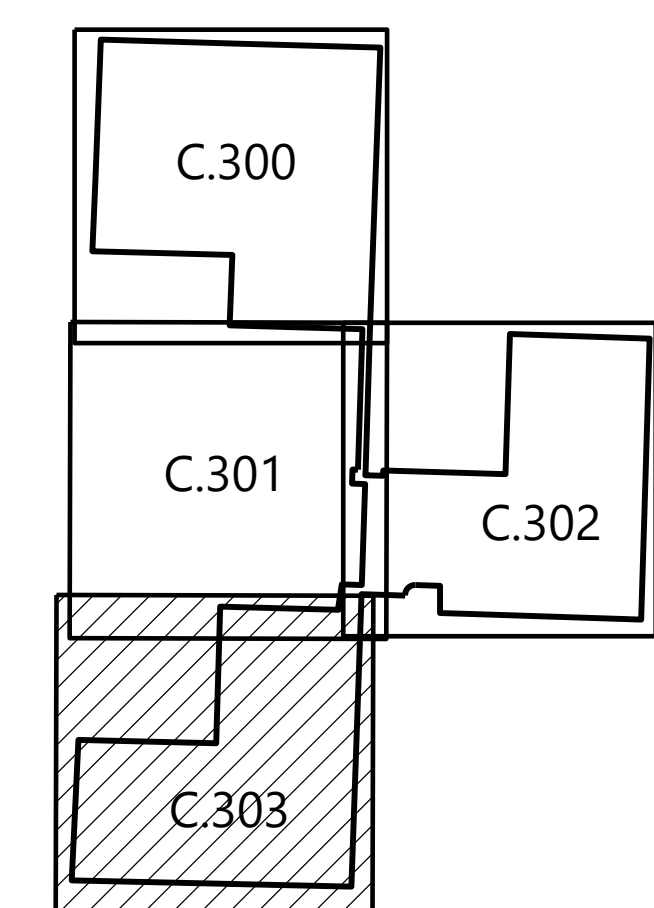

**Elk Creek Solar Project**  
 Rock County, MN

Existing Conditions - 4

NOT FOR CONSTRUCTION

DATE: 05/01/2023 REV:  
 SHEET: C.303 A

\\s01\9392\2023\05\01\C303\195152\_C303.dwg, 5/1/2023 1:38:14 PM, Matt Bump





8400 Normandale Lake Blvd, Suite 1200  
 Bloomington, MN 55347

REVISIONS:

#	DATE	COMMENT	BY	CHK	APR
A	05/01/2023	Permit Plans	MB	BV	KA

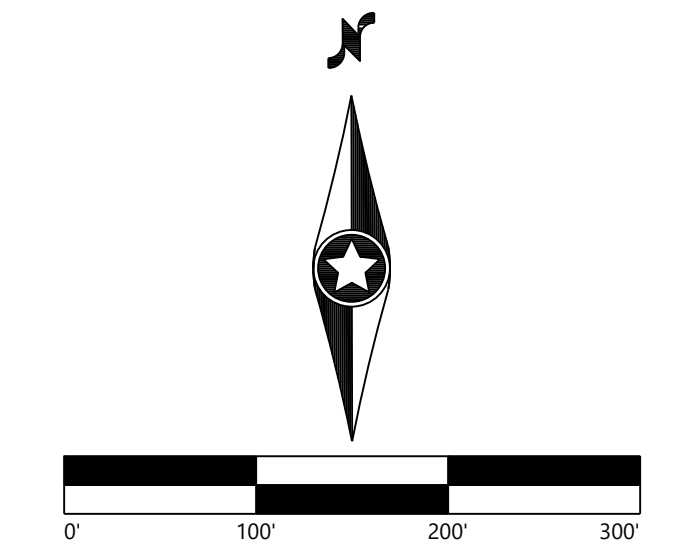

# Elk Creek Solar Project

Rock County, MN

Site Plan - 1

**NOT FOR CONSTRUCTION**

DATE: 05/01/2023 REV:  
 SHEET: C.401 A

- LEGEND:**
- PROJECT BOUNDARY
  - EX. EASEMENT LINE
  - EX. SECTION LINE
  - EX. PARCEL LINE
  - RIGHT-OF-WAY LINES
  - EX. OVERHEAD POWER
  - EX. UNDERGROUND COLLECTION
  - EX. FIBER OPTIC
  - EX. PAVED ROAD
  - EX. GRAVEL ROAD
  - EX. STREAM CHANNEL
  - EX. WETLAND
  - EX. STRUCTURE
  - EX. CULVERT
  - EX. SIGN
  - EX. TELEPHONE PEDESTAL
  - EX. INDEX CONTOUR
  - EX. INTERVAL CONTOUR
  - PROPOSED INDEX CONTOUR
  - PROPOSED INTERVAL CONTOUR
  - PROPOSED SOLAR ARRAY WITH INVERTER
  - PROPOSED WETLAND SETBACK
  - PROPOSED MODULE SETBACK
  - PROPOSED ACCESS ROAD
  - PROPOSED SECURITY FENCE
  - PROPOSED UNDERGROUND COLLECTION
  - PROPOSED OVERHEAD COLLECTION
  - PROPOSED LAYDOWN YARD
  - PROPOSED O&M LOCATION
  - PROPOSED SUBSTATION LOCATION
  - PROPOSED EXISTING SUBSTATION EXPANSION LOCATION
  - PROPOSED SCREENING
  - PROPOSED LOW WATER CROSSING
  - PROPOSED SILT FENCE
  - PROPOSED CULVERT
  - PROPOSED PRELIM DRAINAGE BASIN
  - PROPOSED DEER GATE LOCATION

- NOTES:**
- HORIZONTAL PROJECT COORDINATE SYSTEM IS NAD83 (2011) MINNESOTA STATE PLANES, SOUTH ZONE, US FOOT.
  - SEE C.600 - C.602 DRAWINGS FOR SITE DETAILS, FENCING DETAILS, AND ROAD SECTION DETAILS.
  - SEE GRADING AND DRAINAGE SHEETS C.500 - C.525 FOR PROPOSED SITE EARTHWORKS AND DRAINAGE INFORMATION.
  - PROPOSED SUBSTATION LOCATION IS PRELIMINARY. FINAL LOCATION TO BE CONFIRMED WITH FURTHER DESIGN.

**Project Setbacks/Restrictions**

Item	Required
FRONT YARD	25' FROM ROAD RIGHT OF WAY
SIDE YARD	25' FROM PROPERTY LINE
REAR YARD	25' FROM PROPERTY LINE
DWELLINGS	200' FROM HOUSES
PUBLIC CONSERVATION LANDS	200' (NONE IN PROJECT AREA)

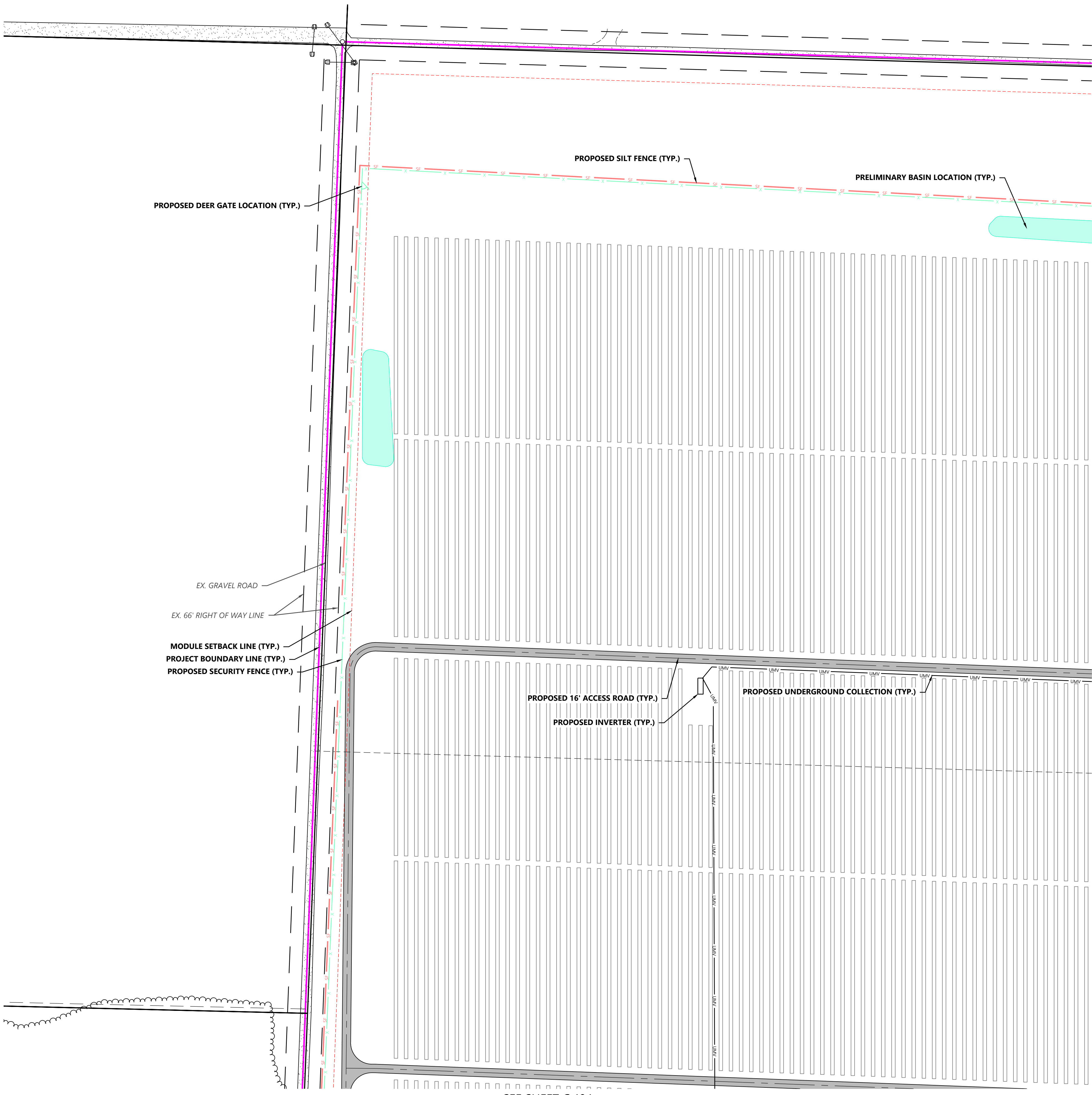
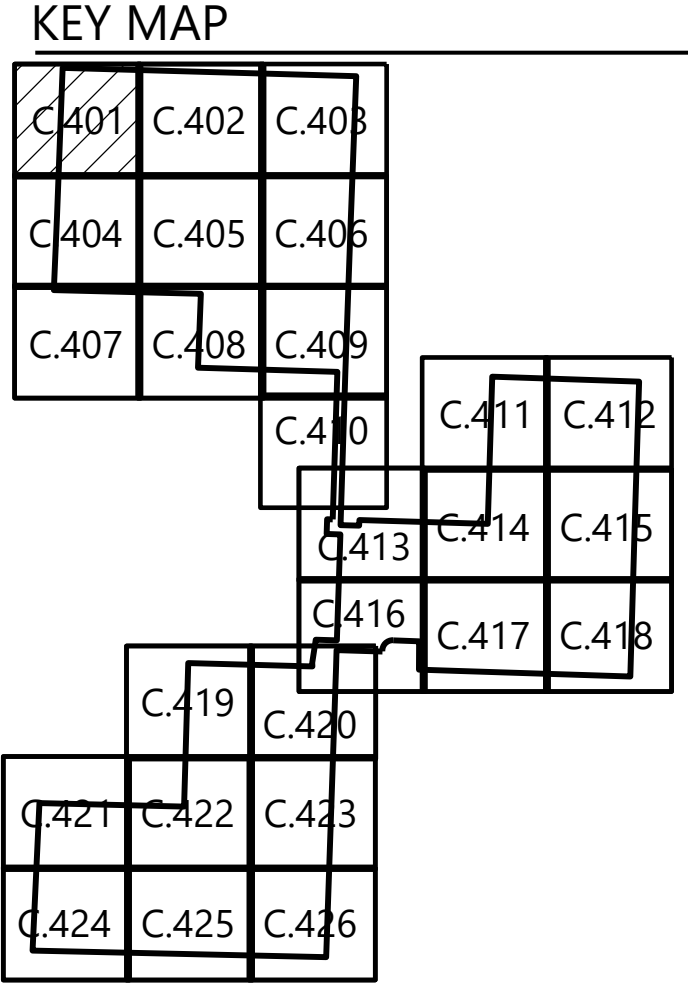

SEE SHEET C.402

SEE SHEET C.404

20230501 10:00 AM C:\Users\jgibson\OneDrive\Documents\Elk Creek Solar\Elk Creek Solar.dwg 5/1/2023 9:54 AM Westwood

PREPARED FOR:



8400 Normandale Lake Blvd, Suite 1200  
 Bloomington, MN 55347

REVISIONS:

#	DATE	COMMENT	BY	CHK	APR
A	05/01/2023	Permit Plans	MB	BV	KA

**LEGEND:**

- PROJECT BOUNDARY
- EX. EASEMENT LINE
- EX. SECTION LINE
- EX. PARCEL LINE
- RIGHT-OF-WAY LINES
- EX. OVERHEAD POWER
- EX. UNDERGROUND COLLECTION
- EX. FIBER OPTIC
- EX. PAVED ROAD
- EX. GRAVEL ROAD
- EX. STREAM CHANNEL
- EX. WETLAND
- EX. STRUCTURE
- EX. CULVERT
- EX. SIGN
- EX. TELEPHONE PEDESTAL
- EX. INDEX CONTOUR
- EX. INTERVAL CONTOUR
- PROPOSED INDEX CONTOUR
- PROPOSED INTERVAL CONTOUR
- PROPOSED SOLAR ARRAY WITH INVERTER
- PROPOSED WETLAND SETBACK
- PROPOSED MODULE SETBACK
- PROPOSED ACCESS ROAD
- PROPOSED SECURITY FENCE
- PROPOSED UNDERGROUND COLLECTION
- PROPOSED OVERHEAD COLLECTION
- PROPOSED LAYDOWN YARD
- PROPOSED O&M LOCATION
- PROPOSED SUBSTATION LOCATION
- PROPOSED EXISTING SUBSTATION EXPANSION LOCATION
- PROPOSED SCREENING
- PROPOSED LOW WATER CROSSING
- PROPOSED SILT FENCE
- PROPOSED CULVERT
- PROPOSED PRELIM DRAINAGE BASIN
- PROPOSED DEER GATE LOCATION

SEE SHEET C.403

- NOTES:
- HORIZONTAL PROJECT COORDINATE SYSTEM IS NAD83 (2011) MINNESOTA STATE PLANES, SOUTH ZONE, US FOOT.
  - SEE C.600 - C.602 DRAWINGS FOR SITE DETAILS, FENCING DETAILS, AND ROAD SECTION DETAILS.
  - SEE GRADING AND DRAINAGE SHEETS C.500 - C.525 FOR PROPOSED SITE EARTHWORKS AND DRAINAGE INFORMATION.
  - PROPOSED SUBSTATION LOCATION IS PRELIMINARY. FINAL LOCATION TO BE CONFIRMED WITH FURTHER DESIGN.

Project Setbacks/Restrictions	
Item	Required
FRONT YARD	25' FROM ROAD RIGHT OF WAY
SIDE YARD	25' FROM PROPERTY LINE
REAR YARD	25' FROM PROPERTY LINE
DWELLINGS	200' FROM HOUSES
PUBLIC CONSERVATION LANDS	200' (NONE IN PROJECT AREA)

**KEY MAP**

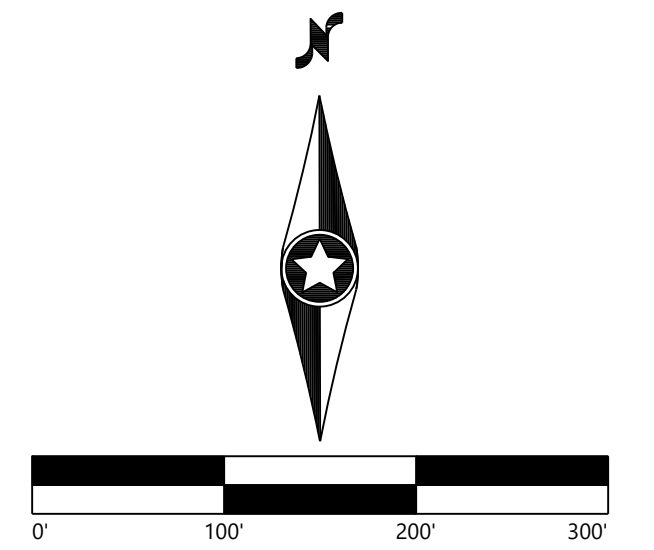
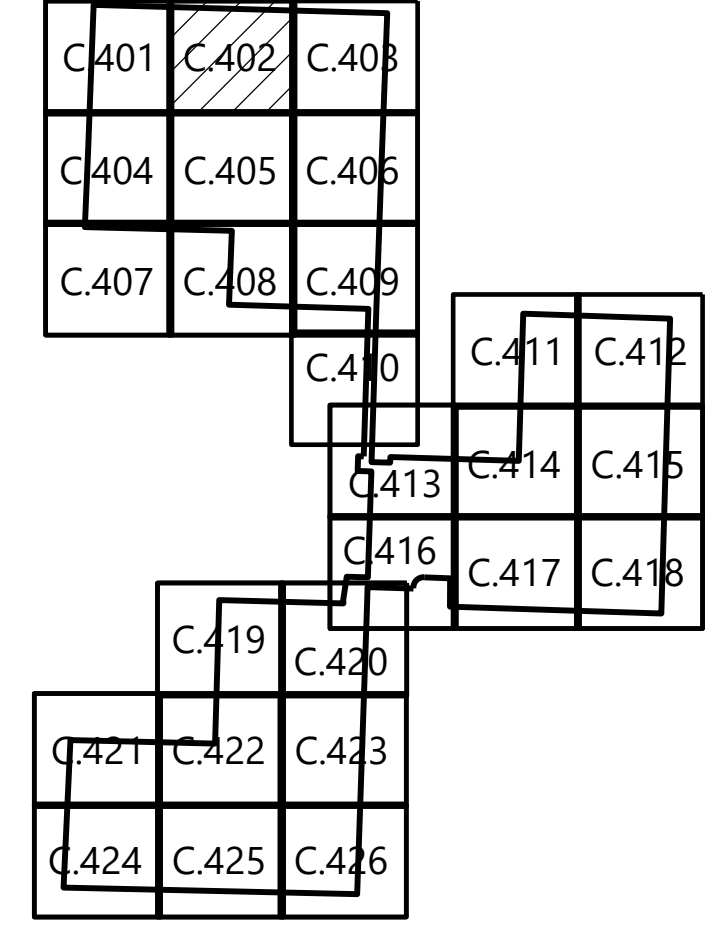

**Elk Creek Solar Project**  
 Rock County, MN

Site Plan - 2

**NOT FOR CONSTRUCTION**

DATE: 05/01/2023 REV:  
 SHEET: C.402 A

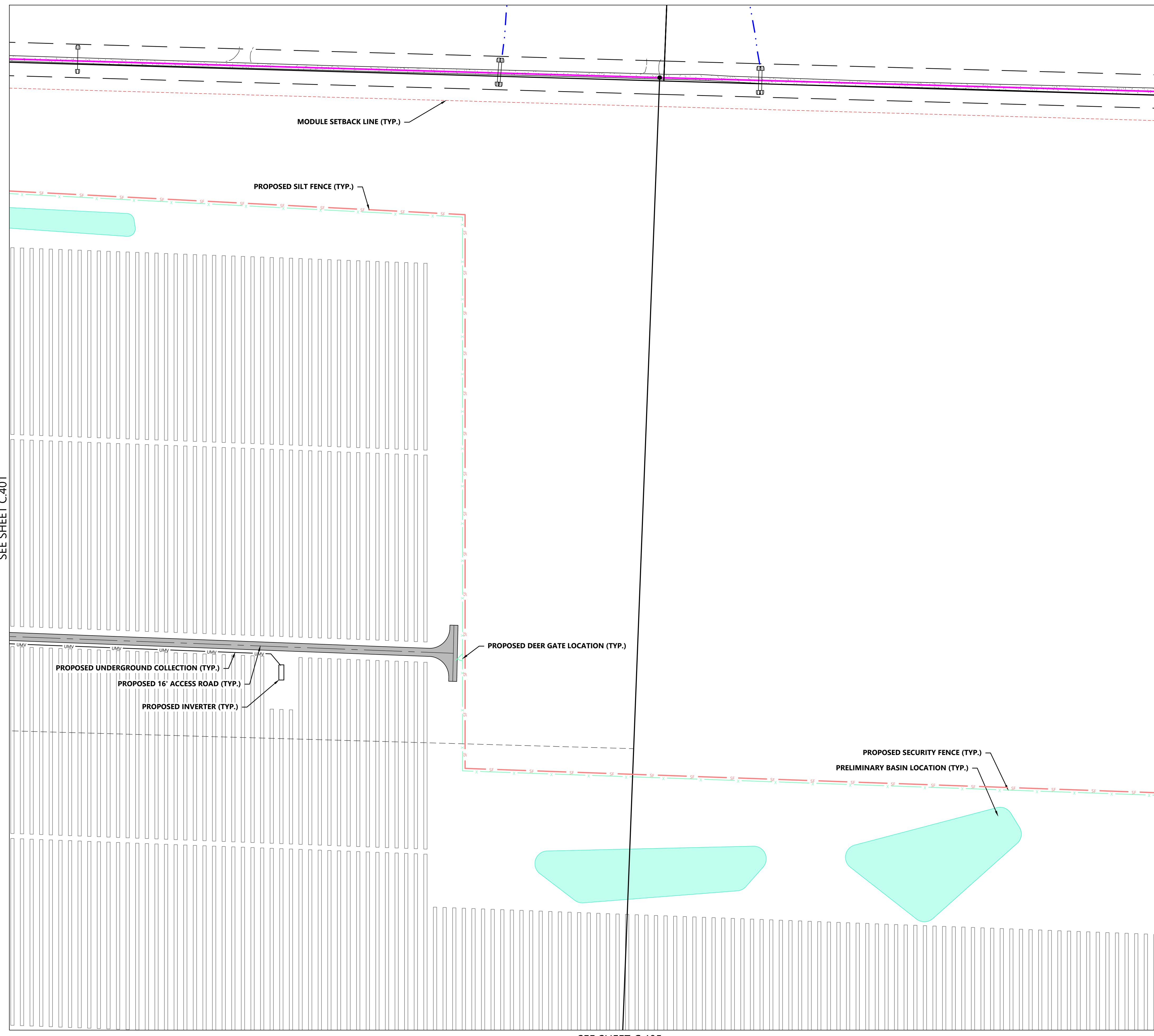

SEE SHEET C.401

SEE SHEET C.405

20230501 10:00 AM C:\Users\jgibson\OneDrive\Documents\Elk Creek Solar\Site Plan - 2.dwg 5/1/2023 3:16:44 AM Westwood

PREPARED FOR:



8400 Normandale Lake Blvd, Suite 1200  
 Bloomington, MN 55347

REVISIONS:

#	DATE	COMMENT	BY	CHK	APR
A	05/01/2023	Permit Plans	MB	BV	KA

**LEGEND:**

- PROJECT BOUNDARY
- EX. EASEMENT LINE
- EX. SECTION LINE
- EX. PARCEL LINE
- RIGHT-OF-WAY LINES
- EX. OVERHEAD POWER
- EX. UNDERGROUND COLLECTION
- EX. FIBER OPTIC
- EX. PAVED ROAD
- EX. GRAVEL ROAD
- EX. STREAM CHANNEL
- EX. WETLAND
- EX. STRUCTURE
- EX. CULVERT
- EX. SIGN
- EX. TELEPHONE PEDESTAL
- EX. INDEX CONTOUR
- EX. INTERVAL CONTOUR
- PROPOSED INDEX CONTOUR
- PROPOSED INTERVAL CONTOUR
- PROPOSED SOLAR ARRAY WITH INVERTER
- PROPOSED WETLAND SETBACK
- PROPOSED MODULE SETBACK
- PROPOSED ACCESS ROAD
- PROPOSED SECURITY FENCE
- PROPOSED UNDERGROUND COLLECTION
- PROPOSED OVERHEAD COLLECTION
- PROPOSED LAYDOWN YARD
- PROPOSED O&M LOCATION
- PROPOSED SUBSTATION LOCATION
- PROPOSED EXISTING SUBSTATION EXPANSION LOCATION
- PROPOSED SCREENING
- PROPOSED LOW WATER CROSSING
- PROPOSED SILT FENCE
- PROPOSED CULVERT
- PROPOSED PRELIM DRAINAGE BASIN
- PROPOSED DEER GATE LOCATION

**NOTES:**

1. HORIZONTAL PROJECT COORDINATE SYSTEM IS NAD83 (2011) MINNESOTA STATE PLANES, SOUTH ZONE, US FOOT.
2. SEE C.600 - C.602 DRAWINGS FOR SITE DETAILS, FENCING DETAILS, AND ROAD SECTION DETAILS.
3. SEE GRADING AND DRAINAGE SHEETS C.500 - C.525 FOR PROPOSED SITE EARTHWORKS AND DRAINAGE INFORMATION.
4. PROPOSED SUBSTATION LOCATION IS PRELIMINARY. FINAL LOCATION TO BE CONFIRMED WITH FURTHER DESIGN.

Project Setbacks/Restrictions	
Item	Required
FRONT YARD	25' FROM ROAD RIGHT OF WAY
SIDE YARD	25' FROM PROPERTY LINE
REAR YARD	25' FROM PROPERTY LINE
DWELLINGS	200' FROM HOUSES
PUBLIC CONSERVATION LANDS	200' (NONE IN PROJECT AREA)

**KEY MAP**

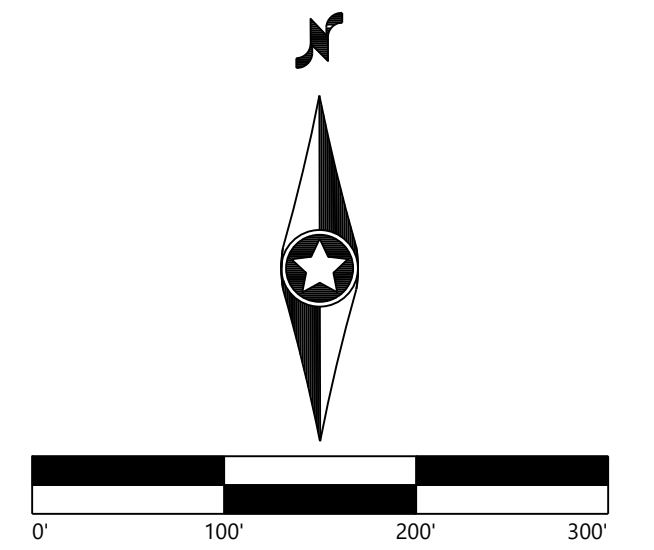
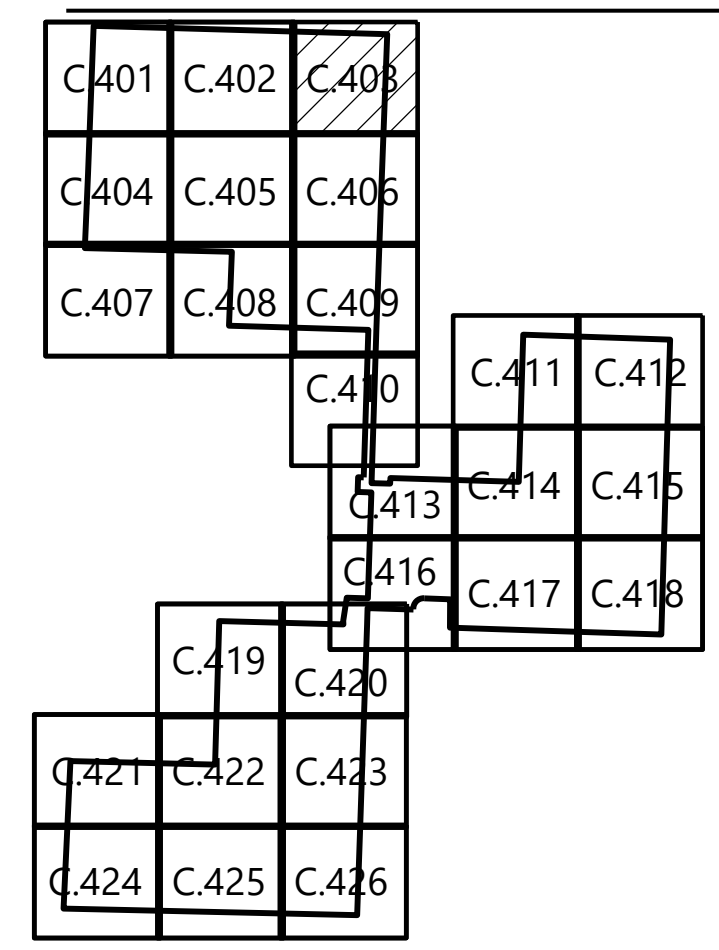

**Elk Creek Solar Project**  
 Rock County, MN

Site Plan - 3

**NOT FOR CONSTRUCTION**

DATE: 05/01/2023 REV:  
 SHEET: C.403 A

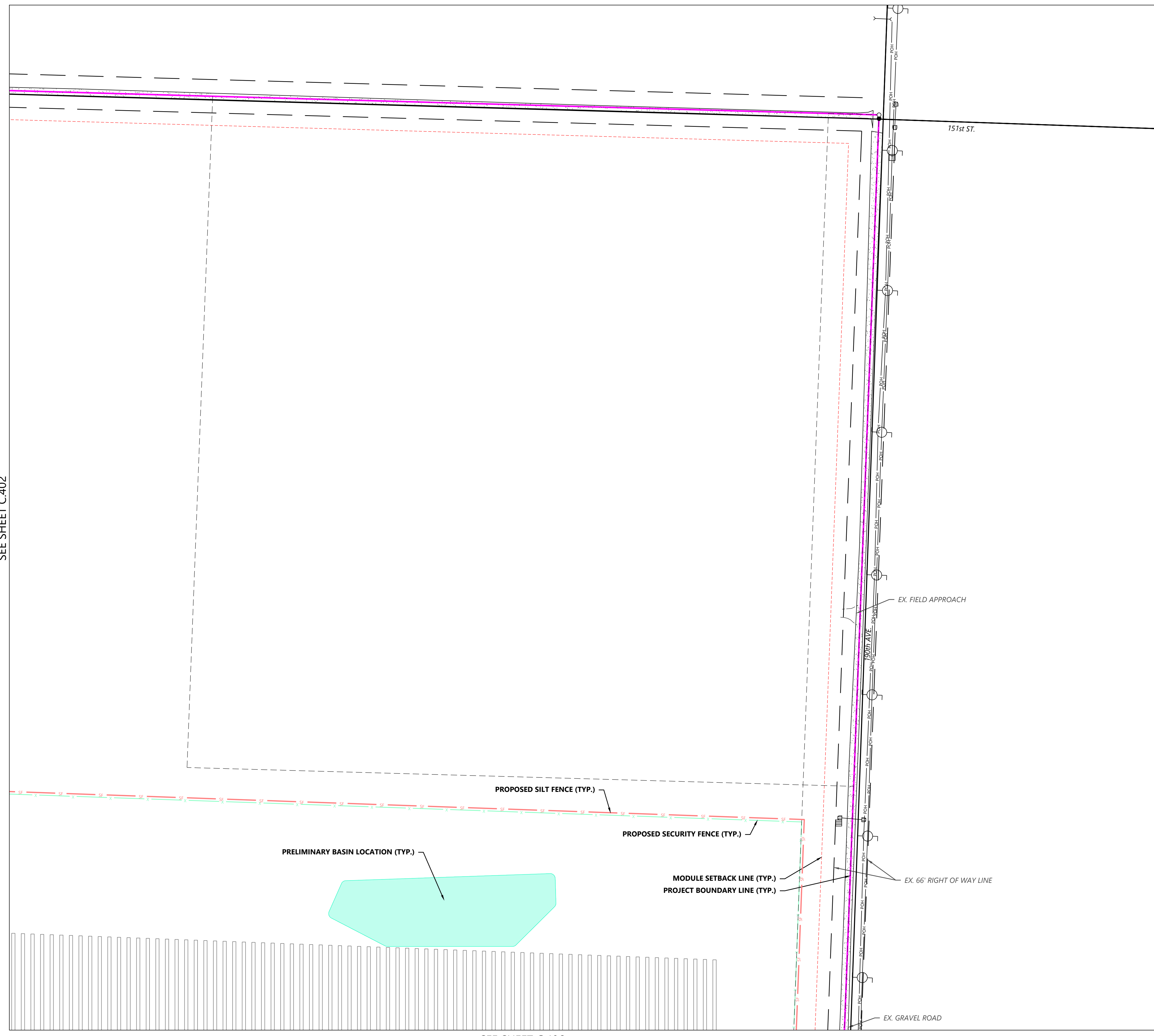

SEE SHEET C.402

SEE SHEET C.406

20230501 10:00 AM C:\Users\jgibson\OneDrive\Documents\Elk Creek Solar Project\Site Plan - 3.dwg 5/1/2023 9:56:16 AM MB 100



SEE SHEET C.402

SEE SHEET C.404

SEE SHEET C.408

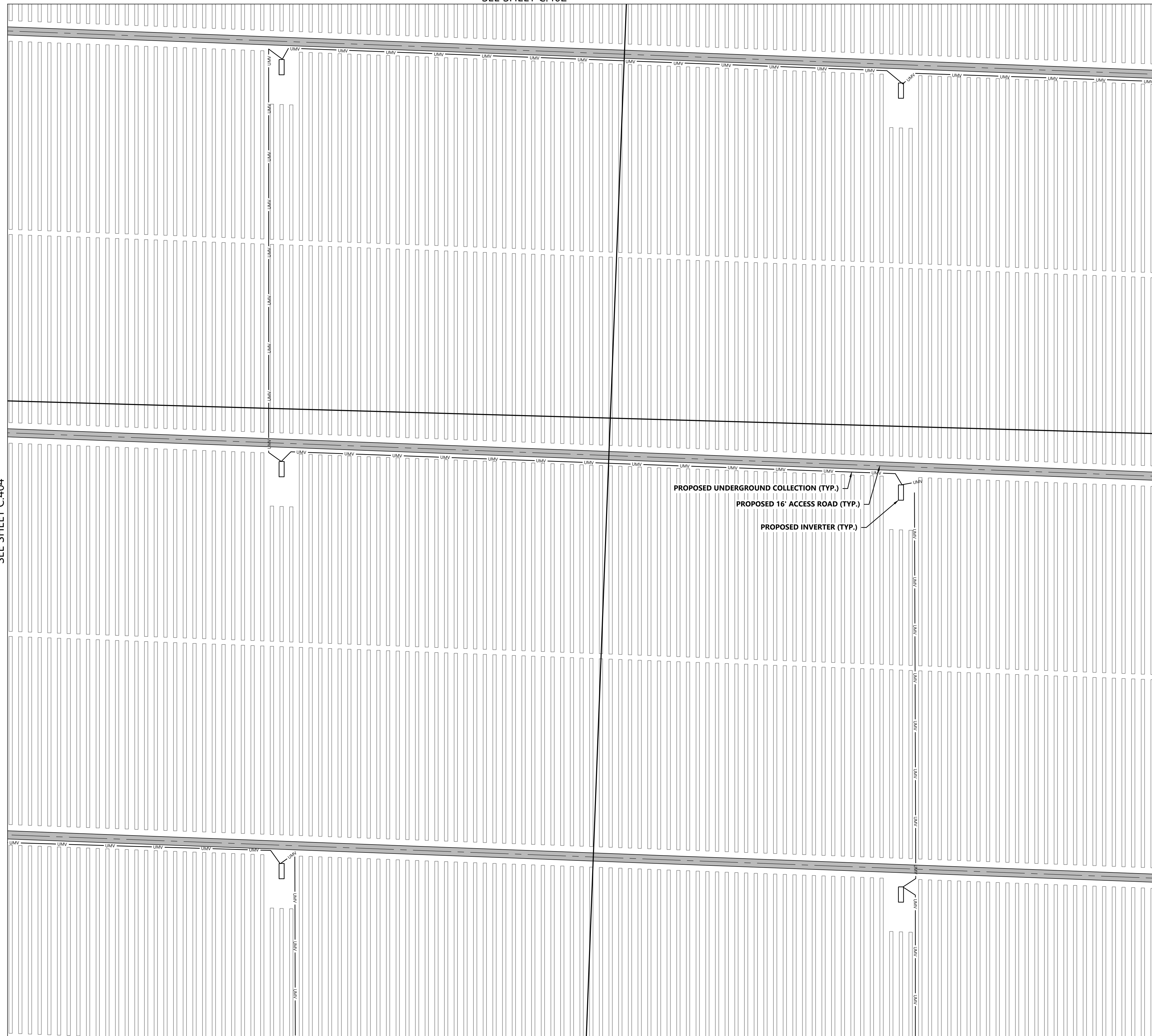

**LEGEND:**

- PROJECT BOUNDARY
- EX. EASEMENT LINE
- EX. SECTION LINE
- EX. PARCEL LINE
- RIGHT-OF-WAY LINES
- EX. OVERHEAD POWER
- EX. UNDERGROUND COLLECTION
- EX. FIBER OPTIC
- EX. PAVED ROAD
- EX. GRAVEL ROAD
- EX. STREAM CHANNEL
- EX. WETLAND
- EX. STRUCTURE
- EX. CULVERT
- EX. SIGN
- EX. TELEPHONE PEDESTAL
- EX. INDEX CONTOUR
- EX. INTERVAL CONTOUR
- PROPOSED INDEX CONTOUR
- PROPOSED INTERVAL CONTOUR
- PROPOSED SOLAR ARRAY WITH INVERTER
- PROPOSED WETLAND SETBACK
- PROPOSED MODULE SETBACK
- PROPOSED ACCESS ROAD
- PROPOSED SECURITY FENCE
- PROPOSED UNDERGROUND COLLECTION
- PROPOSED OVERHEAD COLLECTION
- PROPOSED LAYDOWN YARD
- PROPOSED O&M LOCATION
- PROPOSED SUBSTATION LOCATION
- PROPOSED EXISTING SUBSTATION EXPANSION LOCATION
- PROPOSED SCREENING
- PROPOSED LOW WATER CROSSING
- PROPOSED SILT FENCE
- PROPOSED CULVERT
- PROPOSED PRELIM DRAINAGE BASIN
- PROPOSED DEER GATE LOCATION

**NOTES:**

1. HORIZONTAL PROJECT COORDINATE SYSTEM IS NAD83 (2011) MINNESOTA STATE PLANES, SOUTH ZONE, US FOOT.
2. SEE C.600 - C.602 DRAWINGS FOR SITE DETAILS, FENCING DETAILS, AND ROAD SECTION DETAILS.
3. SEE GRADING AND DRAINAGE SHEETS C.500 - C.525 FOR PROPOSED SITE EARTHWORKS AND DRAINAGE INFORMATION.
4. PROPOSED SUBSTATION LOCATION IS PRELIMINARY. FINAL LOCATION TO BE CONFIRMED WITH FURTHER DESIGN.

Project Setbacks/Restrictions	
Item	Required
FRONT YARD	25' FROM ROAD RIGHT OF WAY
SIDE YARD	25' FROM PROPERTY LINE
REAR YARD	25' FROM PROPERTY LINE
DWELLINGS	200' FROM HOUSES
PUBLIC CONSERVATION LANDS	200' (NONE IN PROJECT AREA)

**KEY MAP**

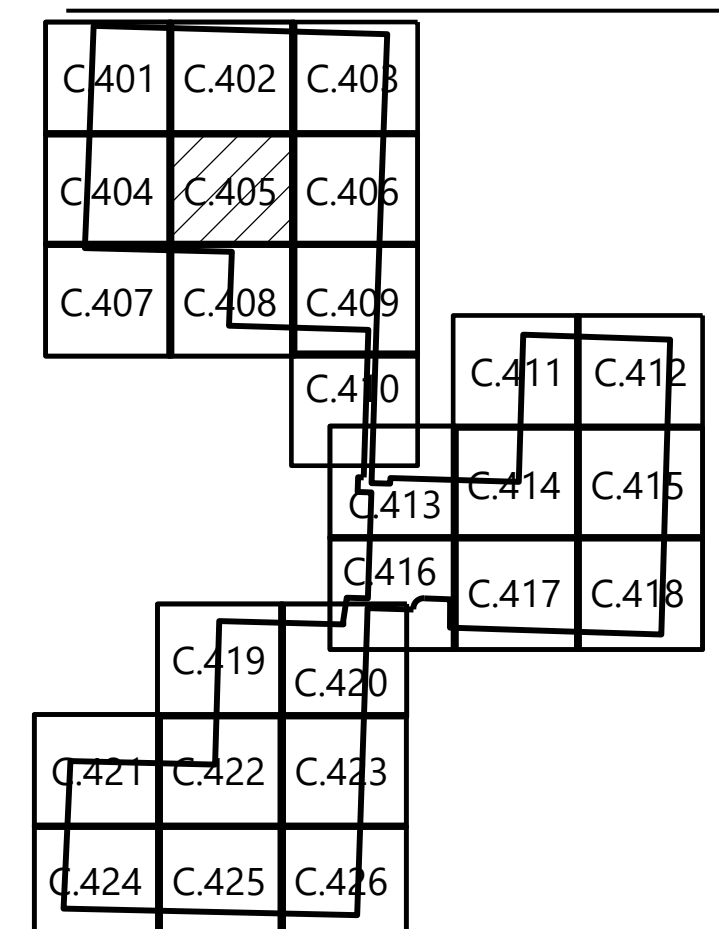

PREPARED FOR:



8400 Normandale Lake Blvd, Suite 1200  
 Bloomington, MN 55347

REVISIONS:

#	DATE	COMMENT	BY	CHK	APR
A	05/01/2023	Permit Plans	MB	BV	KA

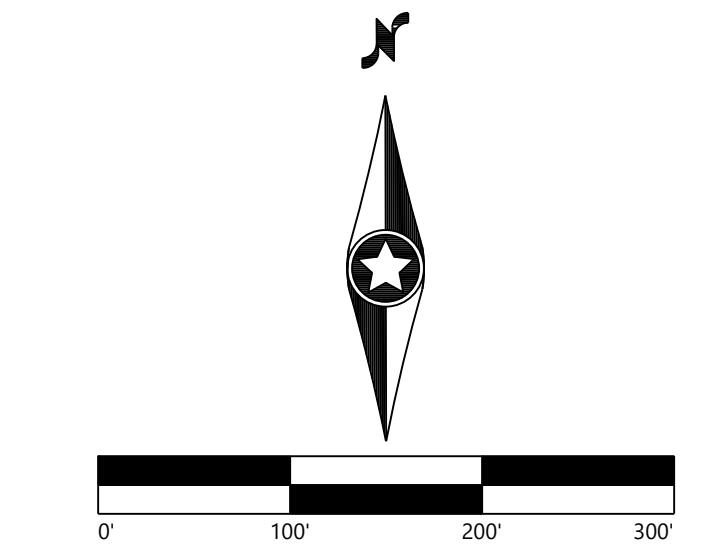

**Elk Creek Solar Project**  
 Rock County, MN

Site Plan - 5

**NOT FOR CONSTRUCTION**

DATE: 05/01/2023 REV:  
 SHEET: C.405 A

20230501 10:00 AM C:\Users\jgibson\OneDrive\Documents\Elk Creek Solar\Elk Creek Solar.dwg 5/1/2023 3:16:44 AM Westwood

SEE SHEET C.402

SEE SHEET C.409

SEE SHEET C.405



**LEGEND:**

- PROJECT BOUNDARY
- EX. EASEMENT LINE
- EX. SECTION LINE
- EX. PARCEL LINE
- RIGHT-OF-WAY LINES
- EX. OVERHEAD POWER
- EX. UNDERGROUND COLLECTION
- EX. FIBER OPTIC
- EX. PAVED ROAD
- EX. GRAVEL ROAD
- EX. STREAM CHANNEL
- EX. WETLAND
- EX. STRUCTURE
- EX. CULVERT
- EX. SIGN
- EX. TELEPHONE PEDESTAL
- EX. INDEX CONTOUR
- EX. INTERVAL CONTOUR
- PROPOSED INDEX CONTOUR
- PROPOSED INTERVAL CONTOUR
- PROPOSED SOLAR ARRAY WITH INVERTER
- PROPOSED WETLAND SETBACK
- PROPOSED MODULE SETBACK
- PROPOSED ACCESS ROAD
- PROPOSED SECURITY FENCE
- PROPOSED UNDERGROUND COLLECTION
- PROPOSED OVERHEAD COLLECTION
- PROPOSED LAYDOWN YARD
- PROPOSED O&M LOCATION
- PROPOSED SUBSTATION LOCATION
- PROPOSED EXISTING SUBSTATION EXPANSION LOCATION
- PROPOSED SCREENING
- PROPOSED LOW WATER CROSSING
- PROPOSED SILT FENCE
- PROPOSED CULVERT
- PROPOSED PRELIM DRAINAGE BASIN
- PROPOSED DEER GATE LOCATION

**NOTES:**

1. HORIZONTAL PROJECT COORDINATE SYSTEM IS NAD83 (2011) MINNESOTA STATE PLANES, SOUTH ZONE, US FOOT.
2. SEE C.600 - C.602 DRAWINGS FOR SITE DETAILS, FENCING DETAILS, AND ROAD SECTION DETAILS.
3. SEE GRADING AND DRAINAGE SHEETS C.500 - C.525 FOR PROPOSED SITE EARTHWORKS AND DRAINAGE INFORMATION.
4. PROPOSED SUBSTATION LOCATION IS PRELIMINARY. FINAL LOCATION TO BE CONFIRMED WITH FURTHER DESIGN.

Project Setbacks/Restrictions	
Item	Required
FRONT YARD	25' FROM ROAD RIGHT OF WAY
SIDE YARD	25' FROM PROPERTY LINE
REAR YARD	25' FROM PROPERTY LINE
DWELLINGS	200' FROM HOUSES
PUBLIC CONSERVATION LANDS	200' (NONE IN PROJECT AREA)

**KEY MAP**

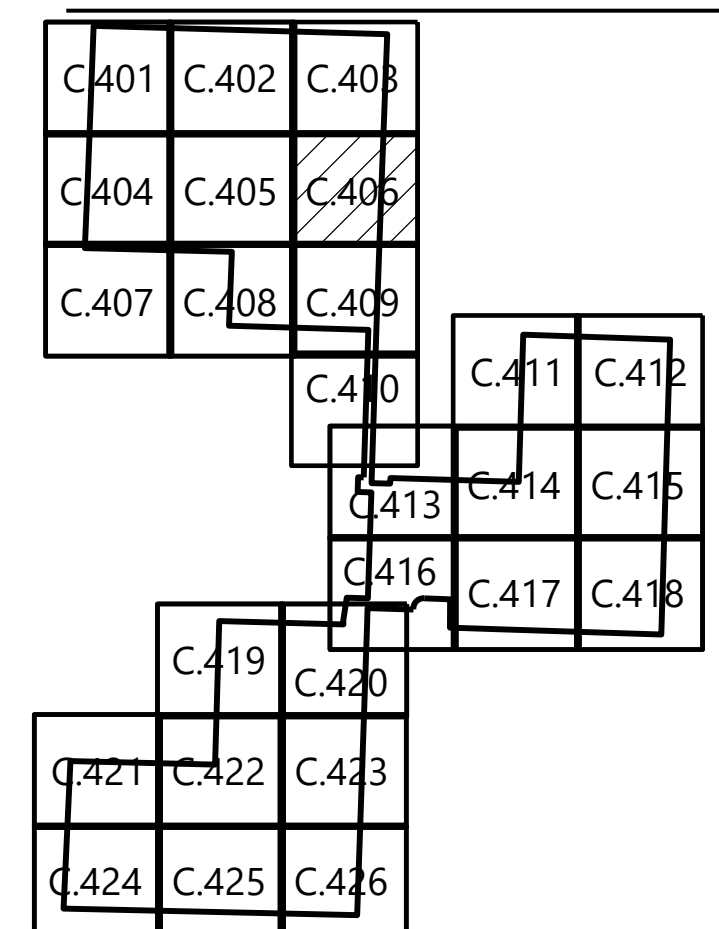

**Westwood**

Phone (952) 937-5150 12701 Whitewater Drive, Suite #300  
 Fax (952) 937-5822 Minnetonka, MN 55343  
 TollFree (888) 937-5150 westwoodps.com  
 Westwood Professional Services, Inc.

PREPARED FOR:  
 nationalgrid renewables

8400 Normandale Lake Blvd, Suite 1200  
 Bloomington, MN 55347

REVISIONS:

#	DATE	COMMENT	BY	CHK	APR
A	05/01/2023	Permit Plans	MB	BV	KA

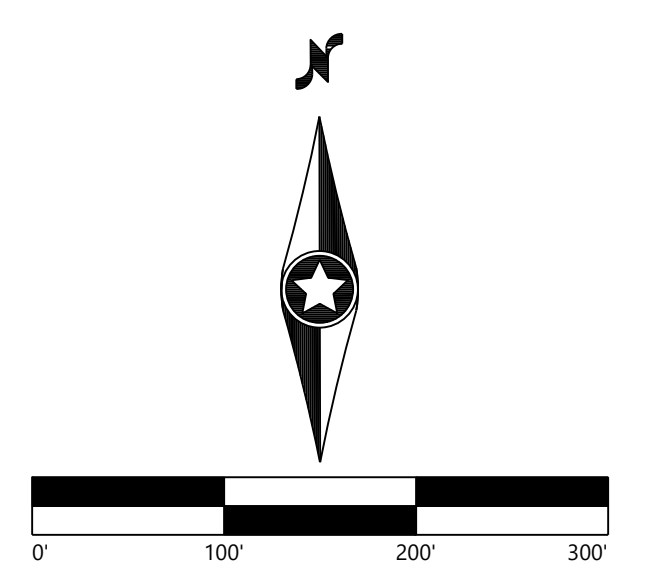

**Elk Creek Solar Project**  
 Rock County, MN

Site Plan - 6

**NOT FOR CONSTRUCTION**

DATE: 05/01/2023 REV:  
 SHEET: C.406 A

20230501 10:00 AM C:\Users\jca\OneDrive\Documents\Elk Creek Solar\Drawings\Site Plan\SP-06.dwg 5/1/2023 3:16:44 AM MB MB



SEE SHEET C.404

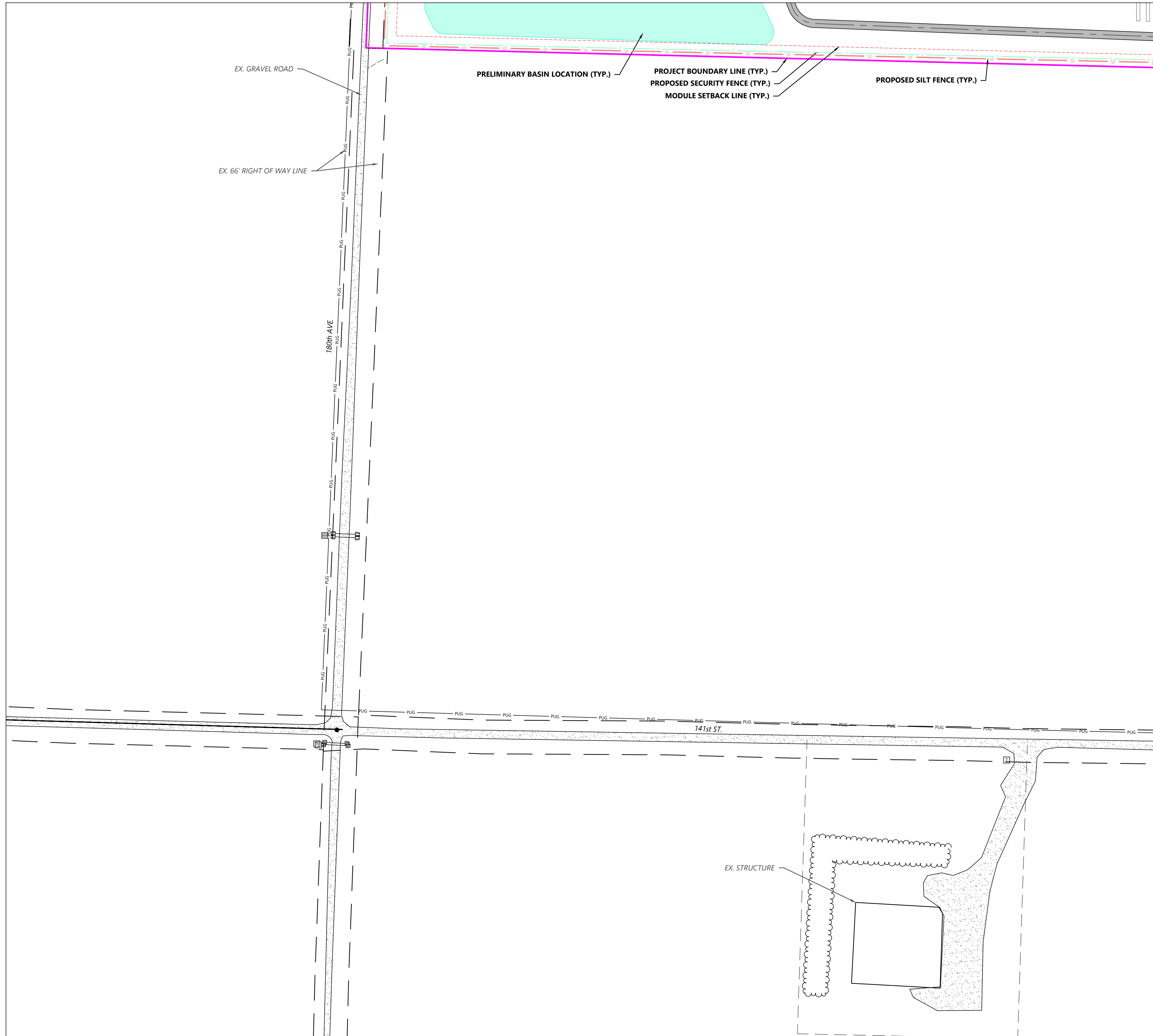

**LEGEND:**

- PROJECT BOUNDARY
- EX. EASEMENT LINE
- EX. SECTION LINE
- EX. PARCEL LINE
- RIGHT-OF-WAY LINES
- EX. OVERHEAD POWER
- EX. UNDERGROUND COLLECTION
- EX. FIBER OPTIC
- EX. PAVED ROAD
- EX. GRAVEL ROAD
- EX. STREAM CHANNEL
- EX. WETLAND
- EX. STRUCTURE
- EX. CULVERT
- EX. SIGN
- EX. TELEPHONE PEDESTAL
- EX. INDEX CONTOUR
- EX. INTERVAL CONTOUR
- PROPOSED INDEX CONTOUR
- PROPOSED INTERVAL CONTOUR
- PROPOSED SOLAR ARRAY WITH INVERTER
- PROPOSED WETLAND SETBACK
- PROPOSED MODULE SETBACK
- PROPOSED ACCESS ROAD
- PROPOSED SECURITY FENCE
- PROPOSED UNDERGROUND COLLECTION
- PROPOSED OVERHEAD COLLECTION
- PROPOSED LAYDOWN YARD
- PROPOSED O&M LOCATION
- PROPOSED SUBSTATION LOCATION
- PROPOSED EXISTING SUBSTATION EXPANSION LOCATION
- PROPOSED SCREENING
- PROPOSED LOW WATER CROSSING
- PROPOSED SILT FENCE
- PROPOSED CULVERT
- PROPOSED PRELIM DRAINAGE BASIN
- PROPOSED DEER GATE LOCATION

SEE SHEET C.408

- NOTES:**
1. HORIZONTAL PROJECT COORDINATE SYSTEM IS NAD83 (2011) MINNESOTA STATE PLANES, SOUTH ZONE, US FOOT.
  2. SEE C.600 - C.602 DRAWINGS FOR SITE DETAILS, FENCING DETAILS, AND ROAD SECTION DETAILS.
  3. SEE GRADING AND DRAINAGE SHEETS C.500 - C.525 FOR PROPOSED SITE EARTHWORKS AND DRAINAGE INFORMATION.
  4. PROPOSED SUBSTATION LOCATION IS PRELIMINARY. FINAL LOCATION TO BE CONFIRMED WITH FURTHER DESIGN.

Project Setbacks/Restrictions	
Item	Required
FRONT YARD	25' FROM ROAD RIGHT OF WAY
SIDE YARD	25' FROM PROPERTY LINE
REAR YARD	25' FROM PROPERTY LINE
DWELLINGS	200' FROM HOUSES
PUBLIC CONSERVATION LANDS	200' (NONE IN PROJECT AREA)

**KEY MAP**

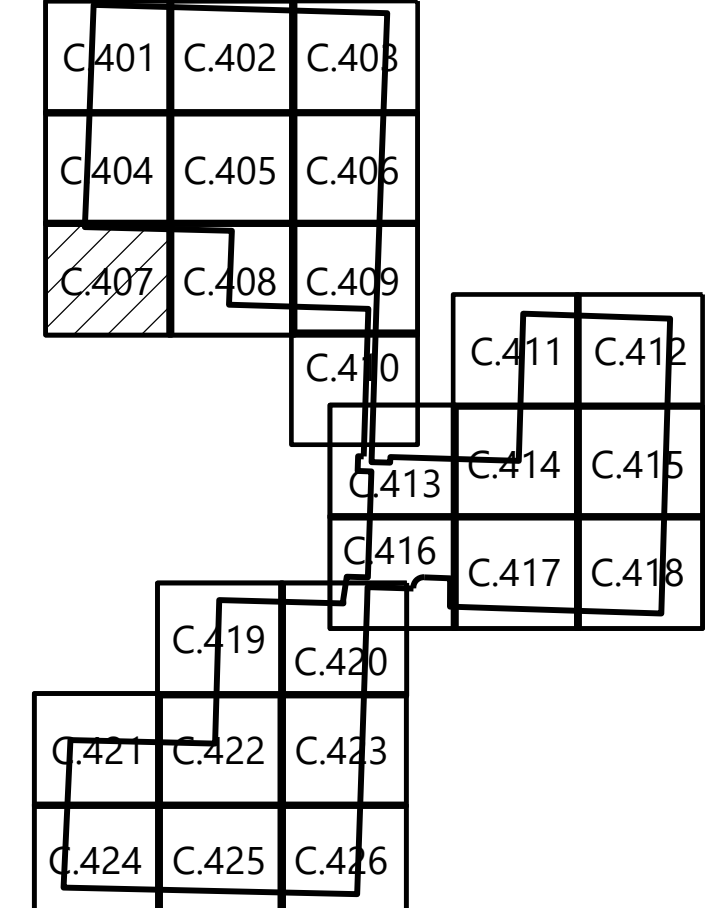

**Westwood**

Phone (952) 937-5150 12701 Whitewater Drive, Suite #300  
 Fax (952) 937-5822 Minnetonka, MN 55343  
 TollFree (888) 937-5150 westwoodps.com  
 Westwood Professional Services, Inc.



8400 Normandale Lake Blvd, Suite 1200  
 Bloomington, MN 55347

**REVISIONS:**

#	DATE	COMMENT	BY	CHK	APR
A	05/01/2023	Permit Plans	MB	BV	KA

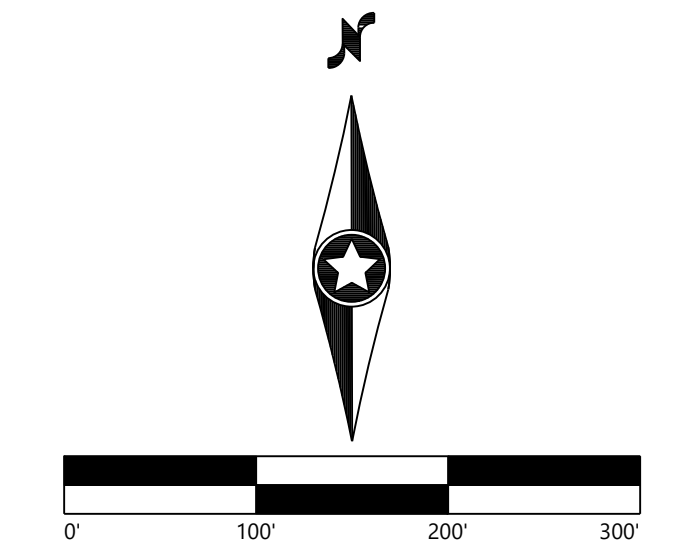

**Elk Creek Solar Project**  
 Rock County, MN

Site Plan - 7

**NOT FOR CONSTRUCTION**

DATE: 05/01/2023 REV:  
 SHEET: C.407 A

S:\2023\1999\2023\05\01\1999\C407.dwg, 5/1/2023 9:57 AM, Matt Brown

SEE SHEET C.405

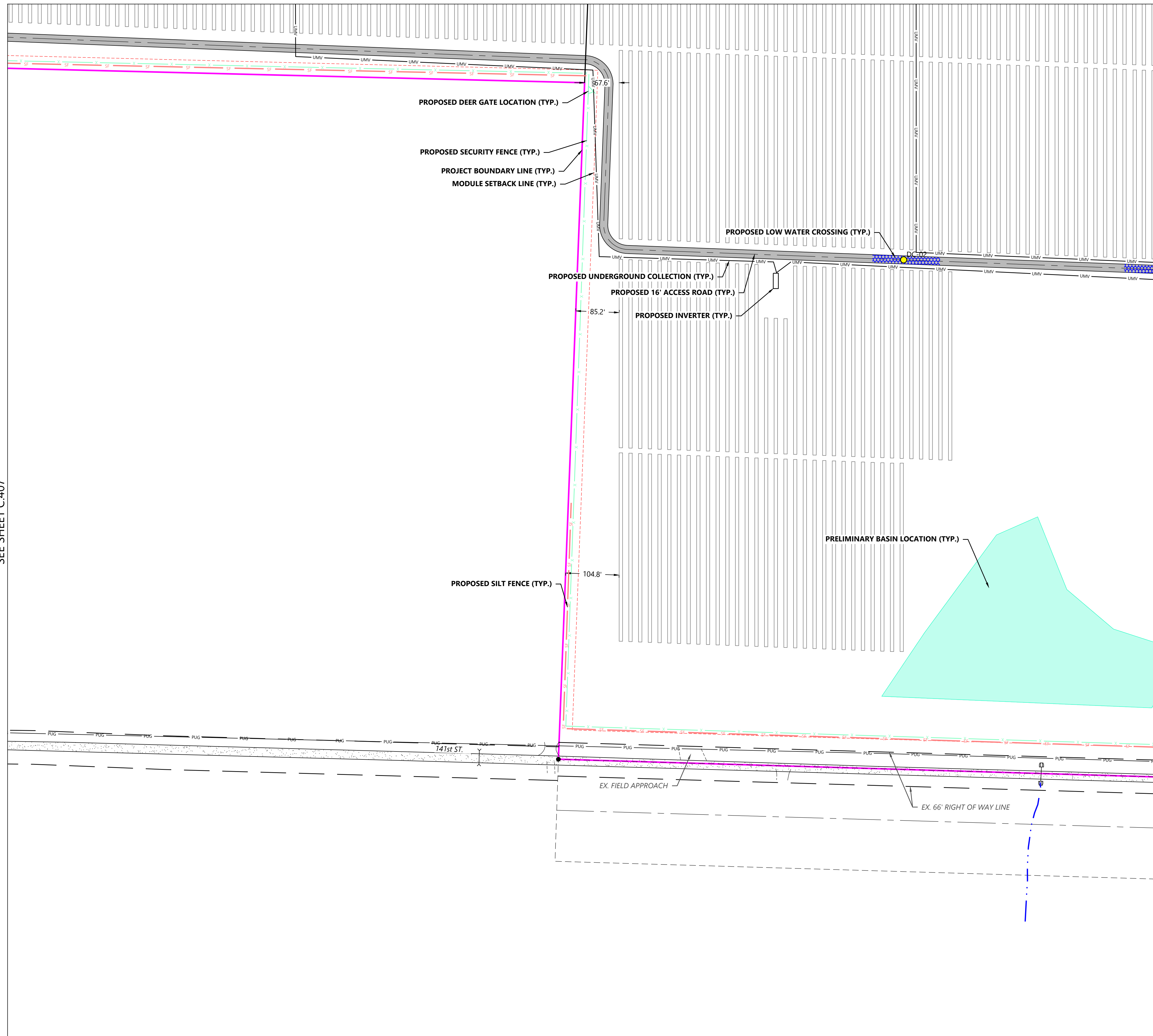

SEE SHEET C.407

SEE SHEET C.409

**LEGEND:**

- PROJECT BOUNDARY
- EX. EASEMENT LINE
- EX. SECTION LINE
- EX. PARCEL LINE
- RIGHT-OF-WAY LINES
- EX. OVERHEAD POWER
- EX. UNDERGROUND COLLECTION
- EX. FIBER OPTIC
- EX. PAVED ROAD
- EX. GRAVEL ROAD
- EX. STREAM CHANNEL
- EX. WETLAND
- EX. STRUCTURE
- EX. CULVERT
- EX. SIGN
- EX. TELEPHONE PEDESTAL
- EX. INDEX CONTOUR
- EX. INTERVAL CONTOUR
- PROPOSED INDEX CONTOUR
- PROPOSED INTERVAL CONTOUR
- PROPOSED SOLAR ARRAY WITH INVERTER
- PROPOSED WETLAND SETBACK
- PROPOSED MODULE SETBACK
- PROPOSED ACCESS ROAD
- PROPOSED SECURITY FENCE
- PROPOSED UNDERGROUND COLLECTION
- PROPOSED OVERHEAD COLLECTION
- PROPOSED LAYDOWN YARD
- PROPOSED O&M LOCATION
- PROPOSED SUBSTATION LOCATION
- PROPOSED EXISTING SUBSTATION EXPANSION LOCATION
- PROPOSED SCREENING
- PROPOSED LOW WATER CROSSING
- PROPOSED SILT FENCE
- PROPOSED CULVERT
- PROPOSED PRELIM DRAINAGE BASIN
- PROPOSED DEER GATE LOCATION

**NOTES:**

1. HORIZONTAL PROJECT COORDINATE SYSTEM IS NAD83 (2011) MINNESOTA STATE PLANES, SOUTH ZONE, US FOOT.
2. SEE C.600 - C.602 DRAWINGS FOR SITE DETAILS, FENCING DETAILS, AND ROAD SECTION DETAILS.
3. SEE GRADING AND DRAINAGE SHEETS C.500 - C.525 FOR PROPOSED SITE EARTHWORKS AND DRAINAGE INFORMATION.
4. PROPOSED SUBSTATION LOCATION IS PRELIMINARY. FINAL LOCATION TO BE CONFIRMED WITH FURTHER DESIGN.

Project Setbacks/Restrictions	
Item	Required
FRONT YARD	25' FROM ROAD RIGHT OF WAY
SIDE YARD	25' FROM PROPERTY LINE
REAR YARD	25' FROM PROPERTY LINE
DWELLINGS	200' FROM HOUSES
PUBLIC CONSERVATION LANDS	200' (NONE IN PROJECT AREA)

**KEY MAP**

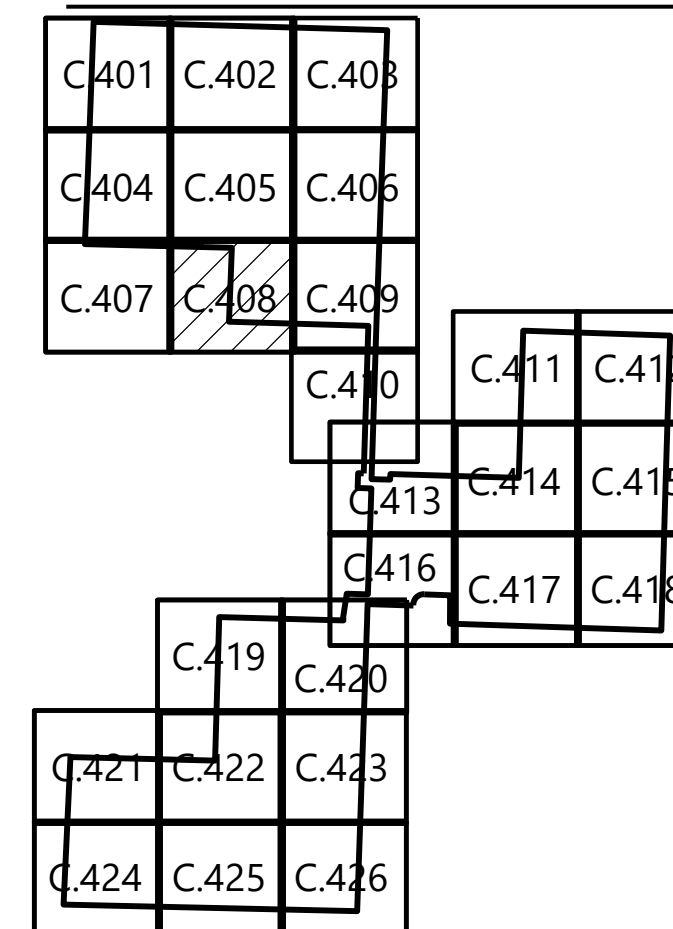

PREPARED FOR:



8400 Normandale Lake Blvd, Suite 1200  
 Bloomington, MN 55347

**REVISIONS:**

#	DATE	COMMENT	BY	CHK	APR
A	05/01/2023	Permit Plans	MB	BV	KA

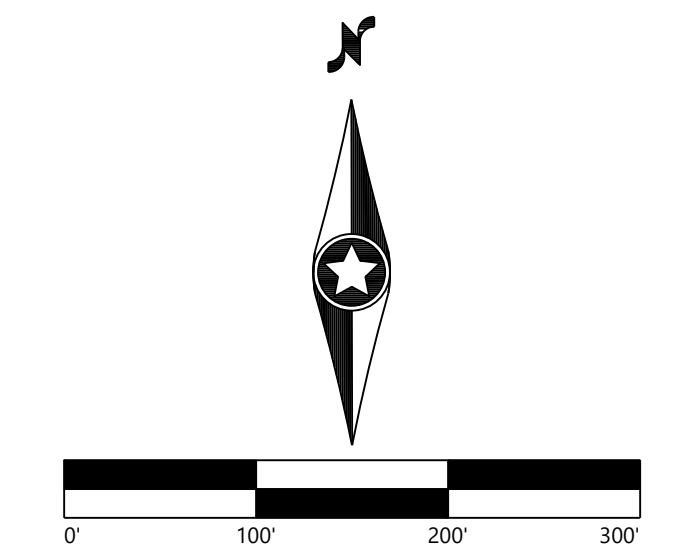

**Elk Creek Solar Project**

Rock County, MN

Site Plan - 8

**NOT FOR CONSTRUCTION**

DATE: 05/01/2023

SHEET: C.408 **A**