

# **Appendix A**

## **Agencies Contacted Regarding Project**

**Nobles 2 Wind Project**

Nobles County, Minnesota

**Nobles 2 Wind Project  
Agency Contact List  
4/19/2016**

<b>Agency</b>	<b>Contact</b>
<b>Federal</b>	
U.S. Army Corps of Engineers (USACE)	U.S. Army Corps of Engineers Attn: Ryan Malterud 180 5 <sup>th</sup> Street East, Ste. 700 St. Paul, MN 55101-1678 Phone: (651) 290-5286 Email: Ryan.M.Malterud@usace.army.mil
U.S. Fish and Wildlife Service (USFWS) (Region 3)	Peter Fasbender U.S. Fish and Wildlife Service Twin Cities Ecological Services Office 4101 American Boulevard East Bloomington, Minnesota 55425 Phone: 952-252-0092, ext. 210 Email: <a href="mailto:peter_fasbender@fws.gov">peter_fasbender@fws.gov</a>
U.S. Fish and Wildlife Service (USFWS) (Region 3)	Mags Rheude U.S. Fish and Wildlife Service Twin Cities Ecological Services Field Office 4101 American Boulevard East Bloomington, Minnesota 55425 Phone: 952-252-0092 ext. 202 Email: <a href="mailto:Margaret_Rheude@fws.gov">Margaret_Rheude@fws.gov</a>
U.S. Department of Agriculture (USDA/NRCS)	Cathee Pullman, State Conservationist Minnesota State Office: USDA/NRCS 375 Jackson Street, Suite 600 St. Paul, Minnesota 55101 Phone: (651) 602-7854 Email: <a href="mailto:cathee.pullman@mn.usda.gov">cathee.pullman@mn.usda.gov</a>

**Nobles 2 Wind Project  
Agency Contact List  
4/19/2016**

<b>Agency</b>	<b>Contact</b>
Federal Aviation Administration	Cindy Whitten OE Wind Turbine Team Manager FAA Central Regional Office 901 Locust St Kansas City, MO 64106 Phone: (816) 329-2528 Email: <a href="mailto:cindy.whitten@faa.gov">cindy.whitten@faa.gov</a>
<b>State</b>	
Minnesota Public Utilities Commission (PUC)  <u>Not contacted via letter for comment.</u> <u>On list for informational purposes only.</u>	Dan Wolf, Executive Secretary Minnesota Public Utilities Commission 121 7 <sup>th</sup> Place East, Suite 350 St. Paul, Minnesota 55101 Phone: 651.201.2217 Email: <a href="mailto:dan.wolf@state.mn.us">dan.wolf@state.mn.us</a>
Minnesota Department of Commerce – Office of Energy Security  <u>Not contacted via letter for comment.</u> <u>On list for informational purposes only.</u>	Rich Davis Energy Facility Permitting Minnesota Department of Commerce 85 7 <sup>th</sup> Place East, Suite 500 St. Paul, MN 55101 Phone: (651) 539-1600 Email: <a href="mailto:richard.davis@state.mn.us">richard.davis@state.mn.us</a>
Minnesota State Historic Preservation Office (SHPO)	Sarah Beimers State Historic Preservation Office Minnesota Historical Society 345 Kellogg Boulevard West St. Paul, Minnesota 55102 Phone: (651) 259-3456 Email: <a href="mailto:sarah.beimers@mnhs.org">sarah.beimers@mnhs.org</a>

**Nobles 2 Wind Project  
Agency Contact List  
4/19/2016**

<b>Agency</b>	<b>Contact</b>
MN BWSR Board Conservationist	Ed Lenz Board Conservationist MN BWSR Regional Office 1400 East Lyon Street Marshall, MN 56258 Phone: (507) 537-6374 Email: <a href="mailto:ed.lenz@state.mn.us">ed.lenz@state.mn.us</a>
Minnesota Department of Natural Resources (MnDNR)	Lisa Joyal Minnesota DNR Natural Heritage Information System 500 Lafayette Road, Box 25 St. Paul, Minnesota 55155 Phone: (651) 259-5109 Email: <a href="mailto:lisa.joyal@state.mn.us">lisa.joyal@state.mn.us</a>
Minnesota Department of Natural Resources (MnDNR)	Jamie Schrenzel Minnesota DNR Energy Project Planner 500 Lafayette Road, Box 25 St. Paul, Minnesota 55155 Phone: (651) 259-5115 Email: <a href="mailto:jamie.schrenzel@state.mn.us">jamie.schrenzel@state.mn.us</a>
Minnesota Department of Natural Resources (MnDNR)	Mr. Kevin Mixon Regional Environmental Assessment Ecologist Minnesota Department of Natural Resources 261 Hwy 15 S New Ulm, MN 56073 Phone: 507-359-6073 Email: <a href="mailto:Kevin.Mixon@state.mn.us">Kevin.Mixon@state.mn.us</a>

**Nobles 2 Wind Project  
Agency Contact List  
4/19/2016**

<b>Agency</b>	<b>Contact</b>
Minnesota Department of Natural Resources (MnDNR)	Brian Nyborg-Region 4 Area Hydrologist (Nobles/Pipestone/Rock/Murray/Cottonwood/Jackson) Ecological and Water Resources 175 County Road 26 Windom, MN 56101-1868 Phone: (507) 831-2900 ext 224 Email: <a href="mailto:bryon.Nyborg@state.mn.us">bryon.Nyborg@state.mn.us</a>
Minnesota Department of Natural Resources (MnDNR)	Bob Hobart DNR Lands and Minerals, Region 4 261 Highway 15 South New Ulm, Minnesota 56073 Phone: (507) 359-6071 Email: <a href="mailto:bob.hobart@state.mn.us">bob.hobart@state.mn.us</a>
Minnesota Pollution Control Agency (MPCA)	Dan Card Minnesota Pollution Control Agency Supervisor, Environmental Review Unit 520 Lafayette Road North St. Paul, Minnesota 55155-4194 Phone: (651) 757-2261 Email: <a href="mailto:dan.card@state.mn.us">dan.card@state.mn.us</a>
Minnesota Department of Health (MDH)	Minnesota Department of Health Environmental Health Division 625 Robert Street N P.O. Box 64975 St. Paul, MN 55164-0975 Marshall, MN 56258: (651) 201-4899 Email: <a href="mailto:health.climatechange@state.mn.us">health.climatechange@state.mn.us</a>

**Nobles 2 Wind Project  
Agency Contact List  
4/19/2016**

<b>Agency</b>	<b>Contact</b>
Minnesota Department of Transportation	Greg Ous Transportation District 7 Engineer 2151 Bassett Drive Mankato, MN 56001-6888 Phone: (507) 304-6101 Email: <a href="mailto:greg.ous@state.mn.us">greg.ous@state.mn.us</a>
Minnesota Department of Transportation Office of Aeronautics	Darlene Dahlseide MnDOT Office of Aeronautics 222 East Plato Boulevard St. Paul, Minnesota 55107-1618 Phone: (651) 234-7248 Email: <a href="mailto:darlene.dahlseide@state.mn.us">darlene.dahlseide@state.mn.us</a>
<b>Local</b>	
Heron Lake Watershed district	Jan Voit-District Administrator Heron Lake Watershed District 1008 3 <sup>rd</sup> Ave., P.O. Box 345 Heron Lake, MN 56137 Phone: 507-793-2462 Email: <a href="mailto:Jan.voit@mysmbs.com">Jan.voit@mysmbs.com</a>
Karananzi-Little Rock Watershed District (KLR)	John Shea-Administrator Kanaranzi-Little Rock Watershed District Nobles SWCD/NRCS Office 1567 McMillan Street, Suite 3 Worthington, MN 56187 Phone: 507-376-9150 ext 3 Email: <a href="mailto:John.shea@noblesswcd.org">John.shea@noblesswcd.org</a>

**Nobles 2 Wind Project  
Agency Contact List  
4/19/2016**

<b>Agency</b>	<b>Contact</b>
City of Lismore, Mayor	Mayor Dave Lutmer City of Lismore P.O. Box 44 Lismore, MN 56155 Phone: (507) 472-8779 Email: <a href="mailto:cityoflismore@gmail.com">cityoflismore@gmail.com</a>
City of Wilmont, Mayor	Mayor Paul Grant 111 4 <sup>th</sup> Avenue North Wilmont, MN 56185 Phone: (507) 926-5235 (Wilmont City Hall) Email:
Nobles County Administration	Tom Johnson-Administrator Nobles County 315 Tenth Street PO Box 757 Worthington, MN 56187 Phone: (507) 295-5201 Email: <a href="mailto:tjohnson@co.nobles.mn.us">tjohnson@co.nobles.mn.us</a>
Nobles County Environmental Services	Wayne Smith, Environmental Services Director Nobles County 960 Diagonal Road PO Box 187 Worthington, MN 56187 Phone: (507) 295-5322 Email: <a href="mailto:wsmith@co.nobles.mn.us">wsmith@co.nobles.mn.us</a>
Nobles County Public Works Office	Stephen P. Schnieder-Director Nobles County Public Works Office 960 Diagonal Road PO Box 187 Worthington, MN 56187 Phone: (507) 295-5322 Email: <a href="mailto:sschnieder@co.nobles.mn.us">sschnieder@co.nobles.mn.us</a>

**Nobles 2 Wind Project  
Agency Contact List  
4/19/2016**

<b>Agency</b>	<b>Contact</b>
Nobles County Soil and Water Conservation District (SWCD)	John Shea Nobles SWCD District Manager 1567 McMillan Street, Suite 3 Worthington, MN 56187 Phone: (507) 376-9150 ext #113 Email: <a href="mailto:john.shea@noblesswcd.org">john.shea@noblesswcd.org</a>
Nobles County Board Chair	Commissioner Gene Metz Chairperson Nobles County Commissioner, Second District 17190 180 <sup>th</sup> St. Lismore, MN 56155 Phone: (507) 295-5201 Email: <a href="mailto:gmetz@co.nobles.mn.us">gmetz@co.nobles.mn.us</a>
Murray County Zoning Administrator	Jean Christoffels Murray County Zoning Administrator 2500 28 <sup>th</sup> Street Slayton, MN 56172 Phone: (507) 836-1166 Email: <a href="mailto:jchristoffels@co.murray.mn.us">jchristoffels@co.murray.mn.us</a>
Murray County Environmental Services	Chris Hansen Murray County Water Resources Administrator 2500 28 <sup>th</sup> Street Slayton, MN 56172 Phone: (507)836-1165 Email: <a href="mailto:chansen@co.murray.mn.us">chansen@co.murray.mn.us</a>
Murray County Highway Department	Randy Groves Murray County Engineer 3051 20 <sup>th</sup> Street Slayton, MN 56172 Phone: (507) 836-1133 Email: <a href="mailto:mchd@co.murray.mn.us">mchd@co.murray.mn.us</a> Also sent to <a href="mailto:rgroves@co.murray.mn.us">rgroves@co.murray.mn.us</a>



**Nobles 2 Wind Project  
Agency Contact List  
4/19/2016**

<b>Agency</b>	<b>Contact</b>
Murray County Soil and Water Conservation District (SWCD)	Howard Konkol Murray SWCD District Manager 2740 22 <sup>nd</sup> Street Slayton, MN 56172 Phone: (507) 836-6990 Ext. #3 Email: <a href="mailto:hkonkol@co.murray.mn.us">hkonkol@co.murray.mn.us</a>
Murray County Board Chair	Commissioner Dave Thiner-District 5 Murray County Commissioner, Board Chair 2500 28 <sup>th</sup> Street Slayton, MN 56172 Phone: (507) 360-1199 Email: <a href="mailto:dthiner@co.murray.mn.us">dthiner@co.murray.mn.us</a>
Southwest Regional Development Commission	Jayme I. Trusty South West Regional Development Commission 2401 Broadway Avenue, Suite 1 Slayton, MN 56172 Phone: (507) 836-1636 Email: <a href="mailto:execdir@swrdc.org">execdir@swrdc.org</a>
<b>Nobles County Townships</b>	
Leota Township	Chairperson Kenneth Bolkema Leota Township 10962 Behrens Ave. Edgerton, MN 56128
Wilmont Township	Chairperson Darren Jeffers Wilmont Township 13402 Edwards Avenue Wilmont, MN 56185
Bloom Township	Chairperson Kevin Onken Bloom Township 25307 120 <sup>th</sup> Street Fulda, MN 56131

**Nobles 2 Wind Project  
Agency Contact List  
4/19/2016**

<b>Agency</b>	<b>Contact</b>
Seward Township	Chairperson Gerald Duerr Seward Township 31215 120 <sup>th</sup> Street Fulda, MN 56131
Lismore Township	Chairman Mark Lenz Lismore Township 18789 Bulick Avenue Lismore, MN 56155
Larkin Township	Chairperson Gary Honermann Larkin Township 18334 220 <sup>th</sup> Street Adrian, MN 56110
Summit Lake Township	Chairperson Paul Rogers Summit Lake Township 25782 180 <sup>th</sup> Street Reading, MN 56165
Elk Township	Chairperson Chad Nickel Elk Township 17966 Oliver Avenue Reading, MN 56165
<b>Murray County Townships</b>	
Fenton Township	Chairperson Harris VanRuler Fenton Township 630 56 <sup>th</sup> Street Chandler, MN 56122 Phone: (507) 677-2329



March 18, 2016

Jamie Schrenzel  
 Minnesota Department of Natural Resources  
 Energy Project Planner  
 500 Lafayette Road, Box 25  
 St. Paul, Minnesota 55155

**Re: Nobles 2 250-300MW Wind Farm**  
 File 0001661.00  
**Cc: Paul White, Nobles 2 Power Partners, LLC**  
 Kelly Kunst, Westwood Professional Services

Dear Ms. Schrenzel:

Nobles 2 Power Partners, LLC (N2PP) requests your formal comments regarding our plans to obtain a site permit from the Minnesota Public Utilities Commission (PUC) for the 250-300 MW Nobles 2 Wind Farm (Project). N2PP would also like to thank you for taking the time review the draft Site Characterization Study of the Project and meeting with us on February 29, 2016 to discuss Nobles 2. As indicated, we plan to apply for a Site Permit and Certificate of Need from the PUC in spring 2016.

N2PP proposes to construct the Project in Nobles County in southwestern Minnesota (**Exhibit 1**). The overall “Project Area” is located in the Townships, Ranges, and Sections indicated in the table below.

Nobles 2 Wind Farm Project Area				
Township	Range	Sections	Township Name	County
104N	43W	13, 23-28, 33-36	Leota	Nobles
104N	42W	S1-4, 8-36	Wilmont	Nobles
104N	41W	S2-36	Bloom	Nobles
104N	40W	S18-19, 30-31	Seward	Nobles
103N	43W	S1-4	Lismore	Nobles
103N	42W	S1-6	Larkin	Nobles
103N	41W	S1-6, 11-14, 23-25	Summit Lake	Nobles
103N	40W	S4-9, 16-21, 28-30	Elk	Nobles
105N	42W	S34-36	Fenton	Murray

The Project is a Large Wind Energy Conversion System (LWECS), as defined in the Wind Siting Act, Minnesota Statutes § 216F.01, and a Site Permit is required for the Project under Minnesota Statutes §

216F.04. Consistent with PUC objectives, N2PP is committed to designing the Project in an orderly manner compatible with environmental preservation, sustainable development, and the efficient use of resources. All decisions with respect to equipment selection, site layout, and spacing are designed to make the most efficient use of land and wind resources while minimizing environmental impacts to the extent practicable. The turbine selected for the Project will be dependent on the most appropriate technology available at the time of ordering equipment prior to construction.

The Project will consist of approximately 150 wind turbines, access roads, underground collection lines, step up transformers, permanent meteorological tower(s), and step up substation. As noted in our discussions, several existing wind farms are in the area of the Project including Nobles (200 MW) and Community Wind South (30 MW) south of the Project Area, Fenton Wind Power Plant (205.5 MW) and Stoneray (not yet constructed) northwest of the Project Area, and Prairie Rose Wind (200 MW) approximately 10 miles west of the Project Area.

N2PP has engaged Westwood Professional Services to complete initial studies and permitting for the Project. As indicated in N2PP's draft Site Characterization Study, the Project Area is primarily comprised of cultivated agricultural land. The predominance of agricultural land, lack of suitable habitat for sensitive species, and pre-and post-construction avian and bat survey information from surrounding wind farms and other farms located in southern Minnesota indicates the Project will be a low risk to avian and bat species. Nonetheless, in an effort to verify the low-risk characterization, general avian point count and eagle point count surveys were initiated in January 2016. As a result of our recent agency discussions regarding avian and bat surveys for the Project, Westwood has adjusted the frequency of eagle point count surveys to include sampling twice per month in March and April and October and November to better capture the peak migration period for bald eagles. Raptor nest surveys, including bald eagles, will be initiated in the next week and grassland and riparian bird surveys are expected to be initiated in mid-May.

N2PP requests your formal comments of the Project for potential environmental impacts and would appreciate any recommendations you may have regarding potential impacts to species of concern.

If you have questions, please contact me at 612-284-4778 or at [jay.regnier@prcwind.com](mailto:jay.regnier@prcwind.com).

Sincerely,

NOBLES 2 POWER PARTNERS, LLC

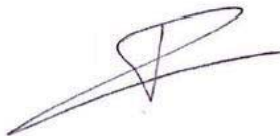
A handwritten signature in black ink, appearing to read 'Jay Regnier', with a stylized flourish at the end.

Jay Regnier P.Eng.  
Director of Project Development

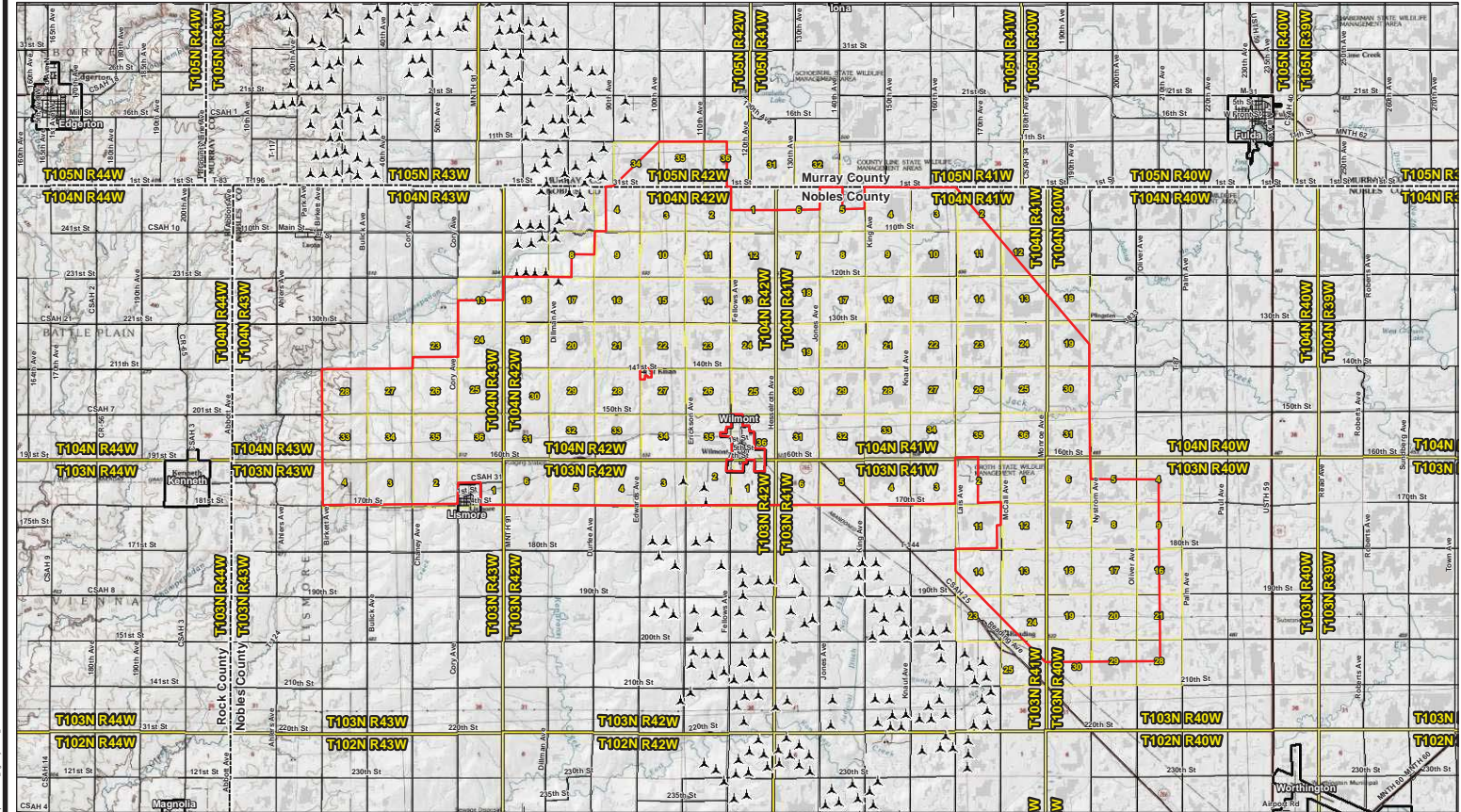

Westwood  
 10000  
 Westwood Professional Services, Inc.



**Legend**

- Project Area
- Existing Wind Turbine
- PLS Township Boundary
- PLS Section Boundary
- Road
- County Boundary
- Municipal Boundary



**Nobles 2 Wind Project**  
 Nobles and Murray County, Minnesota  
 Project Area &  
 USGS Topography  
 EXHIBIT 1





2012	<b>For Agency Use Only:</b>			#Sec _____ Contact Rqsted? _____
	Received _____ Due _____	Inv _____	#EOs _____ Survey Rqsted? _____	
	Search Radius _____mi. L / I / D EM Map'd _____	#Com _____	Related ERDB# _____	
	NoR / NoF / NoE / Std / Sub Let _____ Log out _____			

**NATURAL HERITAGE INFORMATION SYSTEM (NHIS) DATA REQUEST FORM**

Please read the instructions on page 3 before filling out the form. Thank you!

**WHO IS REQUESTING THE INFORMATION?**

Mr. Name and Title Kelly Kunst  
 Ms. Agency/Company Westwood Professional Services  
 Mailing Address 7699 Anagram Drive, Eden Prairie, MN 55344  
(Street) (City) (State) (Zip Code)  
 Phone 952-906-7421 e-mail kelly.kunst@westwoodps.com Responses will be sent via email.   
 If you prefer US Mail check here:

**THIS INFORMATION IS BEING REQUESTED FOR A:**

- Federal EA     State EAW     PUC Site or Route Application     Watershed Plan     BER  
 Federal EIS     State EIS     Local Government Permit     Research Project  
 NEPA Checklist     Other (describe) \_\_\_\_\_  
 Check here if this project is funded through any of the following grant programs: Lessard-Sams Outdoor Heritage Council (L-SOHC), Conservation Partners Legacy (CPL), or Legislative-Citizen Commission on Minnesota Resources (LCCMR).

**INFORMATION WE NEED FROM YOU:**

- 1) **Enclose a map** of the project boundary/area of interest (topographic maps or aerial photos are preferred).
- 2) Please **provide a GIS shapefile\*** (NAD 83, UTM Zone 15N) of the project boundary/area of interest.
- 3) List the following locational information\* (attach additional sheets if necessary):

For Agency Use: Region / MCBS Status	County	Township #	Range #	Section(s) (please list <b>all</b> sections)	For Agency Use: TRS Confirmed <input type="checkbox"/>
	Nobles	104	42	S1-3 and 9-36	
	Nobles	104	41	S2-36	
	Nobles	104	40	S18, 19, 31, and 32	
	Nobles	103	42W	S1-6 (**see attached list for all of S, T, R within Project Area)	

- 4) Please provide the following information (attach additional sheets if necessary):

Project Name: Nobles 2 Wind Farm  
 Project Proposer: Nobles 2 Power Partners, LLC

Description of Project (including types of disturbance anticipated from the project):

Construction of an approximately 250MW total nameplate capacity wind farm including ~150 turbines, access roads, underground collection lines, step up transformers, and step up substation. A preliminary project layout is not available at this time.

Describe the existing land use of the project site. What types of land cover / habitat will be impacted by the proposed project?

The Project Area is primarily agricultural land with interspersed pastureland and wetlands. Wooded areas are generally limited to farmsteads and fencerows.

List any waterbodies (e.g., rivers, intermittent streams, lakes, wetlands) that may be affected by the proposed project, and discuss how they may be impacted (e.g., dewatering, discharge, riverbed disturbance).

Wetland and water resources are expected to be avoided by the Project.

Does the project have the potential to affect any groundwater resources (e.g., groundwater appropriation, change in recharge, or contamination)?

The Project is not anticipated to affect any groundwater resources.

To your knowledge, has the project undergone a previous Natural Heritage review? If so, please list the correspondence #: ERDB # \_\_\_\_\_. How does this request differ from the previous request (e.g., change in scope, change in boundary, project being revived, project expansion, different phase)?

No

To your knowledge, have any native plant community or rare species surveys been conducted within the site? If so, please list: MCBS

List any DNR Permits or Licenses that you will be applying for or have already applied for as part of this project:

Undetermined-pending project layout.

#### INFORMATION WE PROVIDE TO YOU:

1) The response will include a Natural Heritage letter. If applicable, the letter will discuss potential effects to rare features.

- Check here if you are interested in a list of rare features in the vicinity of the area of interest but you do **not** need a review of potential effects to rare features. Please list the reason a review is not needed:

2) Depending on the results of the query or review, the response may include an Index Report of known aggregation sites and known occurrences of federally and state-listed plants and animals\* within an approximate one-mile radius of the project boundary/area of interest. The Index Report and Natural Heritage letter can be included in any public environmental review document.

3) A Detailed Report that contains more information on each occurrence may also be requested. Please note that the Detailed Report may contain specific location information that is protected under *Minnesota Statutes*, section 84.0872, subd. 2, and, as such, the Detailed Report may not be included in any public document (e.g., an EAW).

- Check here if you would like to request a Detailed Report. Please note that if the results of the review are 'No Effects' or a standard comment, a Detailed Report may not be available.

#### FEES / TURNAROUND TIME

There is a fee\* for this service. Requests generally take 3-4 weeks from date of receipt to process, and are processed in the order received.

I have read the entire form and instructions, and the information supplied above is complete and accurate. I understand that material supplied to me from the Natural Heritage Information System is copyrighted and that I am not permitted to reproduce or publish any of this copyrighted material without prior written permission from the DNR. Further, if permission to publish is given, I understand that I must credit the Minnesota Division of Ecological and Water Resources, Minnesota Department of Natural Resources, as the source of the material.

Signature  
(required)

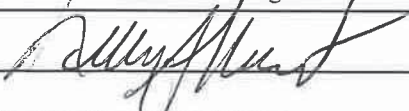

Note: Digital signatures representing the name of a person shall be sufficient to show that such person has signed this document.

#### Mail or email completed form to:

Lisa Joyal, Endangered Species Review Coordinator  
Division of Ecological and Water Resources  
Minnesota Department of Natural Resources  
500 Lafayette Road, Box 25  
St. Paul, Minnesota 55155  
Review.NHIS@state.mn.us

Form is available at

[http://files.dnr.state.mn.us/eco/nhnrp/nhis\\_data\\_request.pdf](http://files.dnr.state.mn.us/eco/nhnrp/nhis_data_request.pdf)

Revised March 2, 2012

\* Please see the instructions on page 3.

Nobles 2 Wind Farm-Complete List of Project Area Section, Townships, Range

<b>Township</b>	<b>Range</b>	<b>Sections</b>	<b>Township Name</b>	<b>County</b>
104N	42W	S1-3, 9-36	Wilmont	Nobles
104N	41W	S2-36	Bloom	Nobles
104N	40W	S18, 19, 30, 31	Seward	Nobles
103N	42W	S1-6	Larkin	Nobles
103N	41W	S1-6, 11-14, 23-25	Summit Lake	Nobles
103N	40W	S4-9, 16-21, 28-30	Elk	Nobles



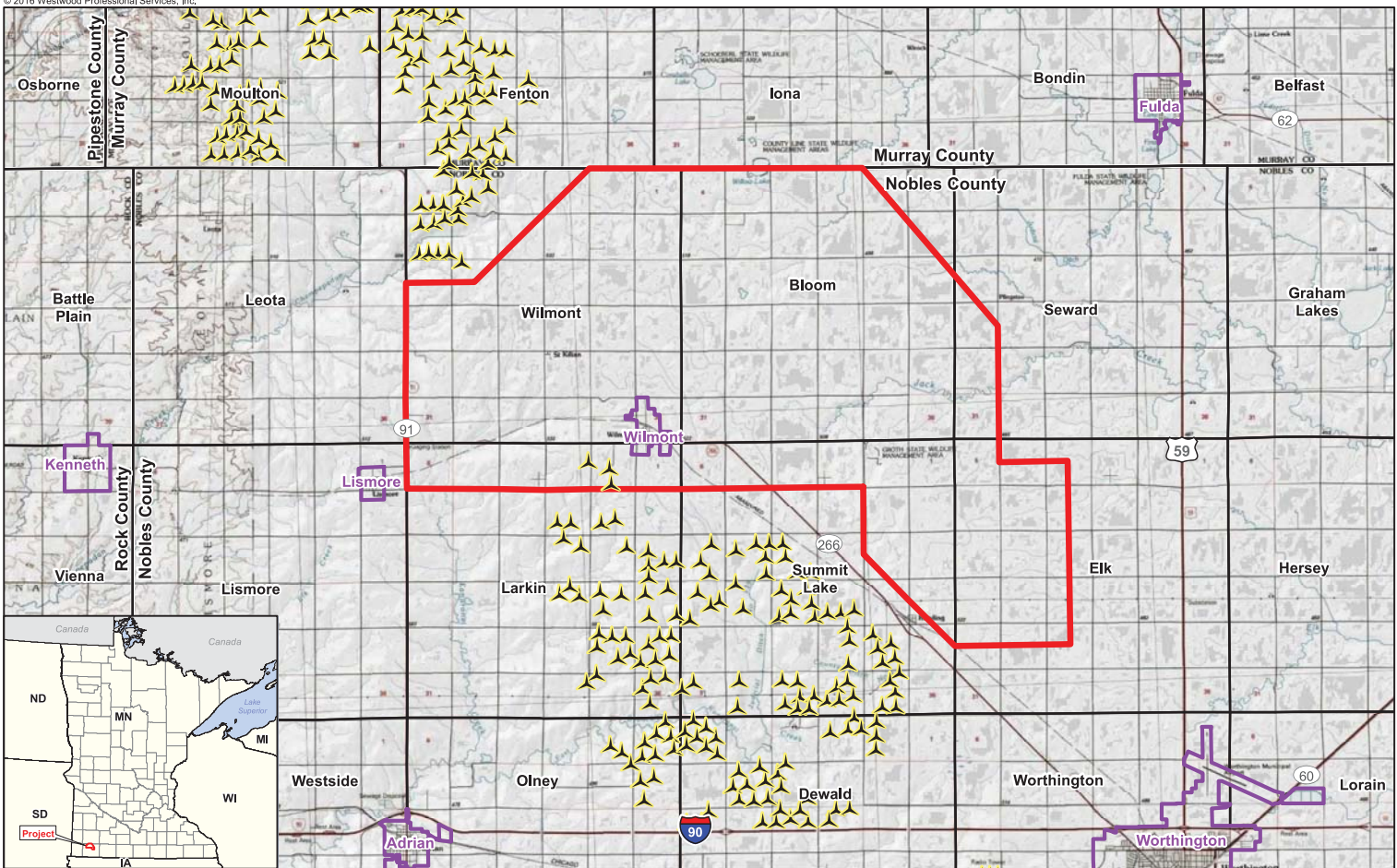

Data Source(s): Data and map are approximate. Westwood (2016); ESRI WMS USA Topo Imagery (Accessed 2016); ESRI (2012); MnDOT (2003); MndNR (2010); Census Bureau (2014).

**Legend**

- Project Boundary
- City Boundary
- County Boundary
- Township Boundary
- Existing Wind Turbine (Others)



**Nobles 2 Wind Farm**

Nobles County, Minnesota  
 Project Location  
 USGS Topography  
 EXHIBIT 1



2012	<b>For Agency Use Only:</b>	#Sec _____ Contact Rqsted? _____
	Received _____ Due _____ Inv _____	#EOs _____ Survey Rqsted? _____
	Search Radius _____mi. L / I / D EM Map'd _____	#Com _____
	NoR / NoF / NoE / Std / Sub Let _____ Log out _____	Related ERDB# _____

**NATURAL HERITAGE INFORMATION SYSTEM (NHIS) DATA REQUEST FORM**

Please read the instructions on page 3 before filling out the form. Thank you!

**WHO IS REQUESTING THE INFORMATION?**

Mr. Name and Title Kelly Kunst  
 Ms. Agency/Company Westwood Professional Services  
 Mailing Address 7699 Anagram Drive, Eden Prairie, MN 55344  
(Street) (City) (State) (Zip Code)  
 Phone 952-906-7421 e-mail kelly.kunst@westwoodps.com Responses will be sent via email.   
 If you prefer US Mail check here:

**THIS INFORMATION IS BEING REQUESTED FOR A:**

- Federal EA     State EAW     PUC Site or Route Application     Watershed Plan     BER  
 Federal EIS     State EIS     Local Government Permit     Research Project  
 NEPA Checklist     Other (describe) \_\_\_\_\_  
 Check here if this project is funded through any of the following grant programs: Lessard-Sams Outdoor Heritage Council (L-SOHC), Conservation Partners Legacy (CPL), or Legislative-Citizen Commission on Minnesota Resources (LCCMR).

**INFORMATION WE NEED FROM YOU:**

- 1) **Enclose a map** of the project boundary/area of interest (topographic maps or aerial photos are preferred).
- 2) Please **provide a GIS shapefile\*** (NAD 83, UTM Zone 15N) of the project boundary/area of interest.
- 3) List the following locational information\* (attach additional sheets if necessary):

For Agency Use: Region / MCBS Status	County	Township #	Range #	Section(s) (please list <b>all</b> sections)	For Agency Use: TRS Confirmed <input type="checkbox"/>
	Nobles	104N	43W	13,23-28, 33-36	
		104N	42W	4, 8	
		103N	43W	1-4	
	Murray	105N	42W	34-36	

- 4) Please provide the following information (attach additional sheets if necessary):

Project Name: Nobles 2 Wind Farm  
 Project Proposer: Nobles 2 Power Partners, LLC

Description of Project (including types of disturbance anticipated from the project):

Construction of an approximatley 250-300MW total nameplate capacity wind farm including approximatley 150 turbines, access roads, underground collection linees, stepup trnasformers, and step up substation. A preliminary project layout is not avaialbe at this time.

Describe the existing land use of the project site. What types of land cover / habitat will be impacted by the proposed project?

The Project Area is primarily agricultural land with interspersed pastureland and wetlands. Wooded areas are generally limited to farmstead and fencerows.

List any waterbodies (e.g., rivers, intermittent streams, lakes, wetlands) that may be affected by the proposed project, and discuss how they may be impacted (e.g., dewatering, discharge, riverbed disturbance).

Wetland and water resources are expected to be avoided by the Project to the extent practicable.

Does the project have the potential to affect any groundwater resources (e.g., groundwater appropriation, change in recharge, or contamination)?

The Project is not anticipated to affect groundwater resources.

To your knowledge, has the project undergone a previous Natural Heritage review? If so, please list the correspondence #: ERDB # \_\_\_\_\_. How does this request differ from the previous request (e.g., change in scope, change in boundary, project being revived, project expansion, different phase)?

A previous request dated 1/26/2016 was submitted for a smaller study area but the results have not yet been provided. This request is for additional land in the project area.

To your knowledge, have any native plant community or rare species surveys been conducted within the site? If so, please list: MCBS

List any DNR Permits or Licenses that you will be applying for or have already applied for as part of this project:

Undetermined-pending project layout.

#### INFORMATION WE PROVIDE TO YOU:

1) The response will include a Natural Heritage letter. If applicable, the letter will discuss potential effects to rare features.

- Check here if you are interested in a list of rare features in the vicinity of the area of interest but you do **not** need a review of potential effects to rare features. Please list the reason a review is not needed:

2) Depending on the results of the query or review, the response may include an Index Report of known aggregation sites and known occurrences of federally and state-listed plants and animals\* within an approximate one-mile radius of the project boundary/area of interest. The Index Report and Natural Heritage letter can be included in any public environmental review document.

3) A Detailed Report that contains more information on each occurrence may also be requested. Please note that the Detailed Report may contain specific location information that is protected under *Minnesota Statutes*, section 84.0872, subd. 2, and, as such, the Detailed Report may not be included in any public document (e.g., an EAW).

- Check here if you would like to request a Detailed Report. Please note that if the results of the review are 'No Effects' or a standard comment, a Detailed Report may not be available.

#### FEES / TURNAROUND TIME

There is a fee\* for this service. Requests generally take 3-4 weeks from date of receipt to process, and are processed in the order received.

I have read the entire form and instructions, and the information supplied above is complete and accurate. I understand that material supplied to me from the Natural Heritage Information System is copyrighted and that I am not permitted to reproduce or publish any of this copyrighted material without prior written permission from the DNR. Further, if permission to publish is given, I understand that I must credit the Minnesota Division of Ecological and Water Resources, Minnesota Department of Natural Resources, as the source of the material.

Signature  
(required)

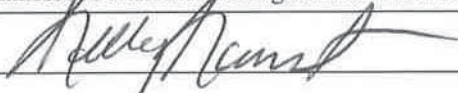

Note: Digital signatures representing the name of a person shall be sufficient to show that such person has signed this document.

#### Mail or email completed form to:

Lisa Joyal, Endangered Species Review Coordinator  
Division of Ecological and Water Resources  
Minnesota Department of Natural Resources  
500 Lafayette Road, Box 25  
St. Paul, Minnesota 55155  
[Review.NHIS@state.mn.us](mailto:Review.NHIS@state.mn.us)

Form is available at

[http://files.dnr.state.mn.us/eco/nhnrp/nhis\\_data\\_request.pdf](http://files.dnr.state.mn.us/eco/nhnrp/nhis_data_request.pdf)

Revised March 2, 2012



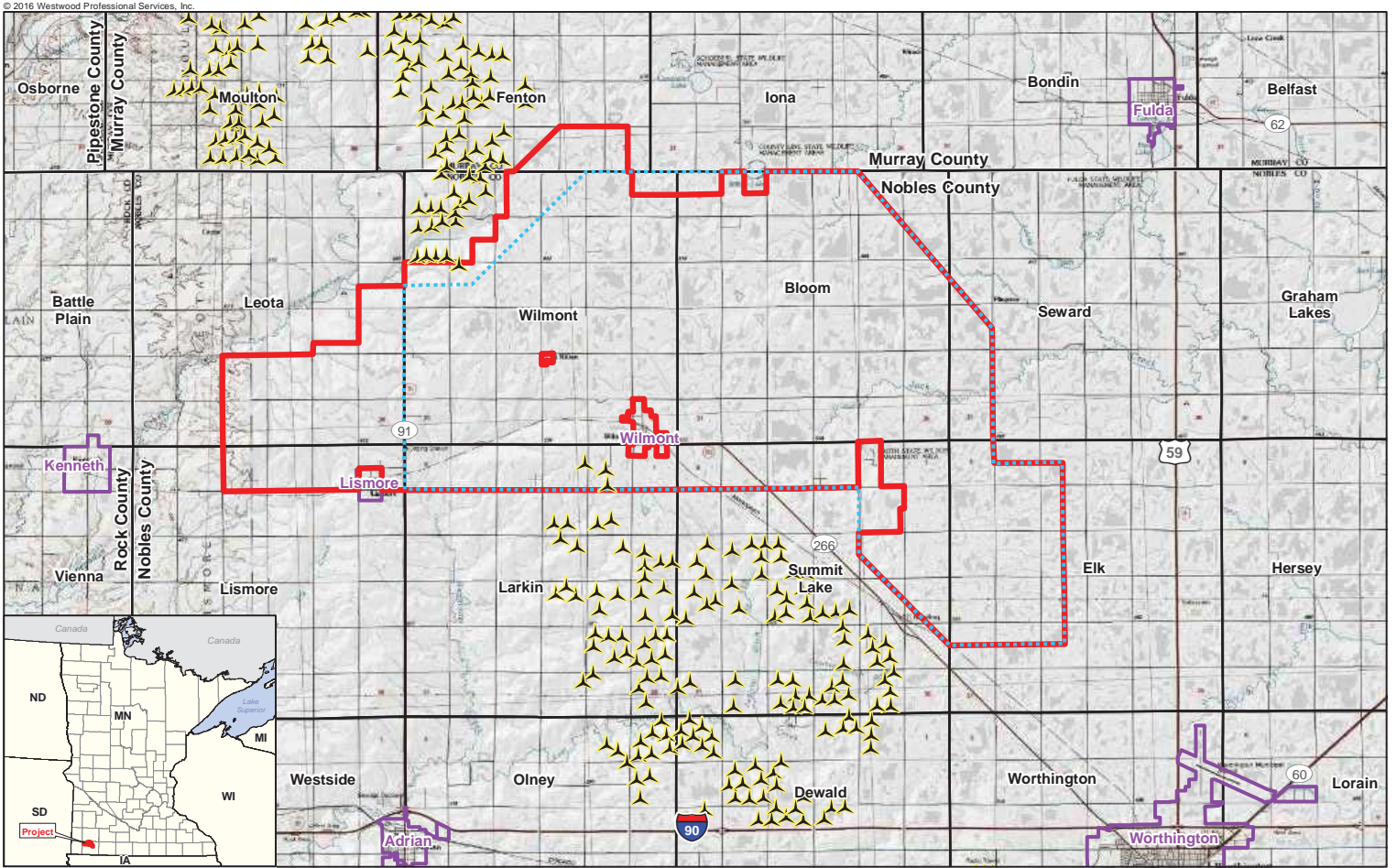

Data Source(s): Data and map are approximate.  
 Westwood (2016); ESRI WMS USA Topo Imagery (Accessed 2016); ESRI (2012); MnDOT (2003); MnDNR (2010); Census Bureau (2014).

**Legend**

- Current Project Boundary
- Previous Project Boundary
- County Boundary
- City Boundary
- Township Boundary
- ▲ Existing Wind Turbine (Others)



Toll Free (888) 937-5150 westwoodps.com  
 Westwood Professional Services, Inc.



**Nobles 2 Wind Farm**

Nobles County, Minnesota  
 Project Location  
 USGS Topography  
 EXHIBIT 1



2012	<b>For Agency Use Only:</b>	#Sec _____ Contact Rqsted? _____
	Received _____ Due _____ Inv _____	#EOs _____ Survey Rqsted? _____
	Search Radius _____mi. L / I / D EM Map'd _____	#Com _____
	NoR / NoF / NoE / Std / Sub Let _____ Log out _____	Related ERDB# _____

## NATURAL HERITAGE INFORMATION SYSTEM (NHIS) DATA REQUEST FORM

Please read the instructions on page 3 before filling out the form. Thank you!

### WHO IS REQUESTING THE INFORMATION?

Mr. Name and Title Kelly Kunst

Ms. Agency/Company Westwood Professional Services

Mailing Address 7699 Anagram Drive, Eden Prairie, MN 55344

(Street) (City) (State) (Zip Code)

Phone 952-906-7421 e-mail kelly.kunst@westwoodps.com Responses will be sent via email.   
If you prefer US Mail check here:

### THIS INFORMATION IS BEING REQUESTED FOR A:

- Federal EA     State EAW     PUC Site or Route Application     Watershed Plan     BER  
 Federal EIS     State EIS     Local Government Permit     Research Project  
 NEPA Checklist     Other (describe) \_\_\_\_\_  
 Check here if this project is funded through any of the following grant programs: Lessard-Sams Outdoor Heritage Council (L-SOHC), Conservation Partners Legacy (CPL), or Legislative-Citizen Commission on Minnesota Resources (LCCMR).

### INFORMATION WE NEED FROM YOU:

- 1) **Enclose a map** of the project boundary/area of interest (topographic maps or aerial photos are preferred).
- 2) Please **provide a GIS shapefile\*** (NAD 83, UTM Zone 15N) of the project boundary/area of interest.
- 3) List the following locational information\* (attach additional sheets if necessary):

For Agency Use: Region / MCBS Status	County _____	Township # _____	Range # _____	Section(s) (please list <b>all</b> sections) _____	For Agency Use: TRS Confirmed <input type="checkbox"/>
	See attached list				
	_____	_____	_____	_____	_____
	_____	_____	_____	_____	_____

- 4) Please provide the following information (attach additional sheets if necessary):

Project Name: Nobles 2 Wind Project

Project Proposer: Nobles 2 Power Partners, LLC

Description of Project (including types of disturbance anticipated from the project):

Construction of an approximately 250MW total nameplate capacity wind farm including up to 150 turbines, access roads, underground collection lines, step up transformers, and step up substation. A preliminary project layout is not available at this time.

Describe the existing land use of the project site. What types of land cover / habitat will be impacted by the proposed project?

The Project Area is primarily agricultural land interspersed with pastureland and wetlands. Wooded areas are generally limited to farmsteads and fencerows.

List any waterbodies (e.g., rivers, intermittent streams, lakes, wetlands) that may be affected by the proposed project, and discuss how they may be impacted (e.g., dewatering, discharge, riverbed disturbance).

Wetlands and water resources are anticipated to be avoided by the project.

Does the project have the potential to affect any groundwater resources (e.g., groundwater appropriation, change in recharge, or contamination)?

The project is not anticipated to affect ground water resources.

To your knowledge, has the project undergone a previous Natural Heritage review? If so, please list the correspondence #: ERDB # 20160294. How does this request differ from the previous request (e.g., change in scope, change in boundary, project being revived, project expansion, different phase)?

Change in Project Area boundary and one year has passed since last request.

To your knowledge, have any native plant community or rare species surveys been conducted within the site? If so, please list: No. Preconstruction avian, eagle and bat surveys have taken place.

List any DNR Permits or Licenses that you will be applying for or have already applied for as part of this project:

N/A

#### INFORMATION WE PROVIDE TO YOU:

1) The response will include a Natural Heritage letter. If applicable, the letter will discuss potential effects to rare features.

- Check here if you are interested in a list of rare features in the vicinity of the area of interest but you do **not** need a review of potential effects to rare features. Please list the reason a review is not needed:

2) Depending on the results of the query or review, the response may include an Index Report of known aggregation sites and known occurrences of federally and state-listed plants and animals\* within an approximate one-mile radius of the project boundary/area of interest. The Index Report and Natural Heritage letter can be included in any public environmental review document.

3) A Detailed Report that contains more information on each occurrence may also be requested. Please note that the Detailed Report may contain specific location information that is protected under *Minnesota Statutes*, section 84.0872, subd. 2, and, as such, the Detailed Report may not be included in any public document (e.g., an EAW).

- Check here if you would like to request a Detailed Report. Please note that if the results of the review are 'No Effects' or a standard comment, a Detailed Report may not be available.

#### FEES / TURNAROUND TIME

There is a fee\* for this service. Requests generally take **3-4 weeks** from date of receipt to process, and are processed in the order received.

I have read the entire form and instructions, and the information supplied above is complete and accurate. I understand that material supplied to me from the Natural Heritage Information System is copyrighted and that I am not permitted to reproduce or publish any of this copyrighted material without prior written permission from the DNR. Further, if permission to publish is given, I understand that I must credit the Minnesota Division of Ecological and Water Resources, Minnesota Department of Natural Resources, as the source of the material.

Signature  
(required)

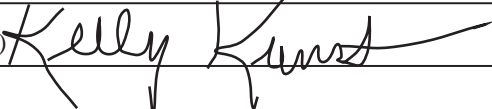

Note: Digital signatures representing the name of a person shall be sufficient to show that such person has signed this document.

Mail or email completed form to:

Lisa Joyal, Endangered Species Review Coordinator  
Division of Ecological and Water Resources  
Minnesota Department of Natural Resources  
500 Lafayette Road, Box 25  
St. Paul, Minnesota 55155  
[Review.NHIS@state.mn.us](mailto:Review.NHIS@state.mn.us)

Form is available at  
[http://files.dnr.state.mn.us/eco/nhnrp/nhis\\_data\\_request.pdf](http://files.dnr.state.mn.us/eco/nhnrp/nhis_data_request.pdf)

Revised March 2, 2012

Nobles 2 Wind Farm-Complete List of Project Area Section, Townships, Range

<b>Township</b>	<b>Range</b>	<b>Sections</b>	<b>Township Name</b>	<b>County</b>
104N	43W	13, 24-26, 33-36	Leota	Nobles
104N	42W	S2-4, 9-35	Wilmont	Nobles
104N	41W	S2-11, 15, 16, 19-22, 28-35	Bloom	Nobles
103N	43W	S1-3	Lismore	Nobles
103N	42W	S2-6	Larkin	Nobles
103N	41W	S2-6	Summit Lake	Nobles



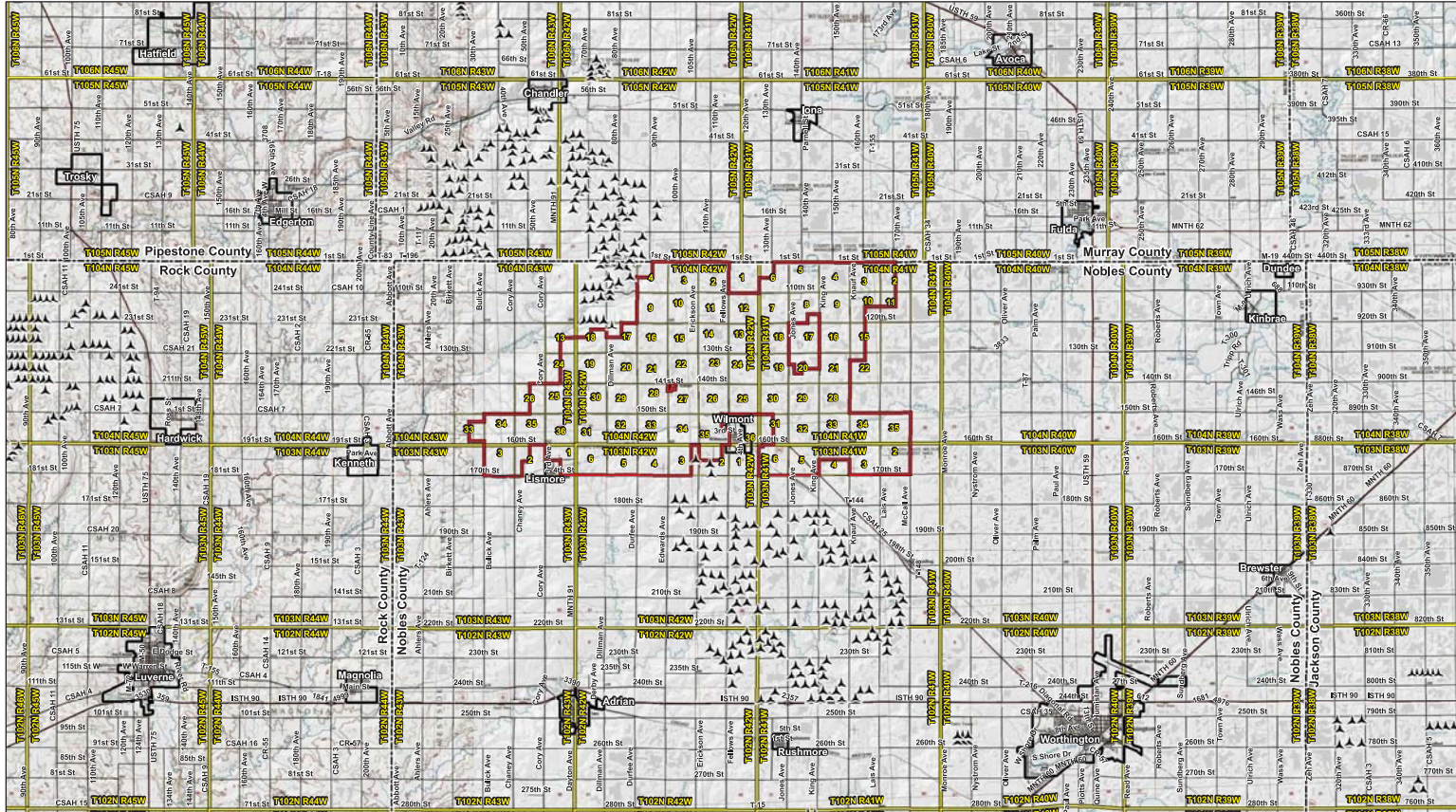

Westwood Professional Services, Inc.  
 1880 837-8190  
 westwoodps.com

- Legend**
- Project Area
  - Existing Wind Turbine
  - PLS Township Boundary
  - County Boundary
  - Municipal Boundary
  - PLS Section Boundary



**Nobs 2 Wind Project**  
 Nobles County, Minnesota  
 Project Location &  
 USGS Topography  
 EXHIBIT 2-1