

Sherco Solar Project

Sherburne County, MN

Preliminary Site Plan-Alternative 2

Sheet List Table	
Sheet Number	Sheet Title
T.100	Cover
C.001	Quantity Summary
C.100	Existing Conditions - 1
C.200	Overall Site Plan
C.201	Site Plan - 1
C.202	Site Plan - 2
C.203	Site Plan - 3
C.204	Site Plan - 4
C.205	Site Plan - 5
C.206	Site Plan - 6
C.207	Site Plan - 7
C.208	Site Plan - 8
C.209	Site Plan - 9
C.300	Screening Plan - 1
C.400	Construction Details - 1
C.401	Construction Details - 2
C.402	Construction Details - 3
C.500	Construction Notes

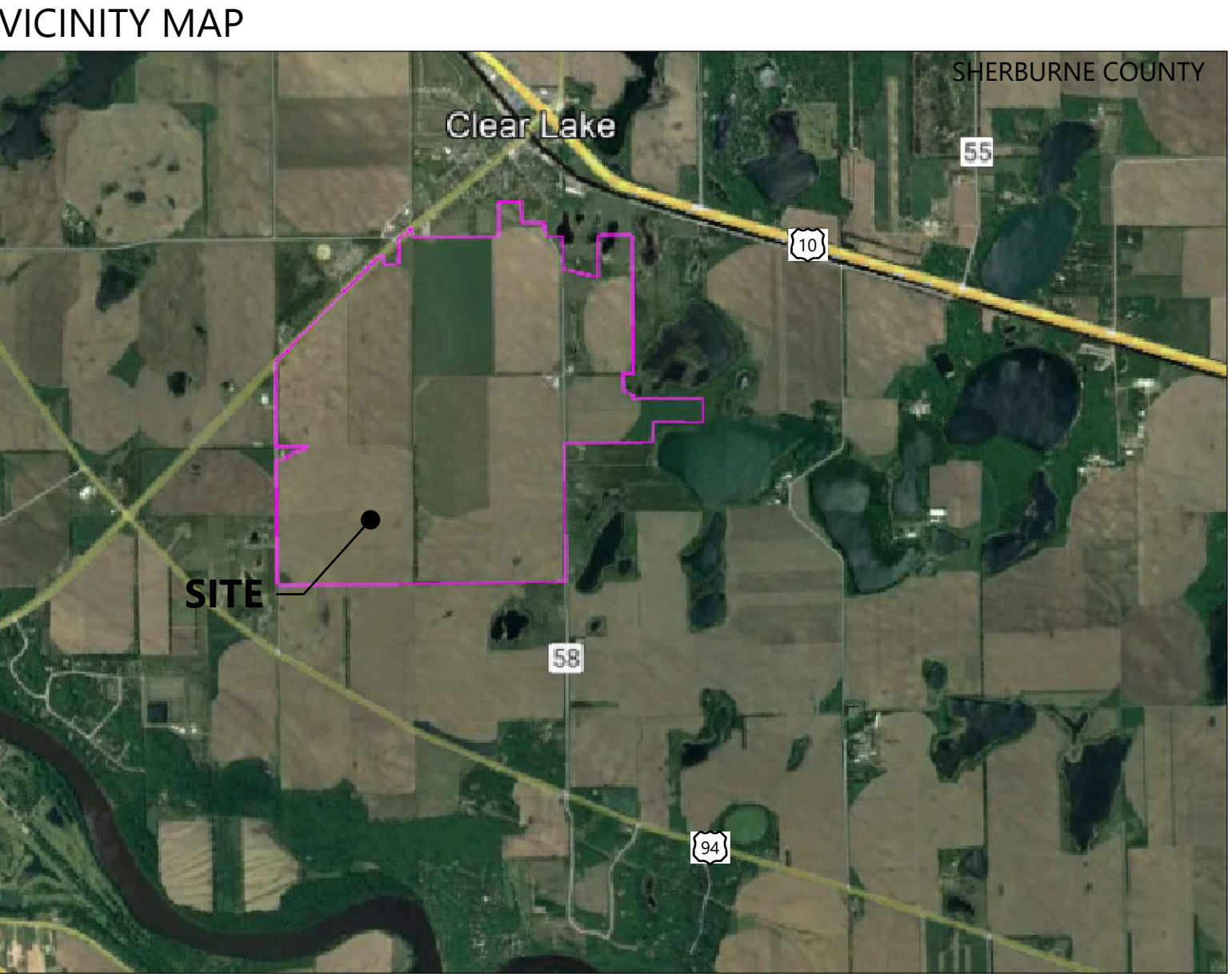
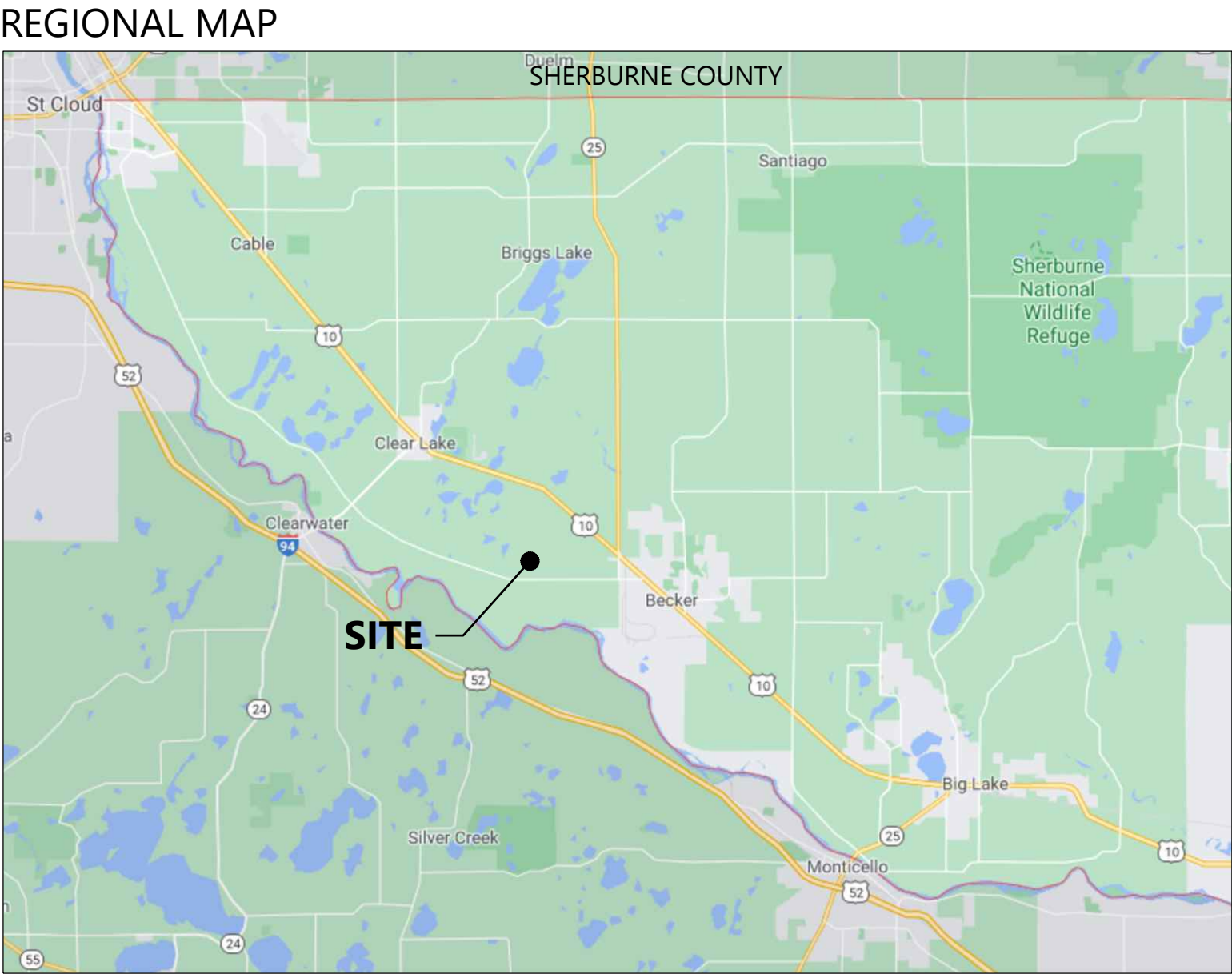

CONTACT INFORMATION			
CONSULTANT	COMPANY	NAME	PHONE NUMBER
OWNER	NORTHERN STATES POWER (XCEL ENERGY)	AARON BRIXIUS	(763) 261-3802
DEVELOPER	NATIONAL GRID RENEWABLES	JOHN STROM	(952) 300-9483
ENGINEERING MANAGER	WESTWOOD	MATT WESSALE	(952) 697-5772
CIVIL ENGINEER	WESTWOOD	DAVE KELEHER	(952) 906-7409
ELECTRICAL ENGINEER	WESTWOOD	DOUG MUTCHER	(952) 697-5709
ELECTRICAL PROJECT MANAGER	WESTWOOD	BRIAN CARROLL	(704) 885-7048

Westwood

Phone (952) 937-5150 12701 Whitewater Drive, Suite #300
Fax (952) 937-5822 Minnetonka, MN 55343
TollFree (888) 937-5150 westwoodps.com
Westwood Professional Services, Inc.

PREPARED FOR:



8400 NORMANDALE LAKE BLVD, STE 1200
BLOOMINGTON, MN 55437

REVISIONS:

#	DATE	COMMENT
A	11/17/2021	CIVIL 30% PLANS

Sherco Solar Project

Sherburne County, MN

Cover

NOT FOR CONSTRUCTION

DATE: 11/17/2021

SHEET: T.100

\\00350527-00_CAD_Sherco\Alternates\035057.DOC \$201.dwg 11/17/2021 9:59 AM Jimmy Blevins

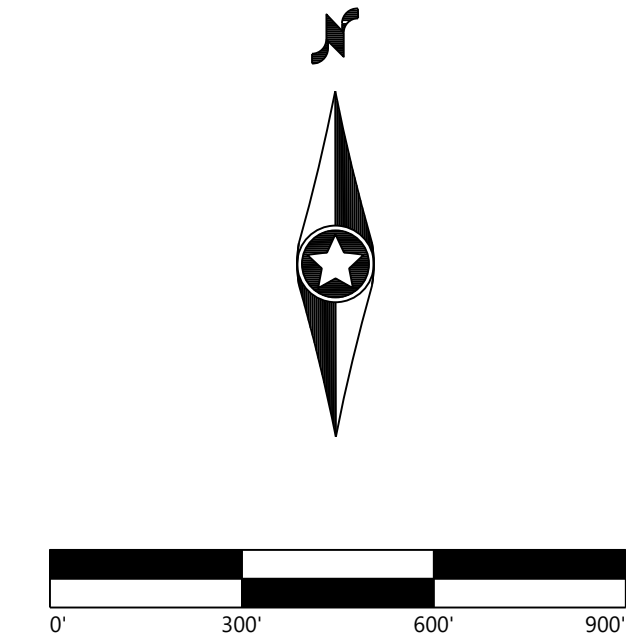

- LEGEND:
- PROJECT BOUNDARY
 - SECTION LINES
 - RIGHT-OF-WAY LINES
 - EASEMENT LINES
 - EX. INDEX CONTOUR
 - EX. INTERVAL CONTOUR
 - EX. TREELINE
 - EX. PAVED ROAD
 - EX. GRAVEL ROAD
 - EX. FENCE
 - EX. OVERHEAD POWER
 - EX. WETLAND
 - EX. PUBLIC WATERBODY
 - EX. RAILROAD
 - EX. IRRIGATION LINE
 - EX. GAS LINE
 - EX. UNDERGROUND CABLE

Westwood

Phone (952) 937-5150 12701 Whitewater Drive, Suite #300
Fax (952) 937-5822 Minnetonka, MN 55343
TollFree (888) 937-5150 westwoodps.com
Westwood Professional Services, Inc.

PREPARED FOR:



8400 NORMANDALE LAKE BLVD, STE 1200
BLOOMINGTON, MN 55437

REVISIONS:

#	DATE	COMMENT
A	11/17/2021	CIVIL 30% PLANS

Sherco Solar Project

Sherburne County, MN

Existing
Conditions - 1

NOT FOR CONSTRUCTION

DATE: 11/17/2021

SHEET: C.100



- LEGEND:**
- PROJECT BOUNDARY
 - SECTION LINES
 - RIGHT-OF-WAY LINES
 - EASEMENT LINES
 - EX. TREELINE
 - EX. PAVED ROAD
 - EX. GRAVEL ROAD
 - EX. IRRIGATION LINES
 - EX. STRUCTURE
 - EX. RAILROAD
 - EX. OVERHEAD POWER
 - EX. GAS LINE
 - EX. UNDERGROUND CABLE
 - EX. UTILITY CABLE
 - EX. WETLAND
 - EX. PUBLIC WATERBODY
 - PROPOSED SOLAR ARRAY
 - PROPOSED MODULE SETBACK
 - PROPOSED ACCESS ROAD
 - PROPOSED ELECTRICAL EQUIPMENT
 - PROPOSED UNDERGROUND COLLECTION
 - PROPOSED LAYDOWN YARD

Westwood

Phone (952) 937-5150 12701 Whitewater Drive, Suite #300
Fax (952) 937-5822 Minnetonka, MN 55343
TollFree (888) 937-5150 westwoodps.com
Westwood Professional Services, Inc.

PREPARED FOR:

nationalgrid
renewables

8400 NORMANDALE LAKE BLVD, STE 1200
BLOOMINGTON, MN 55437

REVISIONS:

#	DATE	COMMENT
A	11/17/2021	CIVIL 30% PLANS

Sherco Solar Project

Sherburne County, MN

Overall Site Plan

NOT FOR CONSTRUCTION

DATE: 11/17/2021

SHEET: C.200

\\01350522-00 CAD Civil\\Minnesota\\03105151 DCC CAD\\01.dwg 11/17/2021 1:00:01 AM Jmm@Baker



	DATE	COMMENT
A	11/17/2021	CIVIL 30% PLANS

	PROJECT BOUNDARY
	SECTION LINES
	RIGHT-OF-WAY LINES
	EASEMENT LINES
	EX. INDEX CONTOUR
	EX. INTERVAL CONTOUR
	EX. TREELINE
	EX. PAVED ROAD
	EX. GRAVEL ROAD
	EX. RAILROAD LINE
	EX. FENCE
	EX. ABOVE-GROUND IRRIGATION (SEE NOTE 7)
	EX. OVERHEAD POWER
	EX. GAS LINE
	EX. UNDERGROUND CABLE
	EX. WETLAND
	EX. PUBLIC WATERBODY
	TREES TO BE CLEARED
	PROPOSED SOLAR ARRAY
	PROPOSED MODULE SETBACK
	PROPOSED ACCESS ROAD
	PROPOSED LOW WATER CROSSING
	PROPOSED SECURITY FENCE
	PROPOSED ELECTRICAL EQUIPMENT
	PROPOSED LAYDOWN YARD
	UNDERGROUND COLLECTION
	PROPOSED INDEX CONTOUR
	PROPOSED INTERVAL CONTOUR
	PROPOSED GRADING LIMITS
	PROPOSED PERIMETER SEDIMENT CONTROL
	PROPOSED OVERHEAD TRANSMISSION LINE
	PROPOSED DISTURBANCE LINE

1. CONTRACTOR SHALL INSTALL ALL PERIMETER EROSION AND SEDIMENT CONTROL DEVICES PRIOR TO UPSLOPE DISTURBANCE ACTIVITIES.
2. SITE PREPARATION INCLUDES BUT IS NOT LIMITED TO CLEARING/GRUBBING, MINOR GRADING, COMPACTION, MOWING OF VEGETATION, AND RESTABILIZATION OF DISTURBED AREA.
3. MINOR SURFACE SMOOTHERS MAY OCCUR FOR SOLAR PANEL INSTALLATION.
4. ACCESS ROADS WILL BE CONSTRUCTED TO MATCH THE SURROUNDING EXISTING GROUND ELEVATIONS TO ALLOW THE CONTINUATION OF DRAINAGE PATTERNS
5. OVERALL DRAINAGE PATTERNS WILL NOT BE ALTERED WITH SOLAR DEVELOPMENT.
6. A SITE SPECIFIC SWPPP AND SPECIFIC BEST MANAGEMENT PRACTICES WILL BE PROVIDED WITH THE FINAL DESIGN.
7. EXISTING ABOVE-GROUND CENTERPIVOT IRRIGATION SYSTEMS TO BE REMOVED IN PV ARRAY AREAS. THE LOCATION OF PRIVATE SUBSURFACE IRRIGATION COMPONENTS ARE UNKNOWN.

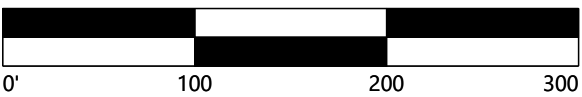

Sherburne County, MN

SHEET: C.201

N:\0030507.00_CAD\Civil\Alternative\0030507.00C-S9F01.dwg 11/17/2021 10:02 AM Jimmy Baxter

SEE SHEET C.203

\\0130502\0 - CAD\Drawings\030501\000\SPR01.dwg 11/17/2021 10:02 AM Jimmy Baez

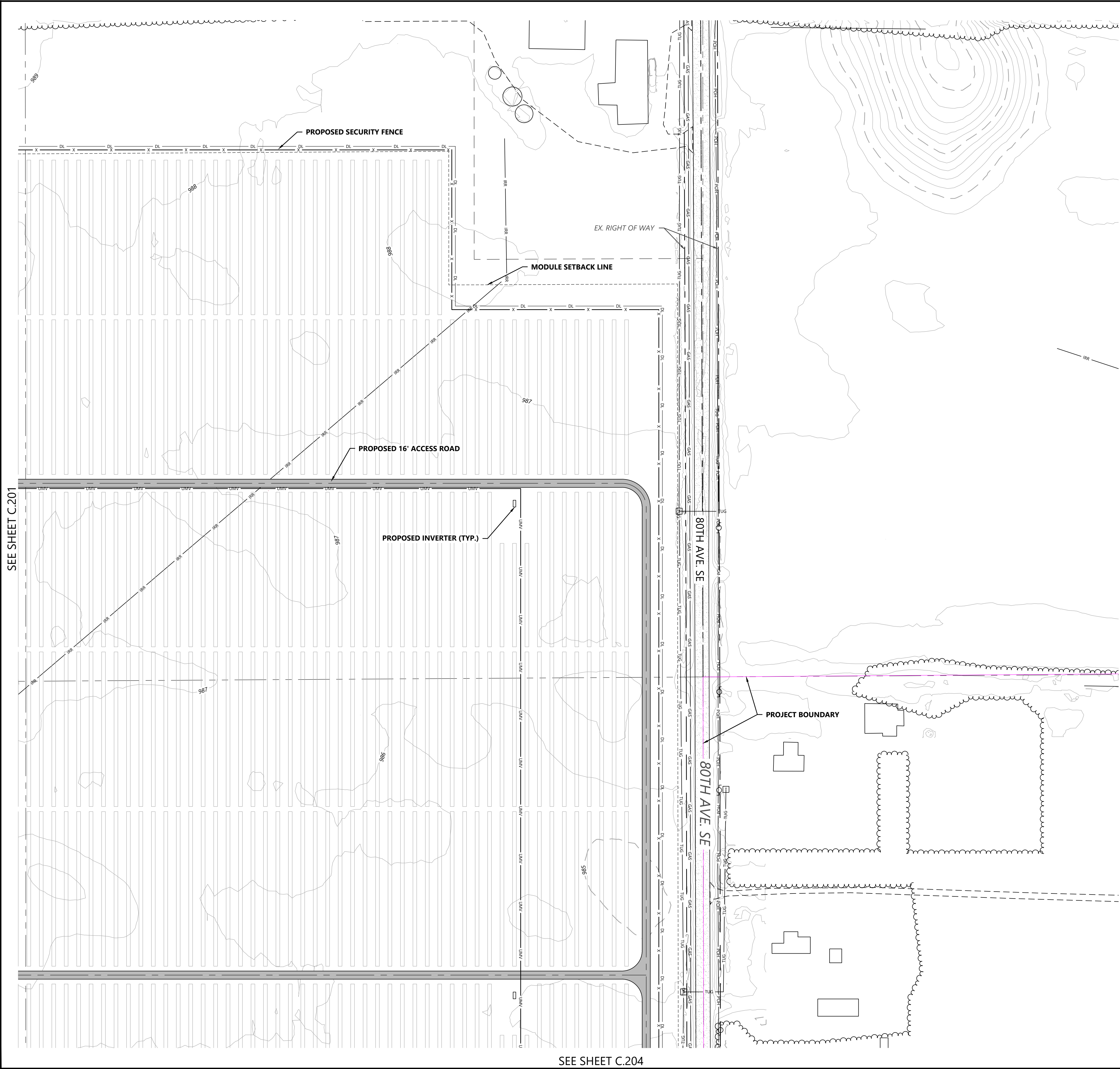

SEE SHEET C.201

SEE SHEET C.204

LEGEND:

- PROJECT BOUNDARY
- SECTION LINES
- RIGHT-OF-WAY LINES
- EASEMENT LINES
- EX. INDEX CONTOUR
- EX. INTERVAL CONTOUR
- EX. TREELINE
- EX. PAVED ROAD
- EX. GRAVEL ROAD
- EX. RAILROAD LINE
- EX. FENCE
- EX. ABOVE-GROUND IRRIGATION (SEE NOTE 7)
- EX. OVERHEAD POWER
- EX. GAS LINE
- EX. UNDERGROUND CABLE
- EX. WETLAND
- EX. PUBLIC WATERBODY
- TREES TO BE CLEARED
- PROPOSED SOLAR ARRAY
- PROPOSED MODULE SETBACK
- PROPOSED ACCESS ROAD
- PROPOSED LOW WATER CROSSING
- PROPOSED SECURITY FENCE
- PROPOSED ELECTRICAL EQUIPMENT
- PROPOSED LAYDOWN YARD
- UNDERGROUND COLLECTION
- PROPOSED INDEX CONTOUR
- PROPOSED INTERVAL CONTOUR
- PROPOSED GRADING LIMITS
- PROPOSED PERIMETER SEDIMENT CONTROL
- PROPOSED OVERHEAD TRANSMISSION LINE
- PROPOSED DISTURBANCE LINE

- NOTES:
- CONTRACTOR SHALL INSTALL ALL PERIMETER EROSION AND SEDIMENT CONTROL DEVICES PRIOR TO UPSLOPE DISTURBANCE ACTIVITIES.
 - SITE PREPARATION INCLUDES BUT IS NOT LIMITED TO CLEARING/GRUBBING, MINOR GRADING, COMPACTION, MOWING OF VEGETATION, AND RESTABILIZATION OF DISTURBED AREA.
 - MINOR SURFACE SMOOTHING MAY OCCUR FOR SOLAR PANEL INSTALLATION.
 - ACCESS ROADS WILL BE CONSTRUCTED TO MATCH THE SURROUNDING EXISTING GROUND ELEVATIONS TO ALLOW THE CONTINUATION OF DRAINAGE PATTERNS. OVERALL DRAINAGE PATTERNS WILL NOT BE ALTERED WITH SOLAR DEVELOPMENT.
 - A SITE SPECIFIC SWPPP AND SPECIFIC BEST MANAGEMENT PRACTICES WILL BE PROVIDED WITH THE FINAL DESIGN.
 - EXISTING ABOVE-GROUND CENTERPIVOT IRRIGATION SYSTEMS TO BE REMOVED IN PV ARRAY AREAS. THE LOCATION OF PRIVATE SUBSURFACE IRRIGATION COMPONENTS ARE UNKNOWN.

KEY MAP:

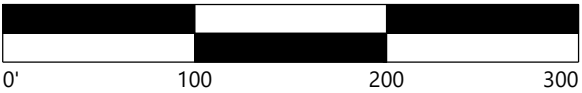
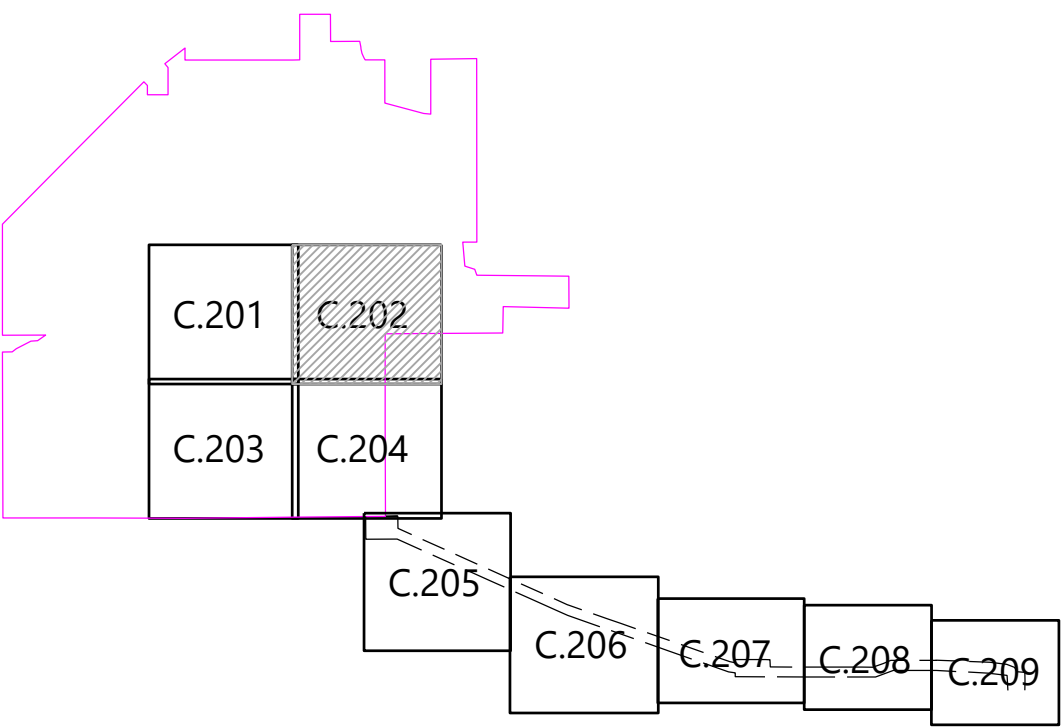

Westwood

Phone (952) 937-5150 12701 Whitewater Drive, Suite #300
Fax (952) 937-5822 Minnetonka, MN 55343
TollFree (888) 937-5150 westwoodps.com
Westwood Professional Services, Inc.

PREPARED FOR:



8400 NORMANDALE LAKE BLVD, STE 1200
BLOOMINGTON, MN 55437

REVISIONS:

#	DATE	COMMENT
A	11/17/2021	CIVIL 30% PLANS

Sherco Solar Project

Sherburne County, MN

Site Plan - 2

NOT FOR CONSTRUCTION

DATE: 11/17/2021

SHEET: C.202

\\03030502.dwg CAD Civil\\Minnesota\\030501.dwg 11/17/2021 10:02 AM Jimmy Baez

SEE SHEET C.201

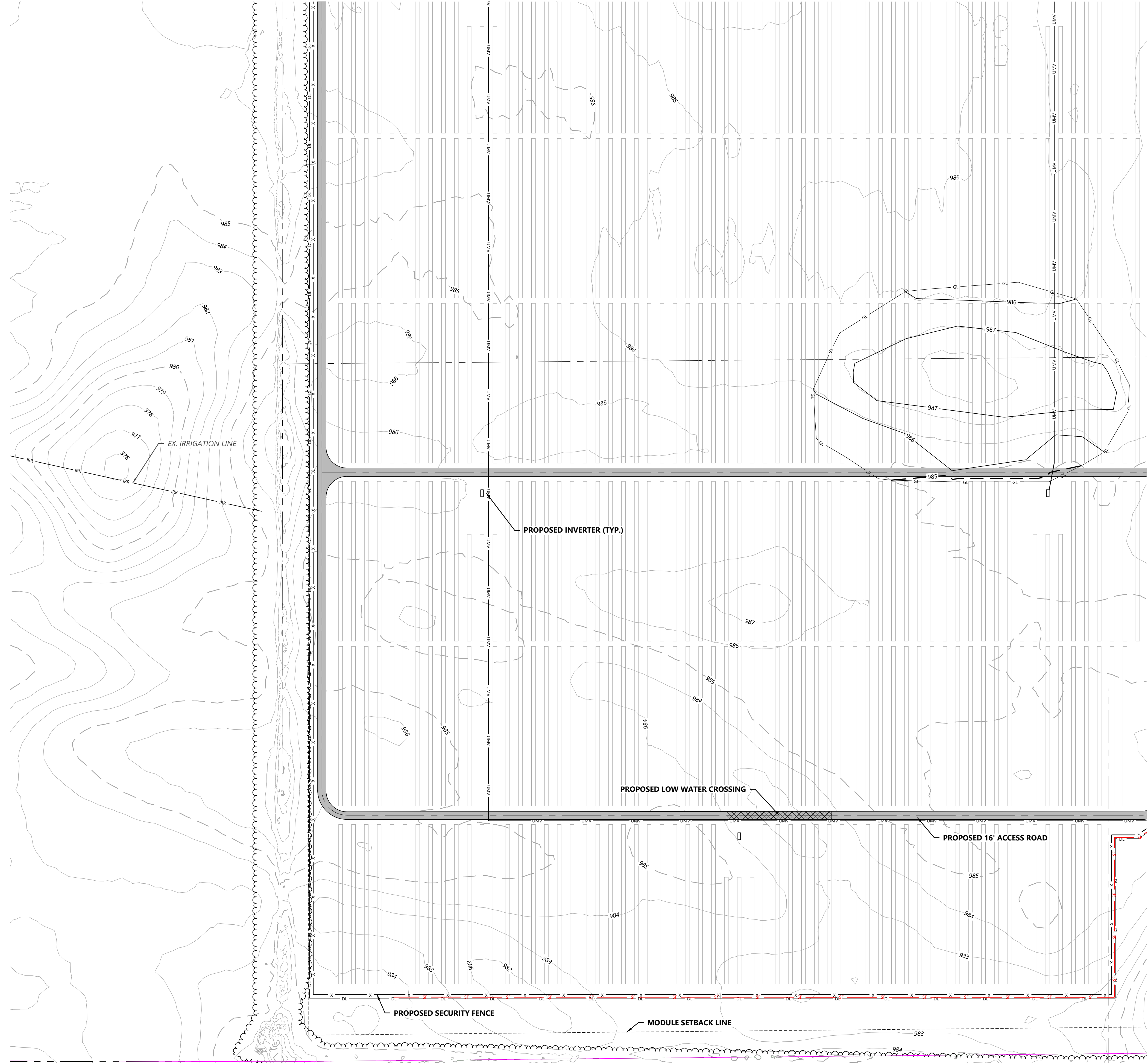

SEE SHEET C.204

LEGEND:

- PROJECT BOUNDARY
- SECTION LINES
- RIGHT-OF-WAY LINES
- EASEMENT LINES
- EX. INDEX CONTOUR
- EX. INTERVAL CONTOUR
- EX. TREELINE
- EX. PAVED ROAD
- EX. GRAVEL ROAD
- EX. RAILROAD LINE
- EX. FENCE
- EX. ABOVE-GROUND IRRIGATION (SEE NOTE 7)
- EX. OVERHEAD POWER
- EX. GAS LINE
- EX. UNDERGROUND CABLE
- EX. WETLAND
- EX. PUBLIC WATERBODY
- TREES TO BE CLEARED
- PROPOSED SOLAR ARRAY
- PROPOSED MODULE SETBACK
- PROPOSED ACCESS ROAD
- PROPOSED LOW WATER CROSSING
- PROPOSED SECURITY FENCE
- PROPOSED ELECTRICAL EQUIPMENT
- PROPOSED LAYDOWN YARD
- UNDERGROUND COLLECTION
- PROPOSED INDEX CONTOUR
- PROPOSED INTERVAL CONTOUR
- PROPOSED GRADING LIMITS
- PROPOSED PERIMETER SEDIMENT CONTROL
- PROPOSED OVERHEAD TRANSMISSION LINE
- PROPOSED DISTURBANCE LINE

- NOTES:
- CONTRACTOR SHALL INSTALL ALL PERIMETER EROSION AND SEDIMENT CONTROL DEVICES PRIOR TO UPSLOPE DISTURBANCE ACTIVITIES.
 - SITE PREPARATION INCLUDES BUT IS NOT LIMITED TO CLEARING/GRUBBING, MINOR GRADING, COMPACTION, MOWING OF VEGETATION, AND RESTABILIZATION OF DISTURBED AREA.
 - MINOR SURFACE SMOOTHING MAY OCCUR FOR SOLAR PANEL INSTALLATION.
 - ACCESS ROADS WILL BE CONSTRUCTED TO MATCH THE SURROUNDING EXISTING GROUND ELEVATIONS TO ALLOW THE CONTINUATION OF DRAINAGE PATTERNS. OVERALL DRAINAGE PATTERNS WILL NOT BE ALTERED WITH SOLAR DEVELOPMENT.
 - A SITE SPECIFIC SWPPP AND SPECIFIC BEST MANAGEMENT PRACTICES WILL BE PROVIDED WITH THE FINAL DESIGN.
 - EXISTING ABOVE-GROUND CENTERPIVOT IRRIGATION SYSTEMS TO BE REMOVED IN PV ARRAY AREAS. THE LOCATION OF PRIVATE SUBSURFACE IRRIGATION COMPONENTS ARE UNKNOWN.

KEY MAP:

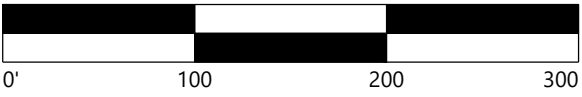
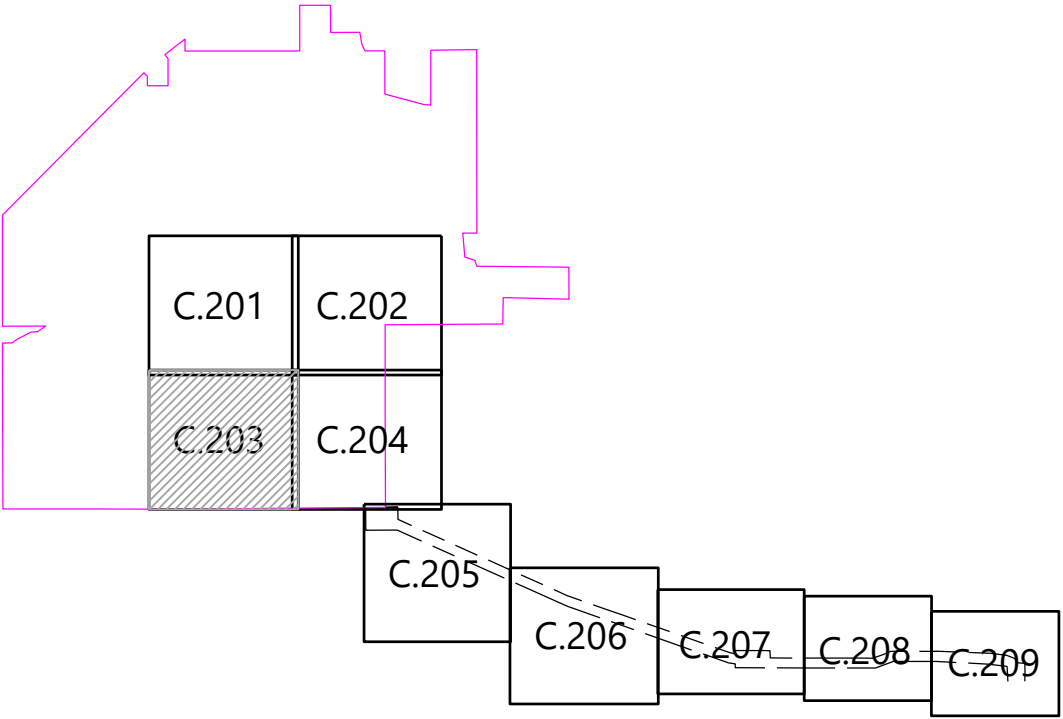

Westwood

Phone (952) 937-5150 12701 Whitewater Drive, Suite #300
Fax (952) 937-5822 Minnetonka, MN 55343
TollFree (888) 937-5150 westwoodps.com
Westwood Professional Services, Inc.

PREPARED FOR:



8400 NORMANDALE LAKE BLVD, STE 1200
BLOOMINGTON, MN 55437

REVISIONS:

#	DATE	COMMENT
A	11/17/2021	CIVIL 30% PLANS

Sherco Solar Project

Sherburne County, MN

Site Plan - 3

NOT FOR CONSTRUCTION

DATE: 11/17/2021

SHEET: C.203



- LEGEND:**
- PROJECT BOUNDARY
 - SECTION LINES
 - RIGHT-OF-WAY LINES
 - EASEMENT LINES
 - EX. INDEX CONTOUR
 - EX. INTERVAL CONTOUR
 - EX. TREELINE
 - EX. PAVED ROAD
 - EX. GRAVEL ROAD
 - EX. RAILROAD LINE
 - EX. FENCE
 - EX. ABOVE-GROUND IRRIGATION (SEE NOTE 7)
 - EX. OVERHEAD POWER
 - EX. GAS LINE
 - EX. UNDERGROUND CABLE
 - EX. WETLAND
 - EX. PUBLIC WATERBODY
 - TREES TO BE CLEARED
 - PROPOSED SOLAR ARRAY
 - PROPOSED MODULE SETBACK
 - PROPOSED ACCESS ROAD
 - PROPOSED LOW WATER CROSSING
 - PROPOSED SECURITY FENCE
 - PROPOSED ELECTRICAL EQUIPMENT
 - PROPOSED LAYDOWN YARD
 - UNDERGROUND COLLECTION
 - PROPOSED INDEX CONTOUR
 - PROPOSED INTERVAL CONTOUR
 - PROPOSED GRADING LIMITS
 - PROPOSED PERIMETER SEDIMENT CONTROL
 - PROPOSED OVERHEAD TRANSMISSION LINE
 - PROPOSED DISTURBANCE LINE

- NOTES:**
- CONTRACTOR SHALL INSTALL ALL PERIMETER EROSION AND SEDIMENT CONTROL DEVICES PRIOR TO UPSLOPE DISTURBANCE ACTIVITIES.
 - SITE PREPARATION INCLUDES BUT IS NOT LIMITED TO CLEARING/GRUBBING, MINOR GRADING, COMPACTION, MOWING OF VEGETATION, AND RESTABILIZATION OF DISTURBED AREA.
 - MINOR SURFACE SMOOTHING MAY OCCUR FOR SOLAR PANEL INSTALLATION.
 - ACCESS ROADS WILL BE CONSTRUCTED TO MATCH THE SURROUNDING EXISTING GROUND ELEVATIONS TO ALLOW THE CONTINUATION OF DRAINAGE PATTERNS. OVERALL DRAINAGE PATTERNS WILL NOT BE ALTERED WITH SOLAR DEVELOPMENT.
 - A SITE SPECIFIC SWPPP AND SPECIFIC BEST MANAGEMENT PRACTICES WILL BE PROVIDED WITH THE FINAL DESIGN.
 - EXISTING ABOVE-GROUND CENTERPIVOT IRRIGATION SYSTEMS TO BE REMOVED IN PV ARRAY AREAS. THE LOCATION OF PRIVATE SUBSURFACE IRRIGATION COMPONENTS ARE UNKNOWN.

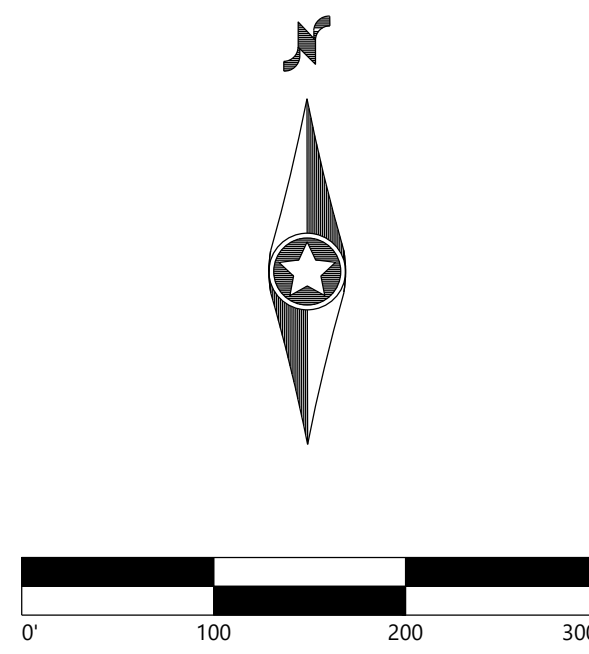
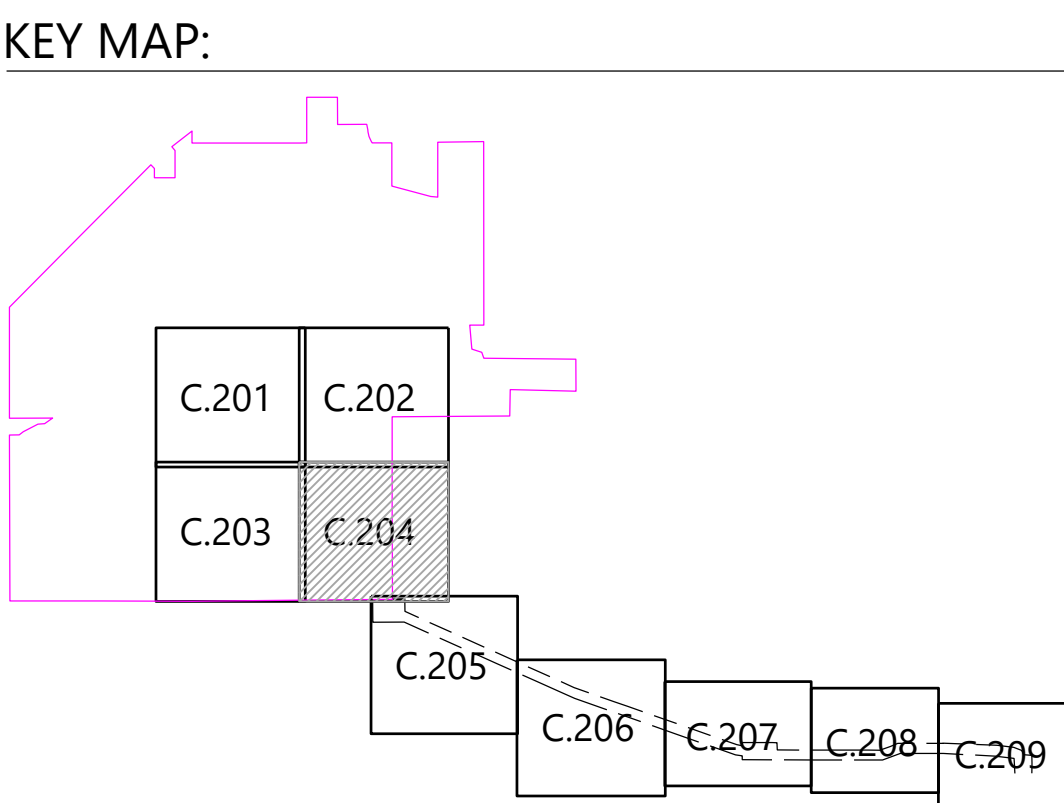

Phone (952) 937-5150 12701 Whitewater Drive, Suite #300
Fax (952) 937-5822 Minnetonka, MN 55343
TollFree (888) 937-5150 westwoodps.com
Westwood Professional Services, Inc.

PREPARED FOR:

8400 NORMANDALE LAKE BLVD, STE 1200
BLOOMINGTON, MN 55437

REVISIONS:

#	DATE	COMMENT
A	11/17/2021	CIVIL 30% PLANS

Sherco Solar Project
Sherburne County, MN

Site Plan - 4

NOT FOR CONSTRUCTION

DATE: 11/17/2021

SHEET: C.204

\\010105027.00 CAD\\G:\\Minnesota\\030501\\000-SPR01.dwg 11/17/2021 10:02 AM Jmmjmm Bawer

PREPARED FOR:



8400 NORMANDALE LAKE BLVD, STE 1200
BLOOMINGTON, MN 55437

REVISIONS:

#	DATE	COMMENT
A	11/17/2021	CIVIL 30% PLANS

Sherco Solar Project

Sherburne County, MN

Site Plan - 5

NOT FOR CONSTRUCTION

DATE: 11/17/2021

SHEET: C.205

LEGEND:

	PROJECT BOUNDARY
	SECTION LINES
	RIGHT-OF-WAY LINES
	EASEMENT LINES
	EX. INDEX CONTOUR
	EX. INTERVAL CONTOUR
	EX. TREELINE
	EX. PAVED ROAD
	EX. GRAVEL ROAD
	EX. RAILROAD LINE
	EX. FENCE
	EX. ABOVE-GROUND IRRIGATION (SEE NOTE 7)
	EX. OVERHEAD POWER
	EX. GAS LINE
	EX. UNDERGROUND CABLE
	EX. WETLAND
	EX. PUBLIC WATERBODY
	TREES TO BE CLEARED
	PROPOSED SOLAR ARRAY
	PROPOSED MODULE SETBACK
	PROPOSED ACCESS ROAD
	PROPOSED LOW WATER CROSSING
	PROPOSED SECURITY FENCE
	PROPOSED ELECTRICAL EQUIPMENT
	PROPOSED LAYDOWN YARD
	UNDERGROUND COLLECTION
	PROPOSED INDEX CONTOUR
	PROPOSED INTERVAL CONTOUR
	PROPOSED GRADING LIMITS
	PROPOSED PERIMETER SEDIMENT CONTROL
	PROPOSED OVERHEAD TRANSMISSION LINE
	PROPOSED DISTURBANCE LINE

NOTES:

- CONTRACTOR SHALL INSTALL ALL PERIMETER EROSION AND SEDIMENT CONTROL DEVICES PRIOR TO UPSLOPE DISTURBANCE ACTIVITIES.
- SITE PREPARATION INCLUDES BUT IS NOT LIMITED TO CLEARING/GRUBBING, MINOR GRADING, COMPACTION, MOWING OF VEGETATION, AND RESTABILIZATION OF DISTURBED AREA.
- MINOR SURFACE SMOOTHING MAY OCCUR FOR SOLAR PANEL INSTALLATION.
- ACCESS ROADS WILL BE CONSTRUCTED TO MATCH THE SURROUNDING EXISTING GROUND ELEVATIONS TO ALLOW THE CONTINUATION OF DRAINAGE PATTERNS. OVERALL DRAINAGE PATTERNS WILL NOT BE ALTERED WITH SOLAR DEVELOPMENT.
- A SITE SPECIFIC SWPPP AND SPECIFIC BEST MANAGEMENT PRACTICES WILL BE PROVIDED WITH THE FINAL DESIGN.
- EXISTING ABOVE-GROUND CENTERPIVOT IRRIGATION SYSTEMS TO BE REMOVED IN PV ARRAY AREAS. THE LOCATION OF PRIVATE SUBSURFACE IRRIGATION COMPONENTS ARE UNKNOWN.

KEY MAP:

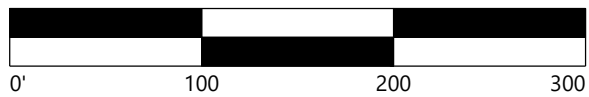
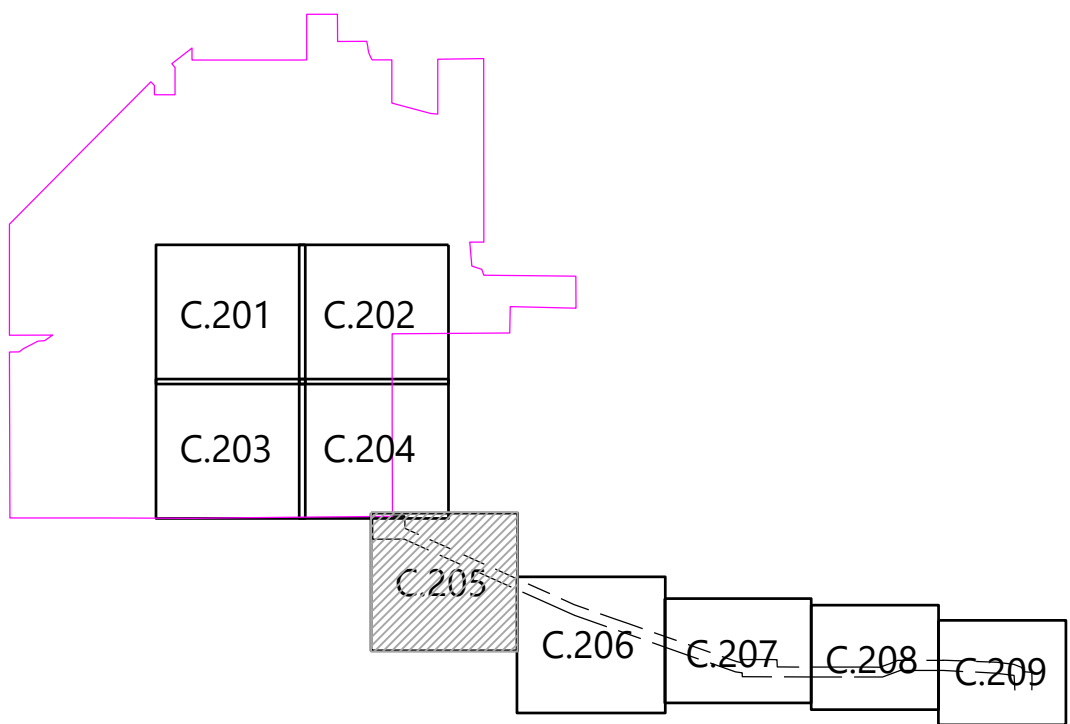

SEE SHEET C.204

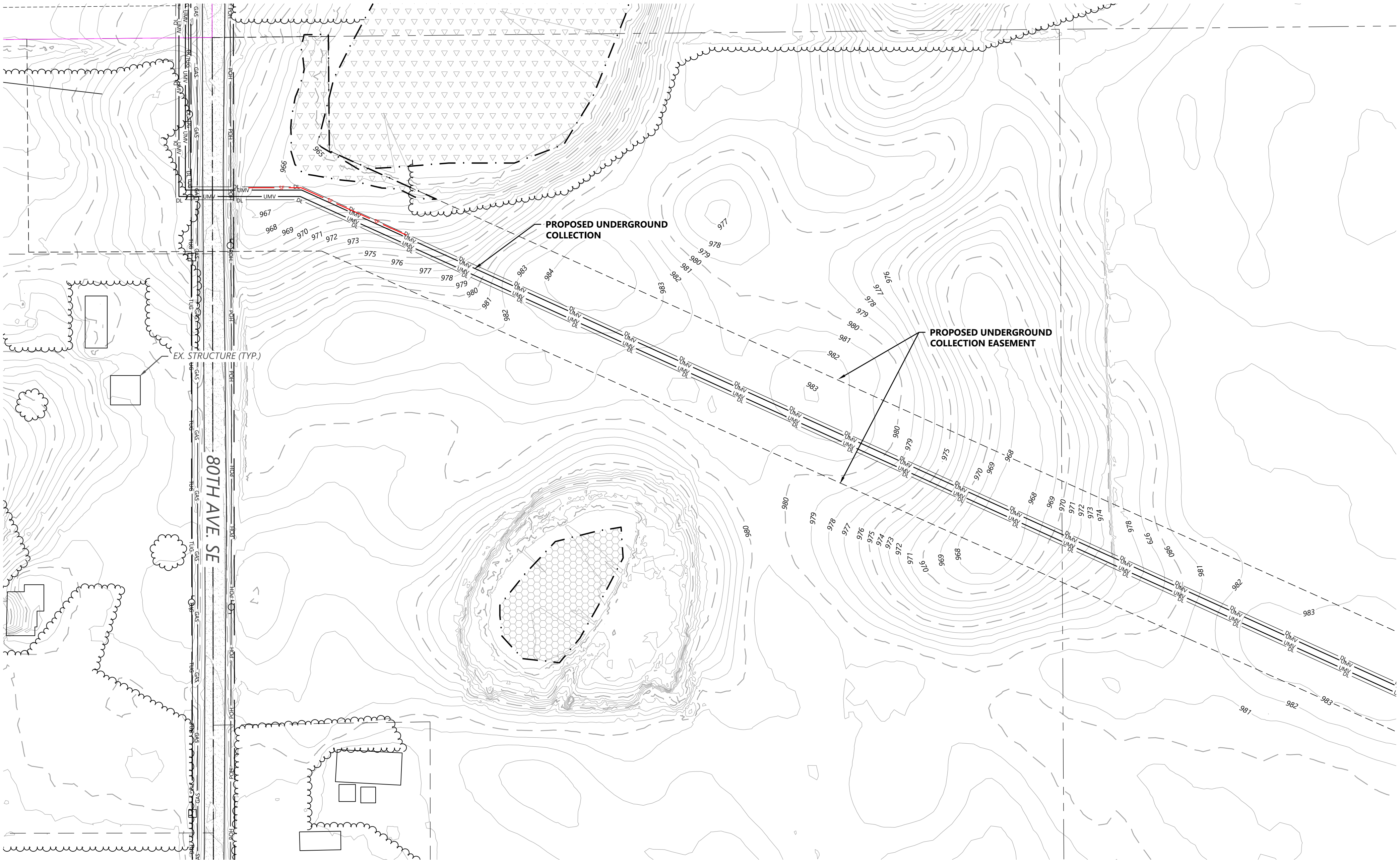

SEE SHEET C.206

S:\035952\03 - CAD\035952.dwg, C:\035952\035952.dwg, 11/17/2021 10:03 AM, Jmmj, Baster

SEE SHEET C.205

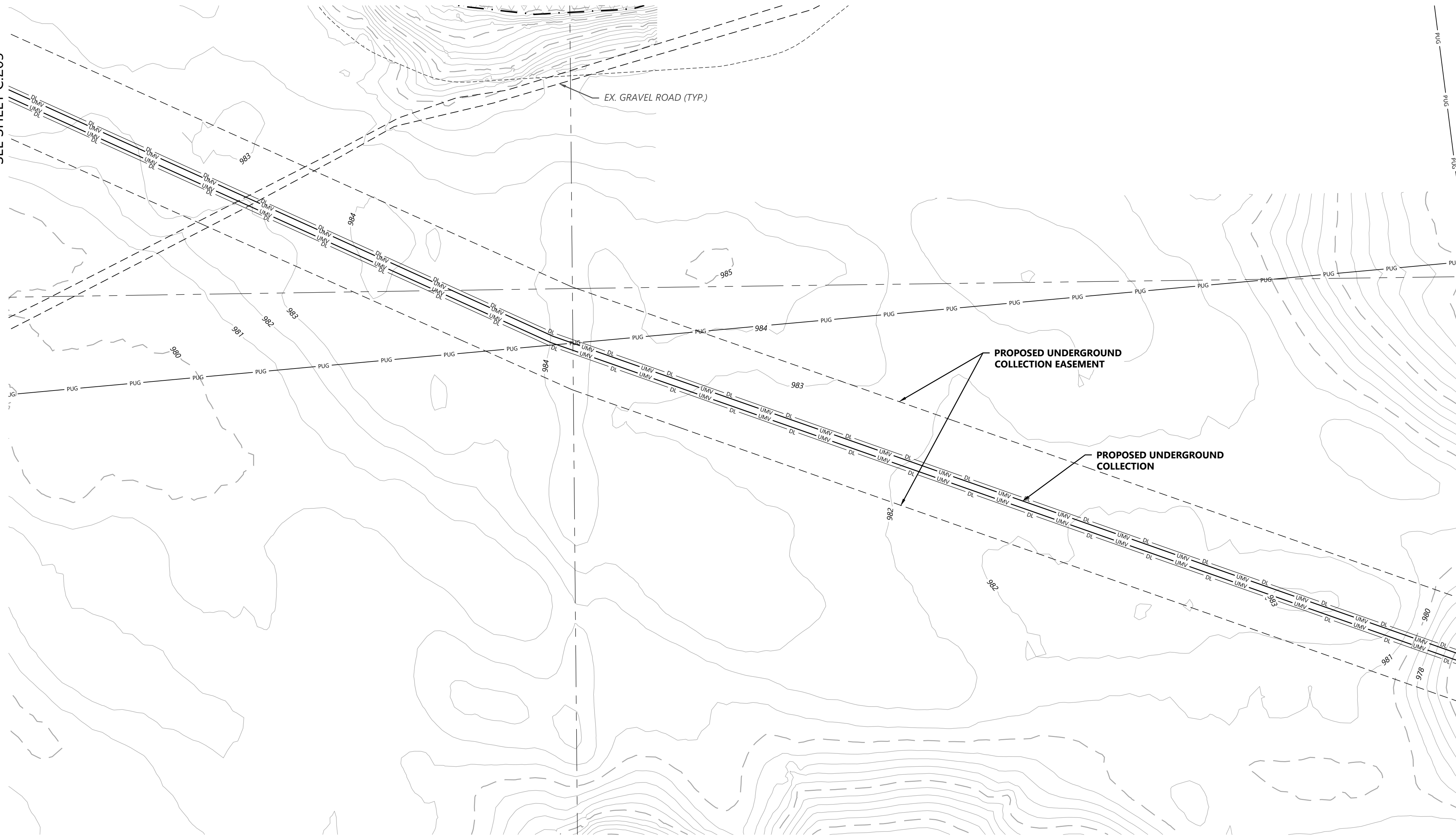

LEGEND:

- PROJECT BOUNDARY
- SECTION LINES
- RIGHT-OF-WAY LINES
- EASEMENT LINES
- EX. INDEX CONTOUR
- EX. INTERVAL CONTOUR
- EX. TREELINE
- EX. PAVED ROAD
- EX. GRAVEL ROAD
- EX. RAILROAD LINE
- EX. FENCE
- EX. ABOVE-GROUND IRRIGATION (SEE NOTE 7)
- EX. OVERHEAD POWER
- EX. GAS LINE
- EX. UNDERGROUND CABLE
- EX. WETLAND
- EX. PUBLIC WATERBODY
- TREES TO BE CLEARED
- PROPOSED SOLAR ARRAY
- PROPOSED MODULE SETBACK
- PROPOSED ACCESS ROAD
- PROPOSED LOW WATER CROSSING
- PROPOSED SECURITY FENCE
- PROPOSED ELECTRICAL EQUIPMENT
- PROPOSED LAYDOWN YARD
- UNDERGROUND COLLECTION
- PROPOSED INDEX CONTOUR
- PROPOSED INTERVAL CONTOUR
- PROPOSED GRADING LIMITS
- PROPOSED PERIMETER SEDIMENT CONTROL
- PROPOSED OVERHEAD TRANSMISSION LINE
- PROPOSED DISTURBANCE LINE

NOTES:

- CONTRACTOR SHALL INSTALL ALL PERIMETER EROSION AND SEDIMENT CONTROL DEVICES PRIOR TO UPSLOPE DISTURBANCE ACTIVITIES.
- SITE PREPARATION INCLUDES BUT IS NOT LIMITED TO CLEARING/GRUBBING, MINOR GRADING, COMPACTION, MOWING OF VEGETATION, AND RESTABILIZATION OF DISTURBED AREA.
- MINOR SURFACE SMOOTHING MAY OCCUR FOR SOLAR PANEL INSTALLATION.
- ACCESS ROADS WILL BE CONSTRUCTED TO MATCH THE SURROUNDING EXISTING GROUND ELEVATIONS TO ALLOW THE CONTINUATION OF DRAINAGE PATTERNS.
- OVERALL DRAINAGE PATTERNS WILL NOT BE ALTERED WITH SOLAR DEVELOPMENT.
- A SITE SPECIFIC SWPPP AND SPECIFIC BEST MANAGEMENT PRACTICES WILL BE PROVIDED WITH THE FINAL DESIGN.
- EXISTING ABOVE-GROUND CENTERPIVOT IRRIGATION SYSTEMS TO BE REMOVED IN PV ARRAY AREAS. THE LOCATION OF PRIVATE SUBSURFACE IRRIGATION COMPONENTS ARE UNKNOWN.

KEY MAP:

SEE SHEET C.207

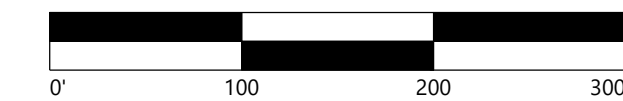
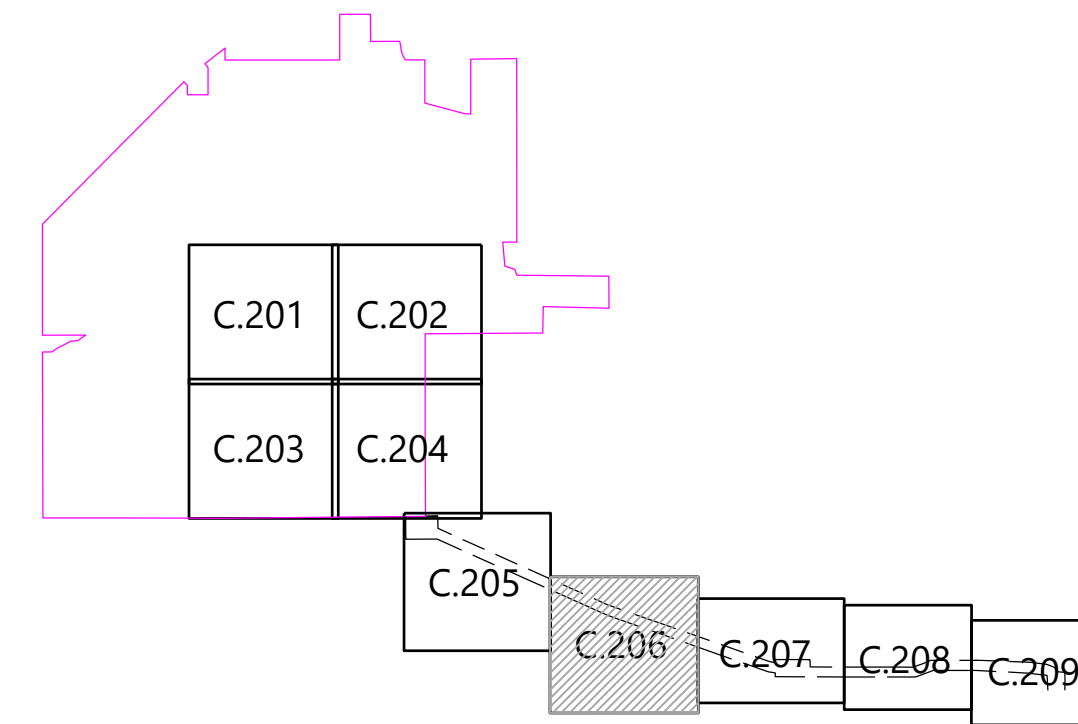

Westwood

Phone (952) 937-5150 12701 Whitewater Drive, Suite #300
Fax (952) 937-5822 Minnetonka, MN 55343
TollFree (888) 937-5150 westwoodps.com
Westwood Professional Services, Inc.

PREPARED FOR:



8400 NORMANDALE LAKE BLVD, STE 1200
BLOOMINGTON, MN 55437

REVISIONS:

#	DATE	COMMENT
A	11/17/2021	CIVIL 30% PLANS

Sherco Solar Project

Sherburne County, MN

Site Plan - 6

NOT FOR CONSTRUCTION

DATE: 11/17/2021

SHEET: C.206

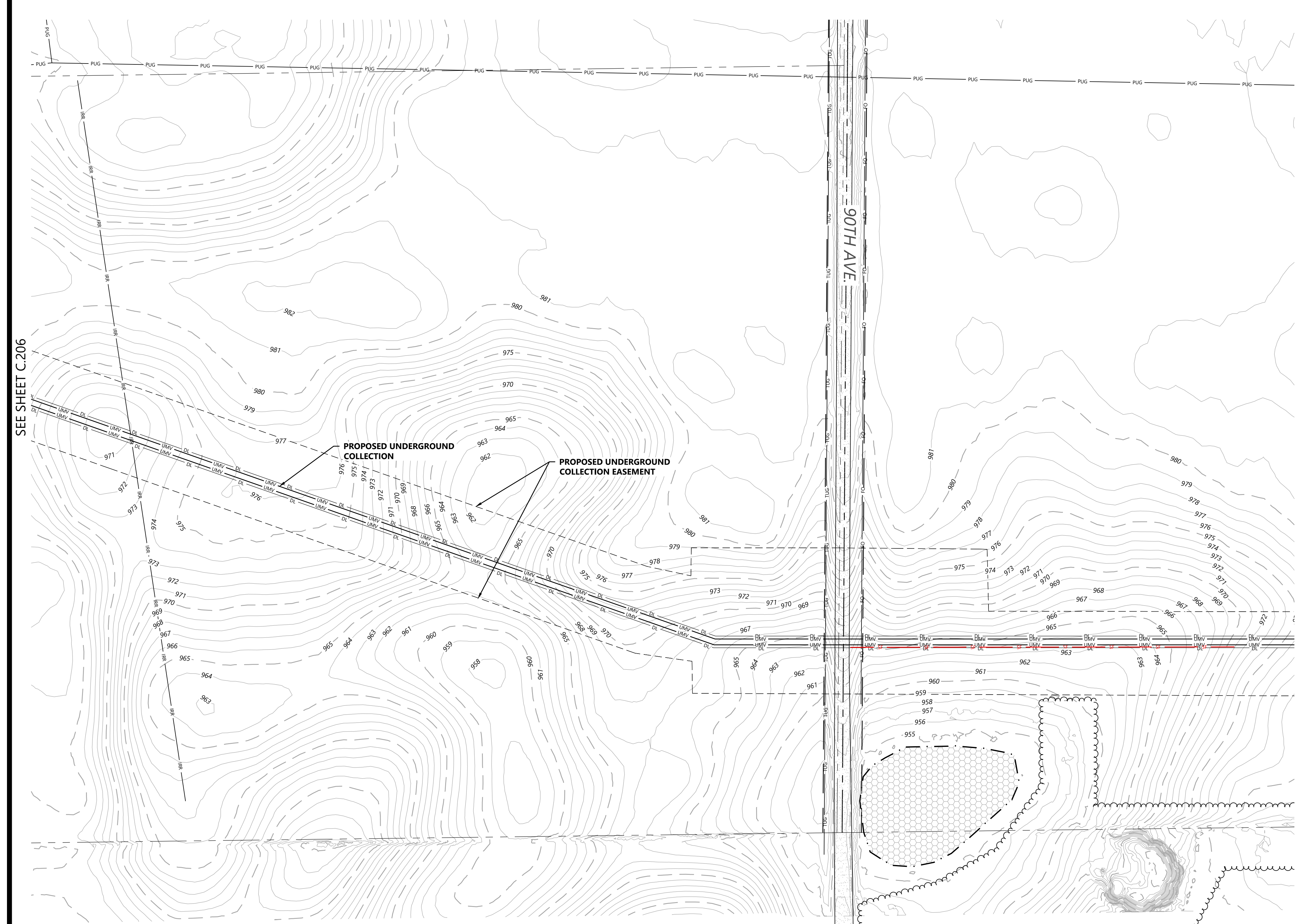

SEE SHEET C.206

SEE SHEET C.208

- LEGEND:
- PROJECT BOUNDARY
 - SECTION LINES
 - RIGHT-OF-WAY LINES
 - EASEMENT LINES
 - EX. INDEX CONTOUR
 - EX. INTERVAL CONTOUR
 - EX. TREELINE
 - EX. PAVED ROAD
 - EX. GRAVEL ROAD
 - EX. RAILROAD LINE
 - EX. FENCE
 - EX. ABOVE-GROUND IRRIGATION (SEE NOTE 7)
 - EX. OVERHEAD POWER
 - EX. GAS LINE
 - EX. UNDERGROUND CABLE
 - EX. WETLAND
 - EX. PUBLIC WATERBODY
 - TREES TO BE CLEARED
 - PROPOSED SOLAR ARRAY
 - PROPOSED MODULE SETBACK
 - PROPOSED ACCESS ROAD
 - PROPOSED LOW WATER CROSSING
 - PROPOSED SECURITY FENCE
 - PROPOSED ELECTRICAL EQUIPMENT
 - PROPOSED LAYDOWN YARD
 - UNDERGROUND COLLECTION
 - PROPOSED INDEX CONTOUR
 - PROPOSED INTERVAL CONTOUR
 - PROPOSED GRADING LIMITS
 - PROPOSED PERIMETER SEDIMENT CONTROL
 - PROPOSED OVERHEAD TRANSMISSION LINE
 - PROPOSED DISTURBANCE LINE

- NOTES:
- CONTRACTOR SHALL INSTALL ALL PERIMETER EROSION AND SEDIMENT CONTROL DEVICES PRIOR TO UPSLOPE DISTURBANCE ACTIVITIES.
 - SITE PREPARATION INCLUDES BUT IS NOT LIMITED TO CLEARING/GRUBBING, MINOR GRADING, COMPACTION, MOWING OF VEGETATION, AND RESTABILIZATION OF DISTURBED AREA.
 - MINOR SURFACE SMOOTHING MAY OCCUR FOR SOLAR PANEL INSTALLATION.
 - ACCESS ROADS WILL BE CONSTRUCTED TO MATCH THE SURROUNDING EXISTING GROUND ELEVATIONS TO ALLOW THE CONTINUATION OF DRAINAGE PATTERNS. OVERALL DRAINAGE PATTERNS WILL NOT BE ALTERED WITH SOLAR DEVELOPMENT.
 - A SITE SPECIFIC SWPPP AND SPECIFIC BEST MANAGEMENT PRACTICES WILL BE PROVIDED WITH THE FINAL DESIGN.
 - EXISTING ABOVE-GROUND CENTERPIVOT IRRIGATION SYSTEMS TO BE REMOVED IN PV ARRAY AREAS. THE LOCATION OF PRIVATE SUBSURFACE IRRIGATION COMPONENTS ARE UNKNOWN.

KEY MAP:

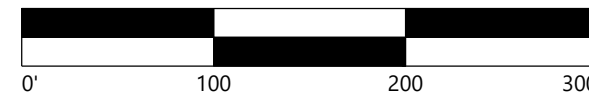
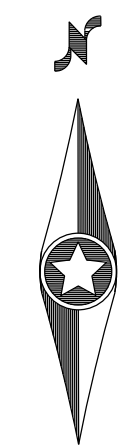
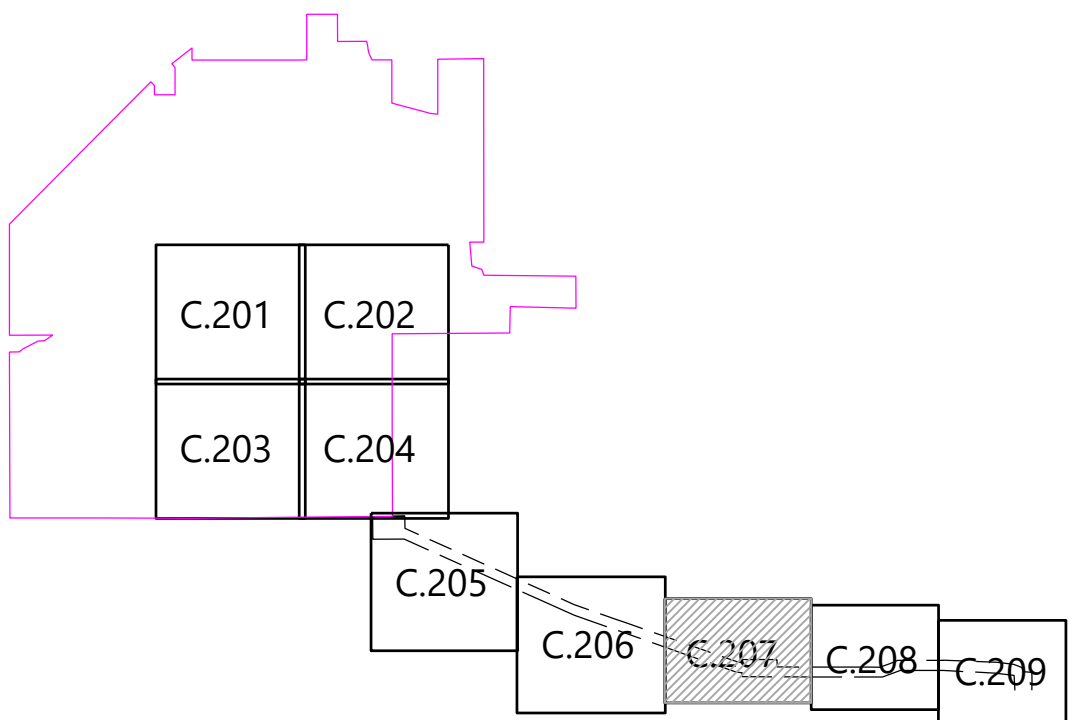

PREPARED FOR:

nationalgrid renewables

8400 NORMANDALE LAKE BLVD, STE 1200
BLOOMINGTON, MN 55437

REVISIONS:

#	DATE	COMMENT
A	11/17/2021	CIVIL 30% PLANS

Sherco Solar Project

Sherburne County, MN

Site Plan - 7

NOT FOR CONSTRUCTION

DATE: 11/17/2021

SHEET: C.207

S:\03\5052\03_045_Civil\Intermittent\035052.dwg 11/17/2021 10:03 AM Jimmy Baer

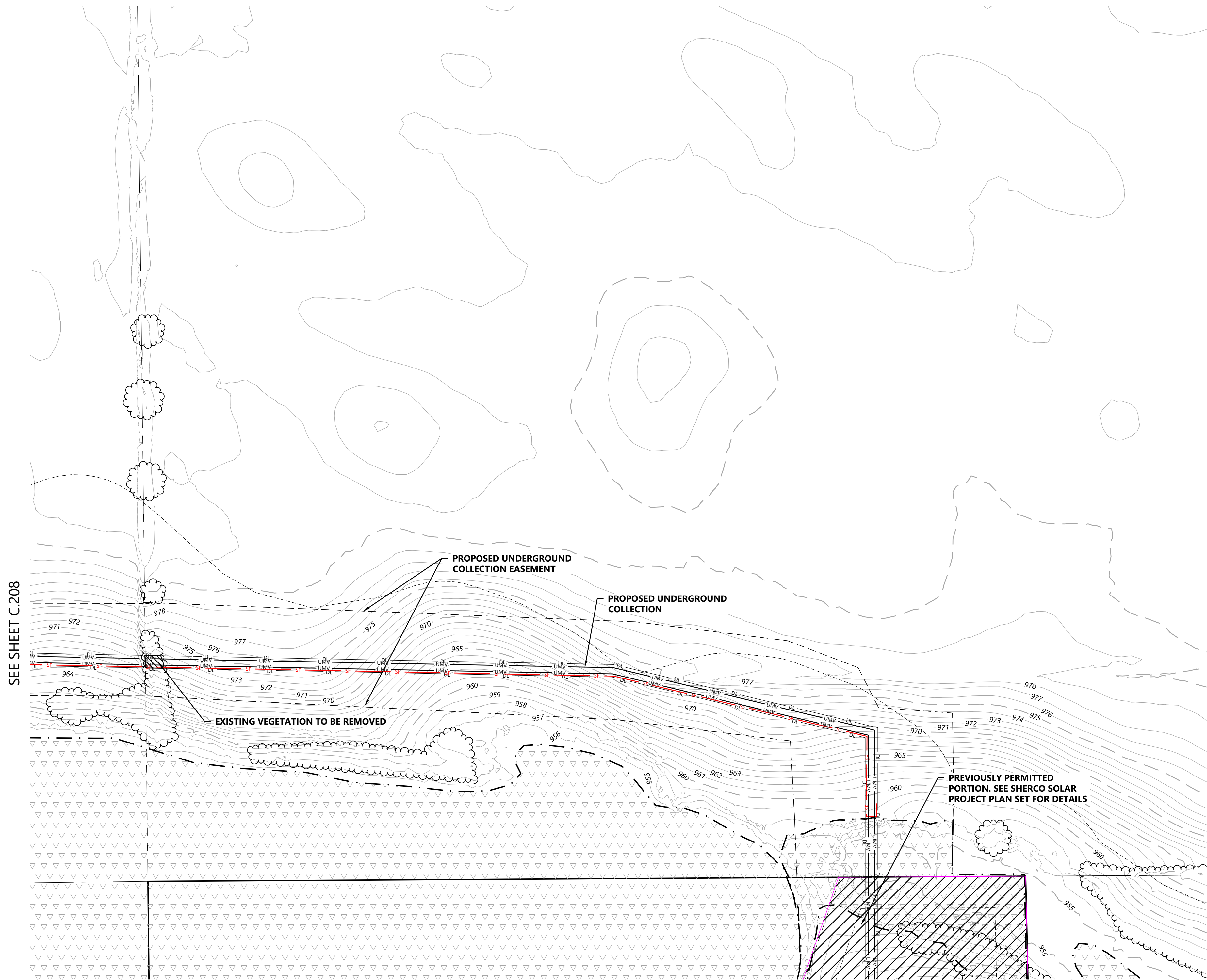

SEE SHEET C.208

LEGEND:

- PROJECT BOUNDARY
- SECTION LINES
- RIGHT-OF-WAY LINES
- EASEMENT LINES
- EX. INDEX CONTOUR
- EX. INTERVAL CONTOUR
- EX. TREELINE
- EX. PAVED ROAD
- EX. GRAVEL ROAD
- EX. RAILROAD LINE
- EX. FENCE
- EX. ABOVE-GROUND IRRIGATION (SEE NOTE 7)
- EX. OVERHEAD POWER
- EX. GAS LINE
- EX. UNDERGROUND CABLE
- EX. WETLAND
- EX. PUBLIC WATERBODY
- TREES TO BE CLEARED
- PROPOSED SOLAR ARRAY
- PROPOSED MODULE SETBACK
- PROPOSED ACCESS ROAD
- PROPOSED LOW WATER CROSSING
- PROPOSED SECURITY FENCE
- PROPOSED ELECTRICAL EQUIPMENT
- PROPOSED LAYDOWN YARD
- UNDERGROUND COLLECTION
- PROPOSED INDEX CONTOUR
- PROPOSED INTERVAL CONTOUR
- PROPOSED GRADING LIMITS
- PROPOSED PERIMETER SEDIMENT CONTROL
- PROPOSED OVERHEAD TRANSMISSION LINE
- PROPOSED DISTURBANCE LINE

- NOTES:
- CONTRACTOR SHALL INSTALL ALL PERIMETER EROSION AND SEDIMENT CONTROL DEVICES PRIOR TO UPSLOPE DISTURBANCE ACTIVITIES.
 - SITE PREPARATION INCLUDES BUT IS NOT LIMITED TO CLEARING/GRUBBING, MINOR GRADING, COMPACTION, MOWING OF VEGETATION, AND RESTABILIZATION OF DISTURBED AREA.
 - MINOR SURFACE SMOOTHING MAY OCCUR FOR SOLAR PANEL INSTALLATION.
 - ACCESS ROADS WILL BE CONSTRUCTED TO MATCH THE SURROUNDING EXISTING GROUND ELEVATIONS TO ALLOW THE CONTINUATION OF DRAINAGE PATTERNS. OVERALL DRAINAGE PATTERNS WILL NOT BE ALTERED WITH SOLAR DEVELOPMENT.
 - A SITE SPECIFIC SWPPP AND SPECIFIC BEST MANAGEMENT PRACTICES WILL BE PROVIDED WITH THE FINAL DESIGN.
 - EXISTING ABOVE-GROUND CENTERPIVOT IRRIGATION SYSTEMS TO BE REMOVED IN PV ARRAY AREAS. THE LOCATION OF PRIVATE SUBSURFACE IRRIGATION COMPONENTS ARE UNKNOWN.

KEY MAP:

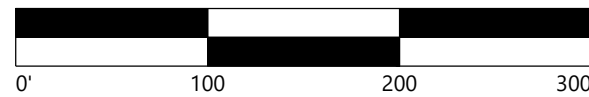
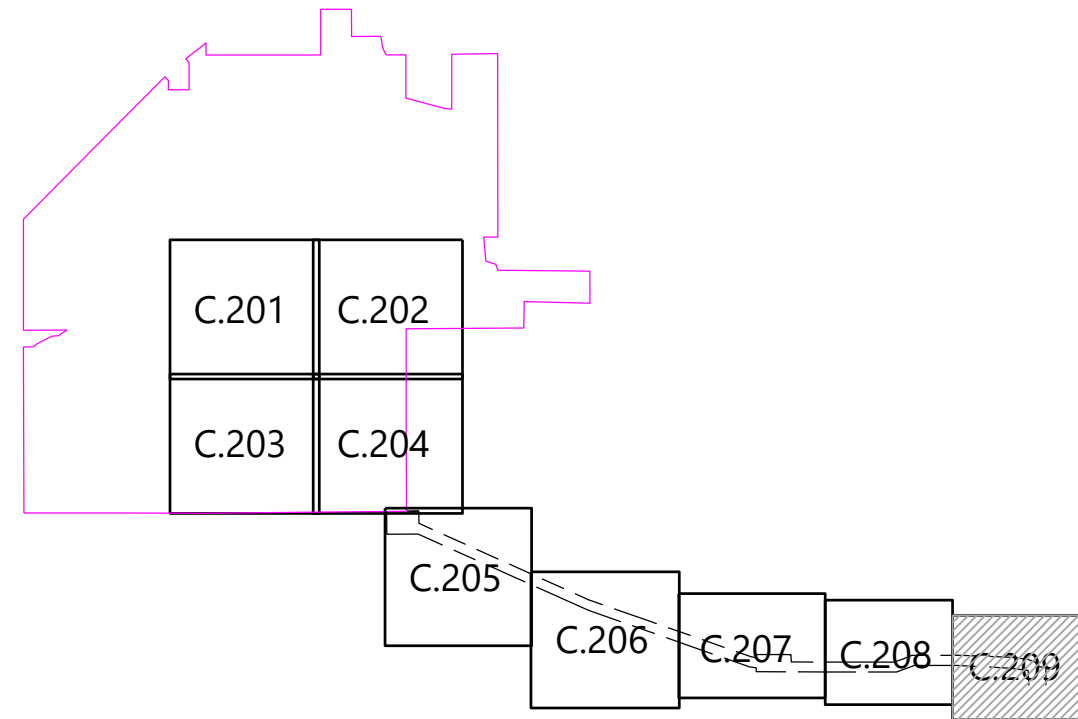

Westwood

Phone (952) 937-5150 12701 Whitewater Drive, Suite #300
Fax (952) 937-5822 Minnetonka, MN 55343
TollFree (888) 937-5150 westwoodps.com
Westwood Professional Services, Inc.

PREPARED FOR:



8400 NORMANDALE LAKE BLVD, STE 1200
BLOOMINGTON, MN 55437

REVISIONS:		
#	DATE	COMMENT
A	11/17/2021	CIVIL 30% PLANS

Sherco Solar Project

Sherburne County, MN

Site Plan - 9

NOT FOR CONSTRUCTION

DATE: 11/17/2021

SHEET: C.209



- LEGEND:**
- PROJECT BOUNDARY
 - SECTION LINES
 - RIGHT-OF-WAY LINES
 - EASEMENT LINES
 - EX. TREELINE
 - EX. PAVED ROAD
 - EX. GRAVEL ROAD
 - EX. RAILROAD LINE
 - EX. FENCE
 - EX. IRRIGATION LINE
 - EX. OVERHEAD POWER
 - EX. WETLAND
 - EX. PUBLIC WATERBODY
 - TREES TO BE CLEARED
 - PROPOSED SOLAR ARRAY
 - PROPOSED MODULE SETBACK
 - PROPOSED ACCESS ROAD
 - PROPOSED LOW WATER CROSSING
 - PROPOSED SECURITY FENCE
 - PROPOSED ELECTRICAL EQUIPMENT
 - PROPOSED LAYDOWN YARD
 - PROPOSED CULVERT
 - PROPOSED OVERHEAD TRANSMISSION LINE
 - PROPOSED VEGETATIVE SCREENING
 - PROPOSED DISTURBANCE LIMITS

KEY MAP:

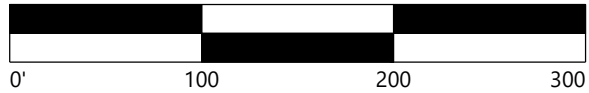
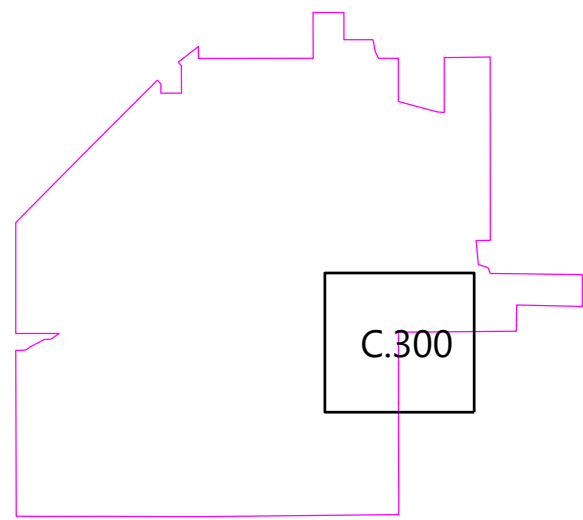

Westwood

Phone (952) 937-5150 12701 Whitewater Drive, Suite #300
Fax (952) 937-5822 Minnetonka, MN 55343
TollFree (888) 937-5150 westwoodps.com
Westwood Professional Services, Inc.

PREPARED FOR:



8400 NORMANDALE LAKE BLVD, STE 1200
BLOOMINGTON, MN 55437

REVISIONS:		
#	DATE	COMMENT
A	11/17/2021	CIVIL 30% PLANS

Sherco Solar Project

Sherburne County, MN

Screening Plan - 1

NOT FOR CONSTRUCTION

DATE: 11/17/2021

SHEET: C.300